

FAU ROUTE	SECTION	COUNTY	TOTAL SHEETS	SHEET NO.
8071	*	SANGAMON	559	73
STA.		TO STA.		
FED. ROAD DIST. NO.		ILLINOIS FED. AID PROJECT		
(84-9-4)A,HBK,BY,BY-1 * 02-00382-02-PV				

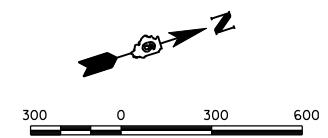
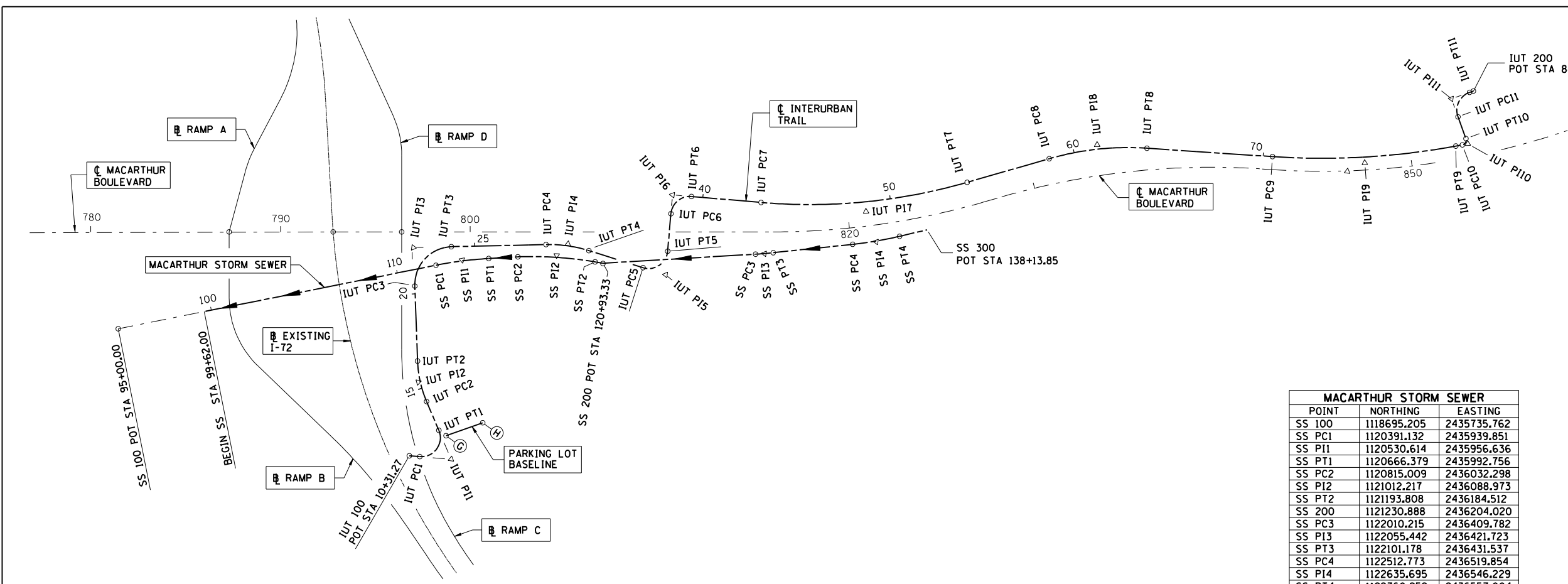

MACARTHUR STORM SEWER		
POINT	NORTHING	EASTING
SS 100	1118695.205	2435735.762
SS PC1	1120391.132	2435939.851
SS PI1	1120530.614	2435956.636
SS PT1	1120666.379	2435992.756
SS PC2	1120815.009	2436032.298
SS PI2	1121012.217	2436088.973
SS PT2	1121193.808	2436184.512
SS 200	1121230.888	2436204.020
SS PC3	1122010.215	2436409.782
SS PI3	1122055.442	2436421.723
SS PT3	1122101.178	2436431.537
SS PC4	1122512.773	2436519.854
SS PI4	1122635.695	2436546.229
SS PT4	1122760.952	2436557.004
SS 300	1122909.290	2436569.765

INTERURBAN TRAIL		
POINT	NORTHING	EASTING
IUT 100	1119944.742	2436850.155
IUT PC1	1119995.596	2436871.688
IUT PI1	1120148.406	2436936.390
IUT PT1	1120134.221	2436771.054
IUT PC2	1120120.117	2436606.665
IUT PI2	1120110.625	2436496.028
IUT PT2	1120141.357	2436389.322
IUT PC3	1120250.882	2436009.034
IUT PI3	1120307.022	2435814.109
IUT PT3	1120501.134	2435872.999
IUT PC4	1120976.531	2436017.227
IUT PI4	1121087.062	2436050.760
IUT PT4	1121180.960	2436118.026
IUT PC5	1121424.443	2436292.449
IUT PI5	1121525.642	2436364.945
IUT PT5	1121574.616	2436250.497
IUT PC6	1121652.650	2436068.137
IUT PI6	1121691.924	2435976.355
IUT PT6	1121783.772	2436015.474
IUT PC7	1122122.701	2436159.830
IUT PI7	1122633.441	2436377.363
IUT PT7	1123188.203	2436397.730
IUT PC8	1123637.890	2436414.239
IUT PI8	1123900.749	2436423.889
IUT PT8	1124144.641	2436522.402
IUT PC9	1124759.748	2436770.856
IUT PI9	1125212.042	2436953.547
IUT PT9	1125695.379	2437019.363
IUT PC10	1125729.982	2437024.074
IUT PI10	1125759.325	2437028.070
IUT PT10	1125758.342	2436998.473
IUT PC11	1125754.291	2436876.569
IUT PI11	1125750.920	2436775.111
IUT PT11	1125852.417	2436773.265
IUT 200	1125874.006	2436772.872

PARKING LOT		
POINT	NORTHING	EASTING
G	1120161.498	2436809.815
H	1120366.451	2436805.423

PROP. CURVE SS 1	
SS PI1	PI STA. = 113+48.65
	Δ = 8° 02' 10" (RT)
	D = 2° 51' 53"
	R = 2,000.00'
	T = 140.49'
	L = 280.52'
	E = 4.93'
SS PC1	P.C. STA. = 112+08.16
SS PT1	P.T. STA. = 114+88.68

PROP. CURVE SS 2	
SS PI2	PI STA. = 118+47.67
	Δ = 11° 42' 56" (RT)
	D = 2° 51' 53"
	R = 2,000.00'
	T = 205.19'
	L = 408.95'
	E = 10.50'
SS PC2	P.C. STA. = 116+42.48
SS PT2	P.T. STA. = 120+51.43

PROP. CURVE SS 3	
SS PI3	PI STA. = 129+46.14
	Δ = 2° 40' 47" (LT)
	D = 2° 51' 53"
	R = 2,000.00'
	T = 46.78'
	L = 93.54'
	E = 0.55'
SS PC3	P.C. STA. = 128+99.36
SS PT3	P.T. STA. = 129+92.90

PROP. CURVE SS 4	
SS PI4	PI STA. = 135+39.58
	Δ = 7° 11' 37" (LT)
	D = 2° 51' 53"
	R = 2,000.00'
	T = 125.72'
	L = 251.11'
	E = 3.95'
SS PC4	P.C. STA. = 134+13.86
SS PT4	P.T. STA. = 136+64.97

PROP. CURVE IUT-1	
IUT PI1	PI STA. = 12+52.44
	Δ = 117° 51' 09" (LT)
	D = 57° 17' 45"
	R = 100.00'
	T = 165.94'
	L = 205.69'
	E = 93.75'
IUT PC1	P.C. STA. = 10+86.50
IUT PT1	P.T. STA. = 12+92.19

PROP. CURVE IUT-2	
IUT PI2	PI STA. = 15+68.22
	Δ = 20° 58' 14" (RT)
	D = 9° 32' 57"
	R = 600.00'
	T = 111.04'
	L = 219.60'
	E = 10.19'
IUT PC2	P.C. STA. = 14+57.18
IUT PT2	P.T. STA. = 16+76.78

PROP. CURVE IUT-3	
IUT PI3	PI STA. = 22+75.38
	Δ = 90° 48' 37" (RT)
	D = 28° 38' 52"
	R = 200.00'
	T = 202.85'
	L = 316.99'
	E = 84.86'
IUT PC3	P.C. STA. = 20+72.53
IUT PT3	P.T. STA. = 23+89.51

PROP. CURVE IUT-4	
IUT PI4	PI STA. = 30+01.81
	Δ = 18° 44' 23" (RT)
	D = 8° 11' 06"
	R = 700.00'
	T = 115.51'
	L = 228.95'
	E = 9.47'
IUT PC4	P.C. STA. = 28+86.31
IUT PT4	P.T. STA. = 31+15.26

PROP. CURVE IUT-5	
IUT PI5	PI STA. = 35+39.26
	Δ = 102° 27' 00" (LT)
	D = 57° 17' 45"
	R = 100.00'
	T = 124.49'
	L = 178.81'
	E = 59.68'
IUT PC5	P.C. STA. = 34+14.77
IUT PT5	P.T. STA. = 35+93.58

PROP. CURVE IUT-6	
IUT PI6	PI STA. = 38+91.76
	Δ = 89° 54' 12" (RT)
	D = 57° 17' 45"
	R = 100.00'
	T = 99.83'
	L = 156.91'
	E = 41.30'
IUT PC6	P.C. STA. = 37+91.93
IUT PT6	P.T. STA. = 39+48.84

PROP. CURVE IUT-7	
IUT PI7	PI STA. = 48+72.37
	Δ = 20° 58' 03" (LT)
	D = 1° 54' 35"
	R = 3,000.00'
	T = 555.14'
	L = 1,097.85'
	E = 50.93'
IUT PC7	P.C. STA. = 43+17.23
IUT PT7	P.T. STA. = 54+15.09

PROP. CURVE IUT-8	
IUT PI8	PI STA. = 61+28.11
	Δ = 19° 53' 32" (RT)
	D = 3° 49' 11"
	R = 1,500.00'
	T = 263.04'
	L = 520.78'
	E = 22.89'
IUT PC8	P.C. STA. = 58+65.08
IUT PT8	P.T. STA. = 63+85.86

PROP. CURVE IUT-9	
IUT PI9	PI STA. = 75+37.04
	Δ = 14° 14' 26" (LT)
	D = 1° 28' 02"
	R = 3,905.00'
	T = 487.80'
	L = 970.57'
	E = 30.35'
IUT PC9	P.C. STA. = 70+49.24
IUT PT9	P.T. STA. = 80+19.81

PROP. CURVE IUT-10	
IUT PI10	PI STA. = 80+84.35
	Δ = 99° 39' 26" (LT)
	D = 229° 10' 59"
	R = 25.00'
	T = 29.61'
	L = 43.48'
	E = 13.76'
IUT PC10	P.C. STA. = 80+54.73
IUT PT10	P.T. STA. = 80+98.22

PROP. CURVE IUT-11	
IUT PI11	PI STA. = 83+21.70
	Δ = 90° 51' 40" (RT)
	D = 57° 17' 45"
	R = 100.00'
	T = 101.51'
	L = 158.58'
	E = 42.50'
IUT PC11	P.C. STA. = 82+20.19
IUT PT11	P.T. STA. = 83+78.77

REVISIONS	
NAME	DATE

ILLINOIS DEPARTMENT OF TRANSPORTATION
 CENTERLINE GEOMETRICS MISC.
 FAI-72, MACARTHUR BLVD
 SEC NO. 02-00382-02-PV
 SEC NO. (84-9-4)A,HBK,BY,BY-1
 SANGAMON COUNTY, ILLINOIS

SCALE: VERT. 1"=40'
 HORIZ. 1"=40'
 DATE: 12/16/2006

DRAWN BY: CLG
 CHECKED BY: SKM

12/16/2006 \$FILES
 LAYOUT: CLG 08/05/06
 DRAWN: CLG 08/05/06
 REVIEWED: JMD/JMD 08/05/06
 © Copyright Hanson Professional Services Inc. \$MS_YEARS
HANSON