

FAU ROUTE	SECTION	COUNTY	TOTAL SHEETS	SHEET NO.
8071	*	SANGAMON	559	90
STA.		TO STA.		
FED. ROAD DIST. NO.		ILLINOIS FED. AID PROJECT		
184-9-41A, HKB, BY-1 * 02-00382-02-PV				

XX DRAINAGE STRUCTURE NOT CONSTRUCTED IN GRADING & STRUCTURES CONTRACT. SHOWN FOR INFORMATION ONLY.

NOTES:
 *** LAY STORM SEWER ON 2000' MIN RADIUS CURVE USING DEFLECTED STRAIGHT PIPE SEGMENTS (TYPICAL)

PIPE CULVERT TYPE 1 RCCP 36" - 202 LF
 USFL 815+00.00, 110' RT EL 598.50
 DSFL 815+00.00, 108' LT EL 598.50
 2 PRECAST REINFORCED CONCRETE FLARED END SECTIONS

PIPE CULVERT TYPE 1 RCCP ELLIPTICAL 18" - 32 LF
 USFL 821+87.00, 143.0' LT EL 600.40
 DSFL 821+41.00, 143.0' LT EL 600.28
 2 PRECAST REINFORCED CONCRETE ELLIPTICAL FLARED END SECTIONS

PIPE CULVERT TYPE 1 RCCP ELLIPTICAL 18" - 32 LF
 USFL 821+89.00, 84.0' LT EL 600.40
 DSFL 821+44.00, 84.0' LT EL 600.28
 2 PRECAST REINFORCED CONCRETE ELLIPTICAL FLARED END SECTIONS

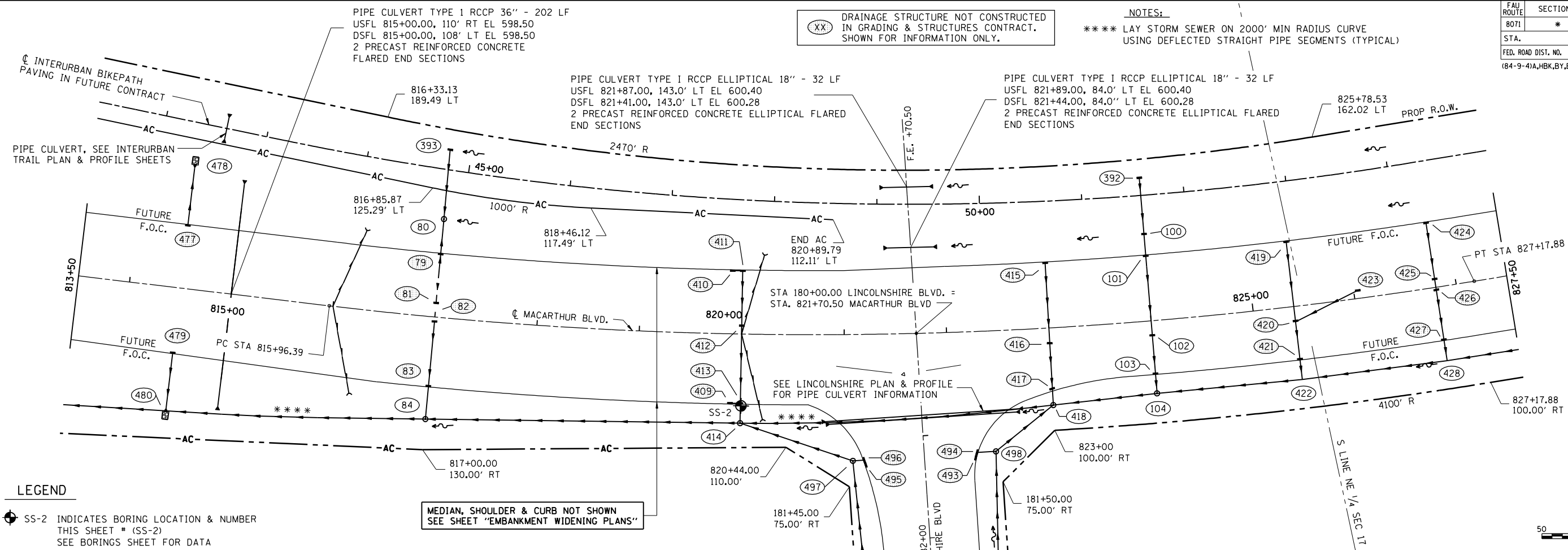

LEGEND

SS-2 INDICATES BORING LOCATION & NUMBER THIS SHEET * (SS-2) SEE BORINGS SHEET FOR DATA

MEDIAN, SHOULDER & CURB NOT SHOWN SEE SHEET "EMBANKMENT WIDENING PLANS"

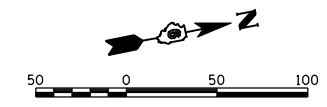

DATE	BY
DATE	BY
DATE	BY

PLAN SURVEYED, PLOTTED, CHECKED, NOTE BOOK NO., DATE FILED, NAME

DATE	BY
DATE	BY
DATE	BY

PROFILE SURVEYED, PLOTTED, CHECKED, NOTE BOOK NO., DATE FILED, NAME

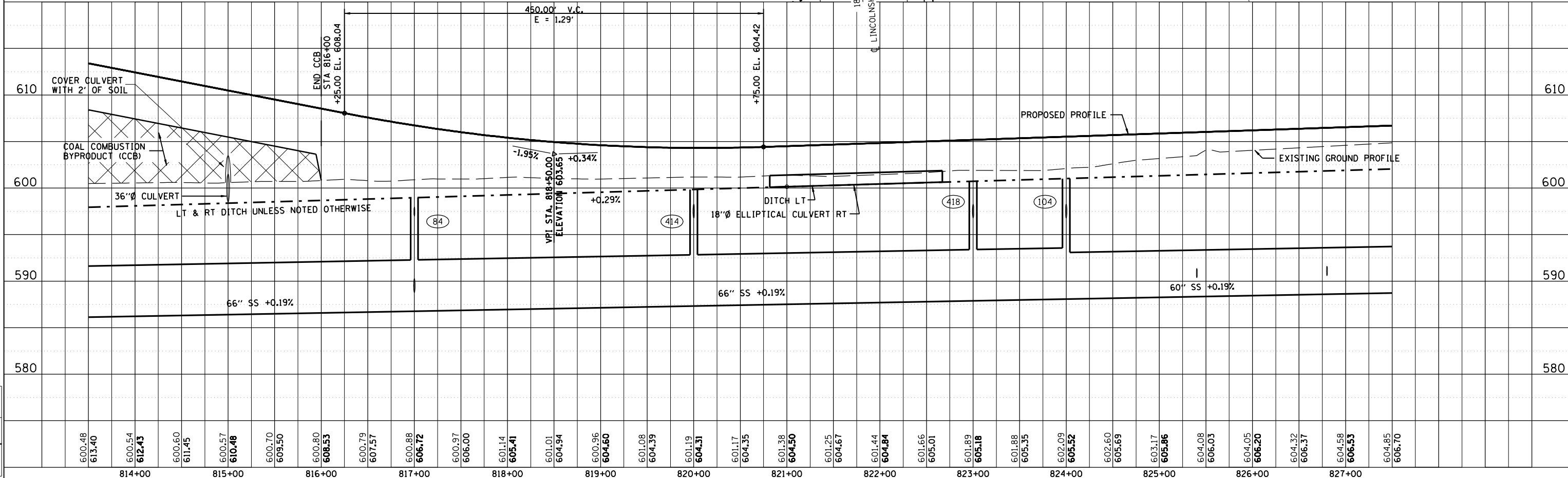

LAYOUT	CLG	04/28/06
DRAWN	CLG	04/28/06
REVIEWED	JMD/JM	04/28/06