

FAU ROUTE	SECTION	COUNTY	TOTAL SHEETS	SHEET NO.
8071	*	SANGAMON	559	124
STA. 8071		TO STA. 42+00		
FED. ROAD DIST. NO.	ILLINOIS	FED. AID PROJECT		
(84-9-4)A,HBK,BY,BY-1 * 02-00382-02-PV				

PLAN	SURVEYED	BY	DATE
NO. _____	PLOTTED _____		
	CHECKED _____		
	PI. OF WAY CHECKED _____		
	CADD FILE NAME _____		



PROFILE	SURVEYED	BY	DATE
NO. _____	PLOTTED _____		
	CHECKED _____		
	PI. OF WAY CHECKED _____		
	STRUCTURE NOTATIONS CHECKED _____		

LAYOUT	CLG	04/28/06
DRAWN	CLG	04/28/06
REVIEWED	JSD/JMM	04/28/06

PIPE CULVERT TYPE 1 RCCP 24" - 47 LF
 USFL 34+00.00, 28' LT EL 600.00
 DSFL 34+00.00, 31' RT EL 598.36
 2 PRECAST REINFORCED CONCRETE
 FLARED END SECTIONS

INTERURBAN STRUCTURE UNDER MACARTHUR BLVD
 BIKEPATH STA 36+95.86 MACARTHUR BLVD STA 810+50

PROP. CURVE IUT-5
 PI STA. = 35+39.26
 $\Delta = 102^\circ 27' 00''$ (LT)
 D = 57° 17' 45"
 R = 100.00'
 T = 124.49'
 L = 178.81'
 E = 59.68'
 e = -----
 T.R. = -----
 S.E. RUN = -----
 P.C. STA. = 34+14.77
 P.T. STA. = 35+93.58

PROP. CURVE IUT-6
 PI STA. = 38+91.76
 $\Delta = 89^\circ 54' 12''$ (RT)
 D = 57° 17' 45"
 R = 100.00'
 T = 99.83'
 L = 156.91'
 E = 41.30'
 e = -----
 T.R. = -----
 S.E. RUN = -----
 P.C. STA. = 37+91.93
 P.T. STA. = 39+48.84

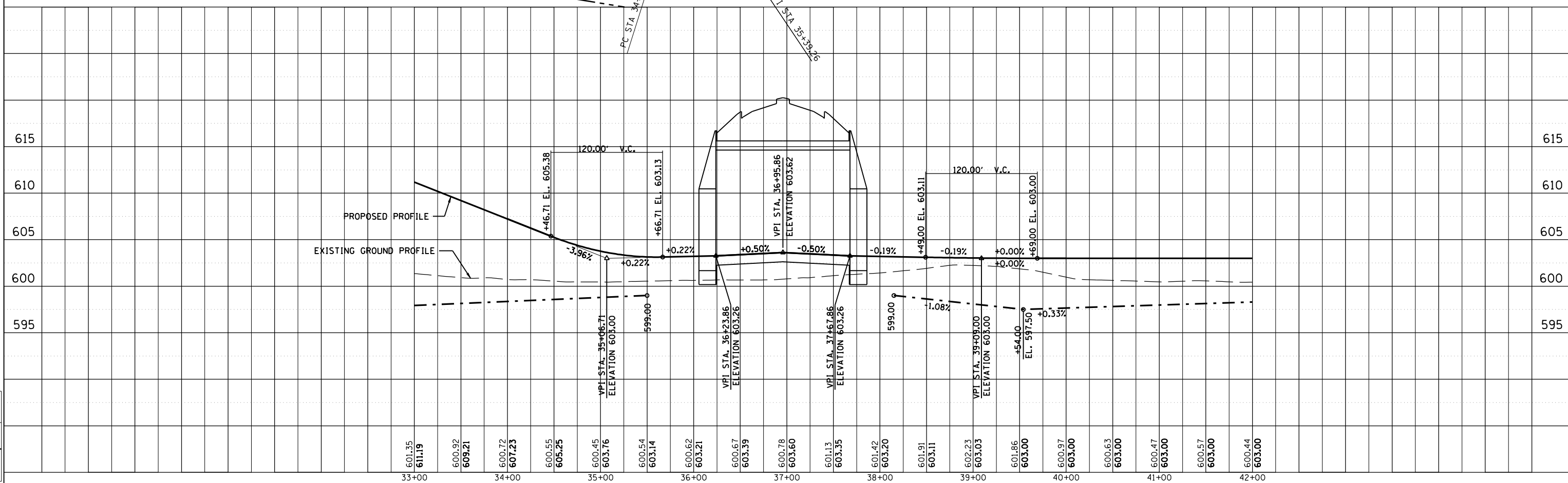
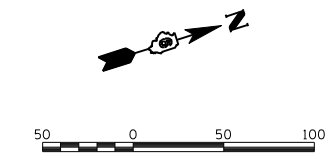

INTERURBAN TRAIL STA 33+00 TO STA 42+00