

FAU ROUTE	SECTION	COUNTY	TOTAL SHEETS	SHEET NO.
8071	*	SANGAMON	559	134
STA.		TO STA.		
FED. ROAD DIST. NO.		ILLINOIS FED. AID PROJECT		
(84-9-4)A,HBK,BY,BY-1 * 02-00382-02-PV				

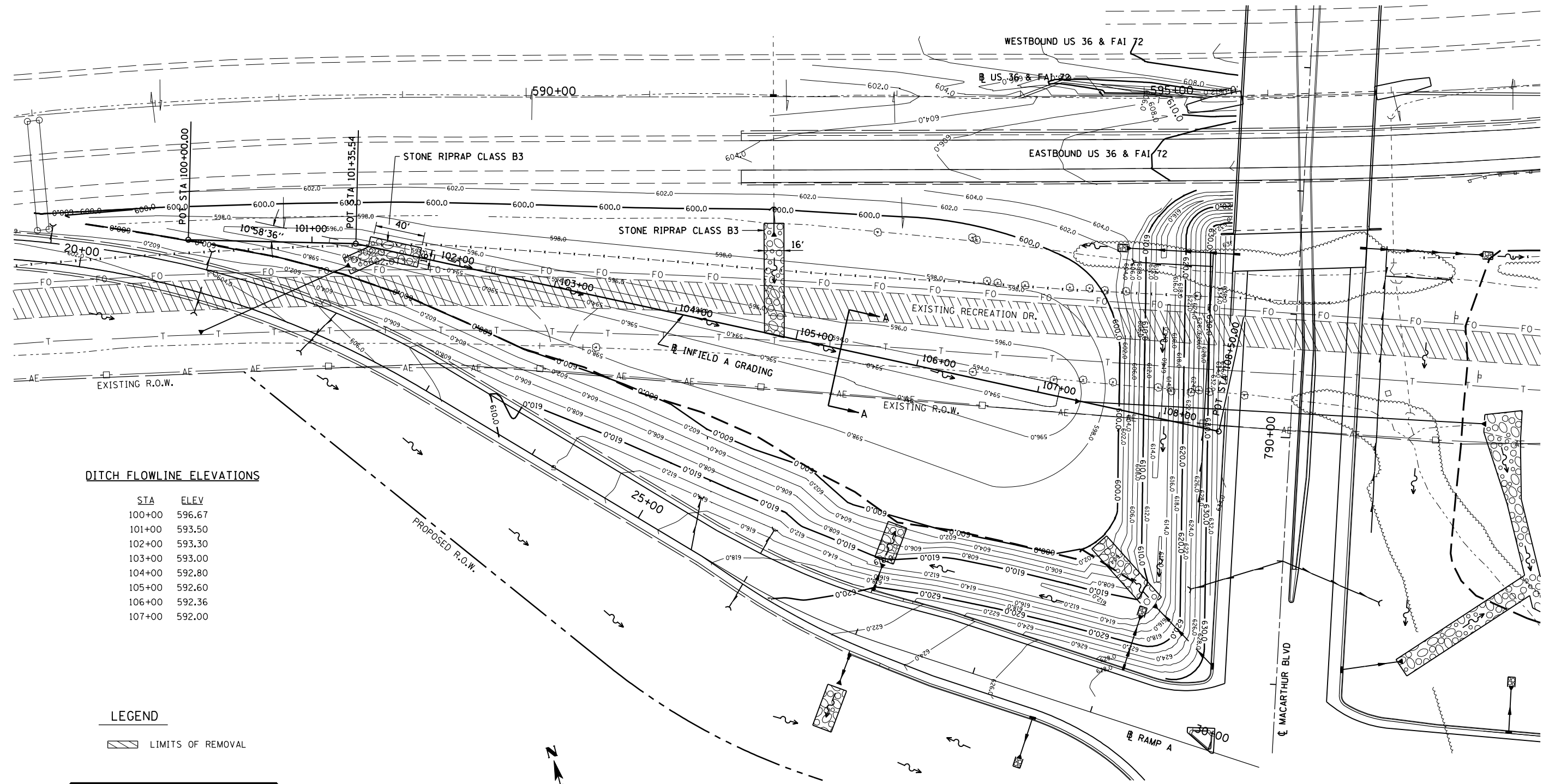
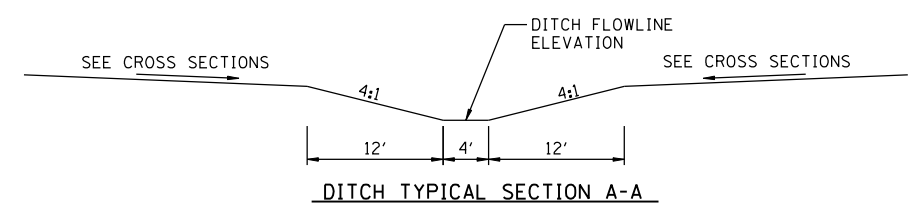

**DITCH FLOWLINE ELEVATIONS**

STA	ELEV
100+00	596.67
101+00	593.50
102+00	593.30
103+00	593.00
104+00	592.80
105+00	592.60
106+00	592.36
107+00	592.00

**LEGEND**

▨ LIMITS OF REMOVAL

INFIELD CONTROL POINTS		
STATION	NORTHING	EASTING
100+00.00	1120052.35	2434698.02
101+35.54	1120014.31	2434828.11
108+50.00	1119686.91	2435463.14



ELEVATION 600.00 INDICATES THE CROSS SECTION SHEAR LINE FOR MACARTHUR BLVD, RAMP A, I-72, AND INFIELD AREA A.

REVISIONS	
NAME	DATE

ILLINOIS DEPARTMENT OF TRANSPORTATION  
**INFIELD AREA A**  
 FAI-72, MACARTHUR BLVD.  
 SEC NO. (84-9-4)A,HBK,BY,BY-1  
 SANGAMON COUNTY, ILLINOIS

SCALE: VERT. 1"=20'  
 HORIZ. 1"=40'  
 DATE: 12/16/2006

DRAWN BY: DJP  
 CHECKED BY: JWM



12/16/2006  
 \$FILES  
 LAYOUT: DJP 08/05/06  
 DRAWN: DJP 08/05/06  
 REVIEWED: JMW 08/05/06