

FED. ROUTE	SECTION	COUNTY	TOTAL SHEETS	SHEET NO.
8071	#	SANGAMON	559	200a
STA. TO STA.		ILLINOIS FED. AID PROJECT		
FED. ROAD DIST. NO.		184-9-41A,HBK,BY,BY-1 # 02-00382-02-PV		

EXISTING STRUCTURES

Sta. 608+52.01 F.A.I. 72
 Over Recreation Drive and U.P. Railroad
 Dual 4-Span Continuous non-composite steel stringer structure. Constructed in 1956.
 Length of W.B. Structure = 238'-1 3/4" and Length of E.B. Structure = 236'-1 1/8" Bk. to Bk.
 Abutments along E. of Roadway. Both E.B. and W.B. Structures are 36'-0" wide. Substructure consists of 6 reinforced concrete piers on steel piles and 4 reinforced concrete Abutments supported on steel piles. Structure No. 084-0074 Eastbound, Structure No. 084-0075 Westbound.

TEMPORARY HMA OVERLAY

1 OF 3

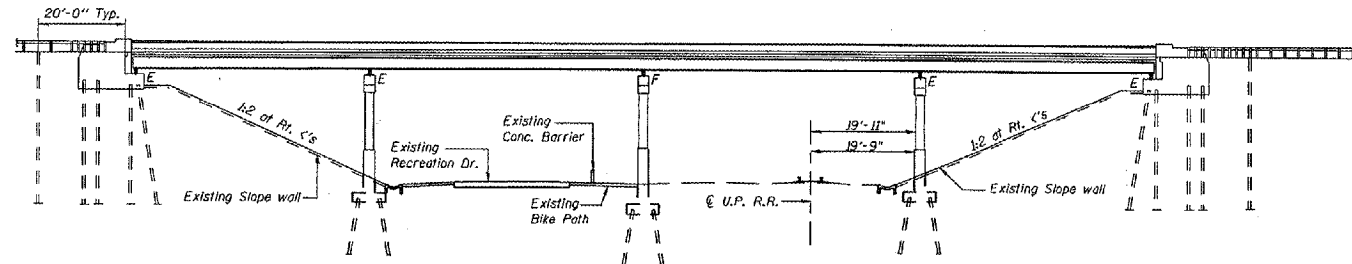

ELEVATION

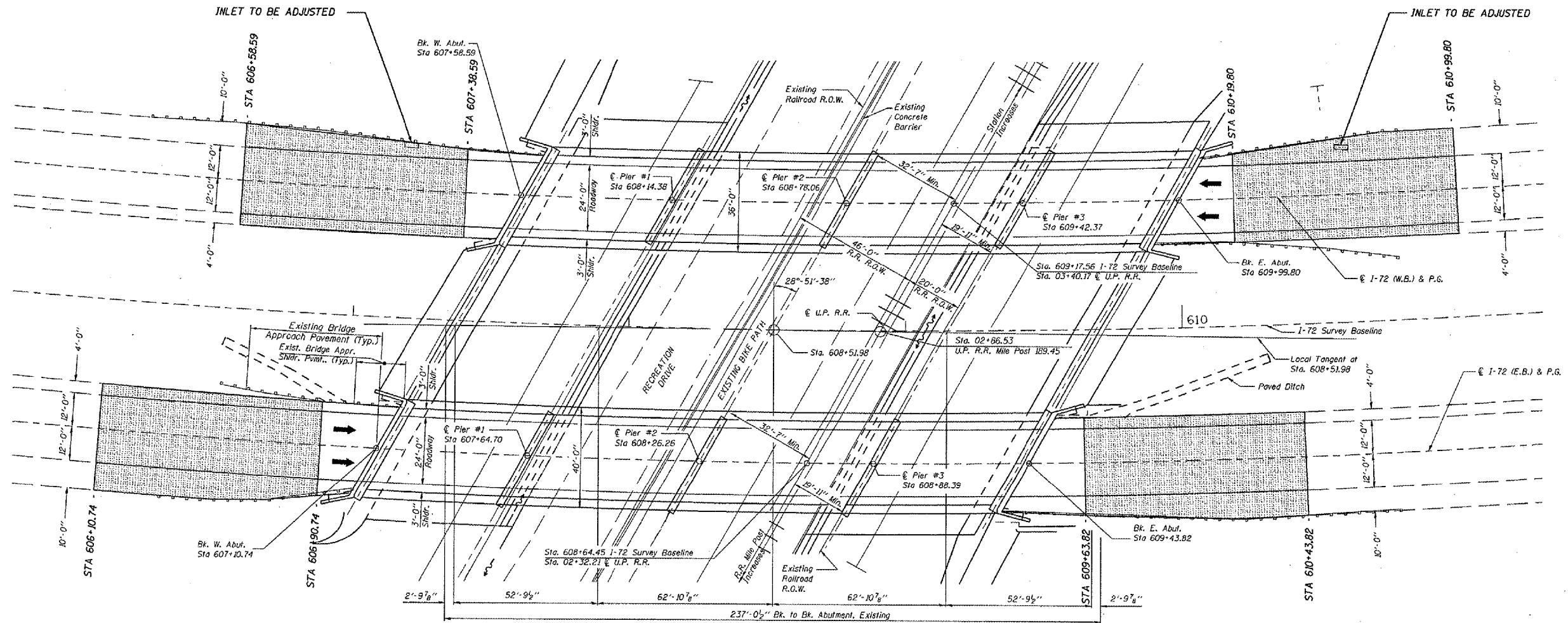
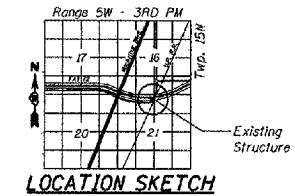

PLAN

HOT-MIX ASPHALT SURFACE REMOVAL - BUTT JOINT
 WB STA 606+58.59 TO STA 607+38.59
 WB STA 610+19.80 TO STA 610+99.80
 EB STA 606+10.74 TO STA 606+90.74
 EB STA 609+63.82 TO STA 610+43.82

HOT-MIX ASPHALT SURFACE COURSE, MIX "D", N90
 WB STA 606+58.59 TO STA 610+99.80
 EB STA 606+10.74 TO STA 610+43.84

REVISIONS	
NAME	DATE

ILLINOIS DEPARTMENT OF TRANSPORTATION
 BRIDGE OVERLAY PLAN SHEETS
 STR NO. 084-0074 EB - 084-0075 WB
 SEC NO. 02-00382-02-PV
 SEC NO. (84-9-41A,HBK,BY,BY-1
 SANGAMON COUNTY, ILLINOIS

SCALE: VERT. DRAWN BY
 HORIZ. CHECKED BY
 DATE

PLOT DATE = 1/25/2007
 FILE NAME = c:\pvs\pvs14653882\hansen_1\m12\addendum.dgn
 PLOT SCALE = 1/8"=1'-0" IN.
 REFERENCE = # 48164