

ABUTMENT BILL OF MATERIAL

Bar	No.	Size	Length	Shape
h(E)	18	#5	19'-9"	—
h ₁ (E)	12	#5	7'-0"	└
h ₂ (E)	12	#5	7'-1"	└
h ₃ (E)	25	#4	11'-3"	—
h ₄ (E)	17	#4	11'-3"	—
h ₅ (E)	8	#6	21'-10"	—
h ₆ (E)	3	#5	24'-10"	—
h ₇ (E)	3	#5	6'-2"	—
n(E)	20	#6	13'-8"	—
n ₁ (E)	12	#6	6'-10"	—
p(E)	16	#8	24'-0"	—
p ₁ (E)	6	#7	13'-0"	—
p ₂ (E)	3	#7	13'-0"	—
p ₃ (E)	3	#7	11'-4"	—
s(E)	44	#5	16'-1"	—
s ₁ (E)	24	#4	9'-5"	—
u(E)	4	#6	9'-5"	—
u ₁ (E)	4	#6	8'-10"	—
u ₂ (E)	27	#4	9'-9"	—
v(E)	86	#5	6'-0"	—
v ₁ (E)	43	#4	3'-1"	—
v ₂ (E)	24	#6	6'-9"	—
v ₃ (E)	6	#6	6'-9"	—
v ₄ (E)	20	#6	6'-9"	—
v ₅ (E)	43	#5	2'-10"	—
Structure Excavation		Cu. Yd.	136	
Concrete Structures		Cu. Yd.	53.9	
Reinforcement Bars, Epoxy Coated		Pound	5520	
Furnishing Steel Piles HP10x57		Foot	490	
Driving Piles		Foot	490	
Test Piles Steel HP10x57		Each	1	

Notes:
Reinforcement bars designated (E) shall be epoxy coated.
For details of Bar Splicers, see sheet 20 of 22.
Conduit is embedded in the South Wing. For details see Conduit Details sheet in the Roadway Plans

MIN. BAR LAPS

- #4 Bar - 1'-8"
- #5 Bar - 2'-2"
- #6 Bar - 2'-7"
- #7 Bar - 3'-5"
- #8 Bar - 4'-6"

Corporate License Number 184-001-084

WEST ABUTMENT
I-72/MACARTHUR BLVD. RAMP B OVER UPRR
SECTION (84-9-4)A, HBK, BY, BY-1
SANGAMON COUNTY
STATION 33+95.61
STRUCTURE NUMBER 084-0514

© Copyright Hanson Professional Services Inc. \$MS_YEAR\$



96S2002B

DATE: 11/16/05

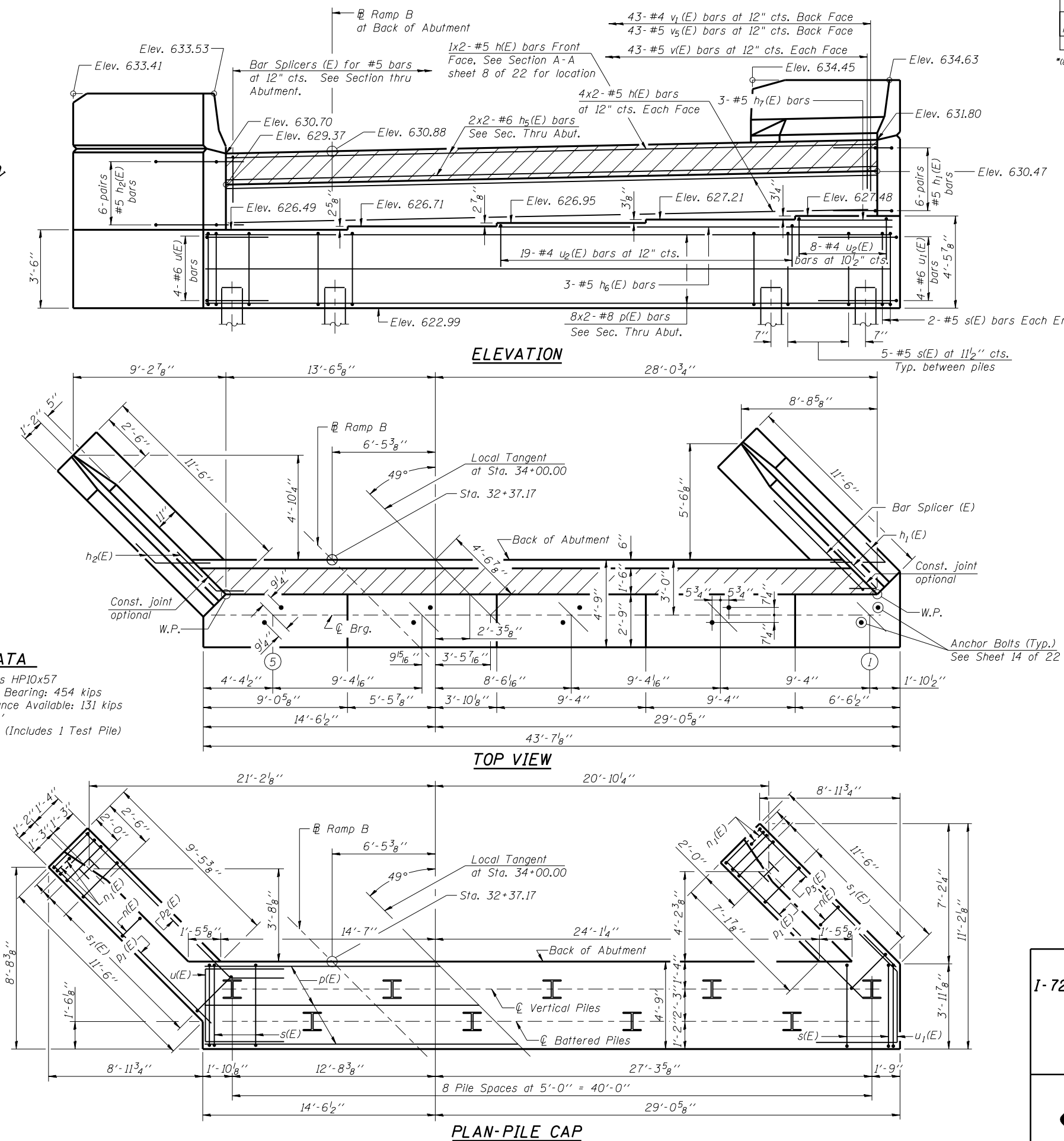

PILE DATA
Type: Steel Piles HP10x57
Nominal Required Bearing: 454 kips
Allowable Resistance Available: 131 kips
Est. Length: 49'
No. Required: 11 (Includes 1 Test Pile)

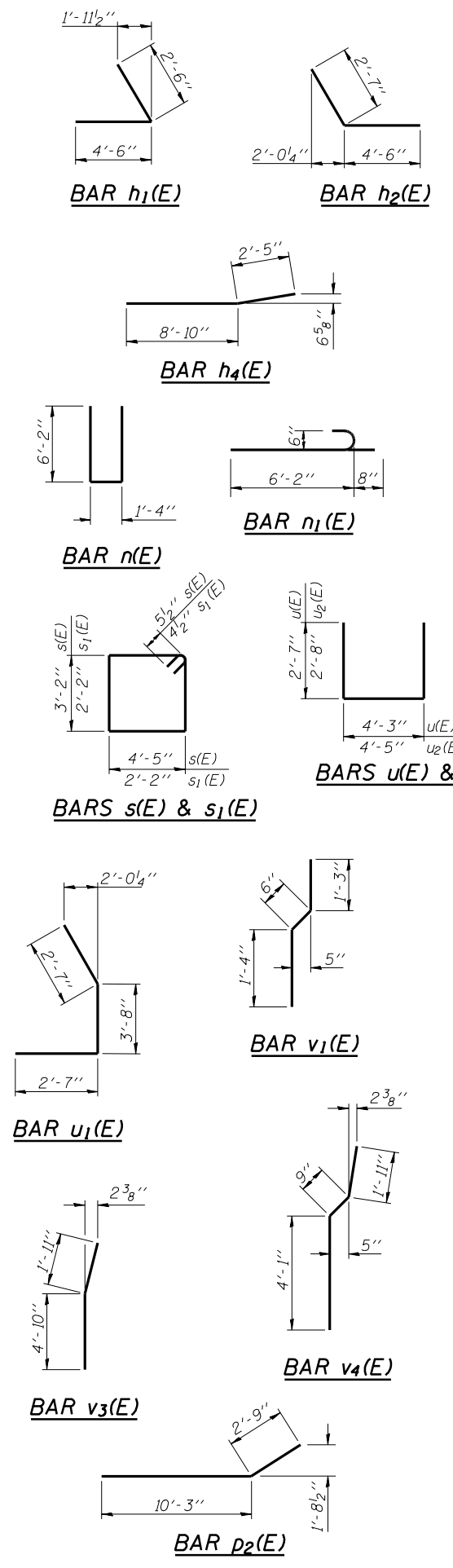

LAYOUT	MM	06/27/03
DRAWN	DAP	01/04/05
REVIEWED	JMM	02/24/05

\$FILE\$ 12/16/2006