

ANCHOR BOLT LAYOUT DIMENSIONS

Beam No.	A	B
1	6 ⁷ / ₁₆ "	6 ⁵ / ₈ "
2	6 ⁷ / ₁₆ "	6 ⁵ / ₈ "
3	6 ⁷ / ₁₆ "	6 ⁵ / ₈ "
4	6 ⁷ / ₁₆ "	6 ¹¹ / ₁₆ "
5	6 ⁷ / ₁₆ "	6 ¹¹ / ₁₆ "

ABUTMENT BILL OF MATERIAL

Bar No.	Size	Length	Shape
h(E)	18	#5 19'-9"	—
h ₃ (E)	25	#4 11'-3"	—
h ₄ (E)	17	#4 11'-3"	—
h ₅ (E)	8	#6 21'-10"	—
h ₈ (E)	12	#5 7'-0"	—
h ₉ (E)	12	#5 7'-1"	—
h ₁₀ (E)	3	#5 24'-8"	—
h ₁₁ (E)	3	#5 8'-0"	—
n(E)	20	#6 13'-4"	—
n ₁ (E)	12	#6 6'-10"	—
p(E)	16	#8 24'-0"	—
p ₁ (E)	6	#7 13'-0"	—
p ₃ (E)	3	#7 11'-4"	—
p ₄ (E)	3	#7 13'-1"	—
s(E)	43	#5 16'-1"	—
s ₁ (E)	26	#4 9'-5"	—
u(E)	4	#6 9'-5"	—
u ₂ (E)	26	#4 9'-9"	—
u ₃ (E)	4	#6 8'-9"	—
v(E)	76	#5 6'-0"	—
v ₁ (E)	38	#4 3'-1"	—
v ₂ (E)	24	#6 6'-9"	—
v ₃ (E)	6	#6 6'-9"	—
v ₄ (E)	20	#6 6'-9"	—
v ₅ (E)	38	#5 2'-10"	—
Structure Excavation	Cu. Yd.	128	
Concrete Structures	Cu. Yd.	50.1	
Reinforcement Bars, Epoxy Coated	Pound	5420	
Furnishing Steel Piles HP10x57	Foot	450	
Driving Piles	Foot	450	
Test Piles Steel HP10x57	Each	1	

Notes:
 Reinforcement bars designated (E) shall be epoxy coated.
 Conduit is embedded in the South Wing. For details see Conduit Details sheet in the Roadway Plans
 Corporate License Number 184-001-084

EAST ABUTMENT
I-72/MACARTHUR BLVD. RAMP B OVER UPRR
SECTION (84-9-4)A, HBK, BY, BY-1
SANGAMON COUNTY
STATION 33+95.61
STRUCTURE NUMBER 084-0514

© Copyright Hanson Professional Services Inc. \$MS_YEAR\$



96S2002B
 DATE: 11/16/05

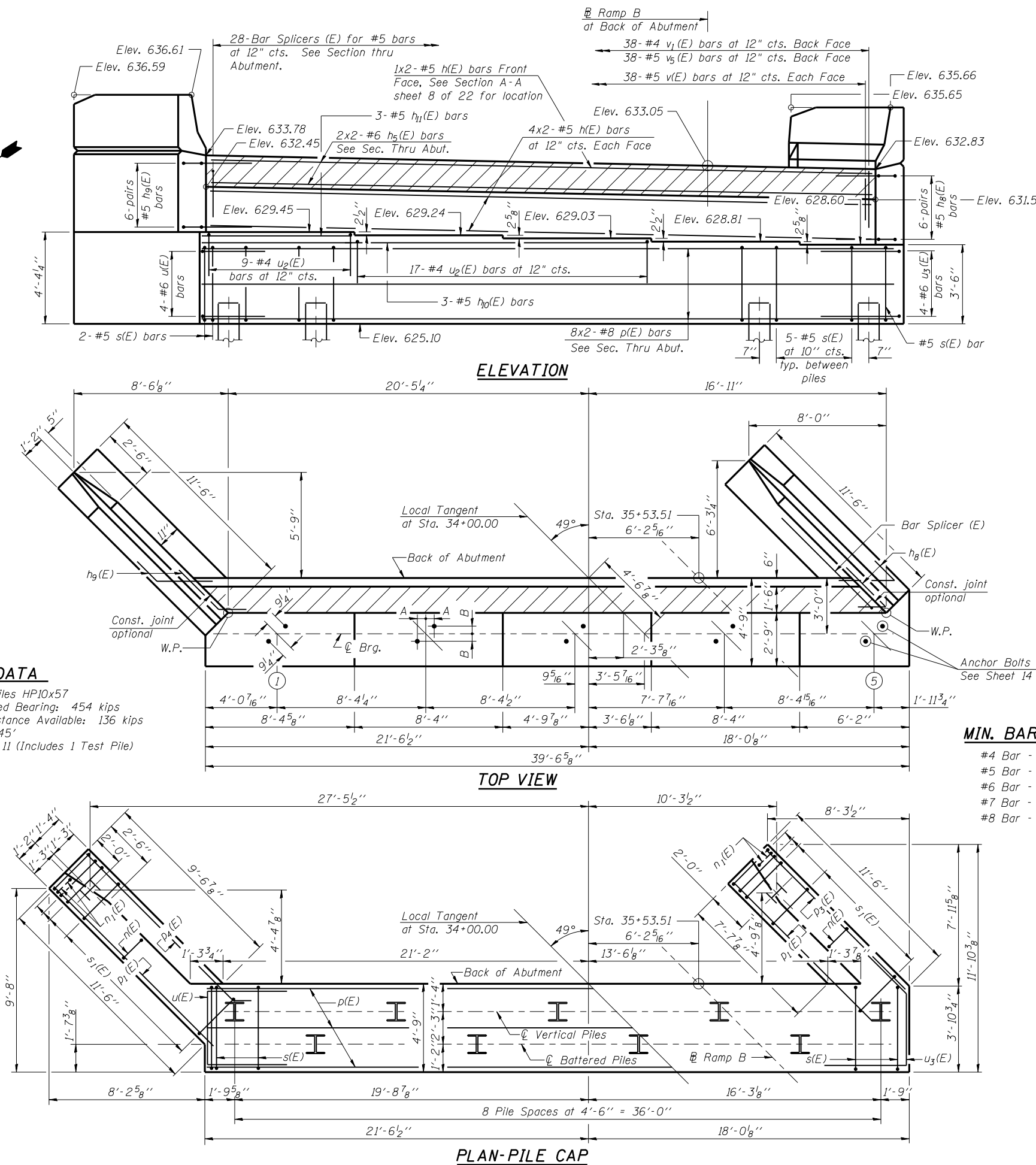

PILE DATA
 Type: Steel Piles HP10x57
 Nominal Required Bearing: 454 kips
 Allowable Resistance Available: 136 kips
 Est. Length: 45'
 No. Required: 11 (Includes 1 Test Pile)

MIN. BAR LAPS
 #4 Bar - 1'-8"
 #5 Bar - 2'-2"
 #6 Bar - 2'-7"
 #7 Bar - 3'-5"
 #8 Bar - 4'-6"

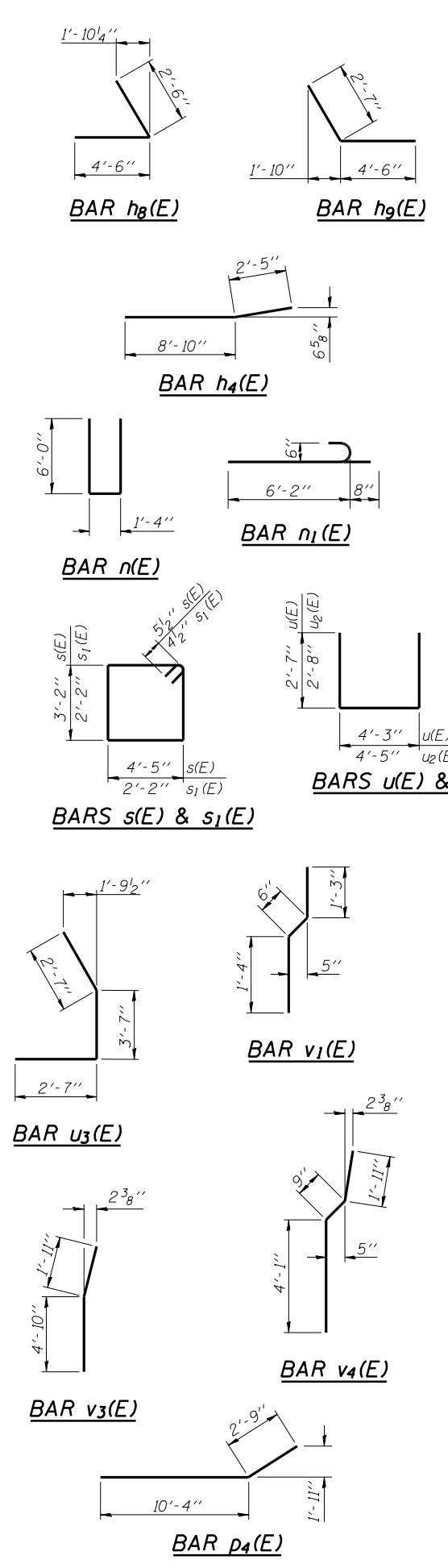

LAYOUT	MM	06/27/03
DRAWN	DAP	01/04/05
REVIEWED	JMM	02/24/05

\$FILES\$
 12/16/2006