

Bench Marks:
 IDOT BM #15 Chiseled square at the southeast quadrant of the intersection of West Grand Avenue and Hazel Dell Road. Benchmark is located 33 feet south of the centerline of Hazel Dell Road on a headwall of a concrete pipe culvert. NAVD88 El. 602.47
 IDOT BM #80 Chiseled cross on the center bolt of the east leg of an iron sign truss over the eastbound lane of Interstate 72. Benchmark is located 1.62 miles east of Il Route 4. NAVD88 El. 601.28
 IDOT BM #0150 Disk in monument vault on survey calibration baseline. Benchmark is located 13 feet north of the centerline of Hazel Dell Road and 0.5 miles west of the intersection of Hazel Dell Road and West Grand Avenue. NAVD88 El. 600.47
 IDOT BM #374 Railroad spike in power pole west of a bike path and southeast of Recreation Drive. Benchmark is located 0.81 miles south of the intersection of West Grand Avenue and Hazel Dell Road. NAVD88 El. 604.61

Existing Structure: None

Note: Piers designed to meet AREMA crashwall criteria

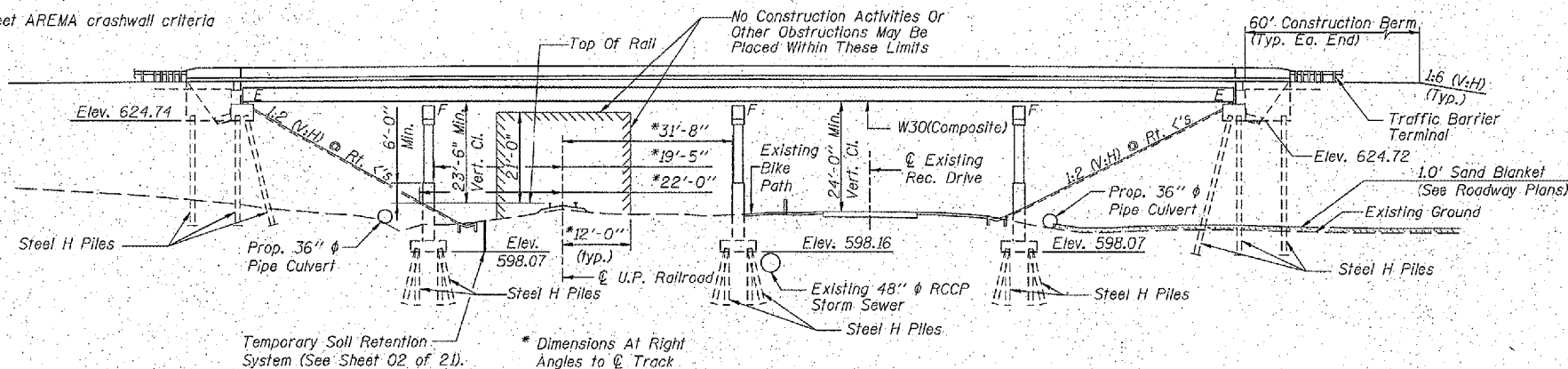

CURVE DATA

(Curve Ramp-C)
 P.I. STA= 46+29.22
 Δ = 34° 38' 10" (Rt.)
 D= 03° 01' 55"
 R= 1,889.69'
 T= 589.23'
 L= 1,142.35'
 E= 89.73'
 P.C. STA= 40+40.00
 P.T. STA= 51+82.35
 e= 5.23%

DESIGN SPECIFICATIONS

AASHTO 2002
 AASHTO 2003 Curved Girder Spec.

LOADING HS20-44

Allow 50 psf for future wearing surface.

SEISMIC DATA

Seismic Performance Category (SPC) = A
 Bedrock Acceleration Coefficient (A) = 0.05g
 Site Coefficient (S) = 2.0

DESIGN STRESSES

FIELD UNITS

f'_c = 3,500 psi
 f_y = 60,000 psi (reinf.)
 f_y = 50,000 psi (M270 Grade 50)

APPROVED
 FOR STRUCTURAL ADEQUACY ONLY

Robert E. Anderson
 ENGINEER OF BRIDGES AND STRUCTURES

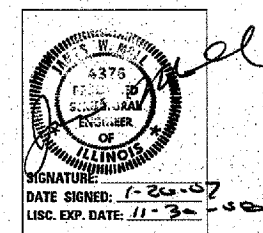
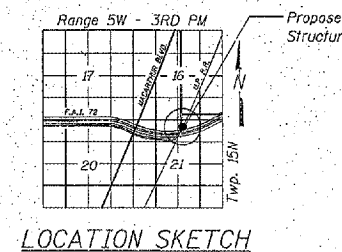
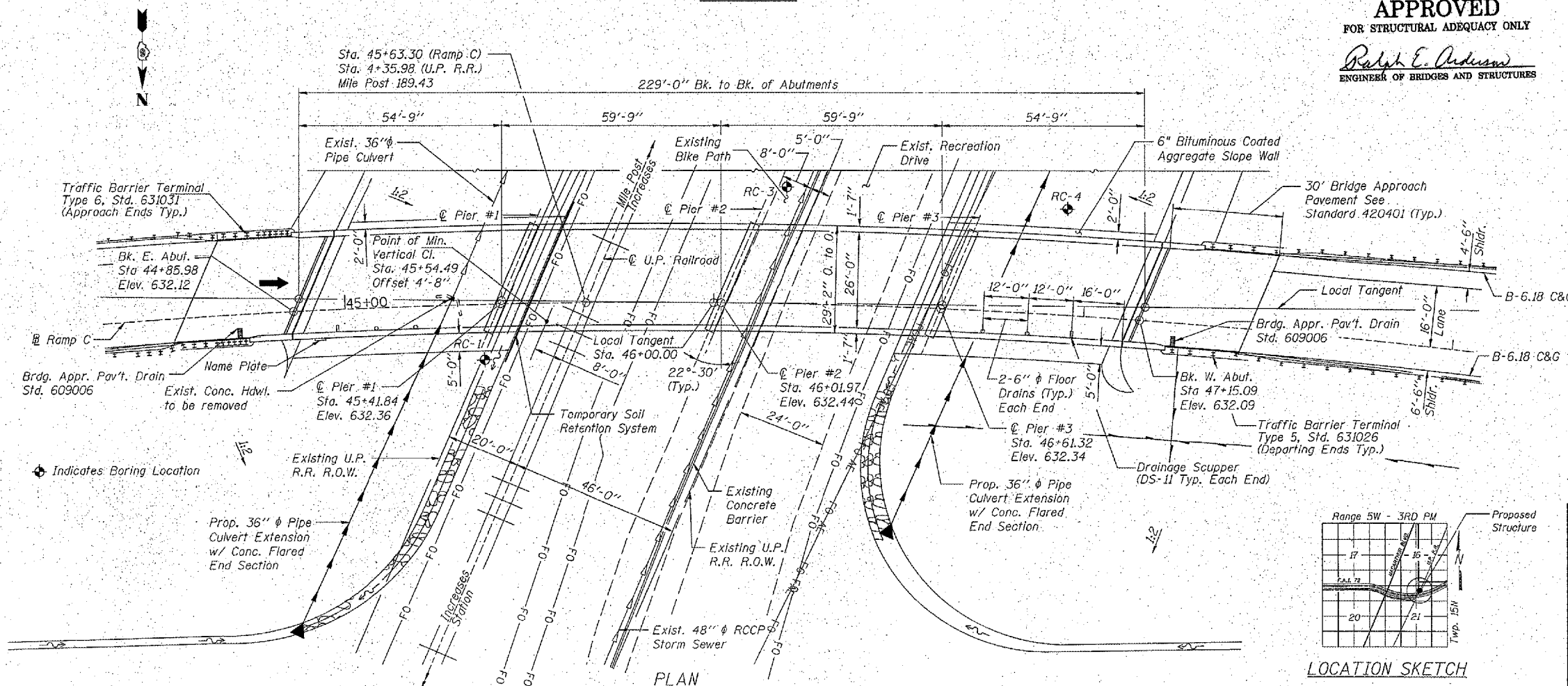

Corporate License Number 184-001-084

GENERAL PLAN AND ELEVATION
 I-72/MACARTHUR BLVD. RAMP C OVER UPRR
 SECTION (84-9-4)A, HKB, BY, BY-1
 SANGAMON COUNTY
 STATION 46+01.97
 STRUCTURE NUMBER 084-0516

© Copyright Hanson Professional Services Inc. 2007

HANSON

96S2002B
 DATE: 11/16/05

LAYOUT	MANV	06/27/03
DRAWN	DAP	01/04/05
REVIEWED	JMM	02/21/05

I:\96\085\566\202A\Struct\SHN_084-0516.dwg
01/25/2007