

CONTRACT NO. 72693

F.A.P. RTE.	SECTION	COUNTY	TOTAL SHEETS	SHEET NO.
777	405RS-8	MONTGOMERY	75	38
STA. 295+00.00		TO STA. 307+00.00		
FED. ROAD DIST. NO.		ILLINOIS FED. AID PROJECT		

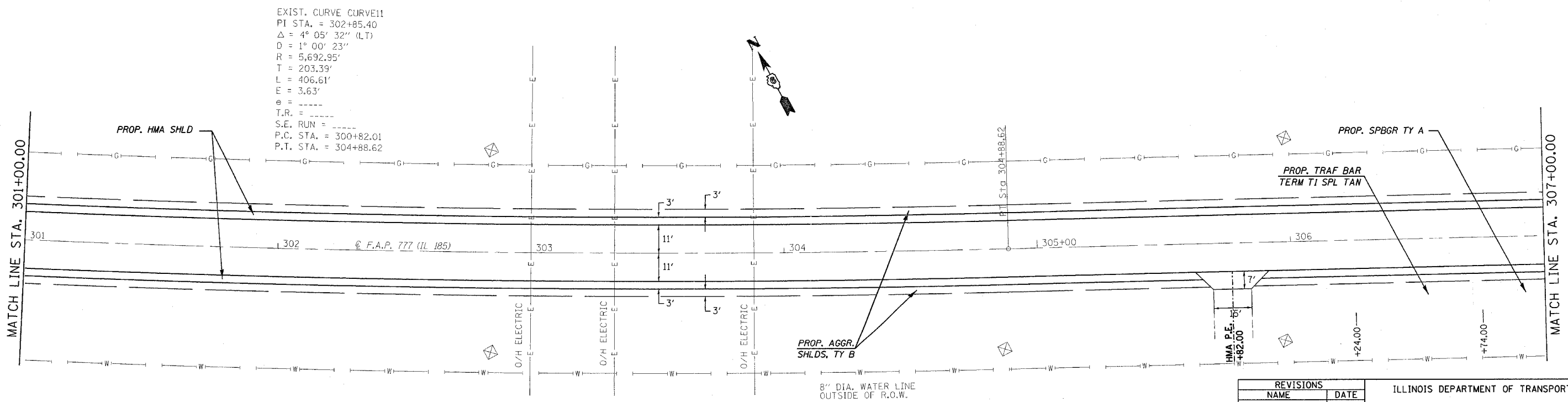
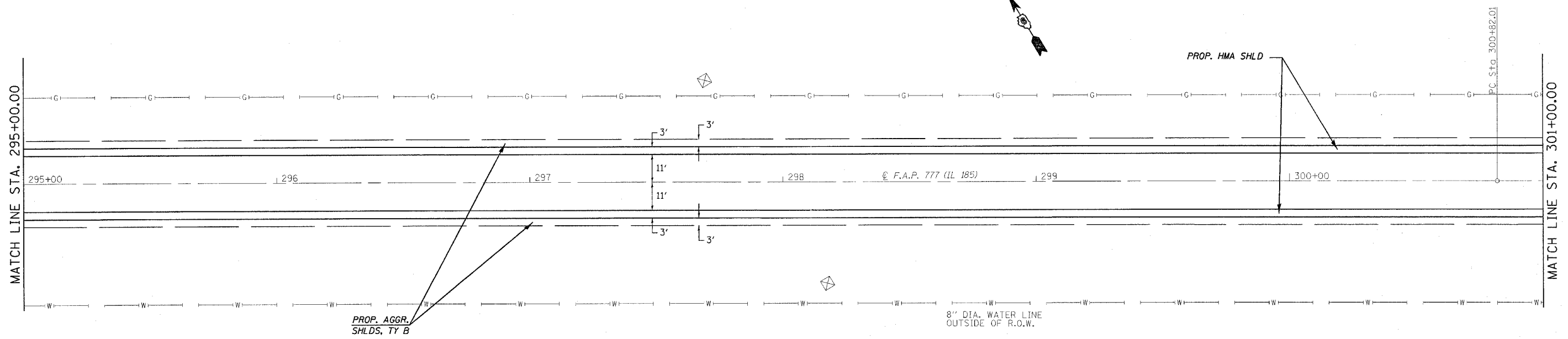

EXIST. CURVE CURVE11
 PI STA. = 302+85.40
 $\Delta = 4^\circ 05' 32''$ (LT)
 $D = 1^\circ 00' 23''$
 $R = 5,692.95'$
 $T = 203.39'$
 $L = 406.61'$
 $E = 3.63'$
 $e = \text{---}$
 $T.R. = \text{---}$
 $S.E. \text{ RUN} = \text{---}$
 $P.C. \text{ STA.} = 300+82.01$
 $P.T. \text{ STA.} = 304+88.62$

REVISIONS	
NAME	DATE

ILLINOIS DEPARTMENT OF TRANSPORTATION
PLAN VIEW
 F.A.U. Route 777 (IL 185)
 Section 405RS-4
 MONTGOMERY COUNTY
 SCALE: VERT. _____
 HORIZ. _____
 DATE: FEBRUARY 22, 2006
 DRAWN BY: JWC
 CHECKED BY: RSC

PLOT DATE = 12/8/2006
 FILE NAME = c:\projects\ad558802\shiplan.dgn
 PLOT SCALE = 20.0000 / IN.
 USER NAME = coxjr