

CONTRACT NO. 72693

F.A.P. RTE.	SECTION	COUNTY	TOTAL SHEETS	SHEET NO.
777	405RS-8	MONTGOMERY	75	43
STA. 355+00.00 TO STA. 367+00.00				
FED. ROAD DIST. NO. ILLINOIS FED. AID PROJECT				

EXIST. CURVE CURVE14
 PI STA. = 359+91.20
 $\Delta = 4^\circ 05' 00''$ (RT)
 $D = 1^\circ 00' 01''$
 $R = 5,727.81'$
 $T = 204.19'$
 $L = 408.21'$
 $E = 3.64'$
 $e =$
 $T.R. =$
 $S.E. RUN =$
 $P.C. STA. = 357+87.01$
 $P.T. STA. = 361+95.22$

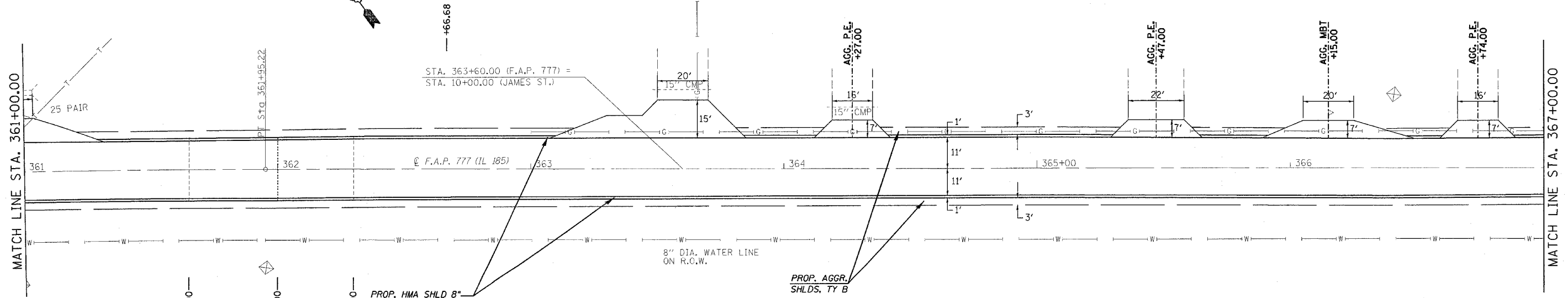
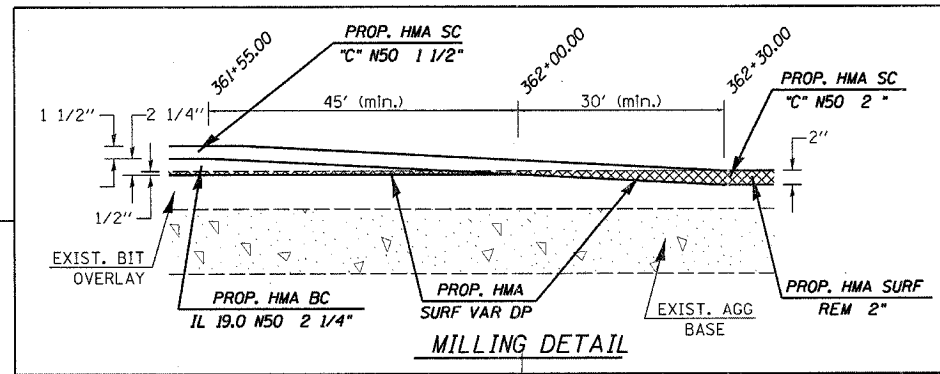
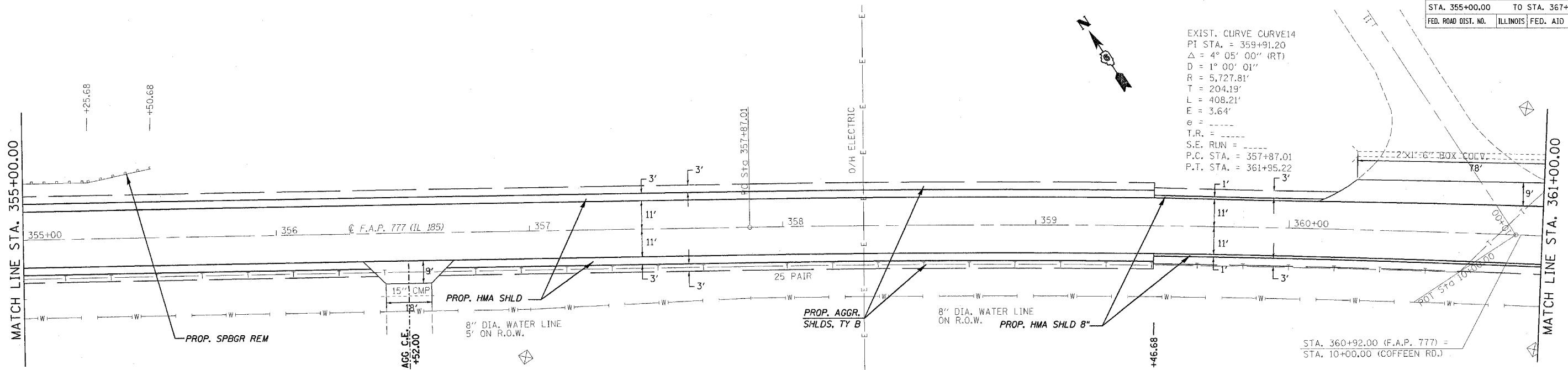

REVISIONS	
NAME	DATE

ILLINOIS DEPARTMENT OF TRANSPORTATION
PLAN VIEW
 F.A.U. Route 777 (IL 185)
 Section 405RS-4
 MONTGOMERY COUNTY
 SCALE: VERT. _____
 HORIZ. _____
 DATE: FEBRUARY 22, 2006
 DRAWN BY: JWC
 CHECKED BY: RSC

PLOT DATE = 12/8/2006
 FILE NAME = c:\projects\4656802\shiplan1.dgn
 PLOT SCALE = 20.0000 / IN.
 USER NAME = cckjw