

CONTRACT NO. 72693

F.A.P. RTE.	SECTION	COUNTY	TOTAL SHEETS	SHEET NO.
777	405RS-8	MONTGOMERY	75	44
STA. 367+00.00		TO STA. 379+00.00		
FED. ROAD DIST. NO.		ILLINOIS FED. AID PROJECT		

EXIST. CURVE CURVE15  
 PI STA. = 368+60.08  
 $\Delta = 2^\circ 16' 00''$  (LT)  
 $D = 1^\circ 00' 00''$   
 $R = 5,729.67'$   
 $T = 113.35'$   
 $L = 226.67'$   
 $E = 1.12'$   
 $\epsilon = \text{---}$   
 $T.R. = \text{---}$   
 $S.E. RUN = \text{---}$   
 $P.C. STA. = 367+46.73$   
 $P.T. STA. = 369+73.40$

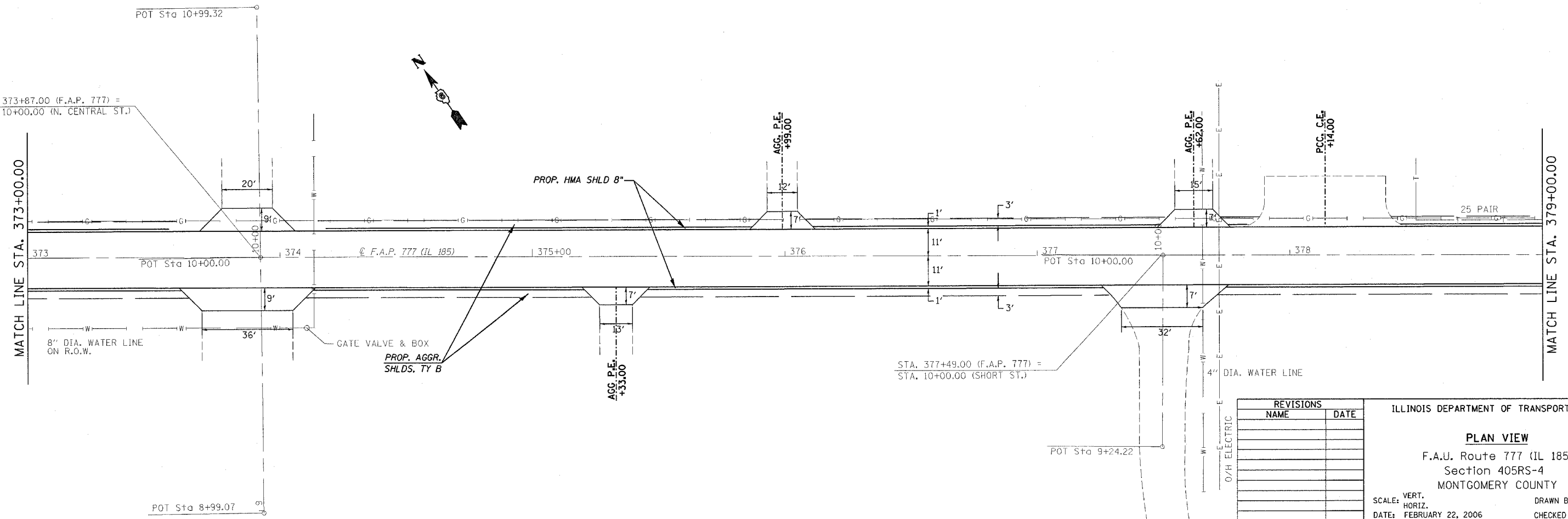
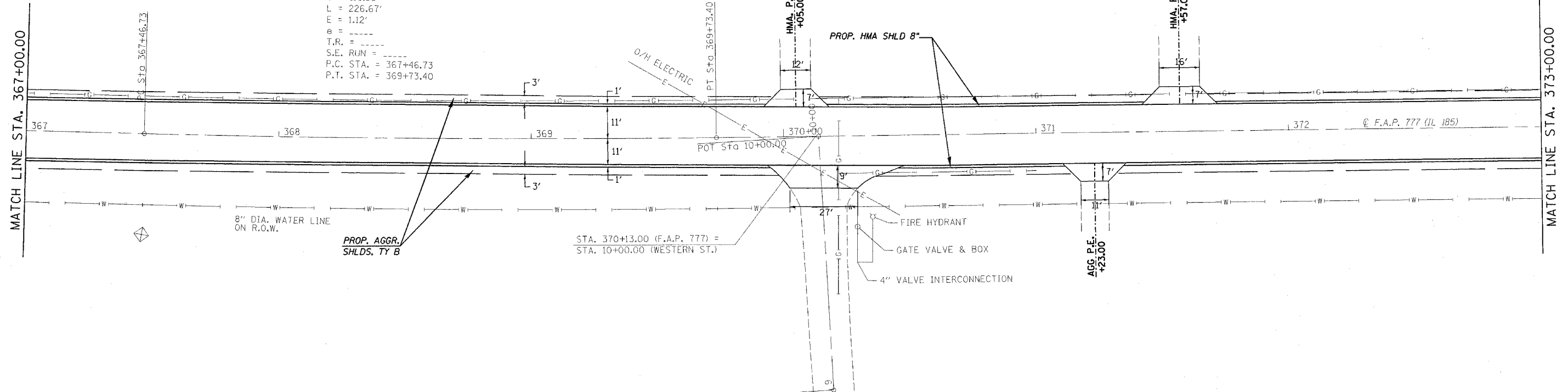

REVISIONS	
NAME	DATE

ILLINOIS DEPARTMENT OF TRANSPORTATION  
**PLAN VIEW**  
 F.A.U. Route 777 (IL 185)  
 Section 405RS-4  
 MONTGOMERY COUNTY  
 SCALE: VERT. \_\_\_\_\_  
 HORIZ. \_\_\_\_\_  
 DATE: FEBRUARY 22, 2006  
 DRAWN BY: JWC  
 CHECKED BY: RSC

PLOT DATE = 12/29/2005  
 FILE NAME = S:\projects\0656802\shiplan1.dgn  
 PLOT SCALE = 5/8" = 1'-0"  
 USER NAME = rsc