

F.A.P. RTE.	SECTION	COUNTY	TOTAL SHEETS	SHEET NO.
75	.	CHRISTIAN	97	1

D 6 RESURFACING 2007

STATE OF ILLINOIS  
DEPARTMENT OF TRANSPORTATION  
DIVISION OF HIGHWAYS

**PROPOSED  
HIGHWAY PLANS**

FAP ROUTE 75 (IL 29)  
SECTION D 6 RESURFACING 2007  
PROJECT: F-0075(154)  
CHRISTIAN COUNTY  
C-96-525-07

INDEX OF SHEETS

COVER SHEET	1
GENERAL NOTES	2
SUMMARY OF QUANTITIES	3-4
TYPICAL SECTIONS	5-26
SCHEDULES OF QUANTITIES	27-38
CROSS TIES	39
PLAN/PAVEMENT MARKING SHEETS	40-75 <b>B.</b>
BRIDGE PLAN SHEETS	76-79
STORM SEWER PLAN SHEET	80
STORM SEWER TRAFFIC CONTROL PLAN	81
CURB REPAIR DETAILS	82
BUTT JOINT DETAILS	83
SOIL BORINGS	84-85
TRAFFIC SIGNAL SHEETS	86-94
SIDEROAD AND ENTRANCE DETAILS	95-97

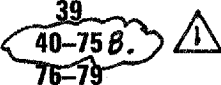

LIST OF ILLINOIS D.O.T. STANDARDS

000001-04	701001-01	701602-02
280001-03	701006-02	701606-04
442201-02	701201-02	701701-04
482006-02	701301-02	702001-06
602401-01	701306-01	780001-01
602701-01	701311-02	781001-02
604001-02	701326-02	886001
606001-03	701336-04	886006
606301-03	701501-03	BLR 22-4
630001-07	701502-01	

SECTION BEGINS  
STA 520+72.00

STORM SEWER  
IMPROVEMENTS  
SE OF IL 29  
@ THE NORFOLK  
SOUTHERN RR  
VIADUCT

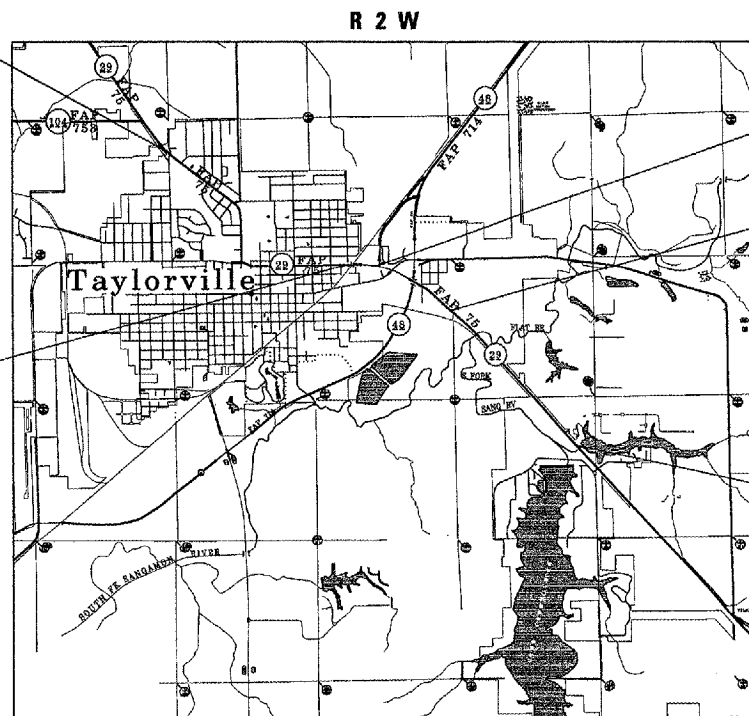

STA EQ 87+81.23 BK =  
STA 7+18.82 AH

STA EQ 41+98.04 BK =  
STA 42+39.60 AH

STA EQ 58+66.00 BK =  
STA 58+70.03 AH

SECTION ENDS  
STA 206+47.00

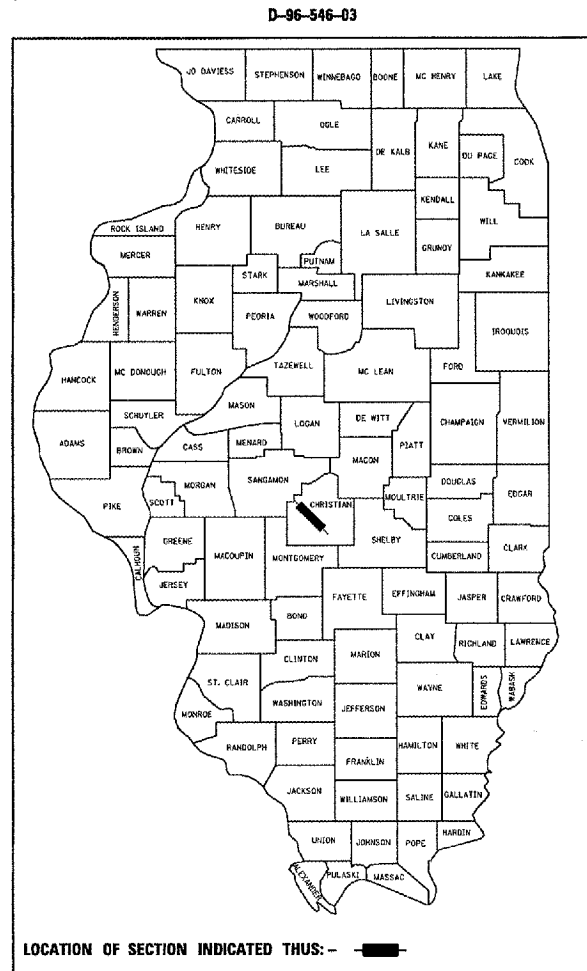

	SECTION A	SECTION B
ADT =	13,350	6,500

STATE OF ILLINOIS  
DEPARTMENT OF TRANSPORTATION  
DIVISION OF HIGHWAYS

SUBMITTED *12/15/06*  
*Chris M. Paul*  
DEPUTY DIRECTOR OF HIGHWAYS, REGION ENGINEER

*Eric E. Stan*  
ENGINEER OF DESIGN AND ENVIRONMENT

*Milton R. Sees, P.E.*  
DIRECTOR OF HIGHWAYS, CHIEF ENGINEER

PRINTED BY THE AUTHORITY  
OF THE STATE OF ILLINOIS

GROSS LENGTH OF PROJECT = 30,207.90 FEET = 5.72 MILES  
NET LENGTH OF PROJECT = 30,207.90 FEET = 5.72 MILES

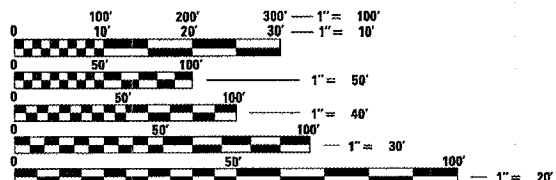

FULL SIZE PLANS HAVE BEEN PREPARED USING STANDARD  
ENGINEERING SCALES. REDUCED SIZED PLANS WILL NOT  
CONFORM TO STANDARD SCALES. IN MAKING MEASUREMENTS  
ON REDUCED PLANS, THE ABOVE SCALES MAY BE USED.

J.U.L.I.E.  
JOINT UTILITY LOCATION INFORMATION FOR EXCAVATION  
1-800-892-0123

CONTRACT NO. 72826

Rev. 2 - 22-07

Rev.

PROJECT ENGINEER: SAL MADONIA (217)782-4761  
SQUAD LEADER: JEFF MYERS (217) 524-7940

F.A.P. RTE.	SECTION	COUNTY	TOTAL SHEETS	SHEET NO.
75	•	CHRISTIAN	97	3
STA.		TO STA.		
FED. ROAD DIST. NO.		ILLINOIS	FED. AID PROJECT	

• D 6 RESURFACING 2007

ILLINOIS DEPARTMENT OF TRANSPORTATION  
SUMMARY OF QUANTITIES

LOCATION OF WORK			80% FED. 20% STATE	IL 29: CHENEY TO IL 48  URBAN	IL 29: IL 48 TO KENNEDY, LAKE TO VELMA RD  RURAL	IL 29: KENNEDY TO LAKE  RURAL	SN 011-0010: IL 29 OVER IL 48  RURAL	SN 011-0011: IL 29 OVER FLAT BRANCH  RURAL	STORM SEWER IMPROVMENTS  URBAN
SUMMARY OF QUANTITIES			CONSTRUCTION TYPE CODE						
CODE NO.	ITEM	UNIT	TOTAL QUANTITY	I000	I000	I000	SFTY-2A	SFTY-2A	Y007
20200500	EARTH EXCAVATION (WIDENING)	CU YD	1715		1715				
25001000	SEEDING, CLASS 2 (SPECIAL)	ACRE	0.21						0.21
40600200	BITUMINOUS MATERIALS (PRIME COAT)	TON	44	24.7	12.3		0.3	0.3	
40600300	AGGREGATE (PRIME COAT)	TON	231	130	65		1	1	
40600635	LEVELING BINDER (MACHINE METHOD), N70	TON	1852		1332				
40600895	CONSTRUCTING TEST STRIP	EACH	1	1					
40600982	HOT-MIX ASPHALT SURFACE REMOVAL- BUTT JOINT	SO YD	2286		989				
40600990	TEMPORARY RAMP	SO YD	1060	723	294				
40603540	POLYMERIZED HOT-MIX ASPHALT SURFACE COURSE, MIX "D", N70	TON	10,712	6914	2664		46.24	47.6	
40800050	INCIDENTAL HOT-MIX ASPHALT SURFACING	TON	490	325	56				
44000152 44000157	HOT-MIX ASPHALT SURFACE REMOVAL 3/4" HOT-MIX ASPHALT SURFACE REMOVAL 2"	SA YD SO YD	1337.3 65,002				660	677	
44000198	HOT-MIX ASPHALT SURFACE REMOVAL (VARIABLE DEPTH)	SO YD	47,128		31,526				
44002020	CONCRETE MEDIAN SURFACE REMOVAL	SO FT	625	625					
44200144	PAVEMENT PATCHING, TYPE II, 12 INCH	SO YD	1,395	815	580				
44200148	PAVEMENT PATCHING, TYPE III, 12 INCH	SO YD	640	325	315				
44200150	PAVEMENT PATCHING, TYPE IV, 12 INCH	SO YD	675	360	315				
48101200	AGGREGATE SHOULDERS, TYPE B	TON	1588	173	731				
48203029	HOT-MIX ASPHALT SHOULDERS 8"	SO YD	7699		7699				
48203100	HOT-MIX ASPHALT SHOULDERS	TON	376						
51205200	TEMPORARY SHEET PILING	SO FT	4,000						4,000
552A1300	STORM SEWERS JACKED IN PLACE, CLASS A 36"	FOOT	221						221
60221000	MANHOLES, TYPE A, 5'-DIAMETER, TYPE I FRAME, OPEN LID	EACH	1						1
60221100	MANHOLES, TYPE A, 5'-DIAMETER, TYPE I FRAME, CLOSED LID	EACH	1						1
60255500	MANHOLES TO BE ADJUSTED	EACH	13	12					
60265700	VALVE VAULTS TO BE ADJUSTED	EACH	22	22					
60618300	CONCRETE MEDIAN SURFACE, 4 INCH	SO FT	625	625					
63300575	REMOVE AND RE-ERECT RAIL ELEMENT OF EXISTING GUARD RAIL	FOOT	6,100				1,388	4,712	
64200105	SHOULDER RUMBLE STRIPS	FOOT	29,812		15,371				14,441

PLOT DATE : 12/26/2008  
 FILE NAME : c:\p\proj\mva\resurfacing\summary.dgn  
 PLOT SCALE : 42.3589 / IN.  
 USER NAME : tanghuo1

REVISIONS	
NAME	DATE

ILLINOIS DEPARTMENT OF TRANSPORTATION  
SUMMARY OF QUANTITIES  
  
FAP 75 (IL 29)  
SECTION D 6 RESURFACING 2007  
CHRISTIAN COUNTY  
  
SCALE: VERT.  
HORIZ.  
DATE  
  
DRAWN BY  
CHECKED BY

Rev. 2-22-07

Rev.

Rev.

F.A.P. RTE.	SECTION	COUNTY	TOTAL SHEETS	SHEET NO.
75	*	CHRISTIAN	97	4
STA.		TO STA.		
FED. ROAD DIST. NO.		ILLINOIS FED. AID PROJECT		

ILLINOIS DEPARTMENT OF TRANSPORTATION  
SUMMARY OF QUANTITIES

\* D 6 RESURFACING 2007

LOCATION OF WORK			80% FED. 20% STATE	IL 29: CHENEY TO IL 48	IL 29: IL 48 TO KENNEDY, LAKE TO VELMA RD	IL 29: KENNEDY TO LAKE	SN 011-0010: IL 29 OVER IL 48	SN 011-0011: IL 29 OVER FLAT BRANCH	STORM SEWER IMPROVEMENTS
				URBAN	RURAL	RURAL	RURAL	RURAL	URBAN
SUMMARY OF QUANTITIES			CONSTRUCTION TYPE CODE						
CODE NO.	ITEM	UNIT	TOTAL QUANTITY	I000	I000	I000	SFTY-2A	SFTY-2A	Y007
67000400	ENGINEER'S FIELD OFFICE, TYPE A	CAL MO	5	5					
67100100	MOBILIZATION	L SUM	1	0.3	0.3	0.2	0.1	0.1	
70100450	TRAFFIC CONTROL AND PROTECTION, STANDARD 701201	L SUM	1	0.5	0.5				
70100460	TRAFFIC CONTROL AND PROTECTION, STANDARD 701306	L SUM	1	0.5	0.5				
70100500	TRAFFIC CONTROL AND PROTECTION, STANDARD 701326	L SUM	1		0.7	0.3			
70100600	TRAFFIC CONTROL AND PROTECTION, STANDARD 701336	L SUM	1	0.5	0.5				
70101835	TRAFFIC CONTROL AND PROTECTION, STANDARD BLR 22	L SUM	1						1
70102620	TRAFFIC CONTROL AND PROTECTION, STANDARD 701501	L SUM	1	0.4	0.6				
70102622	TRAFFIC CONTROL AND PROTECTION, STANDARD 701502	L SUM	1	1					
70102625	TRAFFIC CONTROL AND PROTECTION, STANDARD 701606	L SUM	1	1					
70102632	TRAFFIC CONTROL AND PROTECTION, STANDARD 701602	L SUM	1	1					
70102635	TRAFFIC CONTROL AND PROTECTION, STANDARD 701701	L SUM	1	1					
70103815	TRAFFIC CONTRAL SURVEILLANCE	CAL DA	8		8				
70300100	SHORT-TERM PAVEMENT MARKING	FOOT	10,825	6,495	3,820	510			
70300200	TEMPORARY PAVEMENT MARKING	FOOT	99,767	45,382	34,963	19,422			
70301000	WORK ZONE PAVEMENT MARKING REMOVAL	SO FT	1,358	696	500	162			
* 78000300	THERMOPLASTIC PAVEMENT MARKING - LINE 5"	FOOT	91,172	41,287	30,157	18,958	306.0	464.0	
* 78000400	THERMOPLASTIC PAVEMENT MARKING - LINE 6"	FOOT	477			477			
* 78000500	THERMOPLASTIC PAVEMENT MARKING - LINE 8"	FOOT	1,507	1,507					
* 78000600	THERMOPLASTIC PAVEMENT MARKING - LINE 12"	FOOT	1,397	751		646			
78003100	PREFORMED PLASTIC PAVEMENT MARKING, TYPE B - LETTERS AND SYMBOLS	SO FT	1420	1311		109			
78003120	PREFORMED PLASTIC PAVEMENT MARKING, TYPE B - LINE 5"	FOOT	940	940					
78003130	PREFORMED PLASTIC PAVEMENT MARKING, TYPE B - LINE 6"	FOOT	5861	5861					
78003180	PREFORMED PLASTIC PAVEMENT MARKING, TYPE B - LINE 24"	FOOT	722	666		56			
* 78100100	RAISED REFLECTIVE PAVEMENT MARKER	EACH	1130	725	154	251			
78300200	RAISED REFLECTIVE PAVEMENT MARKER REMOVAL	EACH	1130	725	154	251			
* 88600100	DETECTOR LOOP, TYPE I	FOOT	2,937	2,937					
X5430100	INSERTION CULVERT LINER (SPECIAL)	FOOT	258						258
XX005399	TEMPORARY SOIL RETENTION AND DEWATERING SYSTEM	L SUM	1						1
Z0012500	CONCRETE CURB REPAIR	FOOT	775	775					
Z0048665	RAILROAD PROTECTIVE LIABILITY INSURANCE	L SUM	1						1
X0325675	TEMPORARY RUBBER RAMPS FOR DRAINAGE AND UTILITY CASTINGS	EACH	35	34		1			
X0321744	SILICONE JOINT SEALER 2"	FOOT	78			48	30		
X0322932	SILICONE JOINT SEALER 1 1/2"	FOOT	78			48	30		
X0320887	POLYMER CONCRETE	CUFT	15			9.2	5.8		

\* SPECIALTY ITEMS

Rev. 2-22-07

Rev.

REVISIONS	
NAME	DATE

ILLINOIS DEPARTMENT OF TRANSPORTATION  
SUMMARY OF QUANTITIES  
FAP 75 (IL 29)  
SECTION D 6 RESURFACING 2007  
CHRISTIAN COUNTY  
SCALE: VERT. DATE  
HORIZ. DATE  
DRAWN BY  
CHECKED BY

PLT DATE: 12/20/2006  
PLT SCALE: 1"=40'  
USER NAME: jangh101



F.A.P. RTE.	SECTION	COUNTY	TOTAL SHEETS	SHEET NO.
75	*	CHRISTIAN	97	27
STA.		TO STA.		
FED. ROAD DIST. NO.		ILLINOIS FED. AID PROJECT		

\*D 6 RESURFACING 2007

LEVEL BINDER (MACHINE METHOD), N70

LOCATION	PAVEMENT WIDTH (FOOT)	PAVEMENT AREA (SQ YD)	TONS
I-29 MAINLINE			
STA 28+80.00 TO STA 41+98.04 BK	24	3,514.77	147.62
STA 42+39.60 AH TO STA 58+66.00 BK	24	4,337.07	182.16
STA 58+70.03 AH TO STA 58+79.00	24	23.92	1.00
STA 60+81.00 TO STA 100+89.78	24	10,690.08	448.98
STA 100+89.78 TO STA 102+35.45	24	388.45	16.31
STA 102+35.45 TO STA 107+29.75	26 TO 36	1,702.59	71.51
STA 107+29.75 TO STA 110+72.28	36	1,370.12	57.55
STA 110+72.28 TO STA 113+67.47	36 TO 26	1,016.77	42.70
STA 113+67.47 TO STA 119+82.61	24	1,640.37	68.90
STA 119+82.61 TO STA 124+54.86	26 TO 36	1,626.64	68.32
STA 124+54.86 TO STA 129+69.26	36	2,057.60	86.42
STA 129+69.26 TO STA 137+17.09	36 TO 26	2,575.86	106.19
STA 137+17.09 TO STA 154+00.00	24	4,487.76	188.49
STA 174+00.00 TO STA 206+47.00	24	8,658.67	363.66
TOTAL			1,851.81

HOT-MIX ASPHALT SURFACE REMOVAL (VARIABLE DEPTH)

LOCATION	PAVEMENT WIDTH (FOOT)	LT SHLD WIDTH	RT SHLD WIDTH	AREA (SQ YD)
I-29 MAINLINE				
STA 29+15.00 TO STA 41+98.04 BK	24			3,421.44
STA 42+39.60 AH TO STA 58+66.00 BK	24			4,337.07
STA 58+70.03 AH TO STA 58+79.00	24			23.92
STA 58+79.00 TO STA 60+81.00	BRIDGE OMISSION			
STA 60+81.00 TO STA 100+89.78	24			10,690.08
STA 100+89.78 TO STA 102+35.45	24	4	4	517.94
STA 102+35.45 TO STA 107+29.75	26 TO 36	4	4	2,141.97
STA 107+29.75 TO STA 110+72.28	36	4	4	1,674.59
STA 110+72.28 TO STA 113+67.47	36 TO 26	4	4	1,279.16
STA 113+67.47 TO STA 119+82.61	24	4	4	2,187.16
STA 119+82.61 TO STA 124+54.86	26 TO 36	4	4	2,046.42
STA 124+54.86 TO STA 129+69.26	36	4	4	2,514.84
STA 129+69.26 TO STA 137+17.09	36 TO 26	4	4	3,240.60
STA 137+17.09 TO STA 154+00.00	24			4,487.76
STA 174+00.00 TO STA 206+12.00	24			8,565.33
TOTAL				47,128.28

HOT-MIX ASPHALT SURFACE REMOVAL 2"

LOCATION	LENGTH (FOOT)	PAVEMENT WIDTH (FOOT)	AREA (SQ YD)
I-29 MAINLINE			
STA 520+72.00 TO STA 524+01.34	329.34	52	1,902.85
STA 524+01.34 TO STA 526+85.47	284.13	VAR	2,692.71 *
STA 526+85.47 TO STA 552+05.00	2,519.53	40	11,197.91
STA 552+05.00 TO STA 554+07.00	202.00	40 TO 48	987.56
STA 554+07.00 TO STA 564+80.00	1,073.00	48	5,722.67
STA 564+80.00 TO STA 570+17.12	537.12	48 TO 50	2,924.32
STA 570+17.12 TO STA 572+17.12	200.00	50 TO 60	1,222.22
STA 572+17.12 TO STA 577+05.51	488.39	60 TO 62	3,310.20
STA 577+05.51 TO STA 583+11.84	606.33	VAR	5,596.03 **
STA 583+11.84 TO STA 583+24.00	12.16	48	64.85
STA 47+07.92 TO STA 49+22.00	214.08	48 TO 33	963.36
STA 49+22.00 TO STA 54+22.00	500.00	33	1,833.33
STA 54+22.00 TO STA 55+37.00	115.00	33 TO 30	402.50
STA 55+37.00 TO STA 56+92.00	155.00	30 TO 21	439.17
STA 56+92.00 TO STA 59+46.00	254.00	24	677.33
STA 59+46.00 TO STA 60+66.00	120.00	24 TO 33	380.00
STA 60+66.00 TO STA 63+74.00	308.00	33	1,129.33
STA 63+74.00 TO STA 64+66.00	92.00	33 TO 30	322.00
STA 64+66.00 TO STA 65+99.00	133.00	30 TO 24	399.00
STA 65+99.00 TO STA 79+89.00	1,390.00	24	3,706.67
STA 79+89.00 TO STA 84+78.00	489.00	27	1,467.00
STA 84+78.00 TO STA 87+81.23	303.23	VAR	1,026.15
STA 7+18.82 TO STA 13+43.26	624.44	VAR	2,394.36
STA 13+43.26 TO STA 15+31.02	187.76	VAR	1,592.09 ***
STA 15+31.02 TO STA 17+42.49	211.47	42	859.79
STA 17+42.49 TO STA 26+00.00	857.51	VAR	5,473.81 ****
STA 26+00.00 TO STA 27+47.00	147.00	30 TO 28	473.67
SIDE STREETS/ROADS & ENTRANCES (SEE SCHEDULE ON SHEET 97)			3,268.57
PG TOTAL			59,160.88
JOB TOTAL			62,429.45

EARTH EXCAVATION WIDENING

LOCATION	LT SHLD WIDTH	RT SHLD WIDTH	DEPTH (INCH)	VOLUME (CU YD)
I-29 MAINLINE				
STA 28+80.00 TO STA 31+19.00	3	3	8	35.41
STA 32+05.00 TO STA 39+52.00	0	3	8	55.33
STA 32+05.00 TO STA 39+86.00	3	0	8	57.85
STA 40+28.00 TO STA 41+98.04 BK	0	3	8	12.60
STA 40+50.00 TO STA 41+98.04 BK	3	0	8	10.97
STA 42+39.60 AH TO STA 58+66.00 BK	3	3	8	240.95
STA 58+70.03 AH TO STA 58+79.00	3	3	8	1.33
STA 60+81.00 TO STA 79+60.00	0	3	8	139.19
STA 60+81.00 TO STA 80+05.00	3	0	8	142.52
STA 80+48.00 TO STA 100+89.78	0	3	8	151.24
STA 80+45.00 TO STA 100+89.78	3	0	8	151.47
STA 137+17.09 TO STA 154+00.00	0	3	8	124.66
STA 174+00.00 TO STA 204+26.00	0	3	8	224.15
STA 137+17.09 TO STA 139+21.00	3	0	8	15.10
STA 139+75.00 TO STA 154+00.00	3	0	8	105.56
STA 174+00.00 TO STA 204+16.00	3	0	8	223.41
STA 205+27.00 TO STA 206+47.00	0	3	8	8.89
STA 205+09.00 TO STA 206+47.00	3	0	8	10.22
TOTAL				1,710.85

- \* CHEYNEY INTERSECTION
- \*\* McADAM INTESECTION
- \*\*\* WEBSTER/PARK INTERSECTION
- \*\*\*\* MAIN CROSS/LINCOLN TRAIL. INT.

REVISIONS		ILLINOIS DEPARTMENT OF TRANSPORTATION
NAME	DATE	
		SCHEDULE OF QUANTITIES

FAP 75 (IL 29)  
SECTION D 6 RESURFACING 2007  
CHRISTIAN COUNTY

SCALE: VERT. DATE  
HORIZ. DATE

DRAWN BY  
CHECKED BY

Rev. Sheet 2-22-07

F.A.P. RTE.	SECTION	COUNTY	TOTAL SHEETS	SHEET NO.
75		CHRISTIAN	97	28

STA.	TO STA.

FED. ROAD DIST. NO. ILLINOIS FED. AID PROJECT  
 \*D 6 RESURFACING 2007

TEMPORARY RAMP

LOCATION		LENGTH (FOOT)	PAVEMENT WIDTH (FOOT)	AREA (SQ YD)
<b>I-29 MAINLINE</b>				
STA 520+72.00	TO	STA 520+78.67	6.67	49.0
STA 27+42.00	TO	STA 27+47.00	5.00	26.0
STA 28+80.00	TO	STA 28+85.00	5.00	26.0
STA 153+93.33	TO	STA 154+00.00	6.67	24.0
STA 174+00.00	TO	STA 174+06.67	6.67	24.0
STA 206+40.33	TO	STA 206+47.00	6.67	24.0
<b>SIDE STREETS</b>				
Cheney	LT	6.67	26.0	19.27
Cheney	RT	6.67	36.5	27.05
Knute Rockne Road	LT	6.67	46.5	34.46
Sportsman Drive	LT	6.67	26.0	19.27
Hawley Street	RT	6.67	35.0	25.94
Honer Street	RT	6.67	28.5	21.12
Lincoln Street	LT	6.67	26.5	19.64
Maxwell Street	RT	6.67	29.5	21.86
Toft Street	RT	6.67	32.5	24.09
Bidwell Street	LT	6.67	40.0	29.64
West Bryant Street	RT	6.67	25.0	18.53
Wilson Street	RT	6.67	21.0	15.56
John Street	RT	6.67	18.5	13.71
W Park		6.67	52.0	38.54
S Webster		6.67	37.0	27.42
Washington	LT	6.67	27.0	20.01
Washington	RT	6.67	36.0	26.68
Main Street	LT	6.67	27.0	20.01
Main Street	RT	6.67	27.0	20.01
Walnut Street	LT	6.67	37.0	27.42
Walnut Street	RT	6.67	37.0	27.42
Cherokee Street	LT	6.67	31.0	22.97
Cherokee Street	RT	6.67	31.0	22.97
Cheyenne Street	RT	6.67	24.0	17.79
Shawnee Street	LT	6.67	28.0	20.75
Shawnee Street	RT	6.67	24.0	17.79
Chestnut Street	RT	6.67	24.0	17.79
Long Street	LT	6.67	24.0	17.79
Long Street	RT	6.67	20.0	14.82
Paw Paw Street	RT	6.67	23.0	17.05
McAdam	LT	6.67	30.0	22.23
Lincoln Trail	LT	6.67	40.0	29.64
Main Cross	RT	6.67	30.0	22.23
Pershing	LT	5.00	66.0	36.67
Pershing	RT	5.00	65.0	36.11
Kennedy	LT	5.00	25.0	13.89
Lake	RT	5.00	26.0	14.44
Lake	LT	5.00	26.0	14.44
Velma Road	LT	5.00	72.0	40.00
Velma Road	RT	5.00	80.0	44.44
<b>TOTAL</b>				<b>1,060.02</b>

AGGREGATE SHOULDERS, TYPE B

LOCATION		LT SHLD WIDTH	RT SHLD WIDTH	AVERAGE DEPTH (INCH)	TONS
<b>I-29 MAINLINE</b>					
STA 8+90.00	TO	STA 10+00.00	0	3	2.5
STA 10+68.00	TO	STA 11+47.00	0	3	2.5
STA 11+61.00	TO	STA 13+43.00	3	0	2.5
STA 14+75.00	TO	STA 19+04.00	0	3	2.5
STA 15+30.00	TO	STA 17+83.00	3	0	2.5
STA 20+23.00	TO	STA 27+47.00	3	3	2.5
STA 28+80.00	TO	STA 31+19.00	3	3	2.5
STA 32+05.00	TO	STA 39+52.00	0	3	2.5
STA 32+05.00	TO	STA 39+86.00	3	0	2.5
STA 40+28.00	TO	STA 41+98.00 C4 BK	0	3	2.5
STA 40+50.00	TO	STA 41+98.00 C4 BK	3	0	2.5
STA 42+39.60 AH	TO	STA 58+66.00 BK	3	3	2.5
STA 58+70.03 AH	TO	STA 58+79.00	3	3	2.5
STA 60+81.00	TO	STA 79+60.00	0	3	2.5
STA 60+81.00	TO	STA 80+05.00	3	0	2.5
STA 80+48.00	TO	STA 127+33.00	0	3	2.5
STA 80+45.00	TO	STA 109+09.00	3	0	2.5
STA 110+51.00	TO	STA 127+33.00	3	0	2.5
STA 128+92.00	TO	STA 136+21.00	3	0	2.5
STA 128+92.00	TO	STA 154+00.00	0	3	2.5
STA 174+00.00	TO	STA 204+26.00	0	3	2.5
STA 137+00.00	TO	STA 139+21.00	3	0	2.5
STA 139+75.00	TO	STA 154+00.00	3	0	2.5
STA 174+00.00	TO	STA 204+16.00	3	0	2.5
STA 205+27.00	TO	STA 206+47.00	0	3	2.5
STA 205+09.00	TO	STA 206+47.00	3	0	2.5
<b>LINCOLN TRAIL</b>					
STA 12+50.00	TO	STA 17+35.00	3	0	2.5
STA 12+78.00	TO	STA 17+25.00	0	3	2.5
STA 17+81.00	TO	STA 18+93.00	0	3	2.5
STA 17+92.00	TO	STA 18+93.00	3	0	2.5
<b>TOTAL</b>					<b>1,587.70</b>

PLOT DATE = 2/21/2007  
 PLOT SCALE = 1/8"=1'-0"  
 USER NAME = loughlin-1

Rev. Sheet 2-22-07

REVISIONS	
NAME	DATE

ILLINOIS DEPARTMENT OF TRANSPORTATION  
 SCHEDULE OF QUANTITIES  
 FAP 75 (IL 29)  
 SECTION D 6 RESURFACING 2007  
 CHRISTIAN COUNTY  
 SCALE: VERT. DATE  
 HORIZ. DATE  
 DRAWN BY  
 CHECKED BY

F.A.P. RTE.	SECTION	COUNTY	TOTAL SHEETS	SHEET NO.
75		CHRISTIAN	97	29
STA.		TO STA.		
FED. ROAD DIST. NO.	ILLINOIS	FED. AID PROJECT		

\*D 6 RESURFACING 2007

BITUMINOUS MATERIALS (PRIME COAT)

LOCATION	PAVEMENT WIDTH (FOOT)	LT SHLD WIDTH	RT SHLD WIDTH	AREA (SQ YD)	QUANTITY (TONS)
I-29 MAINLINE					
STA 520+72.00 TO STA 524+01.34	52			1,902.85	0.72
STA 524+01.34 TO STA 526+85.47	VAR			2,692.71	1.02
STA 526+85.47 TO STA 552+05.00	40			11,197.91	4.26
STA 552+05.00 TO STA 554+07.00	40 TO 48			987.56	0.38
STA 554+07.00 TO STA 564+80.00	48			5,722.67	2.17
STA 564+80.00 TO STA 570+17.12	48 TO 50			2,924.32	1.11
STA 570+17.12 TO STA 572+17.12	50 TO 60			1,222.22	0.46
STA 572+17.12 TO STA 577+05.51	60 TO 62			3,310.20	1.26
STA 577+05.51 TO STA 583+11.84	VAR			5,596.03	2.13
STA 583+11.84 TO STA 583+24.00	48			64.85	0.02
STA 47+07.92 TO STA 49+22.00	48 TO 33			963.36	0.37
STA 49+22.00 TO STA 54+22.00	33			1,833.33	0.70
STA 54+22.00 TO STA 55+37.00	33 TO 30			402.50	0.15
STA 55+37.00 TO STA 56+92.00	30 TO 21			439.17	0.17
STA 56+92.00 TO STA 59+46.00	24			677.33	0.26
STA 59+46.00 TO STA 60+66.00	24 TO 33			380.00	0.14
STA 60+66.00 TO STA 63+74.00	33			1,129.33	0.43
STA 63+74.00 TO STA 64+66.00	33 TO 30			322.00	0.12
STA 64+66.00 TO STA 65+99.00	30 TO 24			399.00	0.15
STA 65+99.00 TO STA 79+89.00	24			3,706.67	1.41
STA 79+89.00 TO STA 84+78.00	27			1,467.00	0.56
STA 84+78.00 TO STA 87+81.23	VAR			1,026.15	0.39
STA 7+18.82 TO STA 13+43.26	VAR			2,394.36	0.91
STA 13+43.26 TO STA 15+31.02	VAR			1,592.09	0.60
STA 15+31.02 TO STA 17+42.49	VAR			859.79	0.33
STA 17+42.49 TO STA 26+00.00	VAR			5,473.81	2.08
STA 26+00.00 TO STA 27+47.00	28 TO 30			473.67	0.18
STA 27+47.00 TO STA 28+80.00	44			650.22	0.25
STA 28+80.00 TO STA 41+98.04 BK	24			3,514.77	1.34
STA 42+39.60 AH TO STA 58+66.00 BK	24			4,337.07	1.65
STA 58+70.03 AH TO STA 58+79.00	24			23.92	0.01
STA 58+79.00 TO STA 60+81.00	30			673.33	0.26
STA 60+81.00 TO STA 100+89.78	24			10,690.08	4.06
STA 100+89.78 TO STA 102+35.45	24	4	4	517.94	0.20
STA 102+35.45 TO STA 107+29.75	26 TO 36	4	4	2,141.97	0.81
STA 107+29.75 TO STA 110+72.28	36	4	4	1,674.59	0.64
STA 110+72.28 TO STA 113+67.47	36 TO 26	4	4	1,279.16	0.49
STA 113+67.47 TO STA 119+82.61	24	4	4	2,187.16	0.83
STA 119+82.61 TO STA 124+54.86	26 TO 36	4	4	2,046.42	0.78
STA 124+54.86 TO STA 129+69.26	36	4	4	2,514.84	0.96
STA 129+69.26 TO STA 137+17.09	36 TO 26	4	4	3,240.60	1.23
STA 137+17.09 TO STA 154+00.00	24			4,487.76	1.71
STA 174+00.00 TO STA 206+47.00	24			8,658.67	3.29
CONTINUED	CONTINUED	CONTINUED	CONTINUED	CONTINUED	CONTINUED

BITUMINOUS MATERIALS (PRIME COAT)

LOCATION	PAVEMENT WIDTH (FOOT)	LT SHLD WIDTH	RT SHLD WIDTH	AREA (SQ YD)	QUANTITY (TONS)
SIDE STREETS					
Knute Rockne Road	LT			208.13	0.08
Sportsman Drive	LT			81.92	0.03
Hawley Street	RT			102.62	0.04
Honer Street	RT			125.13	0.05
Lincoln Street	LT			82.47	0.03
Maxwell Street	RT			95.53	0.04
Taft Street	RT			89.02	0.03
Bidwell Street	LT			70.78	0.03
West Bryant Street	RT			87.99	0.03
Wilson Street	RT			53.73	0.02
John Street	RT			33.70	0.01
Washington Street	LT			286.62	0.11
Washington Street	RT			88.75	0.03
Main Street	LT			218.28	0.08
Main Street	RT			204.45	0.08
Walnut Street	LT			42.18	0.02
Walnut Street	RT			42.85	0.02
Cherokee Street	LT			33.47	0.01
Cherokee Street	RT			33.47	0.01
Cheyenne Street	RT			87.76	0.03
Shownee Street	LT			89.53	0.03
Shownee Street	RT			48.73	0.02
Chestnut Street	RT			50.89	0.02
Long Street	LT			83.27	0.03
Long Street	RT			58.32	0.02
Paw Paw Street	RT			45.10	0.02
Lincoln Trail	LT			2,572.53	0.98
Pershing Road	LT			83.46	0.03
Pershing Road	RT			82.19	0.03
STA 110+00.00	LT	4	4	425.21	0.16
STA 128+10.00	LT	4	4	436.34	0.17
STA 128+10.00	RT	4	4	435.08	0.17
Velma Road	LT			91.58	0.03
Velma Road	RT			87.64	0.03
ENTRANCES					
STA 571+01.26	LT			194.18	0.07
STA 573+69.00	LT			265.22	0.10
STA 40+00.00	RT			60.90	0.02
STA 40+10.00	LT			49.97	0.02
STA 80+00.00	RT			72.62	0.03
STA 80+15.00	LT			29.96	0.01
STA 136+50.00	LT			62.17	0.02
STA 139+50.00	LT			49.07	0.02
TOTAL					43.80

- \* CHEYNEY INTERSECTION
- \*\* WEBSTER/PARK INTERSECTION
- \*\*\* McADAM INTESECTION
- \*\*\*\* MAIN CROSS/LINCOLN TRAIL. INT.

REVISIONS		ILLINOIS DEPARTMENT OF TRANSPORTATION
NAME	DATE	
		SCHEDULE OF QUANTITIES

FAP 75 (IL 29)  
SECTION D 6 RESURFACING 2007  
CHRISTIAN COUNTY

SCALE: VERT.      DRAWN BY  
HORIZ.              CHECKED BY  
DATE

Rev. Sheet 2-22-07

PLOT DATE: 2/21/2007  
 FILE NAME: c:\projects\0654603\sheetd11a.dgn  
 USER: JMS  
 USER: JMS

F.A.P. RTE.	SECTION	COUNTY	TOTAL SHEETS	SHEET NO.
75	*	CHRISTIAN	97	30
STA.		TO STA.		
FED. ROAD DIST. NO.		ILLINOIS FED. AID PROJECT		

\*D 6 RESURFACING 2007

POLY HMA SURF CSE, MIX"D", N70

LOCATION			PAVEMENT WIDTH (FOOT)	PAVEMENT AREA (SQ YD)	TONS
<b>I-29 MAINLINE</b>					
STA 520+72.00	TO	STA 524+01.34	52	1,902.85	213.12
STA 524+01.34	TO	STA 526+85.47	VAR	2,692.71	301.58
STA 526+85.47	TO	STA 552+05.00	40	11,197.91	1,254.17
STA 552+05.00	TO	STA 554+07.00	40 TO 48	987.56	110.61
STA 554+07.00	TO	STA 564+80.00	48	5,722.67	640.94
STA 564+80.00	TO	STA 570+17.12	48 TO 50	2,924.32	327.52
STA 570+17.12	TO	STA 572+17.12	50 TO 60	1,222.22	136.89
STA 572+17.12	TO	STA 577+05.51	60 TO 62	3,310.20	370.74
STA 577+05.51	TO	STA 583+11.84	VAR	5,596.03	626.76
STA 583+11.84	TO	STA 583+24.00	48	64.85	7.26
STA 47+07.92	TO	STA 49+22.00	48 TO 33	963.36	107.90
STA 49+22.00	TO	STA 54+22.00	33	1,833.33	205.33
STA 54+22.00	TO	STA 55+37.00	33 TO 30	402.50	45.08
STA 55+37.00	TO	STA 56+92.00	30 TO 21	439.17	49.19
STA 56+92.00	TO	STA 59+46.00	24	677.33	75.86
STA 59+46.00	TO	STA 60+66.00	24 TO 33	380.00	42.56
STA 60+66.00	TO	STA 63+74.00	33	1,129.33	126.48
STA 63+74.00	TO	STA 64+66.00	33 TO 30	322.00	36.06
STA 64+66.00	TO	STA 65+99.00	30 TO 24	399.00	44.69
STA 65+99.00	TO	STA 79+89.00	24	3,706.67	415.15
STA 79+89.00	TO	STA 84+78.00	27	1,467.00	164.30
STA 84+78.00	TO	STA 87+81.23	VAR	1,026.15	114.93
STA 7+18.82	TO	STA 13+43.26	VAR	2,394.36	268.17
STA 13+43.26	TO	STA 15+31.02	VAR	1,592.09	178.31
STA 15+31.02	TO	STA 17+42.49	VAR	859.79	96.30
STA 17+42.49	TO	STA 26+00.00	VAR	5,473.81	613.07
STA 26+00.00	TO	STA 27+47.00	28 TO 30	473.67	53.05
STA 27+47.00	TO	STA 28+80.00	44	650.22	54.62
STA 28+80.00	TO	STA 41+98.04 BK	24	3,514.77	295.24
STA 42+39.60 AH	TO	STA 58+66.00 BK	24	4,337.07	364.31
STA 58+70.03 AH	TO	STA 58+79.00	24	23.92	2.01
STA 58+79.00	TO	STA 60+81.00	30	673.33	56.56
STA 60+81.00	TO	STA 100+89.78	24	10,690.08	897.97
STA 100+89.78	TO	STA 102+35.45	24	388.45	32.63
STA 102+35.45	TO	STA 107+29.75	26 TO 36	1,702.59	143.02
STA 107+29.75	TO	STA 110+72.28	36	1,370.12	115.09
STA 110+72.28	TO	STA 113+67.47	36 TO 26	1,016.77	85.41
STA 113+67.47	TO	STA 119+82.61	24	1,640.37	137.79
STA 119+82.61	TO	STA 124+54.86	26 TO 36	1,626.64	136.64
STA 124+54.86	TO	STA 129+69.26	36	2,057.60	172.84
STA 129+69.26	TO	STA 137+17.09	36 TO 26	2,575.86	216.37
STA 137+17.09	TO	STA 154+00.00	24	4,487.76	376.97
STA 174+00.00	TO	STA 206+47.00	24	8,658.67	727.33
<b>LINCOLN TRAIL</b>					
STA 12+76.40	TO	STA 18+93.00	VAR	2,572.53	288.12
<b>TOTAL</b>					<b>10,728.94</b>

INCIDENTAL HOT-MIX ASPHALT SURFACING

LOCATION		SR/PE/CE/MBTO	LENGTH (FOOT)	PAVEMENT WIDTH (FOOT)	AREA (SQ YD)	TONS
<b>SIDE STREETS</b>						
Knute Rockne Road	LT	SR	VAR	VAR	208.13	23.31
Sportsman Drive	LT	SR	VAR	VAR	81.92	9.18
Hawley Street	RT	SR	VAR	VAR	102.62	11.49
Honer Street	RT	SR	VAR	VAR	125.13	14.01
Lincoln Street	LT	SR	VAR	VAR	82.47	9.24
Maxwell Street	RT	SR	VAR	VAR	95.53	10.70
Taft Street	RT	SR	VAR	VAR	89.02	9.97
Bidwell Street	LT	SR	VAR	VAR	70.78	7.93
West Bryant Street	RT	SR	VAR	VAR	87.99	9.85
Wilson Street	RT	SR	VAR	VAR	53.73	6.02
John Street	RT	SR	VAR	VAR	33.70	3.77
Washington Street	LT	SR	VAR	VAR	286.62	32.10
Washington Street	RT	SR	VAR	VAR	88.75	9.94
Main Street	LT	SR	VAR	VAR	218.28	24.45
Main Street	RT	SR	VAR	VAR	204.45	22.90
Walnut Street	LT	SR	VAR	VAR	42.18	4.72
Walnut Street	RT	SR	VAR	VAR	42.85	4.80
Cherokee Street	LT	SR	VAR	VAR	33.47	3.75
Cherokee Street	RT	SR	VAR	VAR	33.47	3.75
Cheyenne Street	RT	SR	VAR	VAR	87.76	9.83
Shawnee Street	LT	SR	VAR	VAR	89.53	10.03
Shawnee Street	RT	SR	VAR	VAR	48.73	5.46
Chestnut Street	RT	SR	VAR	VAR	50.89	5.70
Long Street	LT	SR	VAR	VAR	83.27	9.33
Long Street	RT	SR	VAR	VAR	58.32	6.53
Paw Paw Street	RT	SR	VAR	VAR	45.10	5.05
<b>ENTRANCES</b>						
STA 571+01.26	LT	CE	VAR	VAR	194.18	21.75
STA 573+69.00	LT	CE	VAR	VAR	265.22	29.70
<b>SIDE STREETS</b>						
Pershing Road	LT	SR	VAR	VAR	83.46	7.01
Pershing Road	RT	SR	VAR	VAR	82.19	6.90
STA 110+00.00	LT	SR	VAR	VAR	425.21	35.72
STA 128+10.00	LT	SR	VAR	VAR	436.34	36.65
STA 128+10.00	RT	SR	VAR	VAR	435.08	36.55
1550 East	LT	SR	VAR	VAR	64.68	5.43
Velma Road	LT	SR	VAR	VAR	91.58	7.69
Velma Road	RT	SR	VAR	VAR	87.64	7.36
<b>ENTRANCES</b>						
STA 40+00.00	RT	PE	VAR	VAR	60.90	5.12
STA 40+10.00	LT	PE	VAR	VAR	49.97	4.20
STA 80+00.00	RT	PE	VAR	VAR	72.62	6.10
STA 80+15.00	LT	PE	VAR	VAR	29.96	2.52
STA 136+50.00	LT	PE	VAR	VAR	62.17	5.22
STA 139+50.00	LT	PE	VAR	VAR	49.07	4.12
STA 158+75.00	LT	PE	VAR	VAR	52.01	4.37
<b>TOTAL</b>					<b>500.22</b>	

- \* CHEYNEY INTERSECTION
- \*\* WEBSTER/PARK INTERSECTION
- \*\*\* McADAM INTESECTION
- \*\*\*\* MAIN CROSS/LINCOLN TRAIL INT.

REVISIONS	
NAME	DATE

ILLINOIS DEPARTMENT OF TRANSPORTATION  
 SCHEDULE OF QUANTITIES  
 FAP 75 (IL 29)  
 SECTION D 6 RESURFACING 2007  
 CHRISTIAN COUNTY  
 SCALE: VERT. HORIZ.  
 DATE  
 DRAWN BY  
 CHECKED BY

Rev. Sheet 2-22-07

PLOT DATE = 2/21/2007  
 PLOT SCALE = 1"=50'  
 USER NAME = jengh111



F.A.P. RTE.	SECTION	COUNTY	TOTAL SHEETS	SHEET NO.
75	*	CHRISTIAN	97	31
STA.		TO STA.		
FED. ROAD DIST. NO.		ILLINOIS FED. AID PROJECT		

\*D 6 RESURFACING 2007

AGGREGATE (PRIME COAT)

LOCATION			PAVEMENT WIDTH (FOOT)	LT SHLD WIDTH	RT SHLD WIDTH	AREA (SQ YD)	QUANTITY (TONS)
I-29 MAINLINE							
STA 520+72.00	TO	STA 524+01.34	52			1,902.85	3.81
STA 524+01.34	TO	STA 526+85.47	VAR			2,692.71	5.39
STA 526+85.47	TO	STA 552+05.00	40			11,197.91	22.40
STA 552+05.00	TO	STA 554+07.00	40 TO 48			987.56	1.98
STA 554+07.00	TO	STA 564+80.00	48			5,722.67	11.45
STA 564+80.00	TO	STA 570+17.12	48 TO 50			2,924.32	5.85
STA 570+17.12	TO	STA 572+17.12	50 TO 60			1,222.22	2.44
STA 572+17.12	TO	STA 577+05.51	60 TO 62			3,310.20	6.62
STA 577+05.51	TO	STA 583+11.84	VAR			5,596.03	11.19
STA 583+11.84	TO	STA 583+24.00	48			64.85	0.13
STA 47+07.92	TO	STA 49+22.00	48 TO 33			963.36	1.93
STA 49+22.00	TO	STA 54+22.00	33			1,833.33	3.67
STA 54+22.00	TO	STA 55+37.00	33 TO 30			402.50	0.81
STA 55+37.00	TO	STA 56+92.00	30 TO 21			439.17	0.88
STA 56+92.00	TO	STA 59+46.00	24			677.33	1.35
STA 59+46.00	TO	STA 60+66.00	24 TO 33			380.00	0.76
STA 60+66.00	TO	STA 63+74.00	33			1,129.33	2.26
STA 63+74.00	TO	STA 64+66.00	33 TO 30			322.00	0.64
STA 64+66.00	TO	STA 65+99.00	30 TO 24			399.00	0.80
STA 65+99.00	TO	STA 79+89.00	24			3,706.67	7.41
STA 79+89.00	TO	STA 84+78.00	27			1,467.00	2.93
STA 84+78.00	TO	STA 87+81.23	VAR			1,026.15	2.05
STA 7+18.82	TO	STA 13+43.26	VAR			2,394.36	4.79
STA 13+43.26	TO	STA 15+31.02	VAR			1,592.09	3.18
STA 15+31.02	TO	STA 17+42.49	VAR			859.79	1.72
STA 17+42.49	TO	STA 26+00.00	VAR			5,473.81	10.95
STA 26+00.00	TO	STA 27+47.00	28 TO 30			473.67	0.95
STA 27+47.00	TO	STA 28+80.00	44			650.22	1.30
STA 28+80.00	TO	STA 41+98.04 BK	24			3,514.77	7.03
STA 42+39.60 AH	TO	STA 58+66.00 BK	24			4,337.07	8.67
STA 58+70.03 AH	TO	STA 58+79.00	24			23.92	0.05
STA 58+79.00	TO	STA 60+81.00	30			673.33	1.35
STA 60+81.00	TO	STA 100+89.78	24			10,690.08	21.38
STA 100+89.78	TO	STA 102+35.45	24	4	4	517.94	1.04
STA 102+35.45	TO	STA 107+29.75	26 TO 36	4	4	2,141.97	4.28
STA 107+29.75	TO	STA 110+72.28	36	4	4	1,674.59	3.35
STA 110+72.28	TO	STA 113+67.47	36 TO 26	4	4	1,279.16	2.56
STA 113+67.47	TO	STA 119+82.61	24	4	4	2,187.16	4.37
STA 119+82.61	TO	STA 124+54.86	26 TO 36	4	4	2,046.42	4.09
STA 124+54.86	TO	STA 129+69.26	36	4	4	2,514.84	5.03
STA 129+69.26	TO	STA 137+17.09	36 TO 26	4	4	3,240.60	6.48
STA 137+17.09	TO	STA 154+00.00	24			4,487.76	8.98
STA 174+00.00	TO	STA 206+47.00	24			8,658.67	17.32
CONTINUED		CONTINUED	CONTINUED			CONTINUED	CONTINUED

AGGREGATE (PRIME COAT)

LOCATION			PAVEMENT WIDTH (FOOT)	LT SHLD WIDTH	RT SHLD WIDTH	AREA (SQ YD)	QUANTITY (TONS)
SIDE STREETS							
Knute Rockne Road	LT	(ADD)	VAR			208.13	0.42
Sportsman Drive	LT	(ADD)	VAR			81.92	0.16
Howley Street	RT	(ADD)	VAR			102.62	0.21
Haner Street	RT	(ADD)	VAR			125.13	0.25
Lincoln Street	LT	(ADD)	VAR			82.47	0.16
Maxwell Street	RT	(ADD)	VAR			95.53	0.19
Taft Street	RT	(ADD)	VAR			89.02	0.18
Bidwell Street	LT	(ADD)	VAR			70.78	0.14
West Bryant Street	RT	(ADD)	VAR			87.99	0.18
Wilson Street	RT	(ADD)	VAR			53.73	0.11
John Street	RT	(ADD)	VAR			33.70	0.07
Washington Street	LT	(ADD)	VAR			286.62	0.57
Washington Street	RT	(ADD)	VAR			88.75	0.18
Main Street	LT	(ADD)	VAR			218.28	0.44
Main Street	RT	(ADD)	VAR			204.45	0.41
Walnut Street	LT	(ADD)	VAR			42.18	0.08
Walnut Street	RT	(ADD)	VAR			42.85	0.09
Cherokee Street	LT	(ADD)	VAR			33.47	0.07
Cherokee Street	RT	(ADD)	VAR			33.47	0.07
Cheyenne Street	RT	(ADD)	VAR			87.76	0.18
Shawnee Street	LT	(ADD)	VAR			89.53	0.18
Shawnee Street	RT	(ADD)	VAR			48.73	0.10
Chestnut Street	RT	(ADD)	VAR			50.89	0.10
Long Street	LT	(ADD)	VAR			83.27	0.17
Long Street	RT	(ADD)	VAR			58.32	0.12
Paw Paw Street	RT	(ADD)	VAR			45.10	0.09
Lincoln Trail	LT	(ADD)	VAR			2,572.53	5.15
Pershing Road	LT	(ADD)				83.46	0.17
Pershing Road	RT	(ADD)				82.19	0.16
STA 110+00.00	LT	(CADD)		4	4	425.21	0.85
STA 128+10.00	LT	(CADD)		4	4	436.34	0.87
STA 128+10.00	RT	(CADD)		4	4	435.08	0.87
Velma Road	LT	(CADD)				91.58	0.18
Velma Road	RT	(CADD)				87.64	0.18
ENTRANCES							
STA 571+01.26	LT	(CADD)	VAR			194.18	0.39
STA 573+69.00	LT	(CADD)	VAR			265.22	0.53
STA 40+00.00	RT	(CADD)				60.90	0.12
STA 40+10.00	LT	(CADD)				49.97	0.10
STA 80+00.00	RT	(CADD)				72.62	0.15
STA 80+15.00	LT	(CADD)				29.96	0.06
STA 136+50.00	LT	(CADD)				62.17	0.12
STA 139+50.00	LT	(CADD)				49.07	0.10
TOTAL							230.54

- CHEYNEY INTERSECTION
- WEBSTER/PARK INTERSECTION
- McADAM INTESECTION
- MAIN CROSS/LINCOLN TRAIL. INT.

PLOT DATE : 2/21/2007  
 FILE NAME : c:\pwworkspace\654683\sheet.dwg  
 USER NAME : jphippen1

Rev. Sheet 2-22-07

REVISIONS		DATE
NAME		

ILLINOIS DEPARTMENT OF TRANSPORTATION

SCHEDULE OF QUANTITIES

FAP 75 (IL 29)  
SECTION D 6 RESURFACING 2007  
CHRISTIAN COUNTY

SCALE: VERT. \_\_\_\_\_  
HORIZ. \_\_\_\_\_  
DATE \_\_\_\_\_

DRAWN BY \_\_\_\_\_  
CHECKED BY \_\_\_\_\_

F.A.P. RTE.	SECTION	COUNTY	TOTAL SHEETS	SHEET NO.
75	*	CHRISTIAN	97	32
STA.		TO STA.		
FED. ROAD DIST. NO.		ILLINOIS	FED. AID PROJECT	

#D 6 RESURFACING 2007

THERMOPLASTIC PAVEMENT MARKING - LINE 5"

LOCATION	COLOR / DESCRIPTION	# OF LINES	LENGTH (FOOT)
IL-29 MAINLINE			
STA 520+72.00 TO STA 524+91.00	YELLOW / MEDIAN	4	1,676.0
STA 525+87.00 TO STA 528+10.00	YELLOW / MEDIAN	4	892.0
STA 528+10.00 TO STA 530+88.00	YELLOW / MEDIAN	2	556.0
STA 531+91.00 TO STA 552+40.00	YELLOW / LTLC	2	4,098.0
STA 531+91.00 TO STA 552+40.00	YELLOW / LTLC SKIP DASHES	2	1,040.0
STA 552+40.00 TO STA 553+95.00	YELLOW / MEDIAN	4	620.0
STA 553+95.00 TO STA 556+07.00	YELLOW / MEDIAN	2	424.0
STA 556+93.00 TO STA 564+39.00	YELLOW / MEDIAN	2	1,492.0
STA 564+89.00 TO STA 568+00.00	YELLOW / MEDIAN	2	622.0
STA 568+30.00 TO STA 573+47.00	YELLOW / MEDIAN	2	1,034.0
STA 573+92.00 TO STA 578+14.00	YELLOW / MEDIAN	2	844.0
STA 579+13.00 TO STA 581+77.00	YELLOW / MEDIAN	2	528.0
STA 582+64.00 TO STA 583+24.00	YELLOW / MEDIAN	2	120.0
STA 583+12.00 TO STA 583+24.00	WHITE/ 2' SKIP DASH	1	12.0
STA 47+07.92 TO STA 48+24.00	WHITE/ 2' SKIP DASH	1	116.0
STA 47+07.92 TO STA 49+80.00	YELLOW / CL	2	544.0
STA 50+03.00 TO STA 52+97.00	YELLOW / CL	2	588.0
STA 50+25.00 TO STA 51+97.00	WHITE / EDGE	2	344.0
STA 53+60.00 TO STA 54+25.00	YELLOW / CL	2	130.0
STA 54+25.00 TO STA 56+47.00	YELLOW / MEDIAN	4	888.0
STA 56+47.00 TO STA 59+46.00	YELLOW / CL	2	598.0
STA 59+46.00 TO STA 61+64.00	YELLOW / MEDIAN	4	872.0
STA 61+64.00 TO STA 62+36.00	YELLOW / CL	2	144.0
STA 53+60.00 TO STA 62+36.00	WHITE / EDGE	2	1,752.0
STA 63+00.00 TO STA 63+70.00	YELLOW / CL	2	140.0
STA 63+70.00 TO STA 65+96.00	YELLOW / MEDIAN	4	904.0
STA 63+00.00 TO STA 69+00.00	WHITE / EDGE	2	1,200.0
STA 66+37.00 TO STA 69+00.00	YELLOW / CL	2	526.0
STA 69+53.00 TO STA 72+54.00	YELLOW / CL	2	602.0
STA 69+53.00 TO STA 76+04.00	WHITE / EDGE	2	1,302.0
STA 72+92.00 TO STA 76+04.00	YELLOW / CL	2	624.0
STA 76+46.00 TO STA 79+54.00	YELLOW / CL	2	616.0
STA 76+46.00 TO STA 87+81.23	WHITE / EDGE	2	2,270.0
STA 79+92.00 TO STA 87+81.23	YELLOW / CL	2	1,578.0
STA 7+18.82 TO STA 14+08.00	YELLOW / MEDIAN	2	1,378.0
STA 14+38.00 TO STA 14+38.00	MEDIAN / McADAM	2	164.1
STA 14+70.00 TO STA 18+24.00	YELLOW / MEDIAN	2	708.0
STA 19+88.00 TO STA 25+46.00	YELLOW / MEDIAN	2	1,116.0
STA 25+46.00 TO STA 27+47.00	YELLOW / NB NPZ	1	201.0
STA 25+46.00 TO STA 27+47.00	YELLOW SKIP DASH / CL	1	60.0
STA 27+47.00 TO STA 28+80.00	YELLOW SKIP DASH / CL BRIDGE	1	40.0
STA 28+80.00 TO STA 41+98.04 BK	YELLOW SKIP DASH / CL	1	330.0
STA 42+39.60 AH TO STA 58+66.00 BK	YELLOW SKIP DASH / CL	1	410.0
STA 58+70.03 AH TO STA 58+79.00	YELLOW SKIP DASH / CL	1	10.0
STA 58+79.00 TO STA 60+81.00	YELLOW SKIP DASH / CL BRIDGE	1	60.0
STA 60+81.00 TO STA 87+50.00	YELLOW SKIP DASH / CL	1	670.0
STA 77+00.00 TO STA 87+50.00	YELLOW SB NPZ	1	1,050.0
STA 87+50.00 TO STA 101+88.00	YELLOW NB & SB NPZ	2	2,876.0
CONTINUED	CONTINUED	CONTINUED	CONTINUED

THERMOPLASTIC PAVEMENT MARKING - LINE 5"

LOCATION	COLOR / DESCRIPTION	# OF LINES	LENGTH (FOOT)
STA 101+88.00 TO STA 107+30.00	YELLOW / MEDIAN	4	2,168.0
STA 107+30.00 TO STA 109+76.00	YELLOW / MEDIAN	2	492.0
STA 109+99.00 TO STA 109+99.00	MEDIAN / KENNEDY ROAD	2	115.0
STA 110+20.00 TO STA 113+67.00	YELLOW / MEDIAN	4	1,388.0
STA 113+67.00 TO STA 119+83.00	YELLOW / MEDIAN	2	1,232.0
STA 119+83.00 TO STA 126+32.00	YELLOW / MEDIAN	4	2,596.0
STA 126+32.00 TO STA 127+47.00	YELLOW / MEDIAN	2	230.0
STA 128+00.00 TO STA 128+00.00	MEDIAN / N. LAKE ROAD	2	104.0
STA 128+00.00 TO STA 128+00.00	MEDIAN / S. LAKE ROAD	2	76.0
STA 128+54.00 TO STA 129+69.00	YELLOW / MEDIAN	2	230.0
STA 129+69.00 TO STA 136+19.00	YELLOW / MEDIAN	4	2,600.0
STA 136+19.00 TO STA 154+00.00	YELLOW SKIP DASH / CL	1	450.0
STA 174+00.00 TO STA 205+09.00	YELLOW SKIP DASH / CL	1	780.0
STA 205+09.00 TO STA 206+47.00	YELLOW SKIP DASH / CL	1	138.0
STA 7+18.82 TO STA 13+51.00	EDGE / WHITE	2	1,264.0
STA 13+51.00 TO STA 15+31.00	EDGE / WHITE	1	180.0
STA 13+51.00 TO STA 14+08.00	EDGE McADAM/ WHITE	1	121.7
STA 14+42.00 TO STA 15+31.00	EDGE McADAM/ WHITE	1	150.9
STA 15+31.00 TO STA 17+83.59	EDGE / WHITE	2	505.0
STA 20+23.13 TO STA 27+47.00	EDGE / WHITE	2	1,448.0
STA 27+47.00 TO STA 28+80.00	EDGE BRIDGE / WHITE	2	266.0
STA 28+80.00 TO STA 31+19.00	EDGE / WHITE	2	478.0
STA 32+05.00 TO STA 41+98.04 BK	EDGE / WHITE	2	1,986.0
STA 42+39.60 AH TO STA 58+66.00 BK	EDGE / WHITE	2	3,253.0
STA 58+70.03 AH TO STA 58+79.00	EDGE / WHITE	2	18.0
STA 58+79.00 TO STA 60+81.00	EDGE BRIDGE / WHITE	2	404.0
STA 60+81.00 TO STA 109+09.00	EDGE / WHITE	2	9,656.0
STA 109+09.00 TO STA 110+52.00	EDGE KENNEDY ROAD/ WHITE	2	488.0
STA 109+09.00 TO STA 110+52.00	EDGE / WHITE	1	143.0
STA 110+52.00 TO STA 127+23.80	EDGE / WHITE	2	3,344.0
STA 127+23.80 TO STA 129+02.45	EDGE N. LAKE ROAD/ WHITE	2	236.5
STA 127+23.80 TO STA 129+02.45	EDGE S. LAKE ROAD/ WHITE	2	245.8
STA 129+02.00 TO STA 154+00.00	EDGE / WHITE	2	4,996.0
STA 174+00.00 TO STA 204+25.00	EDGE / WHITE	2	6,050.0
STA 205+09.00 TO STA 206+47.00	EDGE / WHITE	2	276.0
CHENEY			
STA 8+55.00 TO STA 9+42.00	YELLOW / MEDIAN	2	174.0
STA 10+50.00 TO STA 11+25.00	YELLOW / MEDIAN	2	150.0
SOUTH WEBSTER			
STA 114+26.00 TO STA 115+06.00	YELLOW / MEDIAN	2	160.0
WEST PARK			
STA 8+70.00 TO STA 9+53.00	YELLOW / MEDIAN	2	166.0
MAIN CROSS			
STA 9+78.00 TO STA 11+47.00	EDGE / WHITE	2	338.0
STA 9+78.00 TO STA 10+85.00	YELLOW / MEDIAN	2	214.0
LINCOLN TRAIL			
STA 11+07.00 TO STA 18+93.00	EDGE / WHITE	2	1,572.0
STA 11+76.00 TO STA 17+45.00	YELLOW / MEDIAN	2	1,140.0
STA 17+85.00 TO STA 18+93.00	YELLOW / MEDIAN	2	216.0
STA 15+00.00 TO STA 16+61.00	WHITE / 2' SKIP DASH	1	164.0
TOTAL			91,171.9

DATE: 2/21/2007  
 USER: J...  
 FILE: ...

Rev. Sheet 2-22-07

REVISIONS	
NAME	DATE

ILLINOIS DEPARTMENT OF TRANSPORTATION  
 SCHEDULE OF QUANTITIES  
 FAP 75 (IL 29)  
 SECTION D 6 RESURFACING 2007  
 CHRISTIAN COUNTY  
 SCALE: VERT. DATE  
 HORIZ. DATE  
 DRAWN BY  
 CHECKED BY

F.A.P. RTE.	SECTION	COUNTY	TOTAL SHEETS	SHEET NO.
75	*	CHRISTIAN	97	33
STA.		TO STA.		
FED. ROAD DIST. NO.		ILLINOIS FED. AID PROJECT		

\*D 6 RESURFACING 2007

HMA SURFACE REMOVAL - BUTT JOINT

LOCATION	LENGTH (FOOT)	PAVEMENT WIDTH (FOOT)	AREA (SQ YD)
<b>I-29 MAINLINE</b>			
STA 28+80.00 TO STA 29+10.00	30	24	80.00
STA 206+17.00 TO STA 206+47.00	30	24	80.00
STA 153+70.00 TO STA 154+00.00	30	24	80.00
STA 174+00.00 TO STA 174+30.00	30	24	80.00
<b>SIDE STREETS</b>			
PERSHING RD LT SR	VAR	VAR	83.46
PERSHING RD RT SR	VAR	VAR	82.19
KENNEDY LT SR	VAR	VAR	425.21
LAKE LT SR	VAR	VAR	436.34
LAKE RT SR	VAR	VAR	435.08
VELMA RD LT SR	VAR	VAR	91.58
VELMA RD RT SR	VAR	VAR	87.64
<b>ENTRANCES</b>			
STA 40+00.00 RT PE	VAR	VAR	60.90
STA 40+10.00 LT PE	VAR	VAR	49.97
STA 80+00.00 RT PE	VAR	VAR	72.62
STA 80+15.00 LT PE	VAR	VAR	29.96
STA 136+50.00 LT PE	VAR	VAR	62.17
STA 139+50.00 LT PE	VAR	VAR	49.07
<b>TOTAL</b>			<b>2,286.19</b>

SHOULDER RUMBLE STRIPS

LOCATION	LT SHLD WIDTH	RT SHLD WIDTH	LENGTH (FOOT)
<b>I-29 MAINLINE</b>			
STA 28+80.00 TO STA 31+19.00	3	3	478.00
STA 32+05.00 TO STA 39+52.00	0	3	747.00
STA 32+05.00 TO STA 39+86.00	3	0	781.00
STA 40+28.00 TO STA 41+98.04 BK	0	3	170.04
STA 40+50.00 TO STA 41+98.04 BK	3	0	148.04
STA 42+39.60 AH TO STA 58+66.00 BK	3	3	3,252.80
STA 58+70.03 AH TO STA 58+79.00	3	3	17.94
STA 60+81.00 TO STA 79+60.00	0	3	1,879.00
STA 60+81.00 TO STA 80+05.00	3	0	1,924.00
STA 80+48.00 TO STA 127+33.00	0	3	4,685.00
STA 80+45.00 TO STA 109+09.00	3	0	2,864.00
STA 110+51.00 TO STA 127+33.00	3	0	1,682.00
STA 128+92.00 TO STA 136+21.00	3	0	729.00
STA 128+92.00 TO STA 154+00.00	0	3	2,508.00
STA 174+00.00 TO STA 204+26.00	0	3	3,026.00
STA 137+00.00 TO STA 139+21.00	3	0	221.00
STA 139+75.00 TO STA 154+00.00	3	0	1,425.00
STA 174+00.00 TO STA 204+16.00	3	0	3,016.00
STA 205+27.00 TO STA 206+47.00	0	3	120.00
STA 205+09.00 TO STA 206+47.00	3	0	138.00
<b>TOTAL</b>			<b>29,811.82</b>

HOT-MIX ASPHALT SHOULDERS

LOCATION	LT SHLD WIDTH	RT SHLD WIDTH	TONS
<b>I-29 MAINLINE</b>			
STA 100+89.78 TO STA 109+09.00	4	0	45.88
STA 100+89.78 TO STA 127+33.00	0	4	148.02
STA 128+92.00 TO STA 137+17.09	0	4	46.21
STA 110+51.00 TO STA 127+33.00	4	0	94.19
STA 128+92.00 TO STA 136+21.00	4	0	40.82
STA 137+00.00 TO STA 137+17.09	4	0	0.96
<b>TOTAL</b>			<b>376.08</b>

INSERTION CULVERT LINER (SPECIAL)

LOCATION	LENGTH FOOT
LT STA 47+04 TO LT STA 49+61	258
<b>TOTAL</b>	<b>258</b>

MANHOLES, TYPE A, 5'-DIAMETER, TYPE 1 FRAME,

OPEN LID

LOCATION	EACH
RT STA 45+03 (69' RT)	1
<b>TOTAL</b>	<b>1</b>

MANHOLES, TYPE A, 5'-DIAMETER, TYPE 1 FRAME,

CLOSED LID

LOCATION	EACH
LT STA 47+04 (23' LT)	1
<b>TOTAL</b>	<b>1</b>

STORM SEWERS JACKED IN PLACE, CLASS A 36"

LOCATION	LENGTH FOOT
LT STA 47+04 TO RT STA 45+03	221
<b>TOTAL</b>	<b>221</b>

SEEDING, CLASS 2 (SPECIAL)

LOCATION	LENGTH FOOT	WIDTH FOOT	AREA SQ FT	AREA ACRE
RT STA 45+03	100	50	5000	0.11
LT STA 47+04	100	45	4500	0.10
<b>TOTAL</b>				<b>0.21</b>

TEMPORARY SHEET PILING

LOCATION	LENGTH FOOT	DEPTH FOOT	AREA SQ FT
RT STA 46+54 TO 47+54	100	40	4000
<b>TOTAL</b>			<b>4000</b>

\*\* - CONTRACTOR SHALL DESIGN SHEET PILING

PLOT DATE = 2/21/2007  
 FILE NAME = I:\AS-4833\sheet\as.dgn  
 PLOT SCALE = 1/8"=1'-0" / 3/4"  
 USER NAME = laughton1

REVISIONS		ILLINOIS DEPARTMENT OF TRANSPORTATION
NAME	DATE	
		SCHEDULE OF QUANTITIES FAP 75 (IL 29) SECTION D 6 RESURFACING 2007 CHRISTIAN COUNTY  SCALE: VERT.      DRAWN BY HORIZ.              CHECKED BY DATE

*Rev. Sheet 2-22-07*

F.A.P. RTE.	SECTION	COUNTY	TOTAL SHEETS	SHEET NO.
75	*	CHRISTIAN	97	34
STA.		TO STA.		
FED. ROAD DIST. NO.	ILLINOIS	FED. AID PROJECT		

\*D 6 RESURFACING 2007

RAISED REFLECTIVE PAVEMENT MARKER

LOCATION			ONE-WAY AMBER	TWO-WAY AMBER	ONE-WAY CRYSTAL
IL-29 MAINLINE					
520+72	TO	523+39 GORE AREA	14		
523+39	TO	524+90 GORE AREA		8	
523+39	TO	525+10 LANE LINE			5
523+39	TO	524+89 LANE LINE			4
525+90	TO	530+88 GORE AREA		26	
529+10	TO	530+88 LANE LINE			5
532+00	TO	552+42 SUICIDE LANE		102	
552+42	TO	553+80 GORE AREA	8		
553+80	TO	556+06 CL		12	
554+20	TO	556+06 LANE LINE			5
560+96	TO	564+55 CL		9	
556+93	TO	560+96 CL		20	
556+93	TO	560+96 LANE LINE			10
564+89	TO	568+01 CL		8	
568+29	TO	570+17 CL		5	
556+93	TO	573+74 SKIP DASH SB			21
560+96	TO	573+74 SKIP DASH NB			16
570+17	TO	573+47 CL		18	
572+12	TO	573+47 LANE LINE			4
573+92	TO	578+14 CL		22	
575+56	TO	578+14 LANE LINE			7
575+56	TO	577+78 LANE LINE			6
576+40	TO	577+58 LANE LINE			3
579+10	TO	579+92 CL		6	
579+05	TO	579+92 LANE LINE			3
579+13	TO	581+78 MEDIAN LINES		14	
579+12	TO	580+38 LANE LINE			4
579+52	TO	581+83 LANE LINE			6
579+39	TO	581+52 SKIP DASH	3		
582+59	TO	583+11 MEDIAN LINES	4		
581+33	TO	581+74 LANE LINE			4
582+64	TO	583+24 MEDIAN LINES	4		
47+08	TO	49+80 CL		12	
50+03	TO	52+97 CL		16	
50+03	TO	50+85 LANE LINE			3
51+92	TO	52+97 LANE LINE			3
53+60	TO	54+25 LANE LINE		6	3
54+25	TO	56+47 MEDIAN LINES	10		
56+47	TO	59+46 CL		16	
59+46	TO	61+64 MEDIAN LINES	10		
61+64	TO	62+36 CL		6	3
63+00	TO	63+75 CL		6	3
63+75	TO	65+96 MEDIAN LINES	10		
66+37	TO	69+00 CL		14	
69+53	TO	87+62 CL		90	
7+18	TO	11+19 MEDIAN LINE	20		

CONTINUED CONTINUED CONTINUED CONTINUED CONTINUED CONTINUED

RAISED REFLECTIVE PAVEMENT MARKER

LOCATION				ONE-WAY AMBER	TWO-WAY AMBER	ONE-WAY CRYSTAL
11+19	TO	14+04 LANE LINE			8	
11+19	TO	14+05 MEDIAN LINE		16		
14+74	TO	18+22 MEDIAN LINE		18		
14+77	TO	18+21 LANE LINE			9	
19+88	TO	21+40 MEDIAN LINE		8		
21+40	TO	25+47 MEDIAN LINE	22			
19+99	TO	21+40 LANE LINE			4	
25+47	TO	27+47 CL		3		
27+47	TO	28+80 BRIDGE OMISSION				
28+80	TO	58+79 CL		38		
58+79	TO	60+81 BRIDGE OMISSION				
60+81	TO	102+00 CL		52		
102+00	TO	107+30 MEDIAN LINE	26			
107+30	TO	109+77 MEDIAN LINE		14		
107+30	TO	109+77 LANE LINE			7	
110+20	TO	113+67 MEDIAN LINE	20			
113+67	TO	119+68 CL		16		
119+68	TO	126+22 MEDIAN LINE	34			
126+22	TO	127+11 CL		3		
126+31	TO	127+11 LANE LINE			3	
128+56	TO	129+71 LANE LINE			3	
128+56	TO	129+71 CL		3		
129+71	TO	136+20 MEDIAN LINE	34	88		
136+20	TO	154+00 CL		23		
174+00	TO	206+47 CL		41		
CHENEY STREET						
8+55	TO	11+24 LANE LINE		5		
PARK STREET						
8+30	TO	9+52 CL		8		
8+30	TO	9+66 LANE LINE			4	
8+30	TO	9+18 LANE LINE			3	
TOTALS				219	752	159
JOB TOTAL				1130	EACH	

PLT DATE = 2/21/2007  
 FILE NAME = c:\projects\14854883\vehed\vehed.dgn  
 USER NAME = laughton

Rev. Sheet 2-22-07

REVISIONS	
NAME	DATE

ILLINOIS DEPARTMENT OF TRANSPORTATION  
 SCHEDULE OF QUANTITIES  
 FAP 75 (IL 29)  
 SECTION D 6 RESURFACING 2007  
 CHRISTIAN COUNTY  
 SCALE: VERT. \_\_\_\_\_  
 HORIZ. \_\_\_\_\_  
 DATE \_\_\_\_\_ DRAWN BY \_\_\_\_\_  
 CHECKED BY \_\_\_\_\_

F.A.P. RTE.	SECTION	COUNTY	TOTAL SHEETS	SHEET NO.
75	*	CHRISTIAN	97	35
STA.		TO STA.		
FED. ROAD DIST. NO.		ILLINOIS FED. AID PROJECT		

\*D 6 RESURFACING 2007

PREFORMED PLASTIC PAVEMENT MARKING, TYPE B, LETTERS AND SYMBOLS

LOCATION	LANE	DIRECTION	SYMBOL TYPE	SQ. FT.
IL-29 MAINLINE				
STA 523+05	RTL	EB	ONLY	20.8
STA 523+41	LTL	EB	LEFT TURN	15.6
STA 523+41	RTL	EB	RIGHT TURN	15.6
STA 524+25	RTL	EB	ONLY	20.8
STA 524+60	LTL	EB	LEFT TURN	15.6
STA 524+60	RTL	EB	RIGHT TURN	15.6
STA 526+06	LTL	WB	LEFT TURN	15.6
STA 527+31	LTL	WB	LEFT TURN	15.6
STA 529+44	LTL	EB	LEFT TURN	15.6
STA 530+61	LTL	EB	LEFT TURN	15.6
STA 532+00	2LLT	WB	LEFT TURN	15.6
STA 533+98	2LLT	EB	LEFT TURN	31.2
STA 535+98	2LLT	EB	LEFT TURN	31.2
STA 537+98	2LLT	EB	LEFT TURN	31.2
STA 539+98	2LLT	EB	LEFT TURN	31.2
STA 541+98	2LLT	EB	LEFT TURN	31.2
STA 543+98	2LLT	EB	LEFT TURN	31.2
STA 545+98	2LLT	EB	LEFT TURN	31.2
STA 547+98	2LLT	EB	LEFT TURN	31.2
STA 549+98	2LLT	EB	LEFT TURN	31.2
STA 551+98	2LLT	EB	LEFT TURN	31.2
STA 554+28	LTL	EB	LEFT TURN	15.6
STA 555+79	LTL	EB	LEFT TURN	15.6
STA 557+26	RTL	WB	RIGHT TURN	15.6
STA 557+99	RTL	WB	RIGHT TURN	15.6
STA 558+94	RTL	WB	RIGHT TURN	15.6
STA 559+89	RTL	WB	RIGHT TURN	15.6
STA 561+36	RTL	WB	RIGHT TURN	15.6
STA 572+34	LTL	EB	LEFT TURN	15.6
STA 573+32	LTL	EB	LEFT TURN	15.6
STA 574+20	LTL	WB	LEFT TURN	15.6
STA 575+62	CL	EB	STRAIGHT	11.5
STA 575+62	RL	EB	RIGHT TURN	15.6
STA 575+62	LTL	EB	LEFT TURN	15.6
STA 576+71	CL	EB	LEFT LANE	15.6
STA 576+71	LTL	EB	LEFT TURN	15.6
STA 576+71	RL	EB	RIGHT LANE	15.6
STA 577+76	RTL	S	RIGHT TURN	15.6
CONTINUED	CONTINUED	CONTINUED	CONTINUED	CONTINUED

PREFORMED PLASTIC PAVEMENT MARKING, TYPE B, LETTERS AND SYMBOLS

LOCATION	LANE	DIRECTION	SYMBOL TYPE	SQ. FT.
IL-29 MAINLINE				
STA 577+76	CL	S	STRAIGHT	11.5
STA 577+76	LL	S	LEFT TURN	15.6
STA 579+47	CL	WB	STRAIGHT	11.5
STA 579+47	LL	WB	LEFT TURN	15.6
STA 580+26	CL	WB	STRAIGHT	11.5
STA 580+26	RTL	WB	RIGHT TURN	15.6
STA 580+26	LL	WB	LEFT TURN	15.6
STA 581+57	LTL	EB	LEFT TURN	15.6
STA 48+27	LTL	EB	LEFT TURN	15.6
STA 49+18	LTL	EB	LEFT TURN	15.6
STA 50+23	LTL	WB	LEFT TURN	15.6
STA 50+82	LTL	WB	LEFT TURN	15.6
STA 51+92	LTL	EB	LEFT TURN	15.6
STA 52+81	LTL	EB	LEFT TURN	15.6
STA 53+75	LTL	WB	LEFT TURN	15.6
STA 54+17	LTL	WB	LEFT TURN	15.6
STA 61+64	LTL	EB	LEFT TURN	15.6
STA 62+21	LTL	EB	LEFT TURN	15.6
STA 63+21	LTL	WB	LEFT TURN	15.6
STA 63+70	LTL	WB	LEFT TURN	15.6
STA 11+75	LTL	EB	LEFT TURN	15.6
STA 13+59	LTL	EB	LEFT TURN	15.6
STA 14+99	LTL	EB	LEFT TURN	15.6
STA 16+58	LTL	EB	LEFT TURN	15.6
STA 18+11	LTL	EB	LEFT TURN	15.6
STA 20+09	LTL	WB	LEFT TURN	15.6
STA 21+04	LTL	WB	LEFT TURN	15.6
STA 107+32	LTL	EB	LEFT TURN	15.6
STA 108+52	LTL	EB	LEFT TURN	15.6
STA 109+52	LTL	EB	LEFT TURN	15.6
STA 126+36	LTL	EB	LEFT TURN	15.6
STA 127+31	LTL	EB	LEFT TURN	15.6
STA 128+80	LTL	WB	LEFT TURN	15.6
STA 129+66	LTL	WB	LEFT TURN	15.6
PARK				
STA 9+13	RTL	EB	RIGHT TURN	15.6
STA 9+13	LTL	EB	LEFT TURN	15.6
STA 9+13	CL	EB	STRAIGHT	11.5
WEBSTER				
STA 114+54	RL	N	COMBINATION	26
STA 114+72	LL	N	LEFT TURN	15.6
LINCOLN TRL.				
STA 12+18	RTL	SB	RIGHT TURN	15.6
STA 13+49	RTL	SB	RIGHT TURN	15.6
STA 15+00	RTL	SB	RIGHT TURN	15.6
MAIN CROSS				
STA 10+83	RTL	NB	RIGHT TURN	15.6
TOTAL				1,419.9

PLOT DATE: 2/21/2007  
 FILE NAME: c:\projects\114546803\vehedubadgn  
 USER NAME: jhughes

Rev. Sheet 2-22-07

REVISIONS	
NAME	DATE

ILLINOIS DEPARTMENT OF TRANSPORTATION  
 SCHEDULE OF QUANTITIES  
 FAP 75 (IL 29)  
 SECTION D 6 RESURFACING 2007  
 CHRISTIAN COUNTY  
 SCALE: VERT. \_\_\_\_\_  
 DATE \_\_\_\_\_ HORIZ. \_\_\_\_\_  
 DRAWN BY \_\_\_\_\_  
 CHECKED BY \_\_\_\_\_



F.A.P. RTE.	SECTION	COUNTY	TOTAL SHEETS	SHEET NO.
75		CHRISTIAN	97	37
STA.		TO STA.		
FED. ROAD DIST. NO.		ILLINOIS	FED. AID PROJECT	

PREFORMED PLASTIC PAVEMENT MARKING, TYPE B - LINE 24"

LOCATION	DIRECTION	DESCRIPTION	LENGTH (FOOT)
IL-29 MAINLINE			
STA 524+88.00	EB	STOP BAR	11.5
STA 525+10.00	EB	STOP BAR	12.0
STA 525+32.44	EB	STOP BAR	14.0
STA 525+74.00	WB	STOP BAR	14.3
STA 525+90.01	WB	STOP BAR	12.0
STA 556+07.00	EB	STOP BAR	24.2
STA 556+93.00	WB	STOP BAR	29.4
STA 578+14.00	S	STOP BAR	23.8
STA 578+10.33	SW	STOP BAR	18.8
STA 579+12.00	WB	STOP BAR	23.8
STA 579+32.32	NW	STOP BAR	18.2
STA 52+97.00	EB	STOP BAR	23.0
STA 53+60.00	WB	STOP BAR	23.0
STA 62+36.00	EB	STOP BAR	23.0
STA 63+00.00	WB	STOP BAR	23.0
STA 18+22.00	WB	STOP BAR	27.0
STA 19+97.00	WB	STOP BAR	27.0
CHENEY ST.			
STA 524+76.79	TO STA 524+95.19	S	STOP BAR 20.0
STA 525+03.70	TO STA 525+16.31	S	STOP BAR 13.8
STA 525+63.71	TO STA 525+79.37	N	STOP BAR 18.6
STA 526+15.33	TO STA 526+32.28	NE	STOP BAR 22.0
PARK			
STA 9+51.00	E	STOP BAR	12.0
STA 9+66.00	E	STOP BAR	12.0
STA 9+47.00	SE	STOP BAR	19.9
NORTH WEBSTER			
STA 115+05.00	N	STOP BAR	12.0
STA 115+10.00	N	STOP BAR	12.0
STA 114+94.00	NE	STOP BAR	17.8
N. MAIN ST.	S	STOP BAR	20.0
S. MAIN ST.	N	STOP BAR	17.0
McADAM	S	STOP BAR	16.0
McADAM	S	STOP BAR	26.0
MAIN CROSS			
STA 10+85.00	N	STOP BAR	12.0
STA 11+04.00	N	STOP BAR	16.0
LINCOLN TRAIL			
STA 11+67.00	S	STOP BAR	16.0
STA 11+87.00	S	STOP BAR	12.0
KENNEDY			
N. LAKE		STOP BAR	18.3
S. LAKE		STOP BAR	13.2
TOTAL			722.1

HOT-MIX ASPHALT SURFACE REMOVAL, 3/4"

LOCATION	BRIDGE WIDTH (FOOT)	AREA (SQ YD)	
I-29 MAINLINE			
STA 27+47.00	TO STA 28+80.00	44	650.22
STA 58+79.00	TO STA 60+81.00	30	673.33
TOTAL			1,323.55

HMA SHOULDERS 8"

LOCATION	LT SHLD WIDTH	RT SHLD WIDTH	AREA (SQ YD)	
I-29 MAINLINE				
STA 28+80.00	TO STA 31+19.00	3	3	159.33
STA 32+05.00	TO STA 39+52.00	0	3	249.00
STA 32+05.00	TO STA 39+86.00	3	0	260.33
STA 40+28.00	TO STA 41+98.04 BK	0	3	56.68
STA 40+50.00	TO STA 41+98.04 BK	3	0	49.35
STA 42+39.60 AH	TO STA 58+66.00 BK	3	3	1,084.27
STA 58+70.03 AH	TO STA 58+79.00	3	3	5.98
STA 60+81.00	TO STA 79+60.00	0	3	626.33
STA 60+81.00	TO STA 80+05.00	3	0	641.33
STA 80+48.00	TO STA 100+89.78	0	3	680.59
STA 80+45.00	TO STA 100+89.78	3	0	681.59
STA 137+17.09	TO STA 154+00.00	0	3	560.97
STA 174+00.00	TO STA 204+26.00	0	3	1,008.67
STA 137+17.09	TO STA 139+21.00	3	0	67.97
STA 139+75.00	TO STA 154+00.00	3	0	475.00
STA 174+00.00	TO STA 204+16.00	3	0	1,005.33
STA 205+27.00	TO STA 206+47.00	0	3	40.00
STA 205+09.00	TO STA 206+47.00	3	0	46.00
TOTAL				7,698.72

VALVE VAULTS TO BE ADJUSTED

LOCATION	EACH
IL 29 MAINLINE	
STA 526+40.00	RT 1
STA 543+51.00	RT 1
STA 543+55.00	RT 1
STA 543+90.00	RT 1
STA 543+95.00	RT 1
STA 546+91.00	RT 1
STA 551+22.00	RT 1
STA 551+30.00	RT 1
STA 564+55.00	RT 1
STA 564+55.00	RT 1
STA 564+59.00	RT 1
STA 577+85.00	RT 1
STA 115+02.00	LT 1
STA 582+62.00	RT 1
STA 49+49.00	RT 1
STA 50+52.00	RT 1
STA 53+11.00	RT 1
STA 53+56.00	RT 1
STA 62+48.00	RT 1
STA 69+61.00	RT 1
STA 79+60.00	RT 1
STA 79+87.00	RT 1
TOTAL	22

MANHOLES TO BE ADJUSTED

LOCATION	EACH
IL 29 MAINLINE	
STA 539+77.00	LT 1
STA 571+18.00	LT 1
STA 573+14.00	LT 1
STA 573+95.00	LT 1
STA 574+07.00	CL 1
STA 577+53.00	CL 1
STA 115+00.00	1
STA 53+08.00	LT 1
STA 53+16.00	LT 1
STA 53+45.00	RT 1
STA 69+32.00	RT 1
STA 11+91.00	MEDIAN 1
STA 127+87.00	RT 1
TOTAL	13

REVISIONS	
NAME	DATE

ILLINOIS DEPARTMENT OF TRANSPORTATION  
 SCHEDULE OF QUANTITIES  
 FAP 75 (IL 29)  
 SECTION D 6 RESURFACING 2007  
 CHRISTIAN COUNTY

SCALE: VERT.      DRAWN BY  
 DATE                      CHECKED BY

⚠ Rev. Sheet 2-22-07





CONTRACT NO. 72826				
F.A.P. RTE.	SECTION	COUNTY	TOTAL SHEETS	SHEET NO.
75		CHRISTIAN	97	60
STA.		TO STA.		
FED. ROAD DIST. NO.		ILLINOIS FED. AID PROJECT		

• D 6 RESURFACING 2007

LEGEND

- 1.THERMOPLASTIC PAVEMENT MARKING - LINE 5" (WHITE)
- 2.THERMOPLASTIC PAVEMENT MARKING - LINE 5" (YELLOW)
- 3.THERMOPLASTIC PAVEMENT MARKING - LINE 8" (WHITE)
- 4.THERMOPLASTIC PAVEMENT MARKING - LINE 12" (WHITE)
- 5.THERMOPLASTIC PAVEMENT MARKING - LINE 12" (YELLOW)
- 6.PREFORMED PLASTIC PAVEMENT MARKING, TYPE B - LINE 5" (WHITE)
- 7.PREFORMED PLASTIC PAVEMENT MARKING, TYPE B - LINE 6" (WHITE)
- 8.PREFORMED PLASTIC PAVEMENT MARKING, TYPE B - LINE 24" (WHITE)
- 9.PREFORMED PLASTIC PAVEMENT MARKING, TYPE B - LETTERS AND SYMBOLS (WHITE)
- ▶ TWO-WAY AMBER RPM
- ▶ ONE-WAY AMBER RPM
- ▷ ONE-WAY CRYSTAL RPM

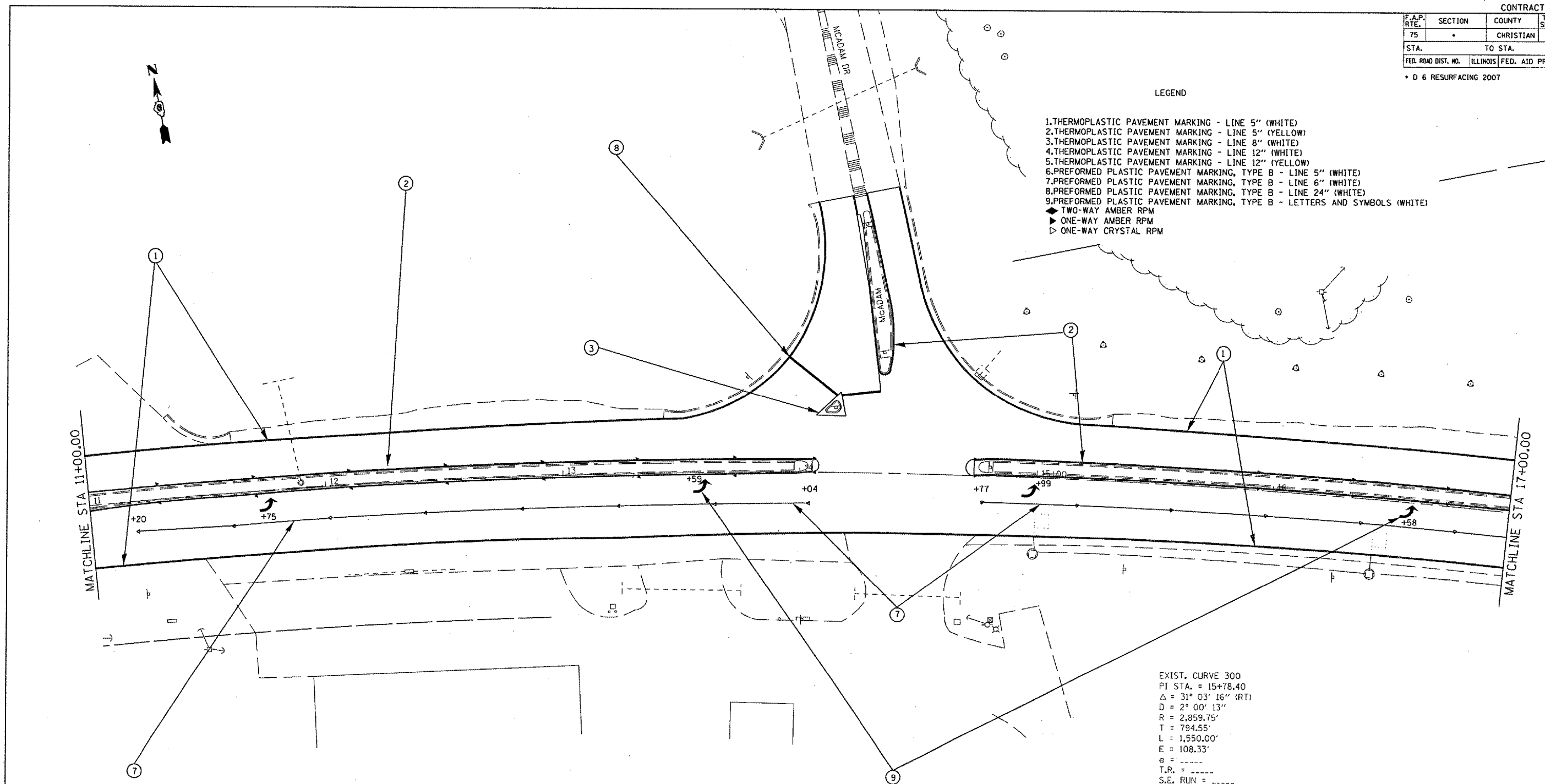

EXIST. CURVE 300  
 PI STA. = 15+78.40  
 $\Delta = 31^\circ 03' 16''$  (RT)  
 $D = 2^\circ 00' 13''$   
 $R = 2,859.75'$   
 $L = 794.55'$   
 $E = 1,550.00'$   
 $e =$   
 $T.R. =$   
 $S.E. RUN =$   
 $P.C. STA. = 7+83.85$   
 $P.T. STA. = 23+33.85$

DATE: 2/21/2007  
 FILE NAME: \\sfs\6803\28\p1\m1.dgn  
 PLOT SCALE: 42.58281 / IN.  
 USER NAME: laughlin-1

Rev. Sheet 2-22-07

REVISIONS	
NAME	DATE

ILLINOIS DEPARTMENT OF TRANSPORTATION  
 PAVEMENT MARKING PLAN  
 FAP 75 (IL 29)  
 SECTION D 6 RESURFACING 2007  
 CHRISTIAN COUNTY

SCALE: VERT. \_\_\_\_\_  
 HORIZ. \_\_\_\_\_  
 DATE \_\_\_\_\_  
 DRAWN BY \_\_\_\_\_  
 CHECKED BY \_\_\_\_\_

F.A.P. RTE.	SECTION	COUNTY	TOTAL SHEETS	SHEET NO.
75		CHRISTIAN	97	61
STA.		TO STA.		
FED. ROAD DIST. NO.		ILLINOIS FED. AID PROJECT		

• D 6 RESURFACING 2007

LEGEND

- 1.THERMOPLASTIC PAVEMENT MARKING - LINE 5" (WHITE)
- 2.THERMOPLASTIC PAVEMENT MARKING - LINE 5" (YELLOW)
- 3.THERMOPLASTIC PAVEMENT MARKING - LINE 8" (WHITE)
- 4.THERMOPLASTIC PAVEMENT MARKING - LINE 12" (WHITE)
- 5.THERMOPLASTIC PAVEMENT MARKING - LINE 12" (YELLOW)
- 6.PREFORMED PLASTIC PAVEMENT MARKING, TYPE B - LINE 5" (WHITE)
- 7.PREFORMED PLASTIC PAVEMENT MARKING, TYPE B - LINE 6" (WHITE)
- 8.PREFORMED PLASTIC PAVEMENT MARKING, TYPE B - LINE 24" (WHITE)
- 9.PREFORMED PLASTIC PAVEMENT MARKING, TYPE B - LETTERS AND SYMBOLS (WHITE)
- ◆ TWO-WAY AMBER RPM
- ▶ ONE-WAY AMBER RPM
- ▷ ONE-WAY CRYSTAL RPM

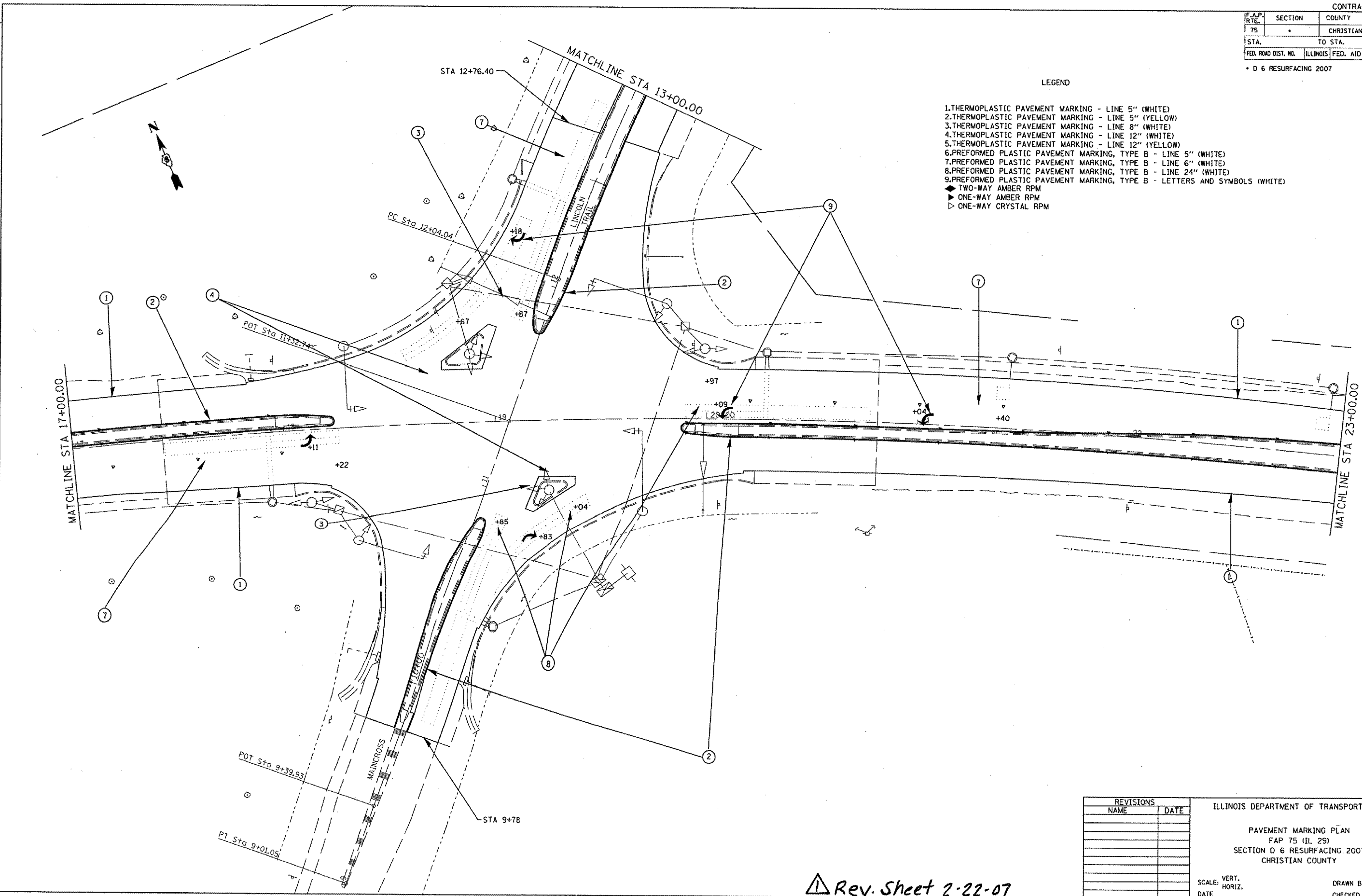

PLOT DATE = 2/21/2007  
 PLOT SCALE = 40:1  
 USER NAME = joughlinr1

REVISIONS	
NAME	DATE

ILLINOIS DEPARTMENT OF TRANSPORTATION  
 PAVEMENT MARKING PLAN  
 FAP 75 (IL 29)  
 SECTION D 6 RESURFACING 2007  
 CHRISTIAN COUNTY  
 SCALE: VERT. \_\_\_\_\_  
 HORIZ. \_\_\_\_\_  
 DATE \_\_\_\_\_  
 DRAWN BY \_\_\_\_\_  
 CHECKED BY \_\_\_\_\_

Rev. Sheet 2-22-07

F.A.P. RTE.	SECTION	COUNTY	TOTAL SHEETS	SHEET NO.
75		CHRISTIAN	97	68
STA.		TO STA.		
FED. ROAD DIST. NO.		ILLINOIS FED. AID PROJECT		

D 6 RESURFACING 2007

- LEGEND
- 1.THERMOPLASTIC PAVEMENT MARKING - LINE 5" (WHITE)
  - 2.THERMOPLASTIC PAVEMENT MARKING - LINE 5" (YELLOW)
  - 2a.THERMOPLASTIC PAVEMENT MARKING - LINE 5" (DOUBLE YELLOW)
  - 2b. THERMOPLASTIC PAVEMENT MARKING LINE 6" (WHITE)
  - 3.THERMOPLASTIC PAVEMENT MARKING - LINE 8" (WHITE)
  - 4.THERMOPLASTIC PAVEMENT MARKING - LINE 12" (WHITE)
  - 5.THERMOPLASTIC PAVEMENT MARKING - LINE 12" (YELLOW)
  - 6.PREFORMED PLASTIC PAVEMENT MARKING, TYPE B - LINE 5" (WHITE)
  - 7.PREFORMED PLASTIC PAVEMENT MARKING, TYPE B - LINE 6" (WHITE)
  - 8.PREFORMED PLASTIC PAVEMENT MARKING, TYPE B - LINE 24" (WHITE)
  - 9.PREFORMED PLASTIC PAVEMENT MARKING, TYPE B - LETTERS AND SYMBOLS (WHITE)
  - ▶ TWO-WAY AMBER RPM
  - ▶ ONE-WAY AMBER RPM
  - ▷ ONE-WAY CRYSTAL RPM

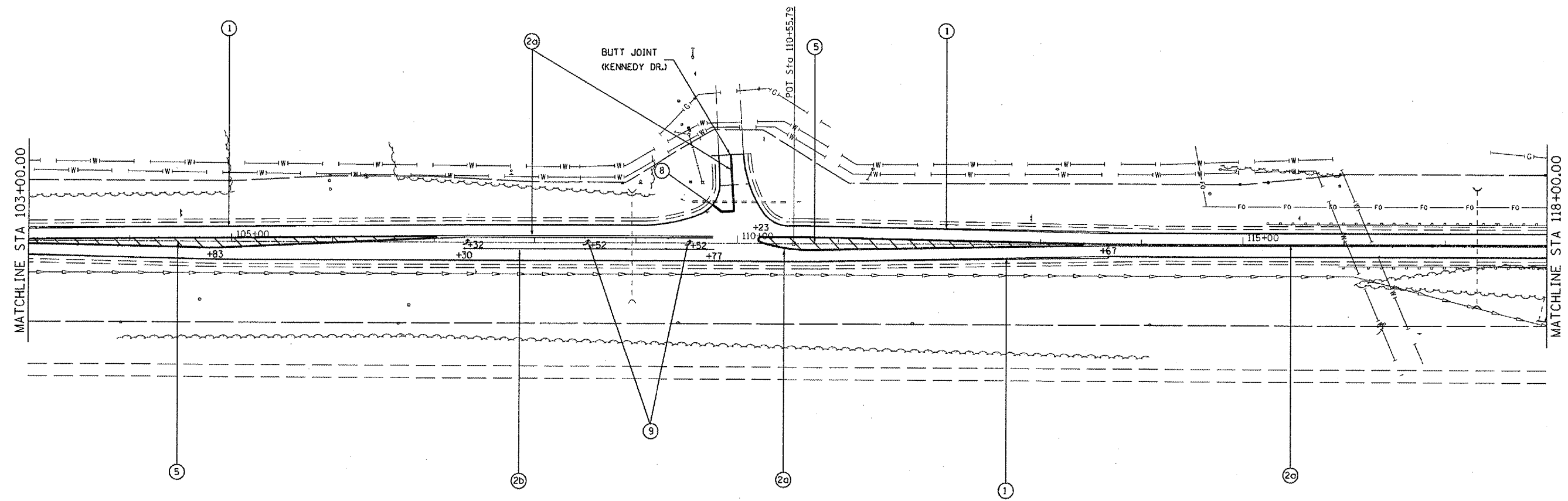

PLOT DATE = 2/21/2007  
 PLOT SCALE = 1/8"=1'-0"  
 USER NAME = boughlin

△ Rev. Sheet 2-22-07

REVISIONS	
NAME	DATE

ILLINOIS DEPARTMENT OF TRANSPORTATION  
 PAVEMENT MARKING PLAN  
 FAP 75 (IL 29)  
 SECTION D 6 RESURFACING 2007  
 CHRISTIAN COUNTY

SCALE: VERT. \_\_\_\_\_  
 HORIZ. \_\_\_\_\_  
 DATE \_\_\_\_\_  
 DRAWN BY \_\_\_\_\_  
 CHECKED BY \_\_\_\_\_

F.A.P. RTE.	SECTION	COUNTY	TOTAL SHEETS	SHEET NO.
75		CHRISTIAN	97	69
STA.		TO STA.		
FED. ROAD DIST. NO.	ILLINOIS	FED. AID PROJECT		

D 6 RESURFACING 2007

- LEGEND
- 1.THERMOPLASTIC PAVEMENT MARKING - LINE 5" (WHITE)
  - 2.THERMOPLASTIC PAVEMENT MARKING - LINE 5" (YELLOW)
  - 2a.THERMOPLASTIC PAVEMENT MARKING - LINE 5" (DOUBLE YELLOW)
  - 2b. THERMOPLASTIC PAVEMENT MARKING - LINE 6" (WHITE)
  - 3.THERMOPLASTIC PAVEMENT MARKING - LINE 8" (WHITE)
  - 4.THERMOPLASTIC PAVEMENT MARKING - LINE 12" (WHITE)
  - 5.THERMOPLASTIC PAVEMENT MARKING - LINE 12" (YELLOW)
  - 6.PREFORMED PLASTIC PAVEMENT MARKING, TYPE B - LINE 5" (WHITE)
  - 7.PREFORMED PLASTIC PAVEMENT MARKING, TYPE B - LINE 6" (WHITE)
  - 8.PREFORMED PLASTIC PAVEMENT MARKING, TYPE B - LINE 24" (WHITE)
  - 9.PREFORMED PLASTIC PAVEMENT MARKING, TYPE B - LETTERS AND SYMBOLS (WHITE)
  - ◆ TWO-WAY AMBER RPM
  - ▶ ONE-WAY AMBER RPM
  - ▷ ONE-WAY CRYSTAL RPM

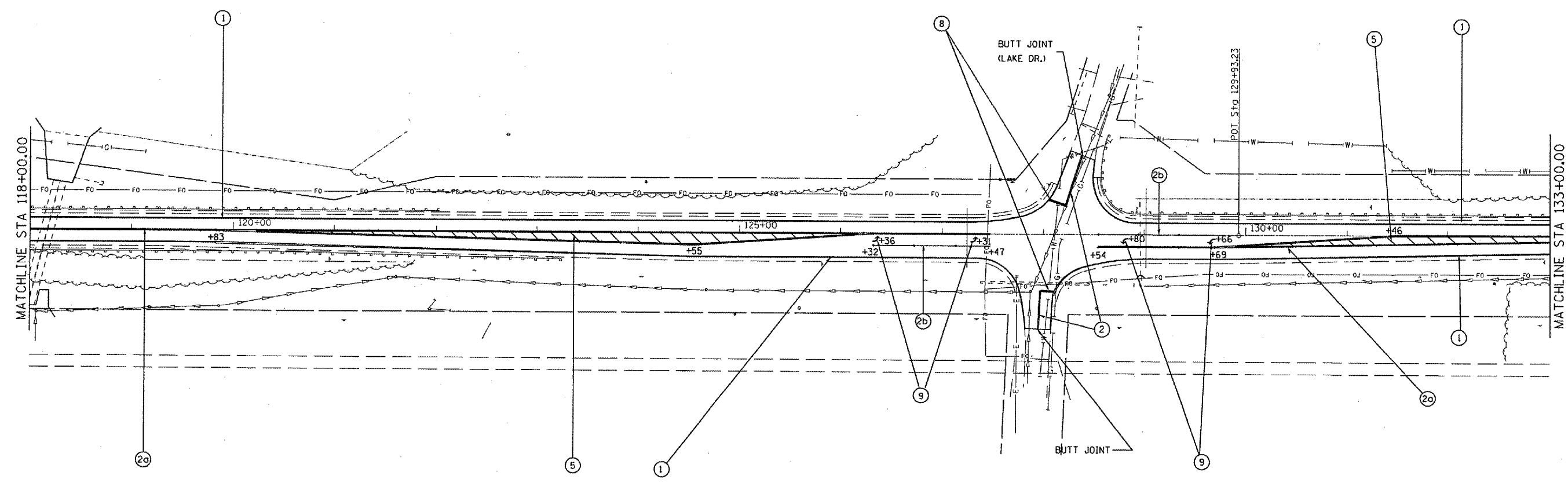

PLOT DATE = 2/21/2007  
 PLOT SCALE = 1/8" = 100'-0"  
 USER NAME = bough/jr=1

△ Rev. Sheet 2-22-07

REVISIONS	
NAME	DATE

ILLINOIS DEPARTMENT OF TRANSPORTATION

PAVEMENT MARKING PLAN  
 FAP 75 (IL 29)  
 SECTION D 6 RESURFACING 2007  
 CHRISTIAN COUNTY

VERT. SCALE:     DRAWN BY  
 HORIZ.         CHECKED BY  
 DATE

F.A.P. RTE.	SECTION	COUNTY	TOTAL SHEETS	SHEET NO.
75		CHRISTIAN	97	71
STA.		TO STA.		
FED. ROAD DIST. NO.		ILLINOIS	FED. AID PROJECT	

D 6 RESURFACING 2007

- LEGEND
- 1.THERMOPLASTIC PAVEMENT MARKING - LINE 5" (WHITE)
  - 2.THERMOPLASTIC PAVEMENT MARKING - LINE 5" (YELLOW)
  - 2a.THERMOPLASTIC PAVEMENT MARKING - LINE 5" (DOUBLE YELLOW)
  - 2b.THERMOPLASTIC PAVEMENT MARKING - LINE 6" (WHITE)
  - 3.THERMOPLASTIC PAVEMENT MARKING - LINE 8" (WHITE)
  - 4.THERMOPLASTIC PAVEMENT MARKING - LINE 12" (WHITE)
  - 5.THERMOPLASTIC PAVEMENT MARKING - LINE 12" (YELLOW)
  - 6.PREFORMED PLASTIC PAVEMENT MARKING, TYPE B - LINE 5" (WHITE)
  - 7.PREFORMED PLASTIC PAVEMENT MARKING, TYPE B - LINE 6" (WHITE)
  - 8.PREFORMED PLASTIC PAVEMENT MARKING, TYPE B - LINE 24" (WHITE)
  - 9.PREFORMED PLASTIC PAVEMENT MARKING, TYPE B - LETTERS AND SYMBOLS (WHITE)
  - ◀ TWO-WAY AMBER RPM
  - ▶ ONE-WAY AMBER RPM
  - ▷ ONE-WAY CRYSTAL RPM

EXIST. CURVE 309  
 PI STA. = 155+95.00  
 $\Delta = 0^\circ 36' 53''$  (RT)  
 $D = 0^\circ 04' 13''$   
 $R = 81,544.64'$   
 $T = 437.50'$   
 $L = 875.00'$   
 $e = 1.17'$   
 $e = \text{-----}$   
 $T.R. = \text{-----}$   
 $S.E. \text{ RUN} = \text{-----}$   
 P.C. STA. = 151+57.49  
 P.T. STA. = 160+32.49

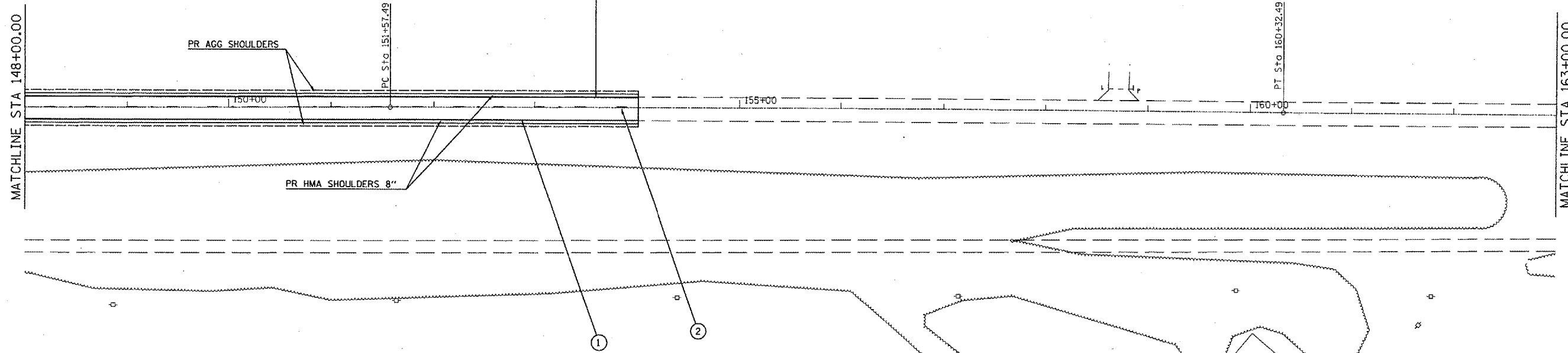

• OMISSION: 154+00 TO 174+00

PLOT DATE : 2/21/2007  
 PLOT SCALE : 1/8"=1'-0"  
 USER NAME : jrough1

Rev. Sheet 2-22-07

REVISIONS	
NAME	DATE

ILLINOIS DEPARTMENT OF TRANSPORTATION  
 PAVEMENT MARKING PLAN  
 FAP 75 (IL 29)  
 SECTION D 6 RESURFACING 2007  
 CHRISTIAN COUNTY

SCALE: VERT. \_\_\_\_\_  
 HORIZ. \_\_\_\_\_

DATE \_\_\_\_\_ DRAWN BY \_\_\_\_\_  
 CHECKED BY \_\_\_\_\_

F.A.P. RTE.	SECTION	COUNTY	TOTAL SHEETS	SHEET NO.
75	*	CHRISTIAN	97	72

STA.	TO STA.
FED. ROAD DIST. NO.	ILLINOIS FED. AID PROJECT

D 6 RESURFACING 2007

- LEGEND
- 1.THERMOPLASTIC PAVEMENT MARKING - LINE 5" (WHITE)
  - 2.THERMOPLASTIC PAVEMENT MARKING - LINE 5" (YELLOW)
  - 2a.THERMOPLASTIC PAVEMENT MARKING - LINE 5" (DOUBLE YELLOW)
  - 2b.THERMOPLASTIC PAVEMENT MARKING - LINE 6" (WHITE)
  - 3.THERMOPLASTIC PAVEMENT MARKING - LINE 8" (WHITE)
  - 4.THERMOPLASTIC PAVEMENT MARKING - LINE 12" (WHITE)
  - 5.THERMOPLASTIC PAVEMENT MARKING - LINE 12" (YELLOW)
  - 6.PREFORMED PLASTIC PAVEMENT MARKING, TYPE B - LINE 5" (WHITE)
  - 7.PREFORMED PLASTIC PAVEMENT MARKING, TYPE B - LINE 6" (WHITE)
  - 8.PREFORMED PLASTIC PAVEMENT MARKING, TYPE B - LINE 24" (WHITE)
  - 9.PREFORMED PLASTIC PAVEMENT MARKING, TYPE B - LETTERS AND SYMBOLS (WHITE)
  - ◆ TWO-WAY AMBER RPM
  - ▶ ONE-WAY AMBER RPM
  - ▷ ONE-WAY CRYSTAL RPM

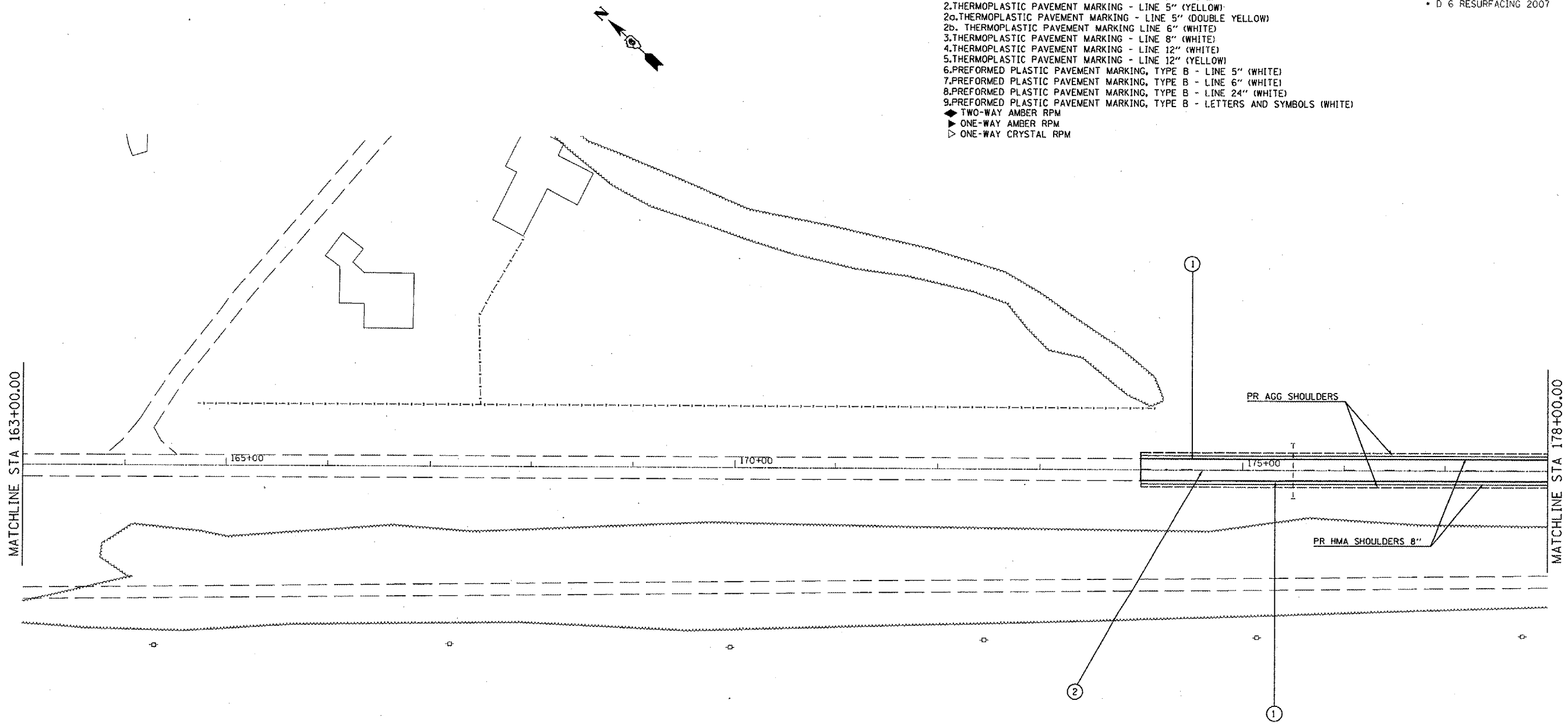

• OMISSION: 154+00 TO 174+00

PLOT DATE = 2/21/2007  
 FILE NAME = c:\pwworkspace\105468338\pwworkspace\105468338.dwg  
 USER NAME = bnguyen

Rev. Sheet 2-22-07

REVISIONS	
NAME	DATE

ILLINOIS DEPARTMENT OF TRANSPORTATION

PAVEMENT MARKING PLAN  
 FAP 75 (IL 29)  
 SECTION D 6 RESURFACING 2007  
 CHRISTIAN COUNTY

SCALE: VERT. \_\_\_\_\_  
 HORIZ. \_\_\_\_\_

DATE \_\_\_\_\_ DRAWN BY \_\_\_\_\_  
 CHECKED BY \_\_\_\_\_

F.A.P. RTE.	SECTION	COUNTY	TOTAL SHEETS	SHEET NO.
75		CHRISTIAN	97	75A
STA.		TO STA.		
FED. ROAD DIST. NO.		ILLINOIS FED. AID PROJECT		

• D 6 RESURFACING 2007

LEGEND

- 1.THERMOPLASTIC PAVEMENT MARKING - LINE 5" (WHITE)
- 2.THERMOPLASTIC PAVEMENT MARKING - LINE 5" (YELLOW)
- 3.THERMOPLASTIC PAVEMENT MARKING - LINE 8" (WHITE)
- 4.THERMOPLASTIC PAVEMENT MARKING - LINE 12" (WHITE)
- 5.THERMOPLASTIC PAVEMENT MARKING - LINE 12" (YELLOW)
- 6.PREFORMED PLASTIC PAVEMENT MARKING, TYPE B - LINE 5" (WHITE)
- 7.PREFORMED PLASTIC PAVEMENT MARKING, TYPE B - LINE 6" (WHITE)
- 8.PREFORMED PLASTIC PAVEMENT MARKING, TYPE B - LINE 24" (WHITE)
- 9.PREFORMED PLASTIC PAVEMENT MARKING, TYPE B - LETTERS AND SYMBOLS (WHITE)
- ◀ TWO-WAY AMBER RPM
- ▶ ONE-WAY AMBER RPM
- ▷ ONE-WAY CRYSTAL RPM

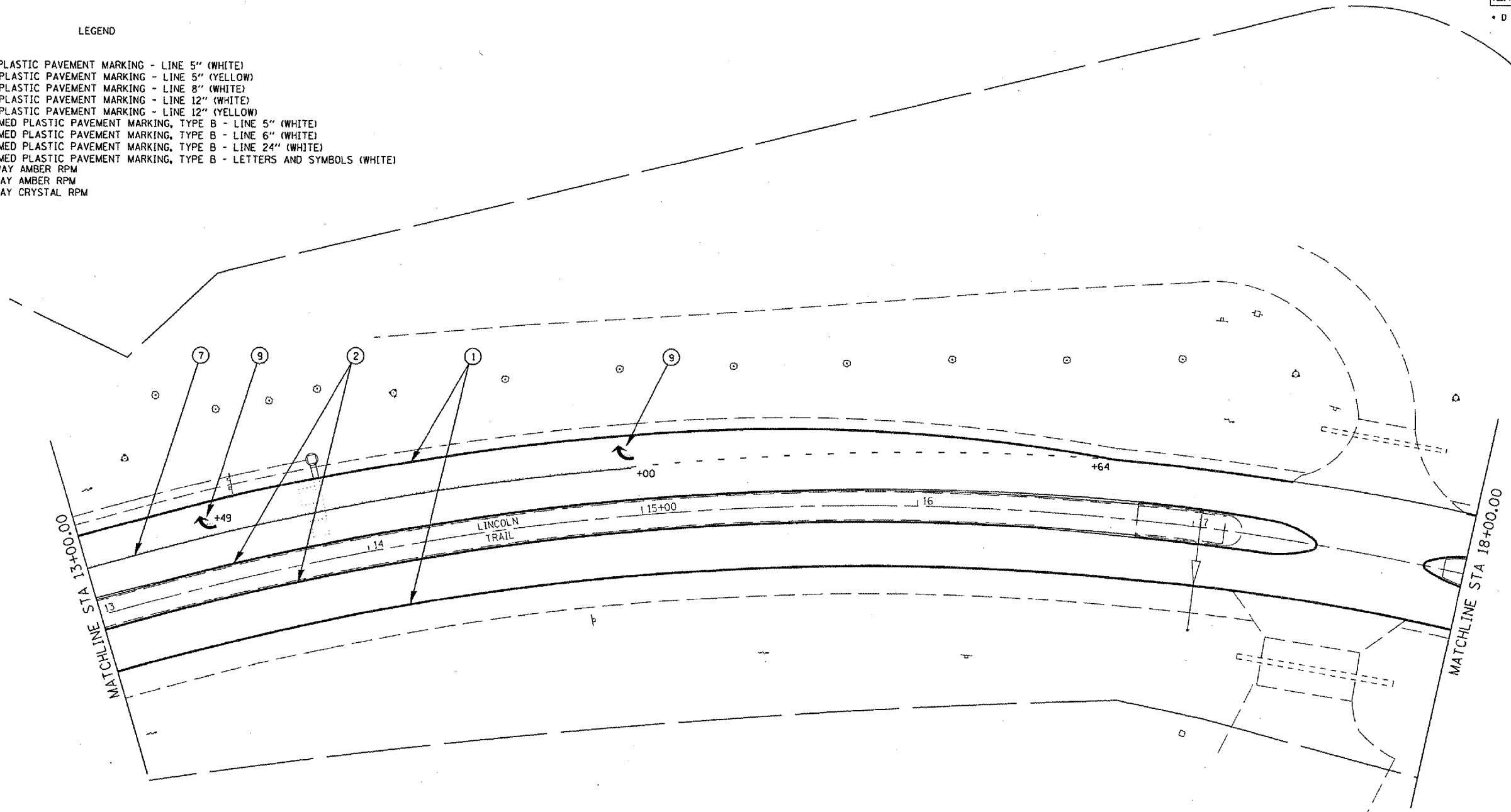

EXIST. CURVE 93  
 PI STA. = 16+25.18  
 $\Delta = 46^\circ 20' 27''$  (RT)  
 $D = 5^\circ 49' 22''$   
 $R = 984.00'$   
 $T = 421.14'$   
 $L = 795.86'$   
 $E = 86.34'$   
 $e = \text{-----}$   
 $T.R. = \text{-----}$   
 $S.E. RUN = \text{-----}$   
 P.C. STA. = 12+04.04  
 P.T. STA. = 19+99.90

PLOT DATE = 2/21/2007  
 PLOT SCALE = 40:300' / IN.  
 USER NAME = laughlinr1

Rev. Sheet 2-22-07

REVISIONS	
NAME	DATE

ILLINOIS DEPARTMENT OF TRANSPORTATION  
 PAVEMENT MARKING PLAN  
 FAP 75 (IL 29)  
 SECTION D 6 RESURFACING 2007  
 CHRISTIAN COUNTY  
 SCALE: VERT. \_\_\_\_\_  
 HORIZ. \_\_\_\_\_  
 DATE \_\_\_\_\_  
 DRAWN BY \_\_\_\_\_  
 CHECKED BY \_\_\_\_\_

F.A.P. RTE.	SECTION	COUNTY	TOTAL SHEETS	SHEET NO.
75		CHRISTIAN	97	75B
STA.		TO STA.		
FED. ROAD DIST. NO.		ILLINOIS FED. AID PROJECT		

• D 6 RESURFACING 2007

LEGEND

- 1.THERMOPLASTIC PAVEMENT MARKING - LINE 5" (WHITE)
- 2.THERMOPLASTIC PAVEMENT MARKING - LINE 5" (YELLOW)
- 3.THERMOPLASTIC PAVEMENT MARKING - LINE 8" (WHITE)
- 4.THERMOPLASTIC PAVEMENT MARKING - LINE 12" (WHITE)
- 5.THERMOPLASTIC PAVEMENT MARKING - LINE 12" (YELLOW)
- 6.PREFORMED PLASTIC PAVEMENT MARKING, TYPE B - LINE 5" (WHITE)
- 7.PREFORMED PLASTIC PAVEMENT MARKING, TYPE B - LINE 6" (WHITE)
- 8.PREFORMED PLASTIC PAVEMENT MARKING, TYPE B - LINE 24" (WHITE)
- 9.PREFORMED PLASTIC PAVEMENT MARKING, TYPE B - LETTERS AND SYMBOLS (WHITE)
- ◆ TWO-WAY AMBER RPM
- ▶ ONE-WAY AMBER RPM
- ▷ ONE-WAY CRYSTAL RPM

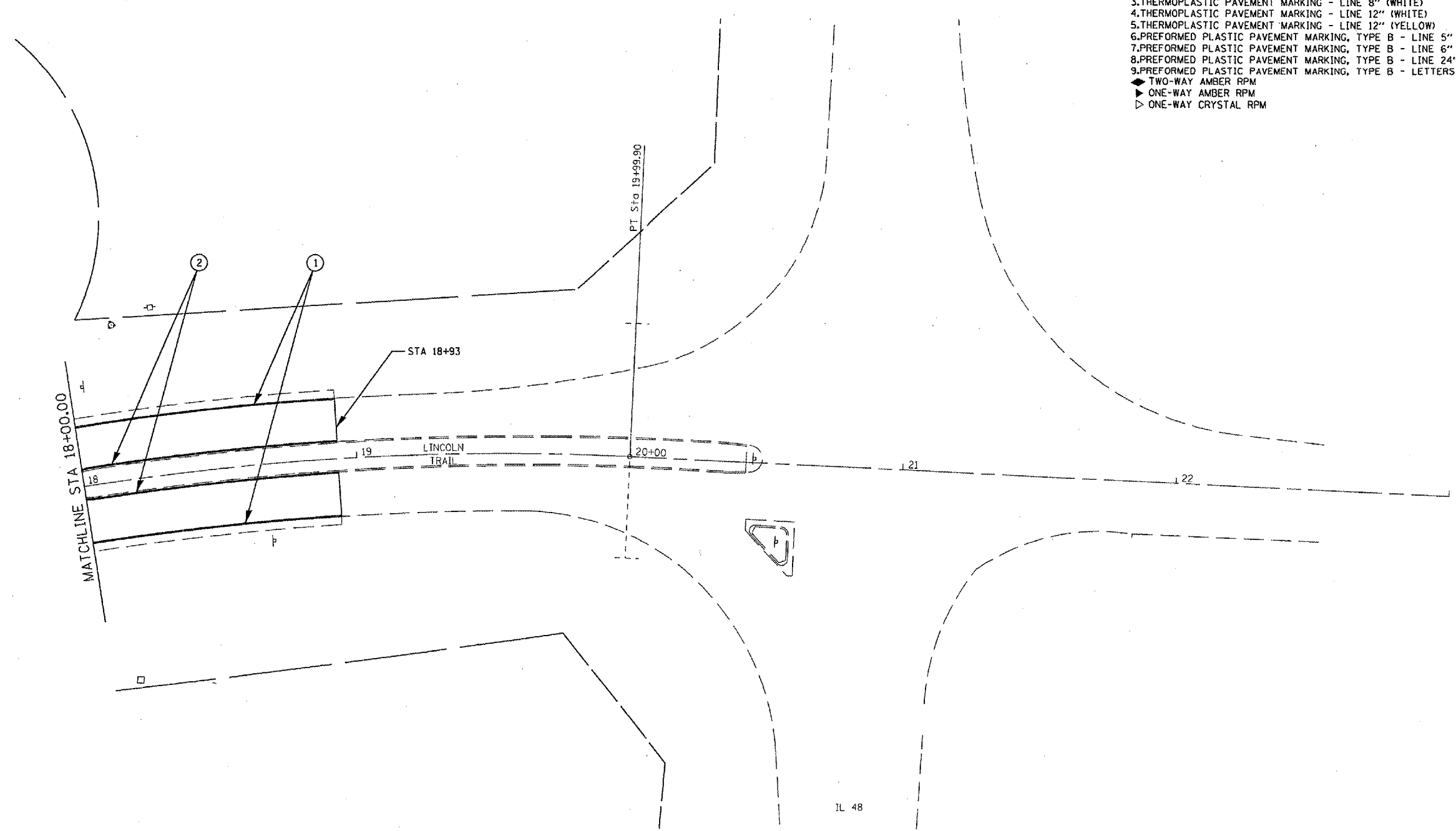

PLOT DATE = 2/21/2007  
 FILE NAME = s:\projects\72826\72826\plan.dgn  
 USER SCALE = 1/8" = 1'-0"  
 USER NAME = boughner

▲ Rev. Sheet 2-22-07

REVISIONS	
NAME	DATE

ILLINOIS DEPARTMENT OF TRANSPORTATION  
 PAVEMENT MARKING PLAN  
 FAP 75 (IL 29)  
 SECTION D 6 RESURFACING 2007  
 CHRISTIAN COUNTY

SCALE: VERT. \_\_\_\_\_  
 HORIZ. \_\_\_\_\_  
 DATE \_\_\_\_\_

DRAWN BY \_\_\_\_\_  
 CHECKED BY \_\_\_\_\_



CONTRACT NO. 72826				
F.A.P. RTE.	SECTION	COUNTY	TOTAL SHEETS	SHEET NO.
75		CHRISTIAN	97	83
STA.		TO STA.		
FED. ROAD DIST. NO.		ILLINOIS FED. AID PROJECT		

D 6 RESURFACING 2007

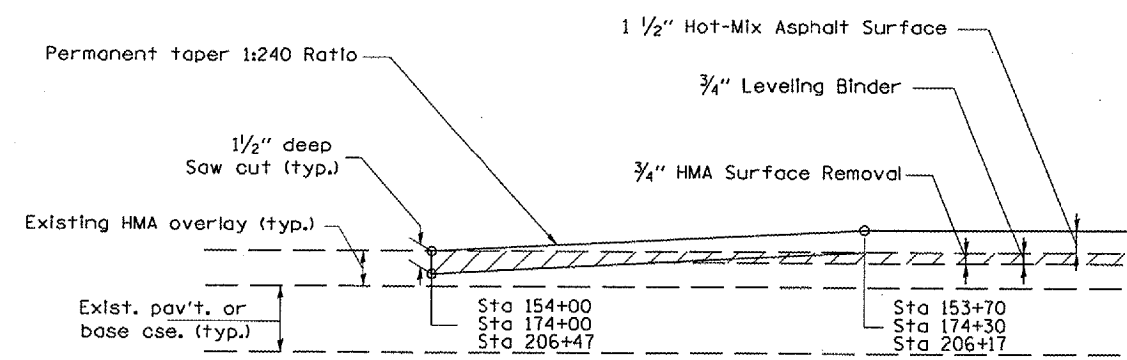

**BUTT JOINT DETAIL**  
IL 29

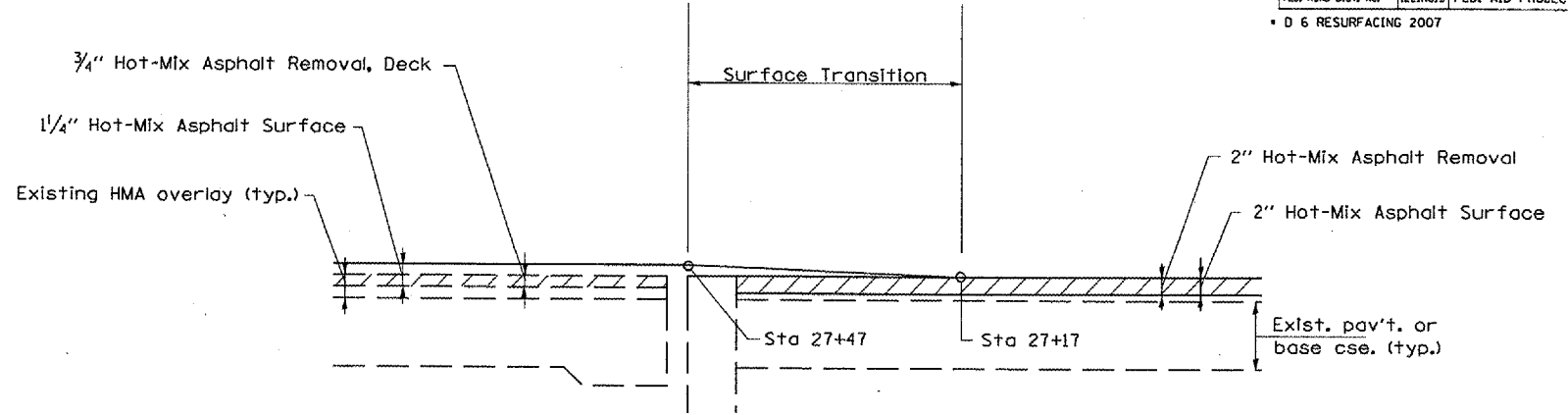

**RAMPING DETAIL**  
@ STRUCTURE

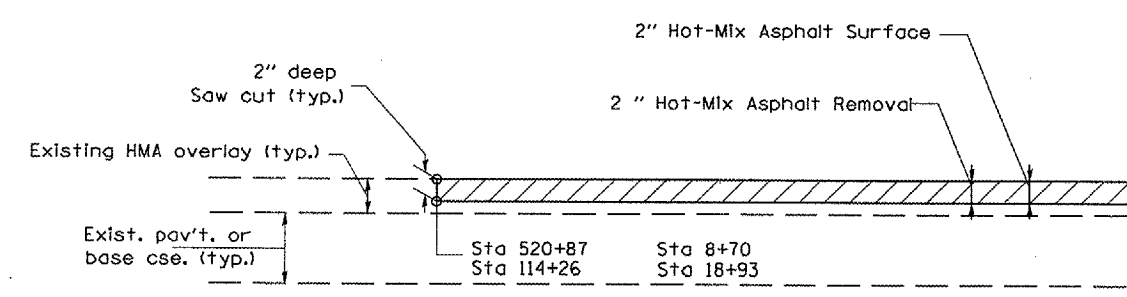

**RAMPING DETAIL**  
IL 29

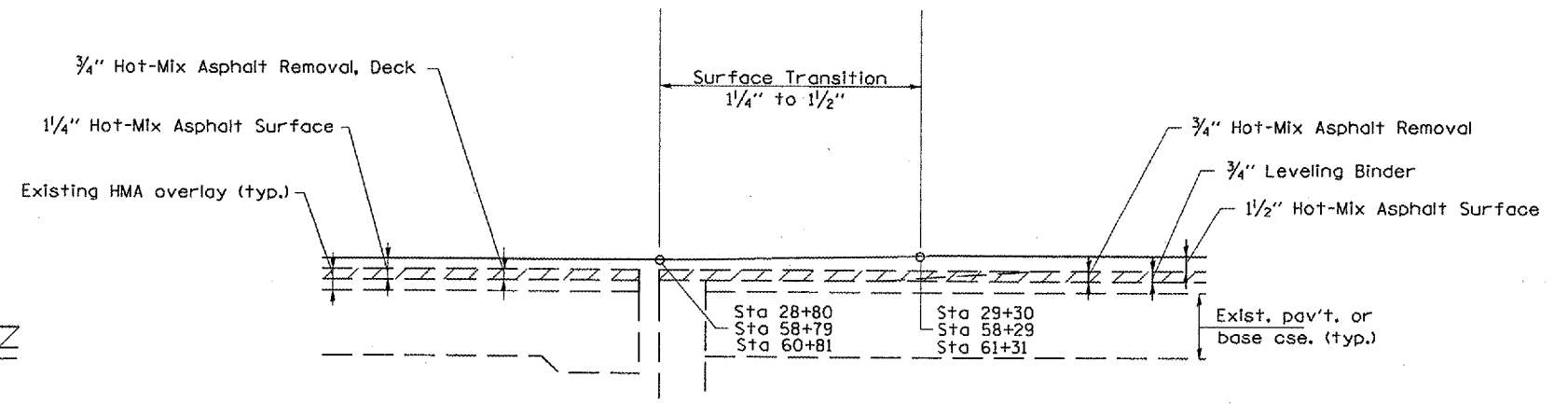

**RAMPING DETAIL**  
@ STRUCTURES

- NOTES:
1. THE SAW CUTS FOR BUTT JOINTS SHALL BE INCLUDED IN THE COST OF HOT-MIX ASPHALT SURFACE REMOVAL- BUTT JOINT.
  2. THE SAW CUTS FOR THE RAMPING DETAIL SHALL BE INCLUDED IN THE COST OF HOT-MIX ASPHALT SURFACE REMOVAL 2".
  3. CONCERNING STRUCTURE DETAILS: PAVE DIRECTLY OVER EXPANSION JOINT AREAS. THIS ASPHALT WILL BE REMOVED DURING POLYMER CONCRETE REMOVAL OPERATIONS AND INCLUDED IN THE COST OF POLYMER CONCRETE.

REVISIONS	
NAME	DATE

ILLINOIS DEPARTMENT OF TRANSPORTATION  
**BUTT JOINT/ RAMPING DETAIL**  
 FAP 75(IL 29)  
 SECTION D 6 RESURFACING 2007  
 CHRISTIAN COUNTY  
 SCALE: VERT. \_\_\_\_\_ DRAWN BY \_\_\_\_\_  
 HORIZ. \_\_\_\_\_ CHECKED BY \_\_\_\_\_  
 DATE \_\_\_\_\_

*Rev. Sheet 2-22-07*

PLOT DATE: 2/21/2007  
 FILE NAME: c:\p\proj\res\4654603\details.dgn  
 PLOT SCALE: 1/8" = 1'-0"  
 PLOT NAME: 10001101

