

F.A.U. RTE.	SECTION	COUNTY	TOTAL SHEETS	SHEET NO.
9079	65BR	MADISON	46	9
STA.		TO STA.		
FED. ROAD DIST. NO.		ILLINOIS	FED. AID PROJECT	

NOTE: ALL MEASUREMENTS ARE PULLED DIRECT

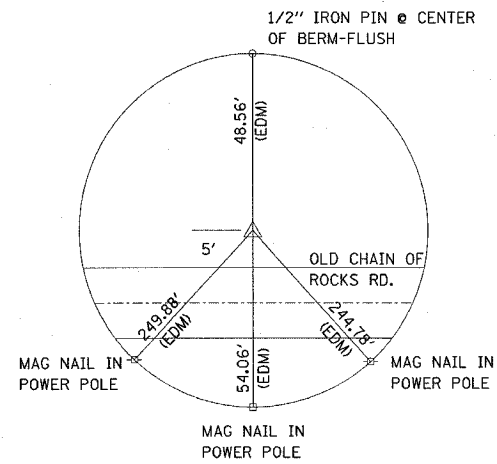

TIE POINT #1

IRON PIN WITH IDOT CAP (FLUSH)
1379.5'± (EDM) WEST OF CENTER OF
OLD CHAIN OF ROCKS RD BRIDGE
OVER MADISON COUNTY DITCH

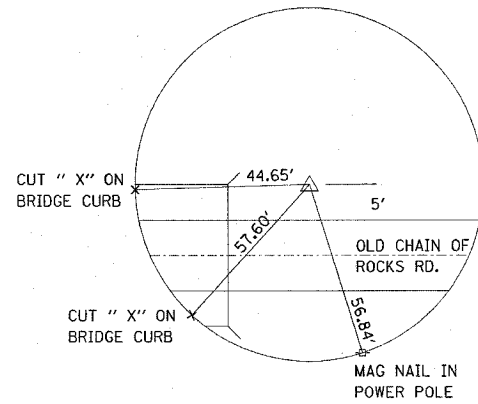

TIE POINT #2

IRON PIN WITH IDOT CAP (FLUSH)

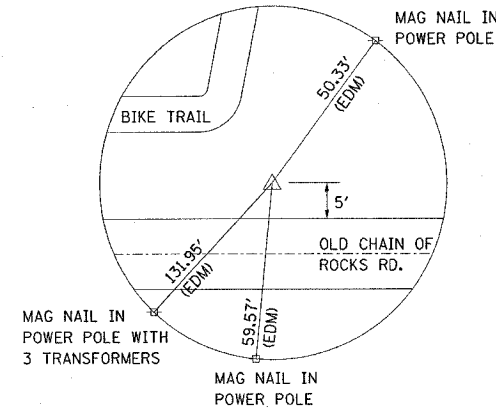

TIE POINT #3

IRON PIN WITH IDOT CAP (FLUSH)

BENCHMARK

BM 1- CUT "□" ON WINGWALL @ SE CORNER OF BRIDGE
ELEV = 421.960

PLOT DATE = 10/19/2006
FILE NAME = c:\arc\projects\ed6699\plan\p1016819b.dgn
PLOT SCALE = 5/8"=1'-0" / IN.
REFERENCE = #REF#

REVISIONS	
NAME	DATE

ILLINOIS DEPARTMENT OF TRANSPORTATION
TIE POINTS & BENCHMARKS

FAU ROUTE 9079
SECTION 65BR
MADISON COUNTY
SN 060-0069 (E) 0236 (P)