

F.A.I. RTE.	SECTION	COUNTY	TOTAL SHEETS	SHEET NO.
70	60-(10,11)RS	MADISON	156	38
STA. _____ TO STA. _____		FED. ROAD DIST. NO. ILLINOIS FED. AID PROJECT		

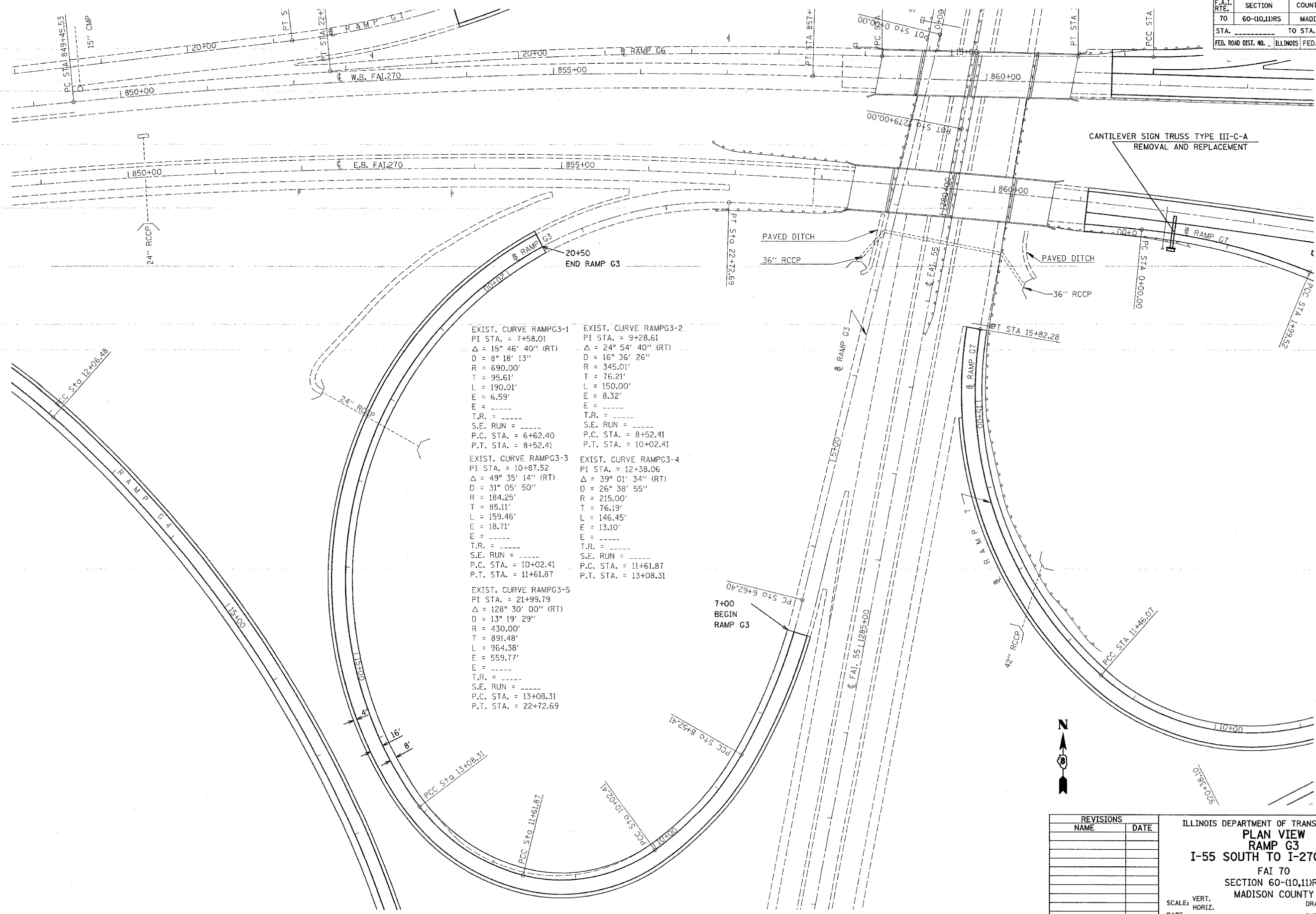

EXIST. CURVE RAMPG3-1  
 PI STA. = 7+58.01  
 $\Delta = 15^\circ 46' 40''$  (RT)  
 D = 8° 18' 13"  
 R = 690.00'  
 T = 95.61'  
 L = 190.01'  
 E = 6.59'  
 T.R. = ----  
 S.E. RUN = ----  
 P.C. STA. = 6+62.40  
 P.T. STA. = 8+52.41

EXIST. CURVE RAMPG3-2  
 PI STA. = 9+28.61  
 $\Delta = 24^\circ 54' 40''$  (RT)  
 D = 16° 36' 26"  
 R = 345.01'  
 T = 76.21'  
 L = 150.00'  
 E = 8.32'  
 T.R. = ----  
 S.E. RUN = ----  
 P.C. STA. = 8+52.41  
 P.T. STA. = 10+02.41

EXIST. CURVE RAMPG3-3  
 PI STA. = 10+87.52  
 $\Delta = 49^\circ 35' 14''$  (RT)  
 D = 31° 05' 50"  
 R = 184.25'  
 T = 85.11'  
 L = 159.46'  
 E = 18.71'  
 T.R. = ----  
 S.E. RUN = ----  
 P.C. STA. = 10+02.41  
 P.T. STA. = 11+61.87

EXIST. CURVE RAMPG3-4  
 PI STA. = 12+38.06  
 $\Delta = 39^\circ 01' 34''$  (RT)  
 D = 26° 38' 55"  
 R = 215.00'  
 T = 76.19'  
 L = 146.45'  
 E = 13.10'  
 T.R. = ----  
 S.E. RUN = ----  
 P.C. STA. = 11+61.87  
 P.T. STA. = 13+08.31

EXIST. CURVE RAMPG3-5  
 PI STA. = 21+99.79  
 $\Delta = 128^\circ 30' 00''$  (RT)  
 D = 13° 19' 29"  
 R = 430.00'  
 T = 891.48'  
 L = 964.38'  
 E = 559.77'  
 T.R. = ----  
 S.E. RUN = ----  
 P.C. STA. = 13+08.31  
 P.T. STA. = 22+72.69

REVISIONS	
NAME	DATE

ILLINOIS DEPARTMENT OF TRANSPORTATION  
**PLAN VIEW**  
**RAMP G3**  
 I-55 SOUTH TO I-270 WEST  
 FAI 70  
 SECTION 60-(10,11)RS  
 MADISON COUNTY

SCALE: VERT. \_\_\_\_\_  
 HORIZ. \_\_\_\_\_  
 DATE \_\_\_\_\_

DRAWN BY \_\_\_\_\_  
 CHECKED BY \_\_\_\_\_

PLOT DATE = #DATE#  
 FILE NAME = #FILE#  
 PLOT SCALE = #SCALE#  
 REFERENCE = #REF#