

F.A.I. RTE.	SECTION	COUNTY	TOTAL SHEETS	SHEET NO.
70	60-10,11DRS	MADISON	156	39
STA.		TO STA.		
FED. ROAD DIST. NO.		ILLINOIS FED. AID PROJECT		

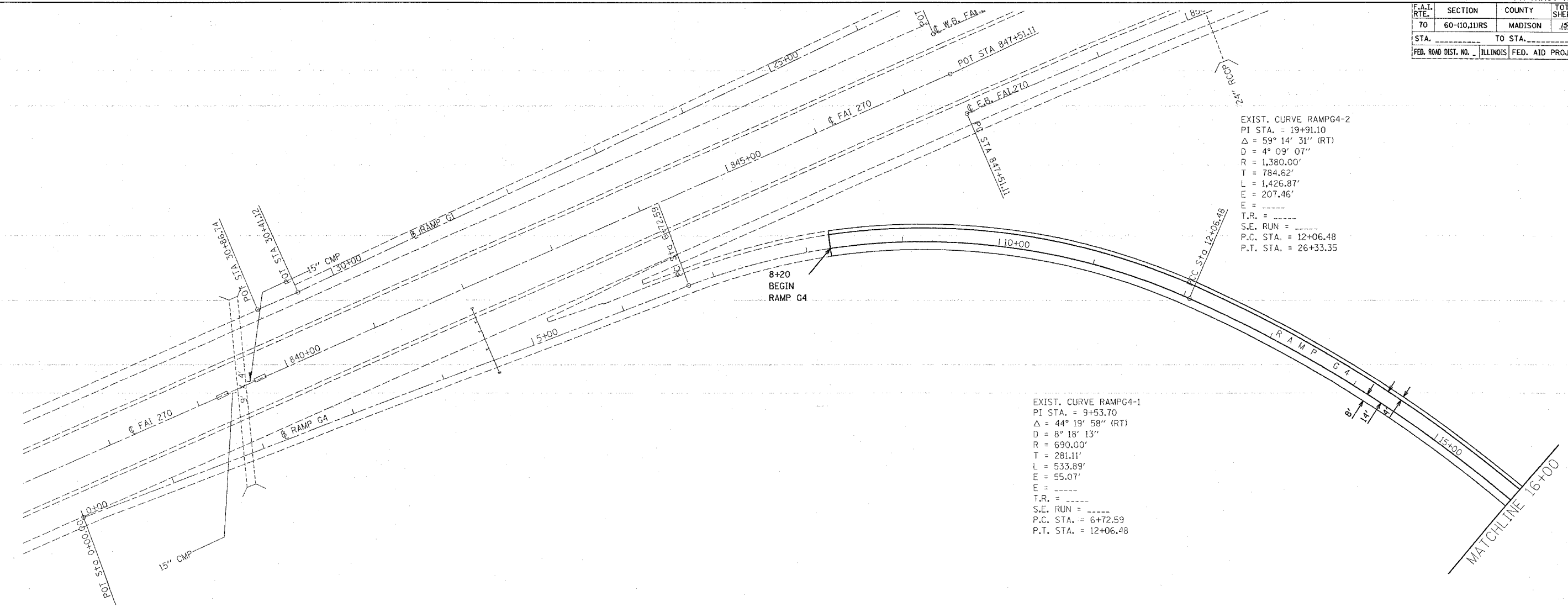

EXIST. CURVE RAMPG4-2  
 PI STA. = 19+91.10  
 $\Delta = 59^\circ 14' 31''$  (RT)  
 $D = 4^\circ 09' 07''$   
 $R = 1,380.00'$   
 $T = 784.62'$   
 $L = 1,426.87'$   
 $E = 207.46'$   
 $T.R. =$   
 $S.E. RUN =$   
 $P.C. STA. = 12+06.48$   
 $P.T. STA. = 26+33.35$

EXIST. CURVE RAMPG4-1  
 PI STA. = 9+53.70  
 $\Delta = 44^\circ 19' 58''$  (RT)  
 $D = 8^\circ 18' 13''$   
 $R = 690.00'$   
 $T = 281.11'$   
 $L = 533.89'$   
 $E = 55.07'$   
 $T.R. =$   
 $S.E. RUN =$   
 $P.C. STA. = 6+72.59$   
 $P.T. STA. = 12+06.48$



PLOT DATE \* DATE \*  
 PLOT SCALE \* SCALE \*  
 REFERENCE \* REF \*

REVISIONS	
NAME	DATE

ILLINOIS DEPARTMENT OF TRANSPORTATION  
**PLAN VIEW**  
**RAMP G4**  
**I-270 EAST TO I-55 SOUTH**  
 FAI 70  
 SECTION 60-10,11DRS  
 MADISON COUNTY  
 SCALE: VERT. \_\_\_\_\_  
 HORIZ. \_\_\_\_\_  
 DATE \_\_\_\_\_  
 DRAWN BY \_\_\_\_\_  
 CHECKED BY \_\_\_\_\_