

F.A.I. RTE.	SECTION	COUNTY	TOTAL SHEETS	SHEET NO.
70	60-(10,11)RS	MADISON	56	40
STA. _____		TO STA. _____		
FED. ROAD DIST. NO. _____		ILLINOIS FED. AID PROJECT		

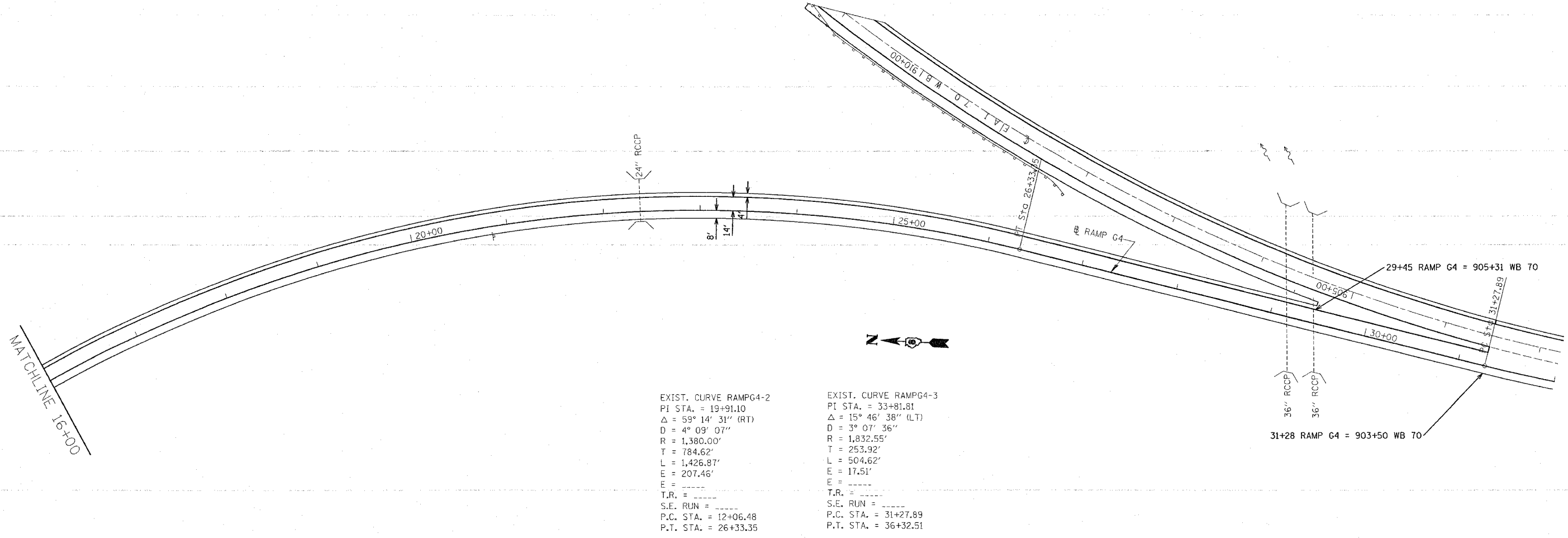

EXIST. CURVE RAMP G4-2  
 PI STA. = 19+91.10  
 Δ = 59° 14' 31" (RT)  
 D = 4° 09' 07"  
 R = 1,380.00'  
 T = 784.62'  
 L = 1,426.87'  
 E = 207.46'  
 E = -----  
 T.R. = -----  
 S.E. RUN = -----  
 P.C. STA. = 12+06.48  
 P.T. STA. = 26+33.35

EXIST. CURVE RAMP G4-3  
 PI STA. = 33+81.81  
 Δ = 15° 46' 38" (LT)  
 D = 3° 07' 36"  
 R = 1,832.55'  
 T = 253.92'  
 L = 504.62'  
 E = 17.51'  
 E = -----  
 T.R. = -----  
 S.E. RUN = -----  
 P.C. STA. = 31+27.89  
 P.T. STA. = 36+32.51

PLOT DATE = #DATE#  
 FILE NAME = #FILE#  
 PLOT SCALE = #SCALE#  
 REFERENCE = #REF#

REVISIONS	
NAME	DATE

ILLINOIS DEPARTMENT OF TRANSPORTATION  
**PLAN VIEW**  
**RAMP G4**  
**I-270 EAST TO 55 SOUTH**  
 FAI 70  
 SECTION 60-(10,11)RS  
 MADISON COUNTY

SCALE: VERT. \_\_\_\_\_  
 HORIZ. \_\_\_\_\_  
 DATE \_\_\_\_\_

DRAWN BY \_\_\_\_\_  
 CHECKED BY \_\_\_\_\_