

F.A.P. RTE.	SECTION	COUNTY	TOTAL SHEETS	SHEET NO.
592	28BR-2,3	ST. CLAIR	51	10A
STA.		TO STA.		
FED. ROAD DIST. NO.	ILLINOIS	FED. AID PROJECT		

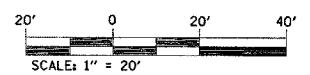
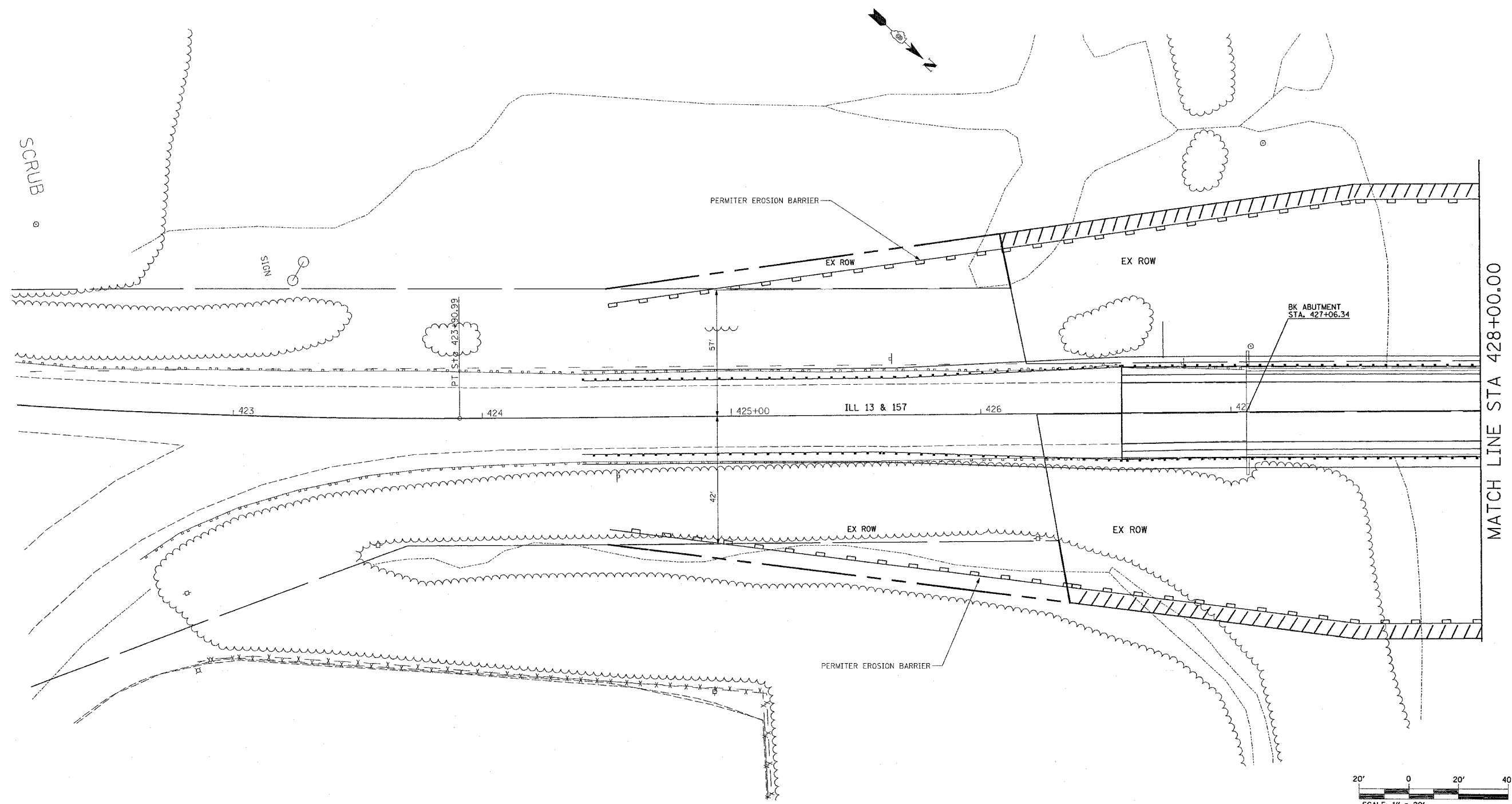

PLOT DATE = 2/21/2007
 FILE NAME = C:\Users\challeng\Documents\challeng\p04406.dgn
 PLOT SCALE = 20.00000 / IN.
 USER NAME = challenge

▲ ADDED SHEET 2-26-07

REVISIONS	
NAME	DATE

ILLINOIS DEPARTMENT OF TRANSPORTATION
EROSION CONTROL
 FAP ROUTE 592 (IL13/157)
 SECTION 28BR-2,3
 ST. CLAIR COUNTY