

F.A.P. RTE.	SECTION	COUNTY	TOTAL SHEETS	SHEET NO.
592	28BR-2,3	ST. CLAIR	51	2
STA.	TO STA.			
FED. ROAD DIST. NO.	ILLINOIS	FED. AID PROJECT		

**GENERAL NOTES**

1. THE STANDARDS AND REVISION NUMBERS LISTED SHALL APPLY TO THIS PROJECT.
2. THE CONTRACTOR SHALL VERIFY ALL DIMENSIONS AND CONDITIONS IN THE FIELD PRIOR TO CONSTRUCTION AND ORDERING MATERIALS.
3. ILLINOIS STATE LAW REQUIRES A 48-HOUR NOTICE BE GIVEN TO UTILITIES BEFORE DIGGING. FIELD MARKING OF FACILITIES MAY BE OBTAINED BY CONTACTING J.U.L.I.E. OR FOR NON-MEMBERS, THE UTILITY COMPANY DIRECTLY. AGENCIES KNOWN TO HAVE FACILITIES WITHIN THE PROJECT AREA ARE AS FOLLOWS:
  - AMEREN IP
  - AMERICAN BOTTOMS REGIONAL WASTEWATER TREATMENT FACILITY
  - AMEREN UE
  - CENTERPOINT ENERGY
  - COMMONFIELDS OF CAHOKIA PUBLIC WATER DISTRICT
  - CONOCO PHILLIPS PIPE LINE COMPANY
  - HARRISONVILLE TELEPHONE CO.
  - ILLINOIS AMERICAN WATER CO.
  - LACLEDE PIPELINE COMPANY
  - LEVEL 3 COMMUNICATIONS, LLC
  - MCI NETWORK SERVICES, INC.
  - 360 NETWORKS (USA) INC.
  - AT&T ILLINOIS

MEMBERS OF J.U.L.I.E. (800) 892-0123 ARE INDICATED BY \*. NON-J.U.L.I.E. MEMBERS MUST BE NOTIFIED INDIVIDUALLY.

4. THE THICKNESS OF THE BITUMINOUS MIXTURES SHOWN ON THE PLANS IS THE NOMINAL THICKNESS. DEVIATIONS MAY OCCUR DUE TO IRREGULARITIES IN THE EXISTING SURFACE OR BASE ON WHICH THE BITUMINOUS MIXTURE IS PLACED.
5. THE EXISTING BEAMS SHALL BE CAREFULLY REMOVED AND DISPOSED OF OUTSIDE OF THE JOB SITE.
6. THE COST OF THE BRIDGE RAIL REMOVAL SHALL BE INCLUDED IN THE COST OF REMOVAL OF THE EXISTING SUPERSTRUCTURE.
7. THE ENGINEER WILL SPECIFY THE LOCATION OF THE CHANGEABLE MESSAGE SIGNS AND THE MESSAGE TO BE PLACED ON THEM. THEY SHALL BE IN PLACE A MINIMUM OF 14 DAYS PRIOR TO THE CLOSURE.
8. THE WIDTHS OF BITUMINOUS SURFACE REMOVAL SHOWN ON THE PLANS ARE THE NOMINAL WIDTHS. IRREGULARITIES IN THE SURFACE WIDTH MAY OCCUR THROUGHOUT THE LENGTH OF THE SECTION. BITUMINOUS SURFACE REMOVAL WILL BE PAID FOR IN SQUARE YARDS BASED UPON THE NOMINAL WIDTHS INDICATED.
9. THE CONTRACTOR SHALL COORDINATE HIS CONSTRUCTION ACTIVITIES WITH THE WORK TO BE PERFORMED ON IL 13 @ 157 ROUNDABOUT BY OTHER CONTRACTORS. THERE SHOULD ALSO BE COOPERATION OF CONSTRUCTION ACTIVITIES BETWEEN CONTRACTORS. THE DETOUR SIGNING SHALL BE IN PLACE PRIOR TO THE IL 13 AND 157 ROUNDABOUT PROJECT. THE LAST CONTRACTOR WORKING SHALL COMPLETE THE WORK ON THE GUARDRAIL.
10. ANY REFERENCE TO "BITUMINOUS CONCRETE" SHALL BE CONSTRUED TO DENOTE "HOT MIX ASPHALT".
11. RIGHT OF WAY MARKERS SHALL BE SET IN ACCORDANCE WITH SECTION 666 OF THE STANDARD SPECIFICATIONS. RIGHT OF WAY MARKERS SHALL BE SET SO THE BACK OF THE POST IS TWELVE (12") INCHES INSIDE THE RIGHT OF WAY BOUNDARY. RIGHT OF WAY PROPERTY CORNERS ARE MARKED BY A 5/8" IRON ROD WITH IDOT ALUMINUM CAP AND SHALL NOT BE REMOVED OR DAMAGED WHEN SETTING THE RIGHT OF WAY MARKERS.
12. THE WETLANDS WILL BE IMPACTED BY 1.7 ACRES.
13. THE REMOVAL OF THE BRIDGE APPROACH PAVEMENT IS INCLUDED IN THE COST OF PAVEMENT REMOVAL.

**INDEX OF SHEETS**

1. COVER SHEET
2. GENERAL NOTES AND TRANSITION DETAIL
- 3.-4. SUMMARY OF QUANTITIES
5. TYPICAL SECTIONS
6. TIE POINTS AND SCHEDULES
- 7.-8. PLAN AND ELEVATION
- 9.-10. STORM WATER POLLUTION PREVENTION PLAN
- 11.-13. PLAT OF HIGHWAYS
14. TRAFFIC CONTROL
15. DETOUR SIGNING SHEET
- 16.-23. CROSS SECTIONS
- 24.-51. BOX CULVERT PLANS S.N. 082-0087 AND BRIDGE PLANS S.N. 082-0212

**HIGHWAY STANDARDS**

000001-04	635011-01
001001-01	666001
001006	702001-06
420401-05	720001
515001-02	720006-01
601101	720011
630001-07	780001-01
630301-04	781001-02
631032-03	886001
635006-02	886006
	B.L.R. 21-6

**EROSION AND SEDIMENT CONTROL NOTES**

1. PLANS INCLUDE ESTIMATED QUANTITIES FOR TEMPORARY EROSION AND SEDIMENT CONTROL. THESE ARE WORST CASE ESTIMATE. DISTURBANCE OF AREAS BEYOND THE LIMITS OF ACTUAL IMPROVEMENT IS TO BE HELD TO A MINIMUM.
2. TEMPORARY SEEDING AND MULCH SHALL BE COMPLETED ON A WEEKLY BASIS ON EXPOSED GROUND AND SHALL BE IN ACCORDANCE WITH SECTION 280 OF THE STANDARD SPECIFICATIONS EXCEPT THAT MULCH AND TEMPORARY SEEDING SHALL BE PAID FOR AS TEMPORARY EROSION CONTROL SEEDING AND NO OTHER PAYMENT WILL BE PERMITTED.
3. ALL AREAS DISTURBED FOR ANY REASON SHALL BE SEEDED WITH CLASS 2 SEEDING, AS DIRECTED BY THE ENGINEER. NUTRIENTS SHALL CONFORM TO ARTICLE 250.04.
4. ALL EROSION CONTROL PRODUCTS FURNISHED SHALL BE SPECIFICALLY RECOMMENDED BY THE MANUFACTURER FOR THE USE SPECIFIED IN THE EROSION CONTROL PLAN. PRIOR TO APPROVAL AND USE OF THE PRODUCT, THE CONTRACTOR SHALL SUBMIT TO THE ENGINEER A NOTARIZED CERTIFICATION BY THE PRODUCER STATING THE INTENDED USE OF THE PRODUCT AND THAT THE PHYSICAL PROPERTIES REQUIRED FOR THIS APPLICATION ARE MET OR EXCEEDED. THE CONTRACTOR SHALL PROVIDE MANUFACTURER RECOMMENDED INSTALLATION PROCEDURES TO FACILITATE THE ENGINEER IN CONSTRUCTION INSPECTION.
5. EARTH STOCKPILES SHALL BE TEMPORARILY SEEDED IF THEY ARE TO REMAIN UNUSED FOR MORE THAN FOURTEEN DAYS.
6. FINAL SEEDING SHALL BE PERFORMED AS SOON AS POSSIBLE.

**COMMITMENTS**

1. THE DEPARTMENT WILL NOTIFY METRO EAST SANITARY DISTRICT AND BI-STATE DEVELOPMENT AGENCY 2 WEEKS PRIOR TO THE CLOSURE OF THEIR ENTRANCES. AT THAT TIME, THE DEPARTMENT WILL ADVISE THEM OF THE DATES THE CLOSURES WILL BE IN EFFECT.
2. COORDINATION EFFORTS WILL CONTINUE THROUGHOUT THE DESIGN AND CONSTRUCTION PHASES OF THE PROJECT. THE DESIGNER WILL CONTACT LOCAL OFFICIALS, HOMEOWNERS, AND BUSINESSES AS THE PROJECT IS CLOSER TO LETTING. IN ADDITION, CONSTRUCTION WILL NOTIFY THE STATE LEGISLATURES AND LOCAL OFFICIALS OF THE UPCOMING DETOUR 2 WEEKS PRIOR TO CLOSURE. THE DESIGNER WILL NOTE THIS COMMITMENT REGARDING COORDINATION EFFORTS IN THE DESIGN PLANS.
3. SPECIAL EROSION CONTROL MEASURES DUE TO THE CLOSE PROXIMITY OF THE EXISTING WETLANDS WILL BE IMPLEMENTED. SIGNING AND FENCING NEED TO BE CONSIDERED TO KEEP CONSTRUCTION ACTIVITIES FROM ENTERING THE WETLANDS.

**TRANSITION DETAIL**

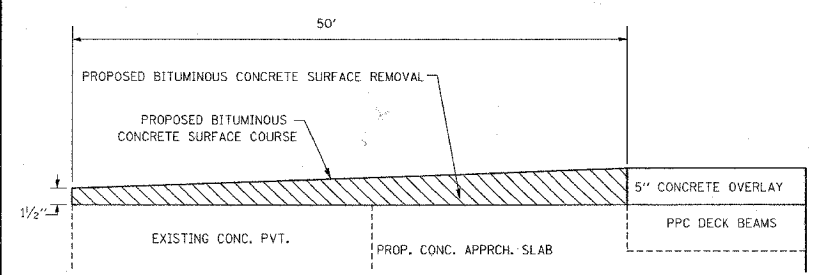

MIXTURE USE	SURFACE	LEVEL BINDER	BINDER/WIDENING	SHOULDERS	TOP LIFT SHOULDERS
AC/PG	PG 64-22	PG 64-22	PG 64-22	PG 58-22	PG 58-22
RAP % (MAX)	10%	10%	15%	30%	30%
DESIGN AIR V10DS	4% @ Ndes=70	4% @ Ndes=70	4% @ Ndes=70	2% @ Ndes=30	**2% @ Ndes=30
MIX COMPOSITION					
(GRADATION MIXTURE)					
FRICTION AGG	MIXTURE "D"	MIXTURE "C"	MIXTURE "B"	BAM	BAM

\*\*TOP LIFT SHOULDERS - DESIGN THIS MIX AT 2.0% VOIDS AND ADD ASPHALT TO REDUCE TO 1.5%.

Rev. 2-26-07

REVISIONS		ILLINOIS DEPARTMENT OF TRANSPORTATION GENERAL NOTES, STANDARDS COMMITMENTS, INDEX OF SHEETS  FAP ROUTE 592 (IL 13/157) SECTION 28BR-2,3 ST. CLAIR COUNTY
NAME	DATE	
		SCALE: VERT. HORIZ. DATE DRAWN BY CHECKED BY

PLOT DATE = 2/21/2007  
 FILE NAME = c:\p\proj\secta\secta\082-0087\082-0212.dgn  
 PLOT SCALE = 50:0000 / 1" = 50'  
 REFERENCE = SHEETS

# SUMMARY OF QUANTITIES

SUMMARY OF QUANTITIES			CONSTRUCTION TYPE CODE					
CODE NO	ITEM	UNIT	TOTAL QUANTITIES	S.N. 082-0087		S.N. 082-0212		
				BRIDGE CANAL NO. 1	RDWY CANAL NO. 1	BRIDGE HARDING DITCH	RDWY HARDING DITCH	RDWY HARDING DITCH
20200100	EARTH EXCAVATION	CU YD	30	30				
20400800	FURNISHED EXCAVATION	CU YD	12,830	12,830				
20700400	POROUS GRANULAR EMBANKMENT <i>SPECIAL</i>	CU YD	55		55			
25000200	SEEDING, CLASS 2	ACRE	1.25		1.25			
25000400	NITROGEN FERTILIZER NUTRIENT	POUND	113		113			
25000500	PHOSPHORUS FERTILIZER NUTRIENT	POUND	113		113			
25000600	POTASSIUM FERTILIZER NUTRIENT	POUND	113		113			
25100105	MULCH, METHOD 1	ACRE	1.25		1.25			
28000250	TEMPORARY EROSION CONTROL SEEDING	POUND	625		625			
<del>28000400</del>	<del>PERIMETER EROSION BARRIER</del>	<del>FOOT</del>	<del>1040</del>		<del>1040</del>			
<del>31101810</del>	<del>SUB-BASE GRANULAR MATERIAL, TYPE B 12"</del>	<del>SQ YD</del>	<del>132</del>		<del>132</del>			
<del>31101900</del>	<del>SUB-BASE GRANULAR MATERIAL, TYPE C</del>	<del>TON</del>	<del>16</del>		<del>12</del>			4
35102000	AGGREGATE BASE COURSE, TYPE B 8"	SQ YD	80		80			
40600200	BITUMINOUS MATERIALS (PRIME COAT)	TON	1.2		1.1		0.1	
40603085	HOT-MIX ASPHALT BINDER COURSE, IL-19.0, N70	TON	446	446				
40603340	HOT-MIX ASPHALT SURFACE COURSE, MIX "D", N70	TON	112		77		35	
40800050	INCIDENTAL HOT-MIX ASPHALT SURFACING	TON	13		13			
42001165	BRIDGE APPROACH PAVEMENT	SQ YD	223		223			
42001300	PROTECTIVE COAT	SQ YD	420		420			
44000155	HOT-MIX ASPHALT SURFACE REMOVAL, 1 1/2"	SQ YD	580		267		313	
<del>44000100</del>	<del>PAVEMENT REMOVAL</del>	<del>SQ YD</del>	<del>223</del>				<del>223</del>	
48101500	AGGREGATE SHOULDERS, TYPE B 6"	SQ YD	296		229		67	
48203029	HOT-MIX ASPHALT SHOULDERS, 8"	SQ YD	296		229		67	
50100100	REMOVAL OF EXISTING STRUCTURES	EACH	1	1				
50101500	REMOVAL OF EXISTING SUPERSTRUCTURES	EACH	1		1			
50102400	CONCRETE REMOVAL	CU YD	12.5		12.5			
50200100	STRUCTURE EXCAVATION	CU YD	63		63			
50200300	COFFERDAM EXCAVATION	CU YD	1133	1133				
50200500	COFFERDAMS	EACH	1	1				
50300225	CONCRETE STRUCTURES	CU YD	15.3		15.3			
50300260	BRIDGE DECK GROOVING	SQ YD	420		420			
50300265	SEAL COAT CONCRETE	CU YD	852.3	852.3				
50301200	CONCRETE WEARING SURFACE	SQ YD	420		420			
50400305	PRECAST PRESTRESSED CONCRETE DECK BEAMS (17" DEPTH)	SQ FT	3770		3770			
50800105	REINFORCEMENT BARS	POUND	50130	50130				
50800205	REINFORCEMENT BARS, EPOXY COATED	POUND	7430		7430			
50800515	BAR SPLICERS	EACH	68		68			
50901050	STEEL RAILING, TYPE SM	FOOT	229		229			
51500100	NAME PLATES	EACH	2	1		1		

PLOT DATE = 12/11/2006  
 FILE NAME = c:\prow\meta\w84425\plan\p04485.dgn  
 PLOT DEVICE = HPGL7  
 PLOT SCALE = 1"=100'  
 REFERENCE = SHEET #

Rev. 2-26-07

F.A.P. RTE.	SECTION	COUNTY	TOTAL SHEETS	SHEET NO.
592	28BR-2,3	ST. CLAIR	51	4
STA.		TO STA.		
FED. ROAD DIST. NO.		ILLINOIS FED. AID PROJECT		

# SUMMARY OF QUANTITIES

80% FED. / 20% STATE

X02B-2A  
ACBHE

X080-2A  
ACBHE

ILLINOIS DEPARTMENT OF TRANSPORTATION

CONSTRUCTION TYPE CODE

S.N. 082-0087

S.N. 082-0212

BRIDGE CANAL NO. 1

RDWY CANAL NO. 1

BRIDGE HARDING DITCH

RDWY HARDING DITCH

RDWY HARDING DITCH

## SUMMARY OF QUANTITIES

URBAN TOTAL QUANTITIES

CODE NO	ITEM	UNIT	URBAN TOTAL QUANTITIES	BRIDGE CANAL NO. 1	RDWY CANAL NO. 1	BRIDGE HARDING DITCH	RDWY HARDING DITCH	RDWY HARDING DITCH
54003000	CONCRETE BOX CULVERTS	CU YD	212.1	212.1				
58700300	CONCRETE SEALER	SQ FT	48.2			48.2		
59000200	EPOXY CRACK INJECTION	FOOT	34			34		
<del>59100100</del>	<del>GEOCOMPOSITE WALL DRAIN</del>	<del>SQ YD</del>	<del>26</del>			<del>26</del>		
<del>59300100</del>	<del>CONTROLLED LOW-STRENGTH MATERIAL</del>	<del>CU YD</del>	<del>2.1</del>			<del>2.1</del>		
<del>60109580</del>	<del>PIPE UNDERDRAINS FOR STRUCTURES 4"</del>	<del>FOOT</del>	<del>112</del>			<del>112</del>		
63000000	STEEL PLATE BEAM GUARD RAIL, TYPE A	FOOT	1370	979		391		
* 63100087	TRAFFIC BARRIER TERMINAL, TYPE 6A	EACH	4			4		
* 63100167	TRAFFIC BARRIER TERMINAL TYPE 1, SPECIAL (TANGENT)	EACH	6	2		4		
63200310	GUARDRAIL REMOVAL	FOOT	1120	721		399		
66600105	FURNISHING AND ERECTING RIGHT-OF-WAY MARKERS	EACH	4		4			
66700095	PERMANENT SURVEY MARKERS	EACH	2		2			
67000400	ENGINEER'S FIELD OFFICE, TYPE A	CAL MO	8	1.6	1.6	1.6	1.6	1.6
67100100	MOBILIZATION	L SUM	1	0.5		0.5		
70100450	TRAFFIC CONTROL AND PROTECTION, STANDARD 701201	L SUM	1	0.5		0.5		
70101830	TRAFFIC CONTROL AND PROTECTION, STANDARD BLR 21	L SUM	1	0.5		0.5		
70106800	CHANGEABLE MESSAGE SIGN	CAL MO	8	1.6	1.6	1.6	1.6	1.6
* 72000100	SIGN PANEL - TYPE 1	SQ FT	9				9	
* 72800100	TELESCOPING STEEL SIGN SUPPORT	FOOT	16				16	
* 78000200	THERMOPLASTIC PAVEMENT MARKING - LINE 4"	FOOT	1775		1375		400	
* 78008210	POLYUREA PAVEMENT MARKING TYPE I - LINE 4"	FOOT	1444	976		468		
* 78100100	RAISED REFLECTIVE PAVEMENT MARKER	EACH	8	4		4		
* 78200410	GUARDRAIL MARKERS, TYPE A	EACH	32	16		16		
* 78201000	TERMINAL MARKER - DIRECT APPLIED	EACH	6	2		4		
78300200	RAISED REFLECTIVE PAVEMENT MARKER REMOVAL	EACH	5	2		3		
* 88600100	DETECTOR LOOP, TYPE I	FOOT	26					26
X0323491	SLOPEWALL CRACK SEALING	FOOT	130			130		
<del>X0323557</del>	<del>BRIDGE JOINT SYSTEM (EXPANSION) 1"</del>	<del>FOOT</del>	<del>66</del>			<del>66</del>		
X0325294	PREFORMED JOINT STRIP SEAL	L SUM	1	0.5		0.5		
X0324952	DETOUR SIGNING	SQ FT	193			193		
X0325305	STRUCTURAL REPAIR OF CONCRETE (DEPTH EQUAL TO OR LESS THAN 5 INCHES)	SQ FT	193			193		
Z0001900	ASBESTOS BEARING PAD REMOVAL	EACH	66	66				
Z0065700	SLOPE WALL REPAIR	SQ YD	8			8		
⊙ Z0070600	TRAINEES	HOUR	1000	1000				

PLOT DATE = \*DATE\*  
PLOT SCALE = \*SCALE\*  
PLOT SCALE = \*SCALE\*  
REFERENCE = \*REF\*

© 1980  
\*SPECIALTY ITEMS

△ Rev. 2-26-07

Rev.

CONTRACT NO. 76904				
F.A.P. RTE.	SECTION	COUNTY	TOTAL SHEETS	SHEET NO.
592	28BR-2,3	ST. CLAIR	51	5
STA.		TO STA.		
FED. ROAD DIST. NO.		ILLINOIS	FED. AID PROJECT	

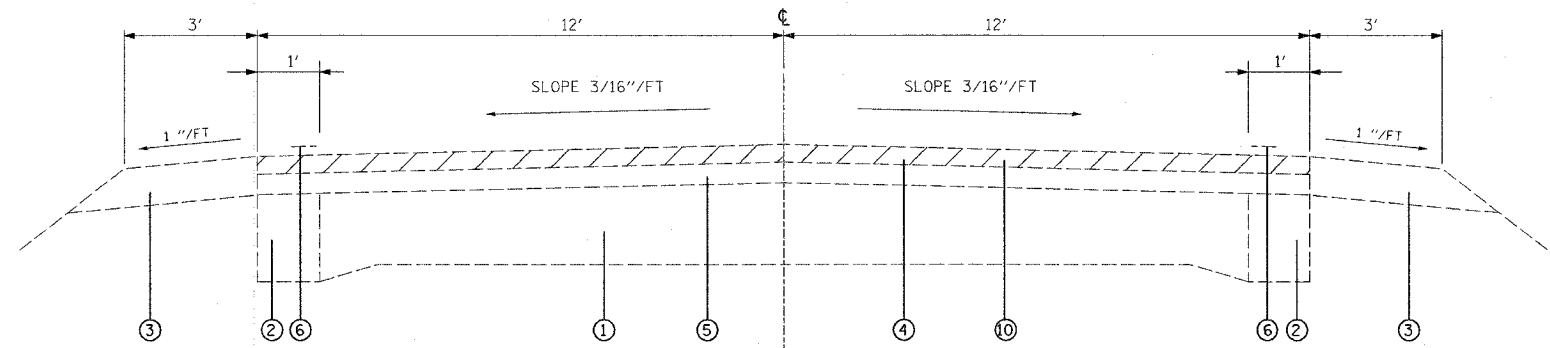

**EXISTING TANGENT SECTION**

CANAL # 1: STA. 426+56.34 TO STA. 427+06.34  
 STA. 429+49.91 TO STA. 429+99.91  
 HARDING DITCH: STA. 435+93.16 TO STA. 436+73.16  
 STA. 436+90.56 TO STA. 438+70.56

**STRUCTURAL DESIGN INFORMATION**

ROAD CLASSIFICATION: CLASS 2  
 STRUCTURAL DESIGN TRAFFIC:  
 PV=7,810 SU=228 MU=89  
 PERCENT OF STRUCTURAL DESIGN TRAFFIC IN DESIGN LANE  
 P=50% S=50% M=50%  
 MINIMUM SUBGRADE SUPPORT RATING: POOR  
 FLEXIBLE PAVEMENT DESIGN: MINIMUM  $T_F = 3.81$

SELECTED DESIGN AC TYPE 20  
 AC THICKNESS SEE TABLE 2  
 HOT-MIX ASPHALT BINDER COURSE, IL-19.0, N70, VARIES  
 HOT-MIX ASPHALT SURFACE COURSE, N70, 1 1/2"

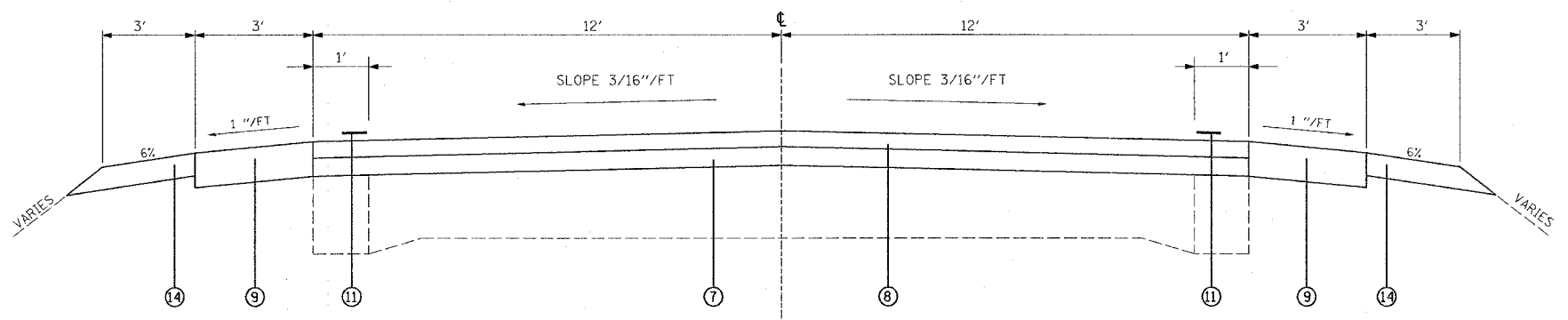

**PROPOSED TANGENT SECTION**

CANAL # 1: STA. 426+56.34 TO STA. 427+06.34  
 STA. 429+49.91 TO STA. 429+99.91  
 HARDING DITCH: STA. 435+93.16 TO STA. 436+73.16  
 STA. 436+90.56 TO STA. 438+70.56

**LEGEND**

- ① EXISTING PAVEMENT 9-6-9
- ② EXISTING BASE COURSE WIDENING, 8"
- ③ EXISTING AGGREGATE SHOULDER
- ④ EXISTING BITUMINOUS CONCRETE SURFACE COURSE, 1 1/2 "
- ⑤ EXISTING BINDER COURSE, 1 1/2 "
- ⑥ EXISTING PAVEMENT MARKING
- ⑦ PROPOSED HOT-MIX ASPHALT MATERIALS (PRIME COAT)
- ⑧ PROPOSED HOT-MIX ASPHALT SURFACE COURSE, SUPERPAVE, 1 1/2 "
- ⑨ PROPOSED HOT-MIX ASPHALT SHOULDER, 8" (CANAL #1)
- ⑩ PROPOSED BITUMINOUS SURFACE REMOVAL, 1 1/2 "
- ⑪ PROPOSED PAVEMENT MARKING
- ⑫ PROPOSED SUBBASE GRANULAR MATERIAL, TYPE B 12"
- ⑬ PROPOSED HOT MIX ASPHALT BINDER COURSE, 12 1/4 "
- ⑭ PROPOSED AGGREGATE SHOULDER, TYPE B 6"
- ⑮ PROPOSED SUBBASE GRANULAR MATERIAL, TYPE C

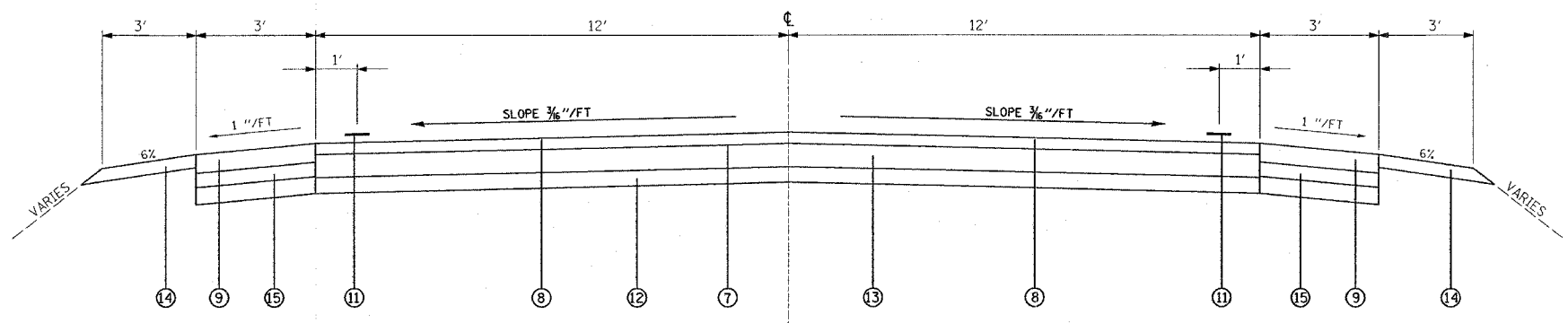

**PROPOSED TANGENT SECTION**

STA. 427+06.34 TO STA. 429+49.91

PLOT DATE = 2/21/2007  
 FILE NAME = c:\projects\76904\84485\plan\94485a.dgn  
 PLOT SCALE = 50,000 / 1"  
 REFERENCE = #REF#

REVISIONS	
NAME	DATE

ILLINOIS DEPARTMENT OF TRANSPORTATION  
**TYPICAL SECTIONS**  
 FAP ROUTE 592 (IL 13/157)  
 SECTION 28BR-2,3  
 ST. CLAIR COUNTY

SCALE: VERT. \_\_\_\_\_  
 HORIZ. \_\_\_\_\_

DATE \_\_\_\_\_ DRAWN BY \_\_\_\_\_  
 CHECKED BY \_\_\_\_\_

Rev. sheet 2-26-07

F.A.P. RTE.	SECTION	COUNTY	TOTAL SHEETS	SHEET NO.
592	28BR-2,3	ST. CLAIR	51	6
STA.		TO STA.		
FED. ROAD DIST. NO.		ILLINOIS FED. AID PROJECT		

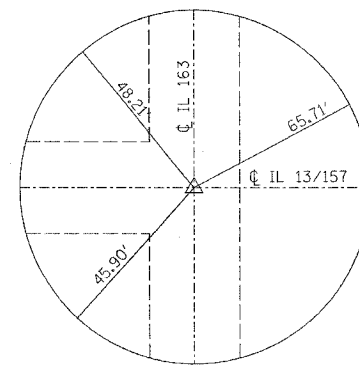

ALL THREE TIES ARE CUT "X" IN MAST ARM FOUNDATION

STA. 441+11.84  
SET MAG NAIL

PAVEMENT MARKING SCHEDULE			CANAL NO. 1		HARDING DITCH			
			PAVEMENT		PAVEMENT		BRIDGE	
STATION			WHITE LINE 4"	YELLOW SOLID LINE 4"	WHITE LINE 4"	YELLOW SOLID LINE 4"	WHITE LINE 4"	YELLOW SOLID LINE 4"
427+06.34	TO	429+49.91	488	488				
426+56.34	TO	427+06.34	RT/LT 100	100				
429+49.91	TO	429+49.91	RT/LT 100	100				
436+73.16	TO	437+90.56					234	234
435+93.16	TO	436+73.16			160	160		
437+90.56	TO	438+70.56			160	160		
	TO							
SUB TOTALS			688	688	320	320	234	234
TOTAL			1376		640		468	

RESURFACING SCHEDULE						
		HOT MIX ASPHALT SURFACE COURSE SUPERPAVE MIX "D", N70		BITUMINOUS MATERIALS (PRIME COAT)	BITUMINOUS SHOULDERS SUPERPAVE	HOT-MIX ASPHALT BINDER
STATION	TO	STATION	TON	TON	TON	TON
426+56.34	TO	427+06.34	11	.1	33	
427+06.34	TO	429+49.91	11	.1	163	446
429+49.91	TO	429+49.91	11	.1	33	
435+93.16	TO	436+43.16	11	.1		
438+40.56	TO	438+70.56	11	.1		
TOTALS			55	.5	229	446

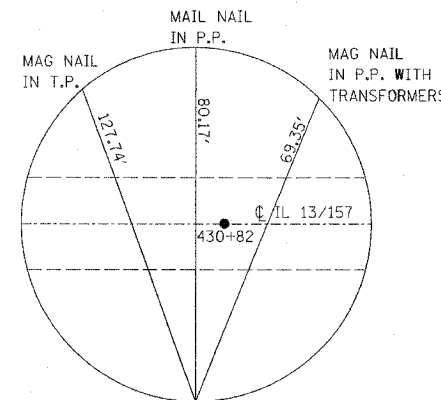

STA. 430+82.00  
SET 1/2" I.P.

ROW MARKERS

STATION	OFFSET
431+75.00	49.69 LT
431+75.00	55.00 LT
430+12.01	75.74 LT
430+35.63	50.29 RT

LOCATION	EARTH EXCAVATION	EARTH EXCAVATION ADJUSTED FOR SHRINKAGE	EMBANKMENT	EARTHWORK BALANCE WASTE (+) OR SHORTAGE (-)
	CU. YD.	CU. YD.	CU. YD.	CU. YD.
STA 424+25 TO 431+35	30	22.5	12,860	-12,837.5

REVISIONS	
NAME	DATE

ILLINOIS DEPARTMENT OF TRANSPORTATION

TIE POINTS AND SCHEDULES  
FAP ROUTE 592 (IL 13/157)  
SECTION 28BR-2,3  
ST CLAIR COUNTY

SCALE: VERT. / HORIZ.  
DATE

DRAWN BY  
CHECKED BY

Rev. Sheet 2-26-07



F.A.P. RTE.	SECTION	COUNTY	TOTAL SHEETS	SHEET NO.
592	28BR-2,3	ST. CLAIR	51	8
STA.		TO STA.		
FED. ROAD DIST. NO.		ILLINOIS	FED. AID PROJECT	

DETECTOR LOOP REQUIREMENTS AND CALCULATIONS

LOOP	PHASE (Ø)	LOOP SIZE(FT)	REQUIRED # OF TURNS	CALCULATED INDUCTANCE MICROHENRIES (µH)	CALCULATED RESISTANCE OHMS (Ω)
WB THRU L-1	2	6' X 6'	6	633.82	3.99

THE ABOVE VALUES ARE CALCULATED OF COMBINED LOOP AND LEAD-IN INDUCTANCE AND RESISTANCE. ACTUAL MEASURED VALUES SHOULD BE WITHIN +/- 20% OF THESE VALUES.

NOTES:

1. THE EXISTING HANDHOLES AND CONDUITS SHALL BE REUSED. IF THEY HAVE BEEN DAMAGED, THEY SHALL BE REPLACED AT THE COST OF THE CONTRACTOR WITH NO ADDITIONAL COMPENSATION AND TO THE SATISFACTION OF THE ENGINEER.
2. THE TOTAL QUANTITY OF DETECTOR LOOPS, TYPE 1 AT THIS INTERSECTION IS 26 FEET. ONLY THE DETECTOR LOOPS WHICH ARE DAMAGED SHALL BE REPLACED; THEREFORE, THE ACTUAL QUANTITY MAY VARY.

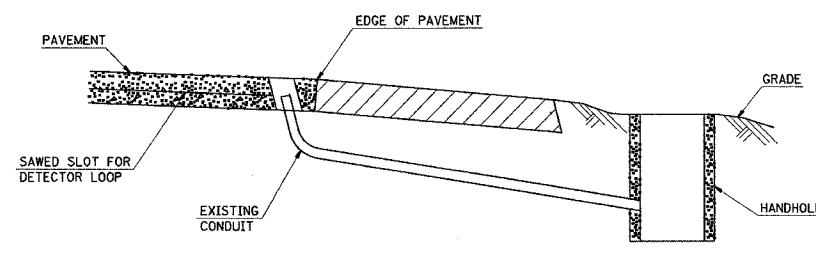
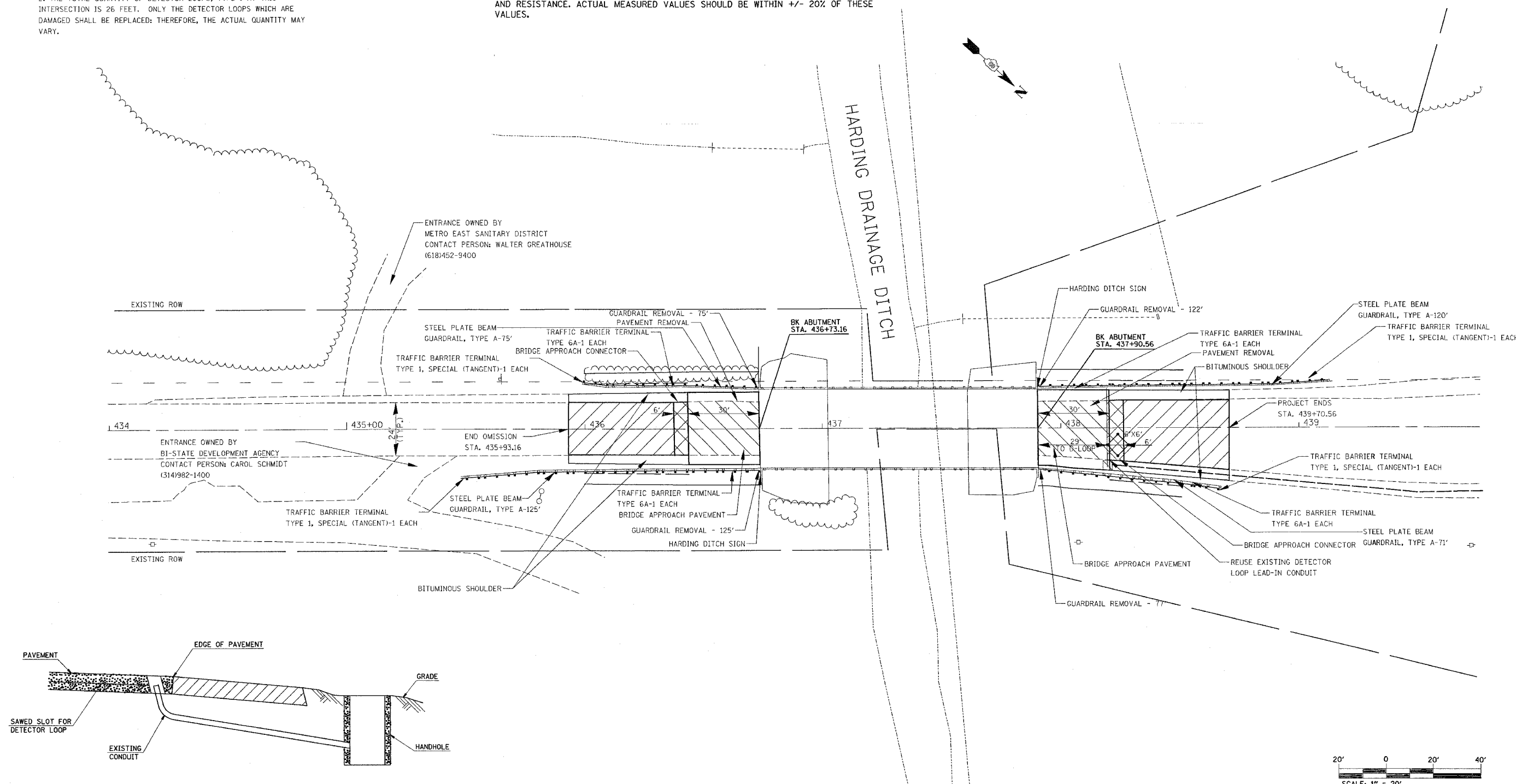

**DETAIL**  
(NO SCALE)  
**RE-USE EXISTING DETECTOR LOOP LEAD-IN CONDUIT**

- 1 DRILL OUT PAVEMENT SEALANT AND CLEAN EXISTING CONDUIT.
  - 2 REMOVE EXISTING CABLE TO HANDHOLE.
  - 3 INSTALL LOOP LEAD-IN CONDUCTORS IN CONDUIT.
  - 4 SPLICE NEW DETECTOR LOOP LEAD-IN CONDUCTORS TO EXISTING LEAD-IN CABLE IN HANDHOLE.
  - 5 FILL HOLE WITH APPROVED SEALER. PREVENT SEALER FROM ENTERING INTO CONDUIT.
- NOT A PAY ITEM. THE COST OF THIS WORK SHALL BE INCLUDED IN THE PAY ITEM "DETECTOR LOOP, TYPE 1"

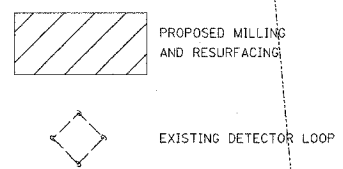
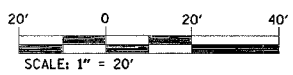

REVISIONS	
NAME	DATE

ILLINOIS DEPARTMENT OF TRANSPORTATION  
**PLAN VIEW**  
FAP ROUTE 592 (IL13/157)  
SECTION 28BR-2,3  
ST. CLAIR COUNTY

Rev. Sheet 2-26-07

DATE = 2/21/2007  
FILE NAME = c:\p\projects\284405\plan\p1\04405a.dgn  
PLOT SCALE = 28.0000 / 1  
USER NAME = chalfont@sk

F.A.P. RTE.	SECTION	COUNTY	TOTAL SHEETS	SHEET NO.
592	28BR-2,3	ST. CLAIR	51	8a
STA.		TO STA.		
FED. ROAD DIST. NO.	ILLINOIS	FED. AID PROJECT		

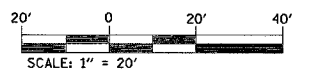
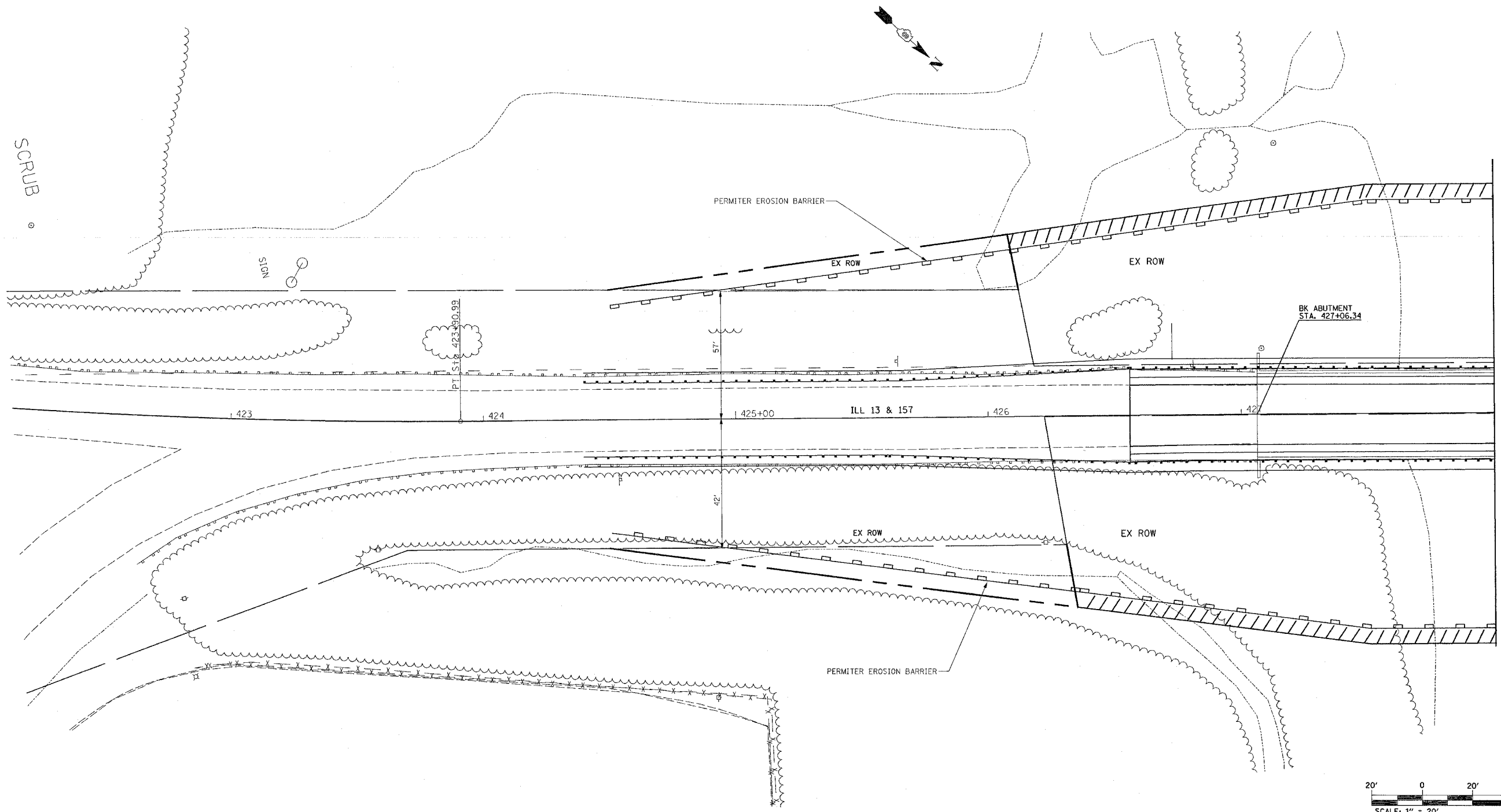

REVISIONS	
NAME	DATE

ILLINOIS DEPARTMENT OF TRANSPORTATION  
**EROSION CONTROL**  
 FAP ROUTE 592 (IL13/157)  
 SECTION 28BR-2,3  
 ST. CLAIR COUNTY

▲ ADDED SHEET 2-26-07

PLOT DATE = 2/28/2007  
 FILE NAME = c:\projects\484485\plan\p1n04405.dgn  
 PLOT SCALE = 28.0000 / 1 IN.  
 USER NAME = challandsk



F.A.P. RTE.	SECTION	COUNTY	TOTAL SHEETS	SHEET NO.
592	28BR-2,3	ST. CLAIR	51	8b
STA.		TO STA.		
FED. ROAD DIST. NO.	ILLINOIS	FED. AID PROJECT		

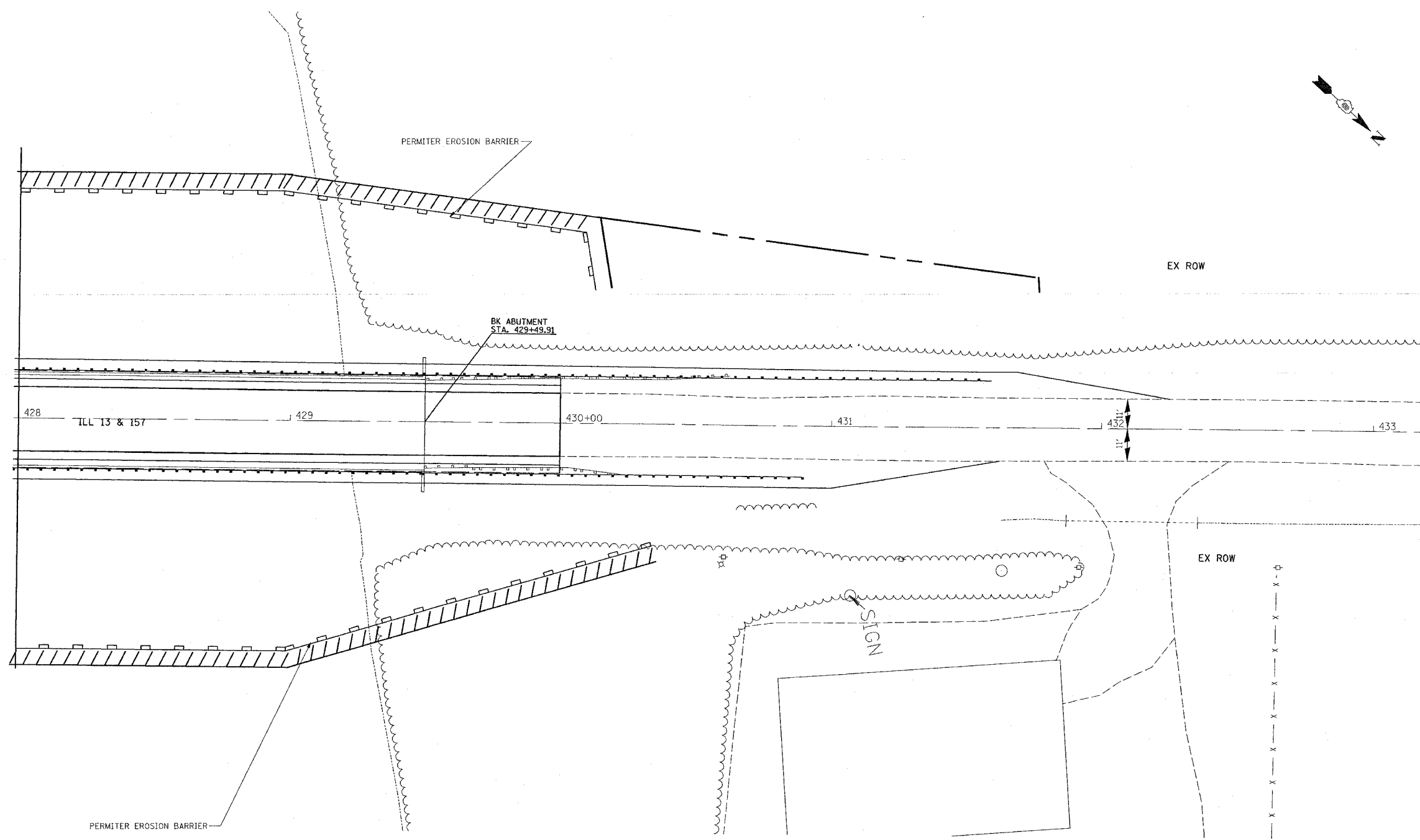

PLOT DATE = 2/20/2007  
 FILE NAME = c:\p\projects\28br23\plan\plan-04-05a.dgn  
 PLOT SCALE = 28.0000 / 1" = 20'  
 USER NAME = challand@sk

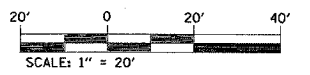

REVISIONS	
NAME	DATE

ILLINOIS DEPARTMENT OF TRANSPORTATION  
**EROSION CONTROL**  
 FAP ROUTE 592 (IL13/157)  
 SECTION 28BR-2,3  
 ST. CLAIR COUNTY

▲ ADDED SHEET 2-26-07

CONTRACT NO. 76904				
F.A.P. RTE.	SECTION	COUNTY	TOTAL SHEETS	SHEET NO.
592	28BR-2,3	ST CLAIR	51	10
STA.		TO STA.		
FED. ROAD DIST. NO.	ILLINOIS	FED. AID PROJECT		

DESCRIPTION OF STABILIZATION PRACTICES DURING CONSTRUCTION:

1. DURING CONSTRUCTION, AREAS OUTSIDE THE CONSTRUCTION LIMITS AS OUTLINED PREVIOUSLY HEREIN SHALL BE PROTECTED. THE CONTRACTOR SHALL NOT USE THIS AREA FOR STAGING (EXCEPT AS DESCRIBED ON THE PLANS AND DIRECTED BY THE ENGINEER), PARKING OF VEHICLES OR CONSTRUCTION EQUIPMENT, STORAGE OF MATERIALS, OR OTHER CONSTRUCTION RELATED ACTIVITIES.
  - (a.) WITHIN THE CONSTRUCTION LIMITS, AREAS WHICH MAY BE SUSCEPTIBLE TO EROSION AS DETERMINED BY THE ENGINEER SHALL REMAIN UNDISTURBED UNTIL FULL SCALE CONSTRUCTION IS UNDERWAY TO PREVENT UNNECESSARY SOIL EROSION.
  - (b.) EARTH STOCKPILES SHALL BE TEMPORARILY SEEDED IF THEY ARE TO REMAIN UNUSED FOR MORE THAN FOURTEEN DAYS.
  - (c.) AS CONSTRUCTION PROCEEDS, THE CONTRACTOR SHALL INSTITUTE THE FOLLOWING AS DIRECTED BY THE ENGINEER:
    - I. PLACE TEMPORARY EROSION CONTROL FACILITIES AT LOCATIONS SHOWN ON THE PLANS.
    - II. TEMPORARILY SEED ERODABLE BARE EARTH ON A WEEKLY BASIS TO MINIMIZE THE AMOUNT OF ERODABLE SURFACE AREA WITHIN THE CONTRACT LIMITS.
    - III. CONSTRUCT ROADSIDE DITCHES AND PROVIDE TEMPORARY EROSION CONTROL SYSTEMS.
    - IV. TEMPORARILY DIVERT WATER AROUND PROPOSED CULVERT LOCATIONS.
    - V. BUILD NECESSARY EMBANKMENT AT CULVERT LOCATIONS AND THEN EXCAVATE AND PLACE CULVERT.
    - VI. CONTINUE BUILDING UP THE EMBANKMENT TO THE PROPOSED GRADE WHILE AT THE SAME TIME, PLACING PERMANENT CONTROL SUCH AS RIPRAP DITCH LINING AND CONDUCTING FINAL SHAPING TO THE SLOPES.
  - (d.) EXCAVATED AREAS AND EMBANKMENT SHALL BE PERMANENTLY SEEDED IMMEDIATELY AFTER FINAL GRADING. IF NOT, THEY SHALL BE TEMPORARILY SEEDED IF NO CONSTRUCTION ACTIVITY IN THE AREA IS PLANNED FOR 7 DAYS.
  - (e.) CONSTRUCTION EQUIPMENT SHALL BE STORED AND FUELED ONLY AT DESIGNATED LOCATIONS. ALL NECESSARY MEASURES SHALL BE TAKEN TO CONTAIN ANY FUEL OF OTHER POLLUTANT IN ACCORDANCE WITH EPA WATER QUALITY REGULATIONS. LEAKING EQUIPMENT OR SUPPLIES SHALL BE IMMEDIATELY REPAIRED OR REMOVED FROM THE SITE.
  - (f.) THE RESIDENT ENGINEER SHALL INSPECT THE PROJECT DAILY DURING CONSTRUCTION ACTIVITIES. INSPECTION SHALL ALSO BE DONE WEEKLY AND AFTER RAINS OF 1/2 INCH OR GREATER OR EQUIVALENT SNOWFALL AND DURING THE WINTER SHUTDOWN PERIOD. THE PROJECT SHALL ADDITIONALLY BE INSPECTED BY THE CONSTRUCTION FIELD ENGINEER ON A BI-WEEKLY BASIS TO DETERMINE THAT EROSION CONTROL EFFORTS ARE IN PLACE AND EFFECTIVE AND IF OTHER EROSION CONTROL WORK IS NECESSARY.
  - (g.) SEDIMENT COLLECTED DURING CONSTRUCTION OF THE VARIOUS TEMPORARY EROSION CONTROL SYSTEMS SHALL BE DISPOSED OF ON THE SITE ON A REGULAR BASIS AS DIRECTED BY THE ENGINEER. THE COST OF THIS MAINTENANCE SHALL BE INCLUDED IN THE UNIT BID PRICE FOR EARTH EXCAVATION.
  - (h.) THE TEMPORARY EROSION CONTROL SYSTEMS SHALL BE REMOVED AS DIRECTED BY THE ENGINEER AFTER USE IS NO LONGER NEEDED OR NO LONGER FUNCTIONING. THE COST OF THIS REMOVAL SHALL BE INCLUDED IN THE UNIT BID PRICE FOR TEMPORARY EROSION CONTROL SYSTEM.

DESCRIPTION OF STRUCTURAL PRACTICES AFTER FINAL GRADING:

1. TEMPORARY EROSION CONTROL SYSTEMS SHALL BE LEFT IN PLACE WITH PROPER MAINTENANCE UNTIL PERMANENT EROSION CONTROL IS IN PLACE AND WORKING PROPERLY AND ALL PROPOSED TURF AREAS SEEDED AND ESTABLISHED.
2. ONCE PERMANENT EROSION CONTROL SYSTEMS AS PROPOSED IN THE PLANS ARE FUNCTIONAL AND ESTABLISHED, TEMPORARY ITEMS SHALL BE REMOVED, CLEANED UP, AND DISTURBED TURF RESEEDED.





MAINTENANCE AFTER CONSTRUCTION:

1. CONSTRUCTION IS COMPLETE AFTER ACCEPTANCE BY I.D.O.T. FINAL INSPECTION. MAINTENANCE UP TO THIS DATE WILL BE BY THE CONTRACTOR.

MISCELLANEOUS:

1. TEMPORARY DITCH CHECKS SHALL BE LOCATED AT EVERY FT. FALL/RISE IN DITCH GRADE.
2. TEMPORARY DITCH CHECKS, AGGREGATE USES GRADING NO. 3- REMOVE AT END OF CONSTRUCTION.
3. TEMPORARY EROSION CONTROL SEEDING SHALL BE APPLIED AT A RATE OF 100 LBS/ACRES.
4. MULCH AS APPLIED TO TEMPORARY EROSION CONTROL SEEDING SHALL BE BY THE METHOD SPECIFIED IN THE CONTRACT AND AT THE DIRECTION OF THE ENGINEER. MULCH WILL BE PAID SEPARATELY AND SHALL CONFORM TO SECTION 251 OF THE STANDARD SPECIFICATIONS.
5. CONSTRUCT PERIMETER EROSION CONTROL AT BEGINNING OF CONSTRUCTION. REMOVE AT END OF CONSTRUCTION.
6. ALL EROSION CONTROL PRODUCTS FURNISHED SHALL BE SPECIFICALLY RECOMMENDED BY THE MANUFACTURER FOR THE USE SPECIFIED IN THE EROSION CONTROL PLAN. PRIOR TO THE APPROVAL AND USE OF THE PRODUCT, THE CONTRACTOR SHALL SUBMIT TO THE ENGINEER A NOTARIZED CERTIFICATION BY THE PRODUCER STATING THE INTENDED USE OF THE PRODUCT AND THAT THE PHYSICAL PROPERTIES REQUIRED FOR THIS APPLICATION ARE MET OR EXCEEDED. THE CONTRACTOR SHALL PROVIDE MANUFACTURER INSTALLATION PROCEDURES TO FACILITATE THE ENGINEER IN CONSTRUCTION INSPECTION.

LEGEND

-  TEMPORARY DITCH CHECK- ROLLED EXCELSIOR, SILT WEDGES/PANELS
-  TEMPORARY DITCH CHECK- AGGREGATE
-  EROSION CONTROL BLANKET
-  PERIMETER EROSION BARRIER- SILT FILTER FENCE OR OTHER AS APPROVED BY THE ENGINEER
-  INLET AND PIPE PROTECTION- STRAW BALES, FILTER FABRIC, AGGREGATES

EROSION CONTROL SCHEDULE						
LOCATION		RT/LT	TEMP EROSION CTL SEEDING (ACRE)	MULCH METHOD 1 (ACRE)	PERIMETER EROSION BARRIER (FOOT)	
425+15	TO	430+16	LT	0.58	0.58	355
425+09	TO	430+33	RT	0.67	0.67	378
TOTAL				1.25	1.25	733.00

REVISIONS		DATE
NAME		

ILLINOIS DEPARTMENT OF TRANSPORTATION  
**STORM WATER POLLUTION PREVENTION PLAN**  
 FAP ROUTE 529  
 SECTION 28BR-2,3  
 ST CLAIR COUNTY

SCALE: VERT. \_\_\_\_\_  
 HORIZ. \_\_\_\_\_

DATE \_\_\_\_\_ DRAWN BY \_\_\_\_\_  
 CHECKED BY \_\_\_\_\_

Rev. Sheet 2-26-07

PLOT DATE = 2/21/2007  
 FILE NAME = c:\p\projects\984485\plan\p1n04105.dgn  
 PLOT SCALE = 984485 / IN  
 REFERENCE = 41874

F.A.P. RTE.	SECTION	COUNTY	TOTAL SHEETS	SHEET NO.
592	28BR-2,3	ST. CLAIR	51	10A
STA.		TO STA.		
FED. ROAD DIST. NO.	ILLINOIS	FED. AID PROJECT		

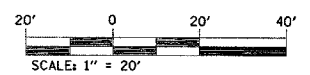
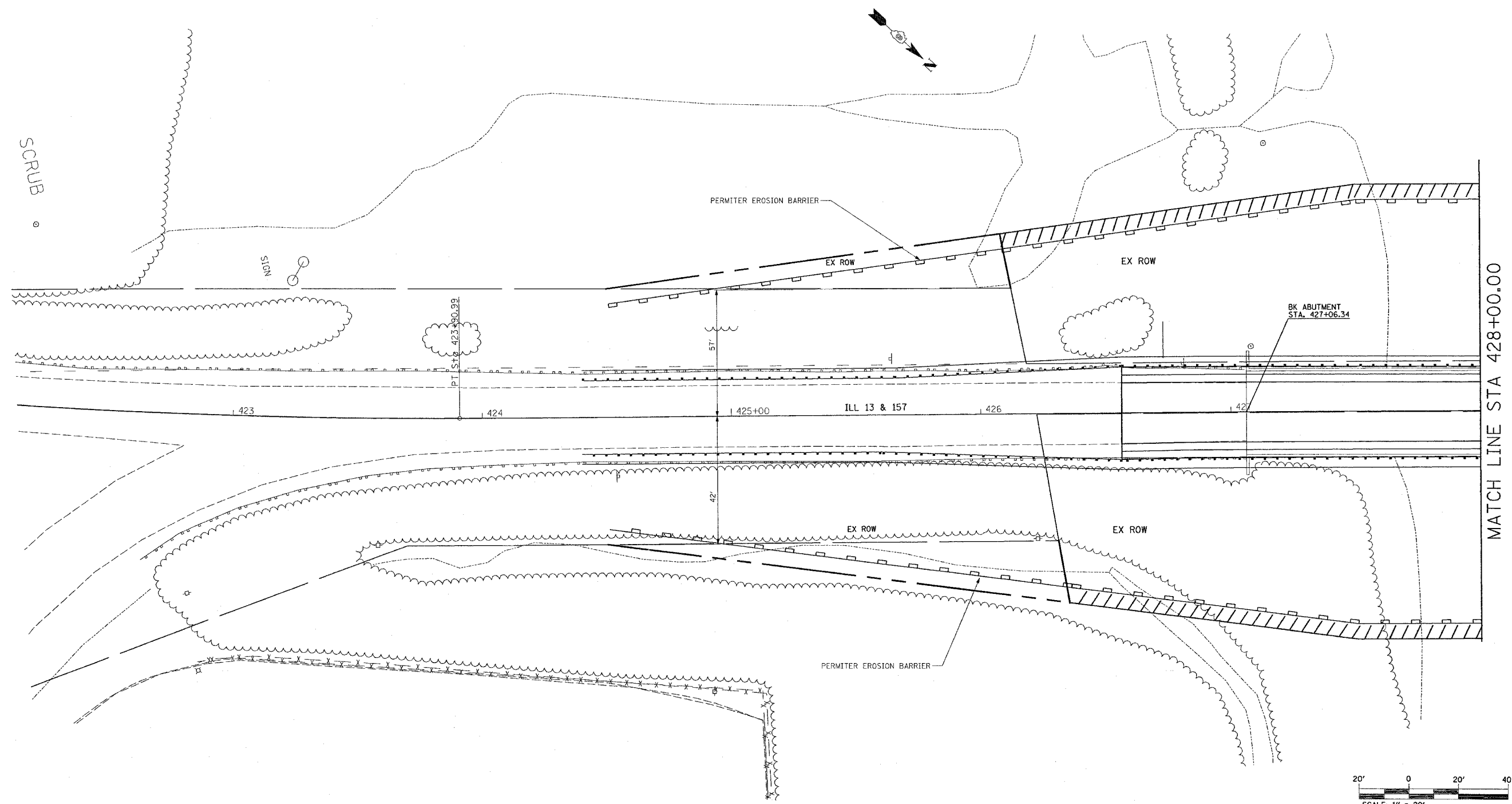

PLOT DATE = 2/21/2007  
 FILE NAME = \\s01\proj\28br\28br-2,3\plan\p04406.dgn  
 PLOT SCALE = 20.00000 / IN.  
 USER NAME = challenge

▲ ADDED SHEET 2-26-07

REVISIONS	
NAME	DATE

ILLINOIS DEPARTMENT OF TRANSPORTATION  
**EROSION CONTROL**  
 FAP ROUTE 592 (IL13/157)  
 SECTION 28BR-2,3  
 ST. CLAIR COUNTY

CONTRACT NO. 76904				
F.A.P. RTE.	SECTION	COUNTY	TOTAL SHEETS	SHEET NO.
592	28BR-2,3	ST. CLAIR	51	10B
STA.		TO STA.		
FED. ROAD DIST. NO.	ILLINOIS	FED. AID PROJECT		

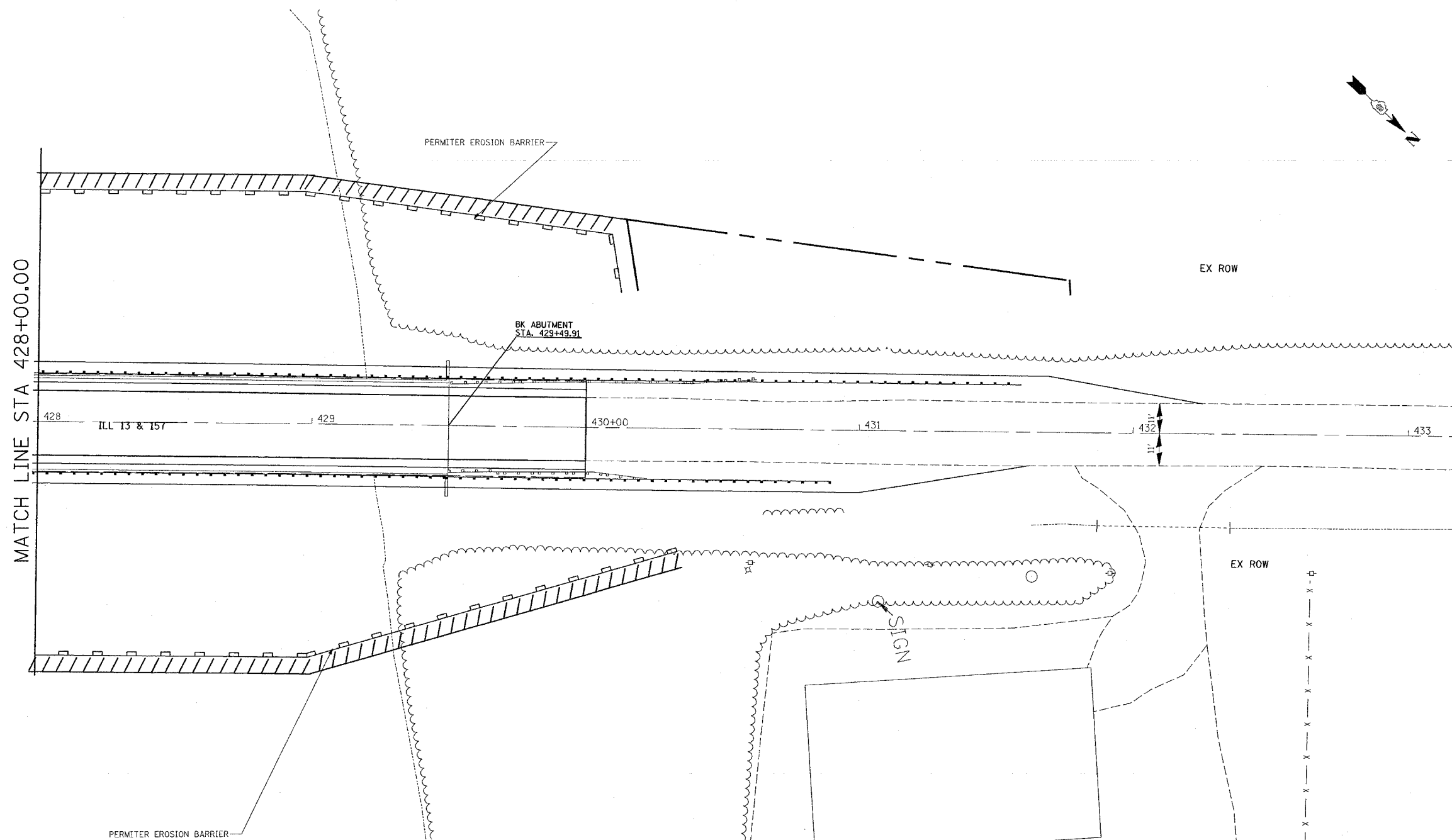

MATCH LINE STA 428+00.00



REVISIONS	
NAME	DATE

ILLINOIS DEPARTMENT OF TRANSPORTATION  
**EROSION CONTROL**  
 FAP ROUTE 592 (IL13/157)  
 SECTION 28BR-2,3  
 ST. CLAIR COUNTY

PLOT DATE = 2/21/2007  
 PLOT SCALE = 28.0000 / IN.  
 USER NAME = chullandake

ADDED SHEET 2-2L-07

FAP RTE.	SECTION	COUNTY	TOTAL SHEETS	SHEET NO.
592	28BR-2,3	ST. CLAIR	51	16
STA. 424+50.00		TO STA. 425+25.00		
FED. ROAD DIST. NO.		ILLINOIS FED. AID PROJECT		

FINAL SURVEY NO.	BY	DATE

ORIGINAL SURVEY NO.	BY	DATE

PLOT DATE = 2/21/2007  
 FILE NAME = c:\pro\pca\cd81485\plan\sheet16.dwg  
 PLOT SCALE = 1/8" = 1'-0"  
 USER NAME = chandler@skidmore

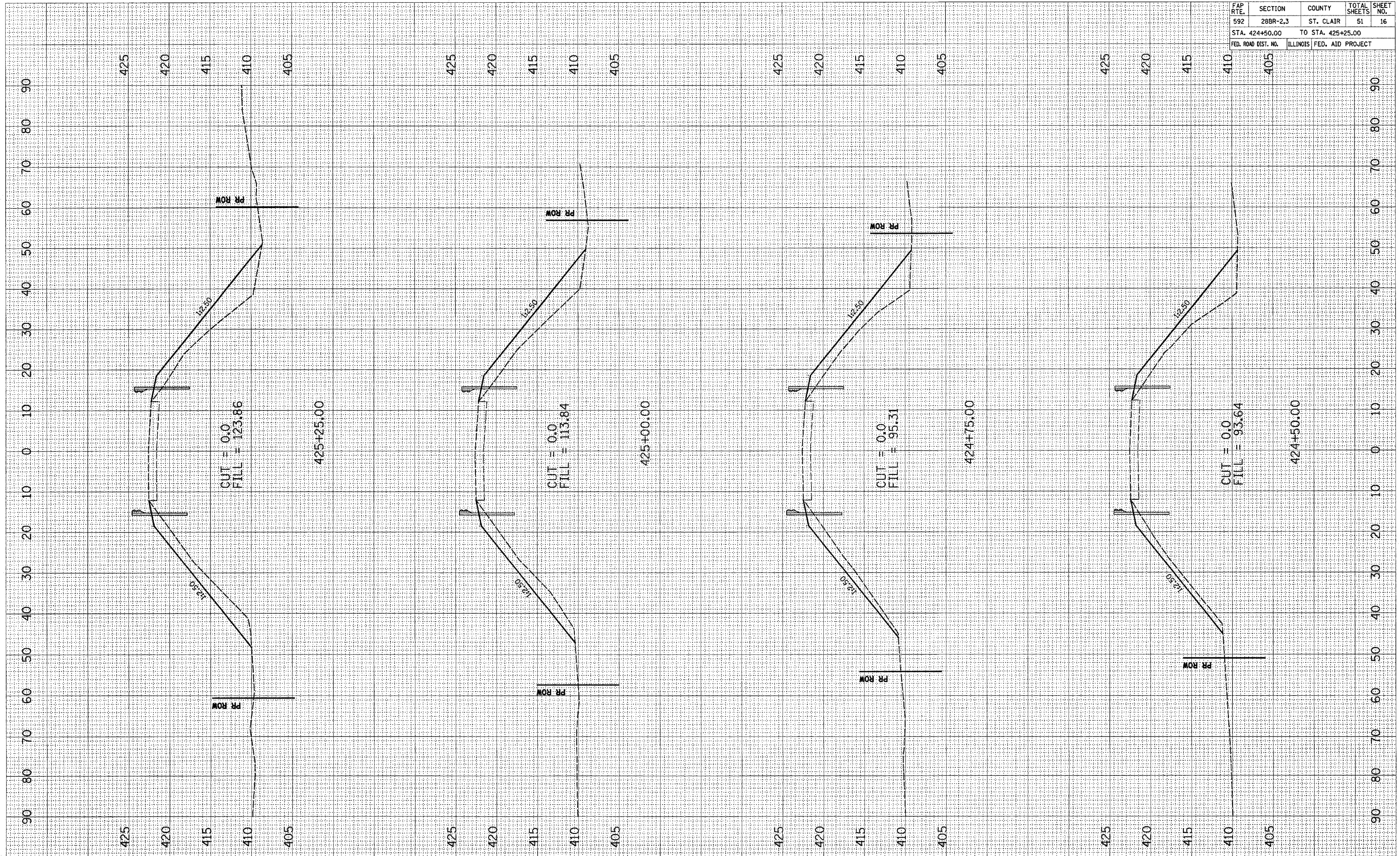

PLOT DATE = 2/21/2007  
 FILE NAME = c:\projects\ed04105\plan\shah\shah.dwg  
 PLOT SCALE = 8.0000' / 1" IN.  
 USER NAME = shahlandeko

ORIGINAL SURVEY BY DATE  
 SURVEYED BY DATE  
 TEMPLATE  
 AREAS CHECKED

FINAL SURVEY BY DATE  
 SURVEYED BY DATE  
 TEMPLATE  
 AREAS CHECKED

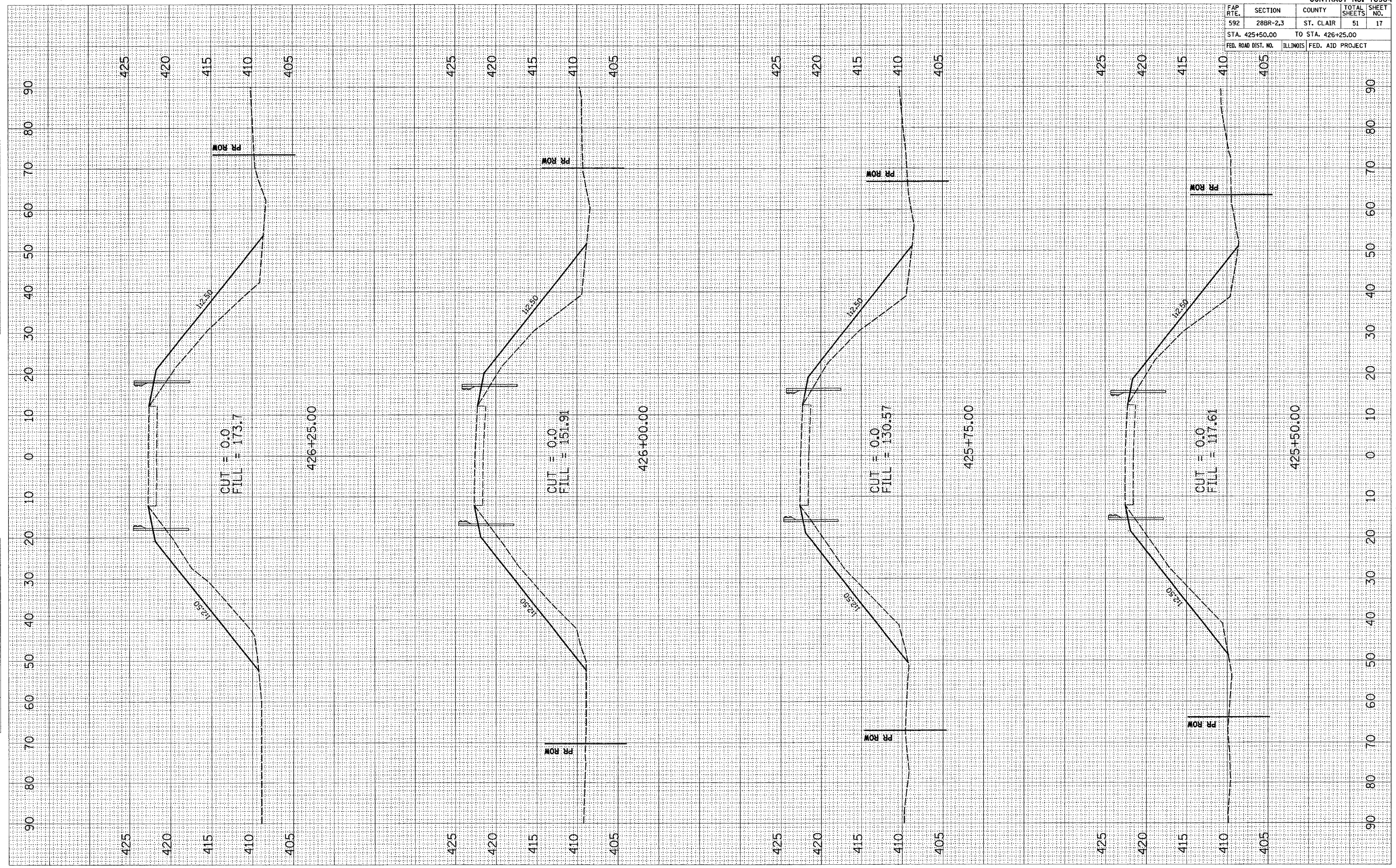

CONTRACT NO. 76904				
FAP RTE.	SECTION	COUNTY	TOTAL SHEETS	SHEET NO.
592	28BR-2,3	ST. CLAIR	51	17
STA. 425+50.00		TO STA. 426+25.00		
FED. ROAD DIST. NO.	ILLINOIS	FED. AID PROJECT		

PLOT DATE = 2/21/2007  
 FILE NAME = c:\pva\jose\c81405\plan\sheet\81418a.dwg  
 USER NAME = chandler@ebs

ORIGINAL SURVEY PLOTTED  
 SURVEY PLOTTED  
 TEMPLATE  
 AREAS CHECKED

FINAL SURVEY PLOTTED  
 SURVEY PLOTTED  
 TEMPLATE  
 AREAS CHECKED

BY \_\_\_\_\_ DATE \_\_\_\_\_

BY \_\_\_\_\_ DATE \_\_\_\_\_

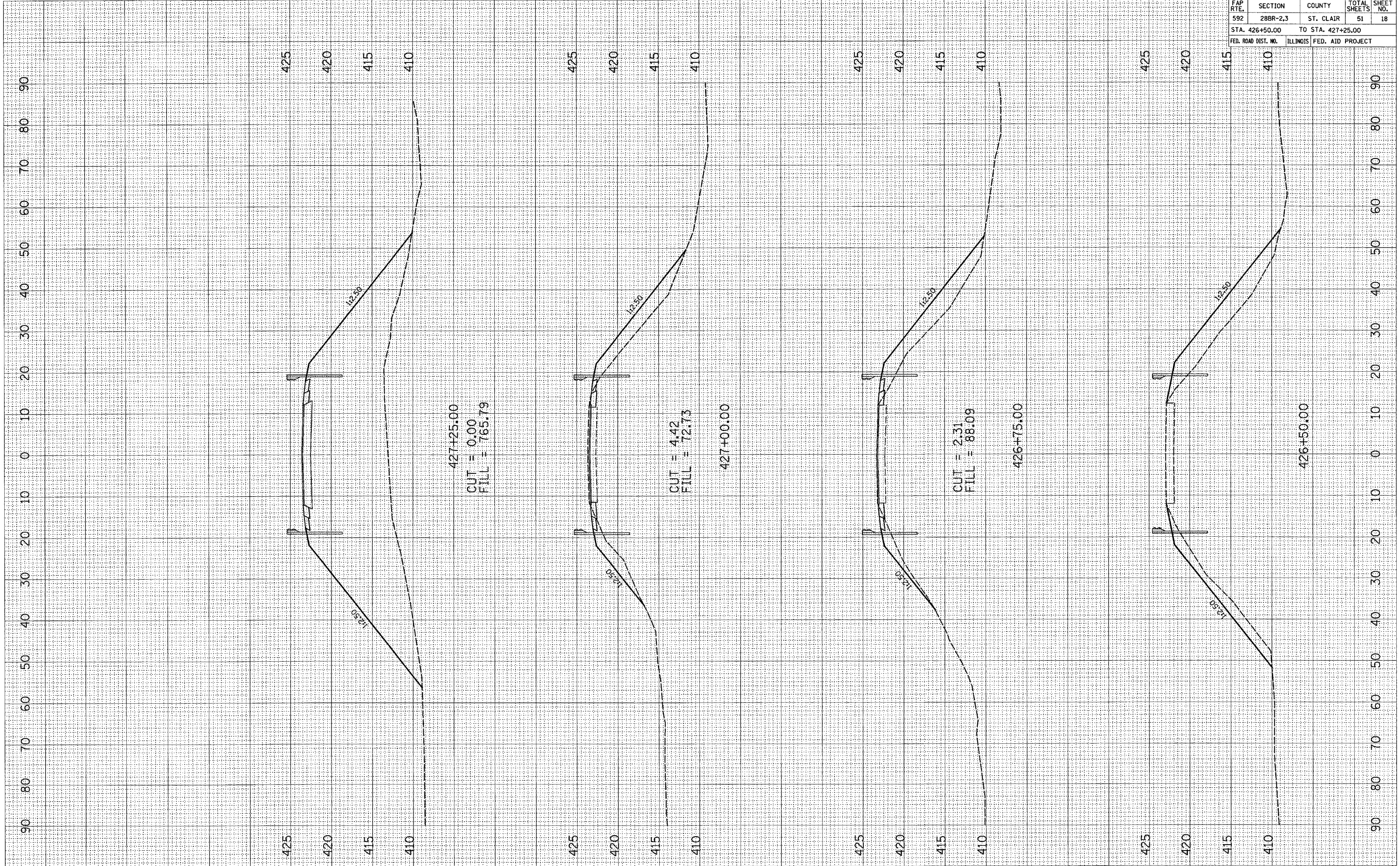

FAP R.T.E.	SECTION	COUNTY	TOTAL SHEETS	SHEET NO.
592	28BR-2,3	ST. CLAIR	51	18
STA. 426+50.00		TO STA. 427+25.00		
FED. ROAD DIST. NO.		ILLINOIS	FED. AID PROJECT	

CONTRACT NO. 76904

FAP RTE.	SECTION	COUNTY	TOTAL SHEETS	SHEET NO.
592	28BR-2,3	ST. CLAIR	51	19
STA. 427+50.00		TO STA. 428+00.00		
FED. ROAD DIST. NO.	ILLINOIS	FED. AID PROJECT		

FINAL SURVEY	SURVEYED	BY	DATE
NOTE BOOK	PLOTTED		
NO.	AREAS CHECKED		

ORIGINAL SURVEY	SURVEYED	BY	DATE
NO.	PLOTTED		
	AREAS CHECKED		

PLOT DATE = 2/21/2007  
 FILE NAME = \\s04485\env\work\4485\cd\work  
 PLOT SCALE = 10.0000' / IN.  
 USER NAME = challandake

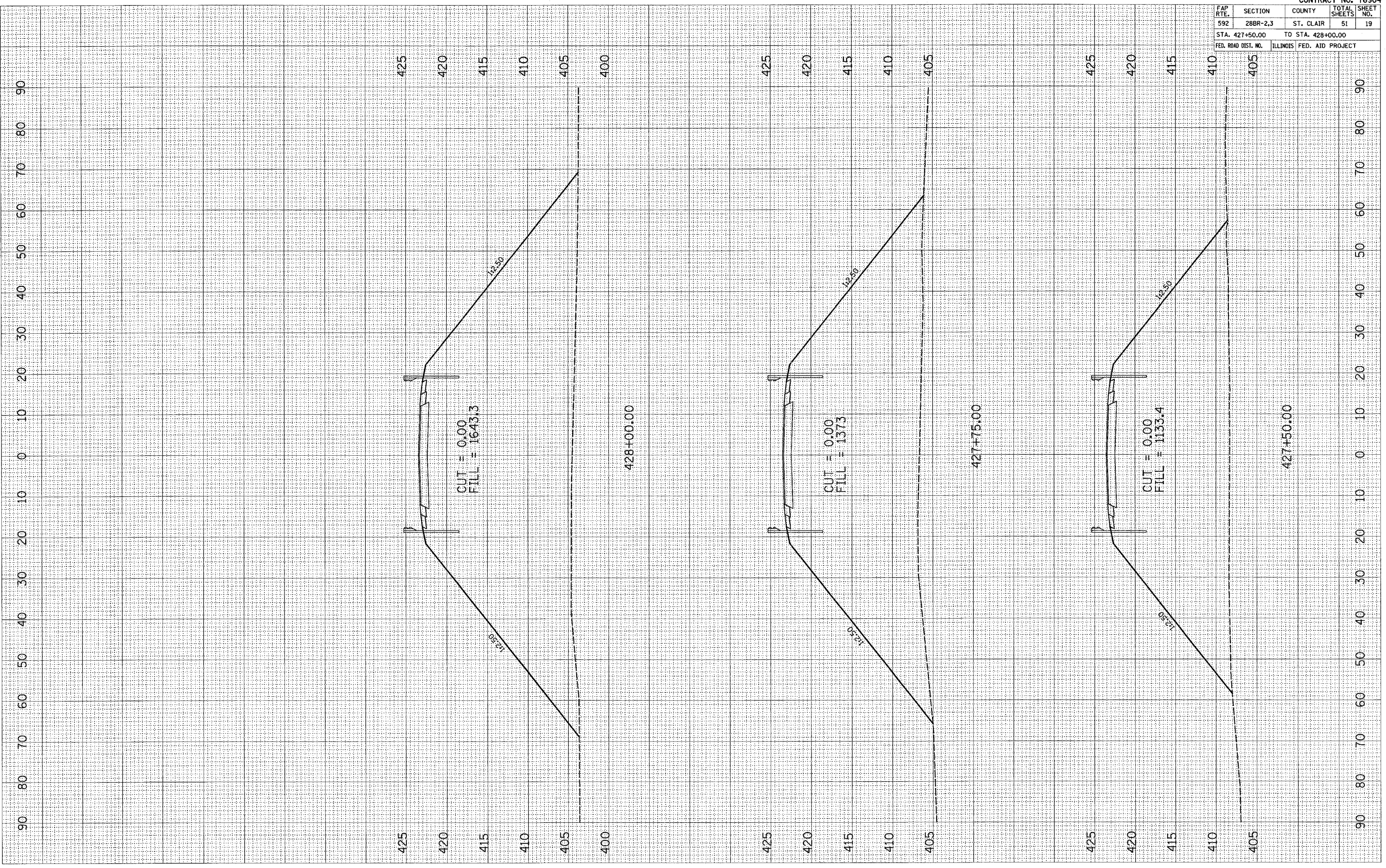



PLOT DATE = 2/21/2007  
 PLOT SCALE = 1"=40'  
 USER NAME = challandak

ORIGINAL SURVEY PLOTTED  
 SURVEY TEMPLATE AREAS CHECKED  
 NO.

FINAL SURVEY PLOTTED  
 SURVEY TEMPLATE AREAS CHECKED  
 NO.

BY \_\_\_\_\_ DATE \_\_\_\_\_

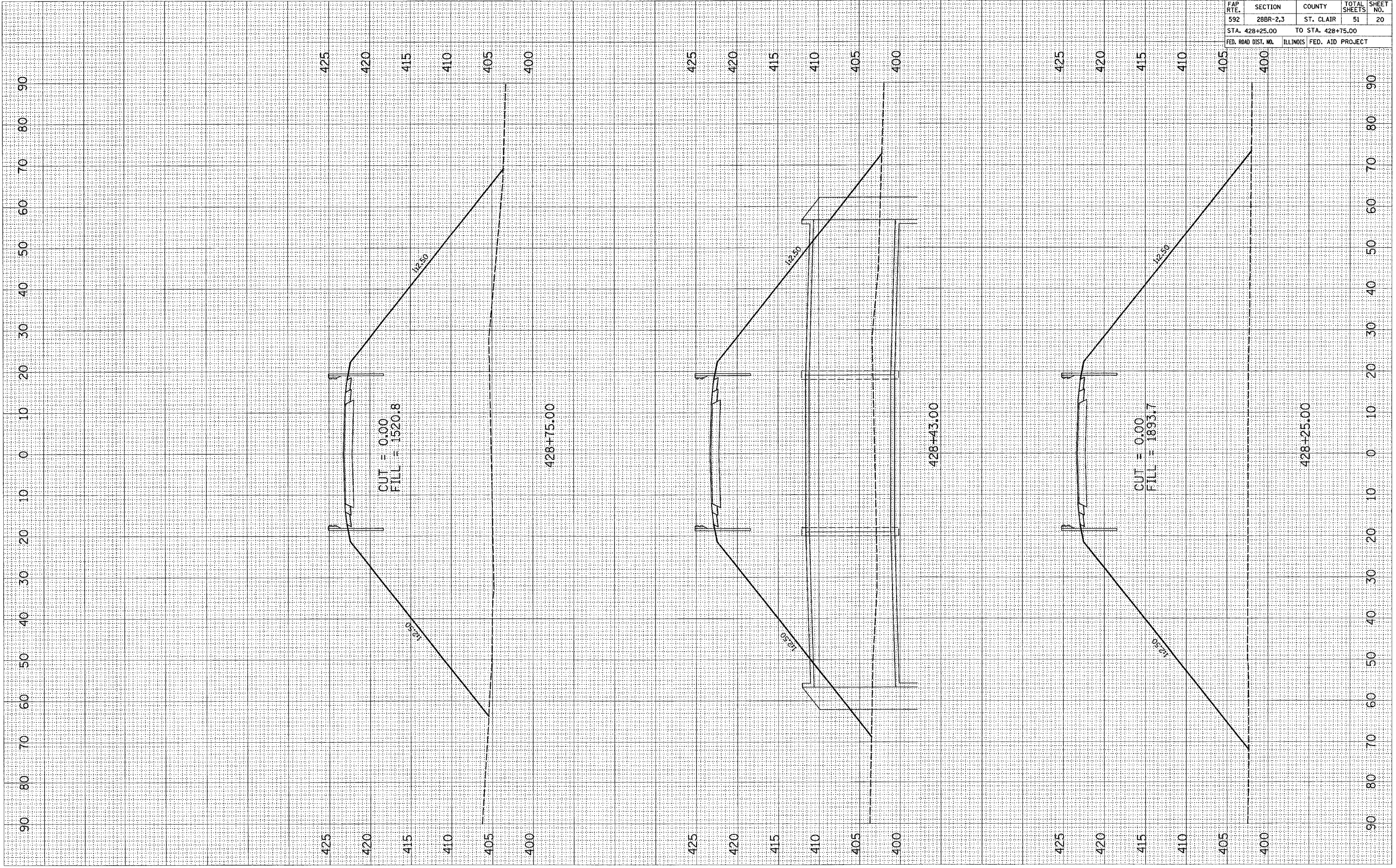

CONTRACT NO. 76904				
FAP RTE.	SECTION	COUNTY	TOTAL SHEETS	SHEET NO.
592	28BR-2,3	ST. CLAIR	51	20
STA. 428+25.00		TO STA. 428+75.00		
FED. ROAD DIST. NO.	ILLINOIS	FED. AID PROJECT		

Rev. Sheet 2-26-07

FAP RTE.	SECTION	COUNTY	TOTAL SHEETS	SHEET NO.
592	28BR-2,3	ST. CLAIR	51	21
STA. 429+00.00		TO STA. 429+75.00		
FED. ROAD DIST. NO.		ILLINOIS	FED. AID PROJECT	

FINAL SURVEY	REWORKED	BY	DATE
NO.	NO.		

ORIGINAL SURVEY	REWORKED	BY	DATE
NO.	NO.		

PLOT DATE = 2/21/2007  
 FILE NAME = c:\proje\mca\2044485\plan\sheet\21.dwg  
 PLOT SCALE = 1/8"=1'-0"  
 USER NAME = chollandare

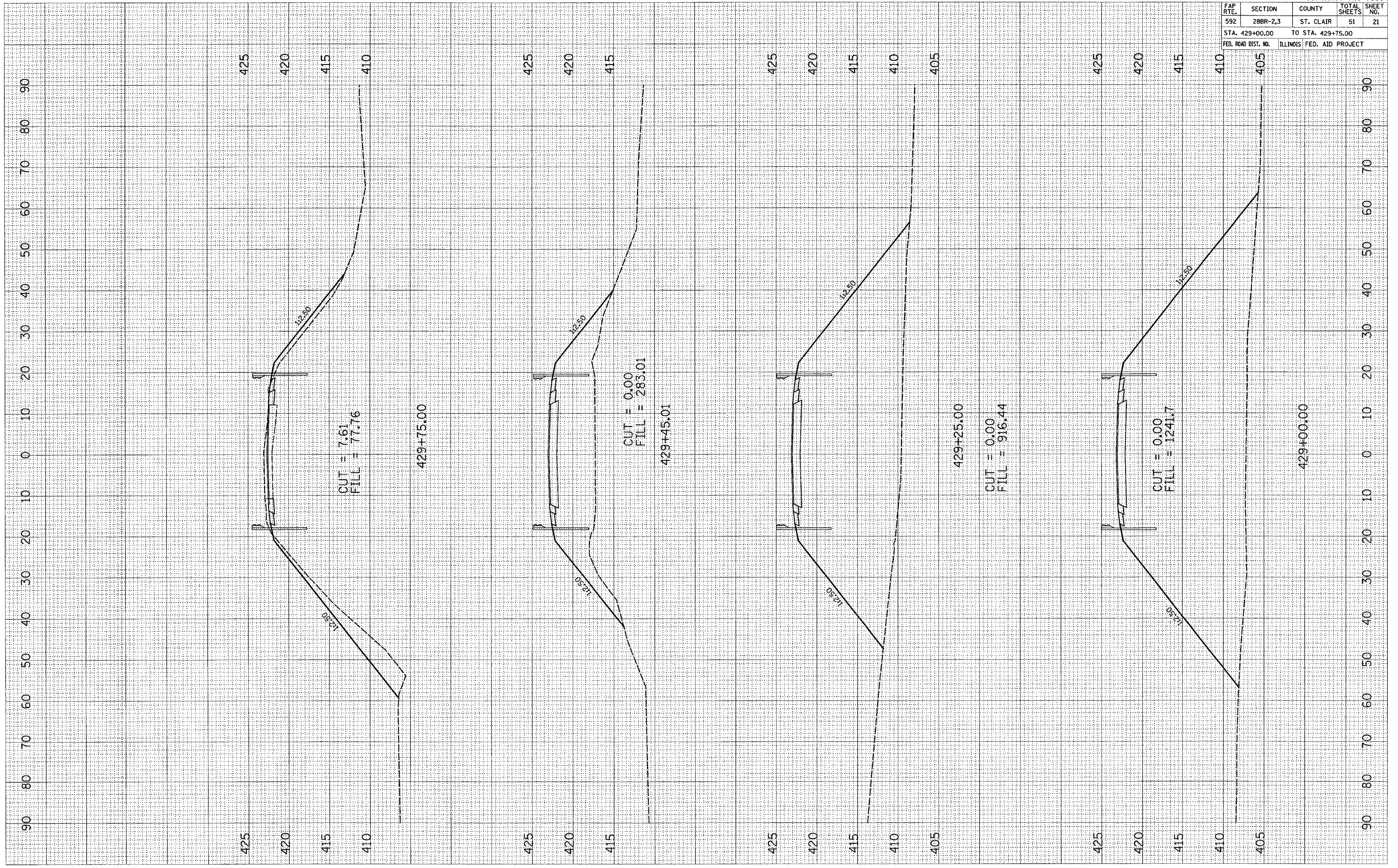

FAP R.T.E.	SECTION	COUNTY	TOTAL SHEETS	SHEET NO.
592	28BR-2,3	ST. CLAIR	51	22
STA. 430+00.00		TO STA. 430+75.00		
FED. ROAD DIST. NO.	ILLINOIS	FED. AID PROJECT		

FINAL SURVEY	BY	DATE
NOTE BOOK		
AREAS		
AREAS CHECKED		

ORIGINAL SURVEY	BY	DATE
NOTE BOOK		
AREAS		
AREAS CHECKED		

PLOT DATE = 2/21/2007  
 FILE NAME = c:\proje\28br\28br4185\plan\sheet\28br4185.dwg  
 PLOT SCALE = 1/8"=1'-0"  
 USER NAME = chlandeske



Rev. Sheet 2-26-07

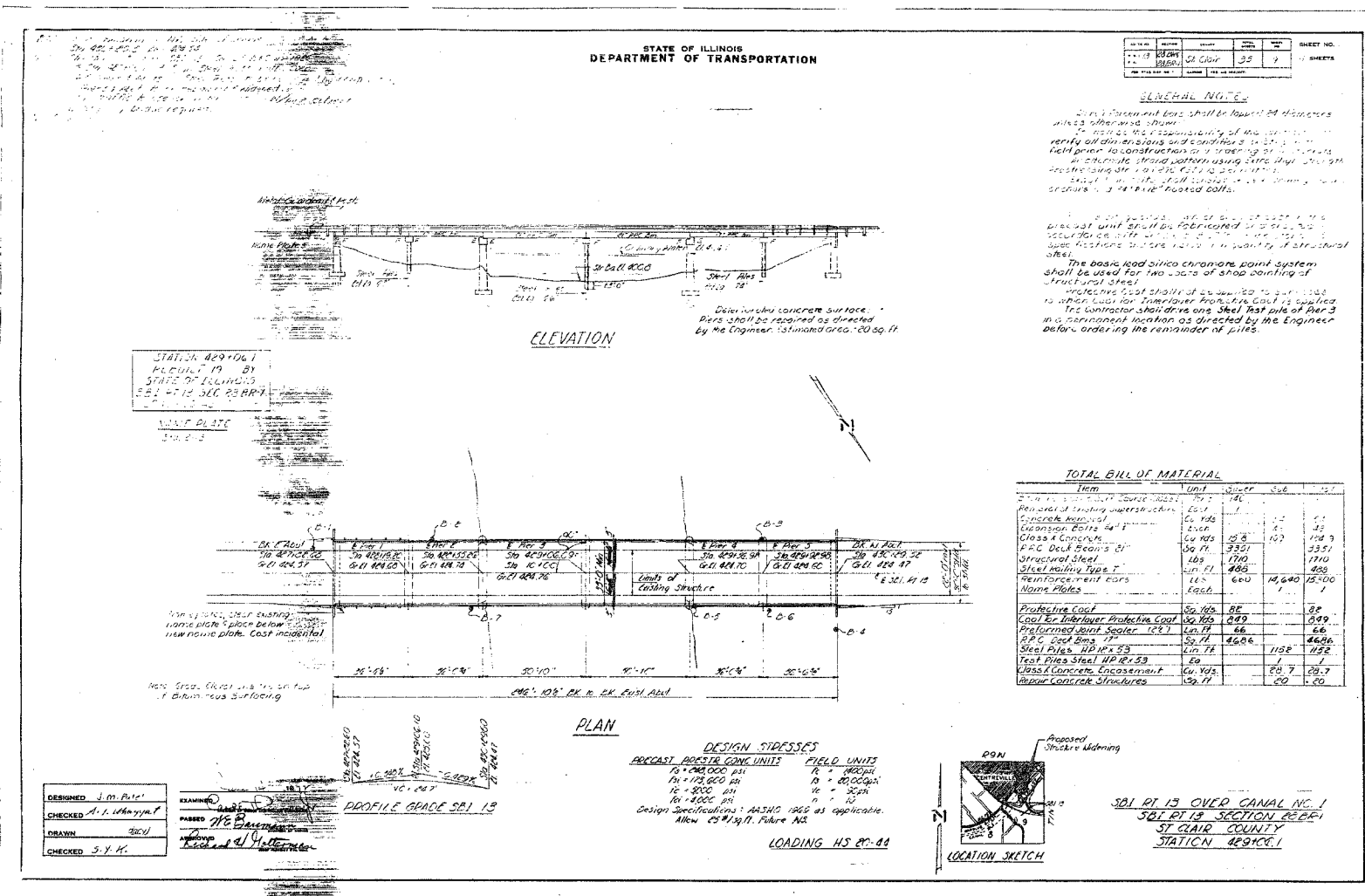

FOR INFORMATION ONLY

REVISIONS		ILLINOIS DEPARTMENT OF TRANSPORTATION
NAME	DATE	
		<b>EXISTING STRUCTURE OVER CANAL NO. 1</b> FAP ROUTE 592 (IL 13/157) SECTION 28BR-2,3 ST. CLAIR COUNTY SCALE: VERT. _____ HORIZ. _____ DATE _____ DRAWN BY _____ CHECKED BY _____

PLOT DATE = 2/29/2007  
 FILE NAME = c:\projects\1485\plan\1485a2.dgn  
 PLOT SCALE = 28.8000 / 1  
 USER NAME = gelinh

F.A.P. RTE.	SECTION	COUNTY	TOTAL SHEETS	SHEET NO.
592	28BR-2,3	ST. CLAIR	51	51B
STA.		TO STA.		
FED. ROAD DIST. NO.	ILLINOIS	FED. AID PROJECT		

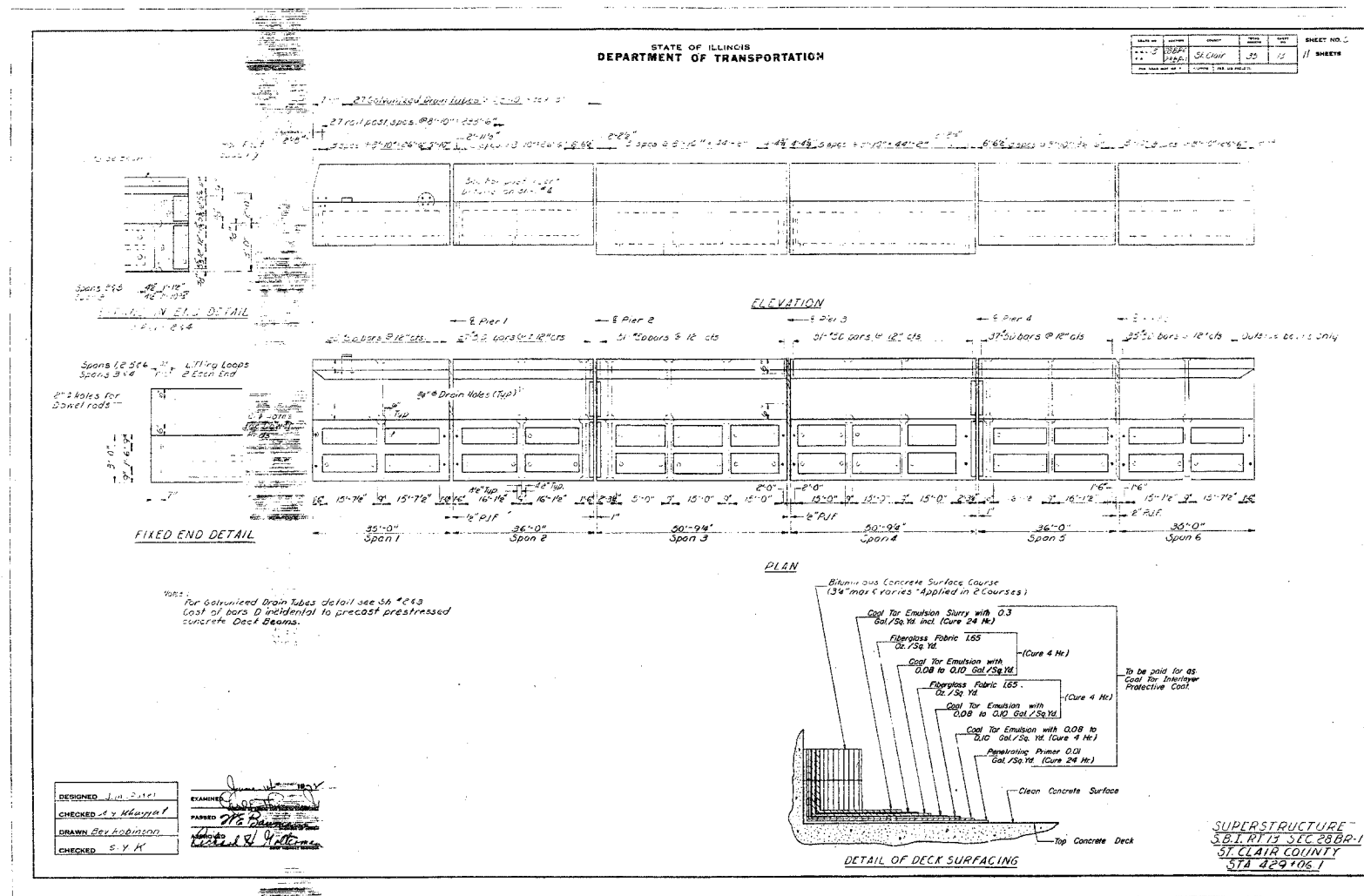

FOR INFORMATION ONLY

PLOT DATE = 2/26/2007  
 PLOT SCALE = 20/8000" = 1/400"  
 USER NAME = gcalch

ADDED SHEET 2-24-07

REVISIONS	
NAME	DATE

ILLINOIS DEPARTMENT OF TRANSPORTATION

**EXISTING STRUCTURE  
OVER CANAL NO. 1**

FAP ROUTE 592 (IL 13/157)  
SECTION 28BR-2,3  
ST. CLAIR COUNTY

SCALE: VERT. \_\_\_\_\_  
HORIZ. \_\_\_\_\_

DATE \_\_\_\_\_ DRAWN BY \_\_\_\_\_  
CHECKED BY \_\_\_\_\_



F.A.P. RTE.	SECTION	COUNTY	TOTAL SHEETS	SHEET NO.
592	28BR-2,3	ST. CLAIR	51	51d
STA.		TO STA.		
FED. ROAD DIST. NO.		ILLINOIS FED. AID PROJECT		

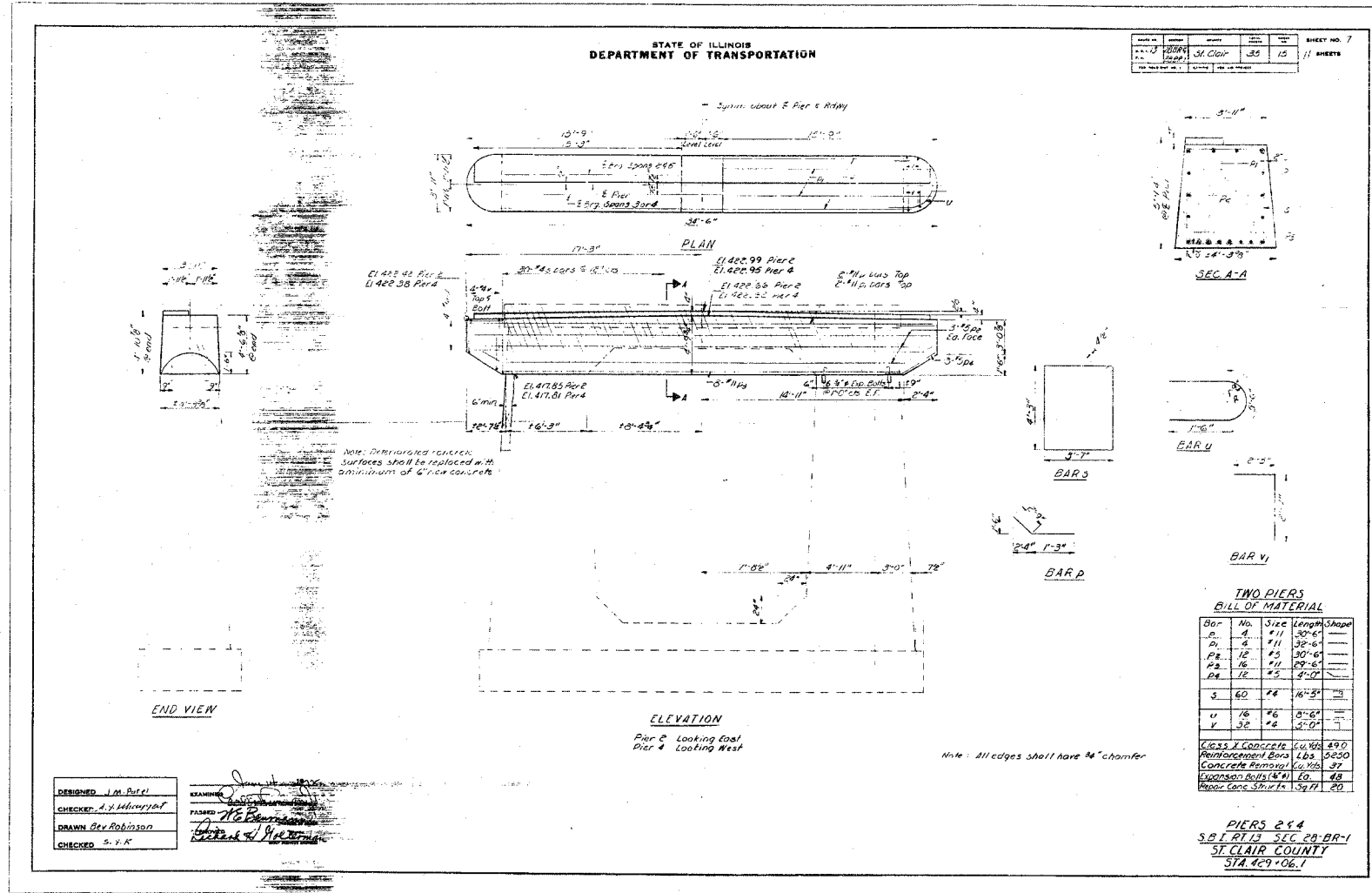

FOR INFORMATION ONLY

REVISIONS	
NAME	DATE

ILLINOIS DEPARTMENT OF TRANSPORTATION  
**EXISTING STRUCTURE  
OVER CANAL NO. 1**  
FAP ROUTE 592 (IL 13/157)  
SECTION 28BR-2,3  
ST. CLAIR COUNTY

SCALE: VERT. \_\_\_\_\_  
HORIZ. \_\_\_\_\_  
DATE \_\_\_\_\_ DRAWN BY \_\_\_\_\_  
CHECKED BY \_\_\_\_\_

F.A.P. RTE.	SECTION	COUNTY	TOTAL SHEETS	SHEET NO.
592	28BR-2,3	ST. CLAIR	51	51

STA.	TO STA.
FED. ROAD DIST. NO.	ILLINOIS FED. AID PROJECT

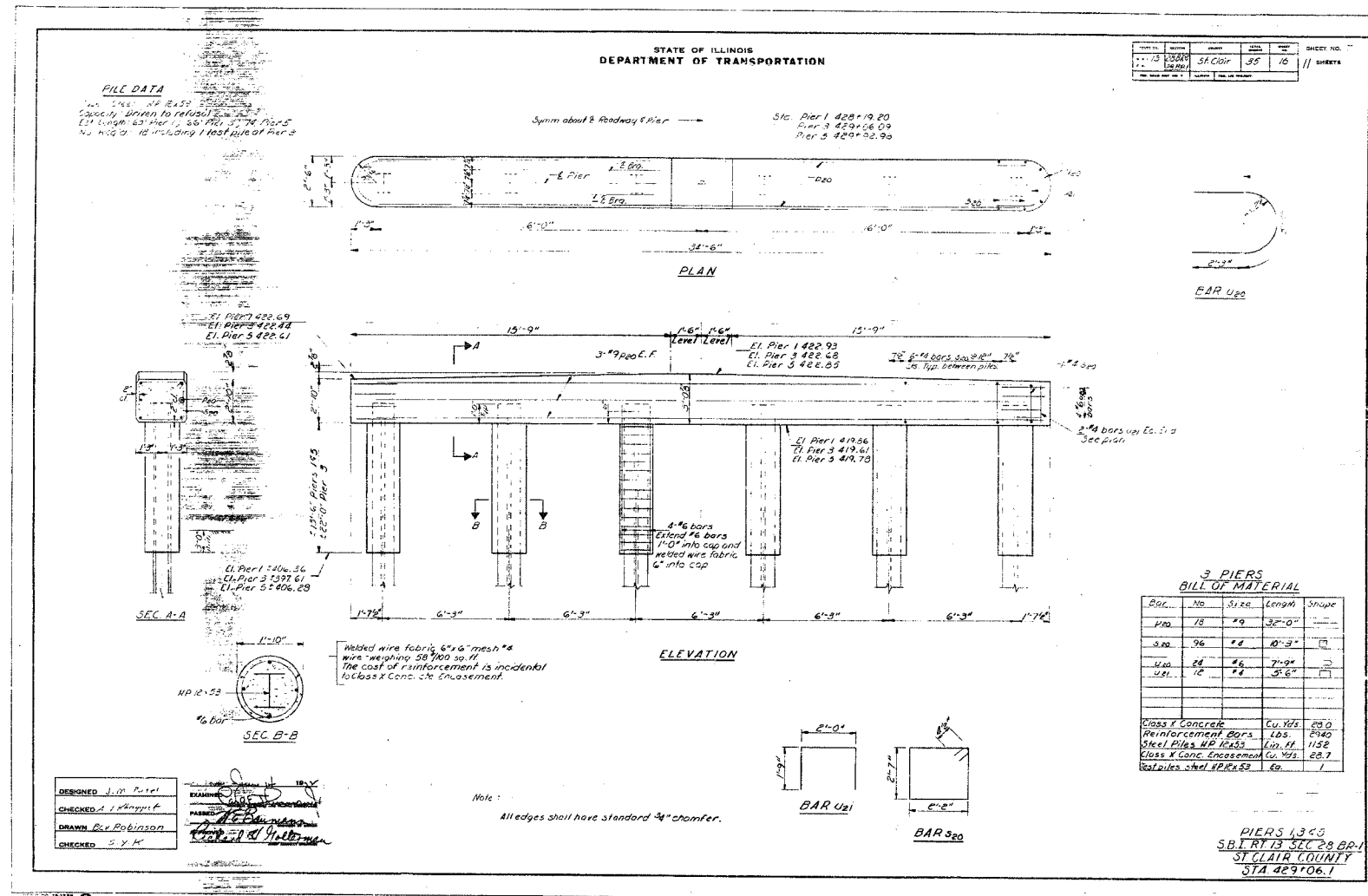

FOR INFORMATION ONLY

REVISIONS		ILLINOIS DEPARTMENT OF TRANSPORTATION EXISTING STRUCTURE OVER CANAL NO. 1 FAP ROUTE 592 (IL 13/157) SECTION 28BR-2,3 ST. CLAIR COUNTY
NAME	DATE	

SCALE: VERT. \_\_\_\_\_  
 HORIZ. \_\_\_\_\_  
 DATE \_\_\_\_\_

DRAWN BY \_\_\_\_\_  
 CHECKED BY \_\_\_\_\_

PLOT DATE = 2/26/2007  
 PLOT SCALE = 20/8000  
 USER NAME = gmlsh

ADDED SHEET 2-26-07