

F.A.I. RTE.	SECTION	COUNTY	TOTAL SHEETS	SHEET NO.
255			35	24

STA. _____ TO STA. _____

FED. ROAD DIST. NO. ILLINOIS FED. AID PROJECT

- DIST 8 ITS 2007-1, 2A
- MADISON & ST CLAIR COUNTIES

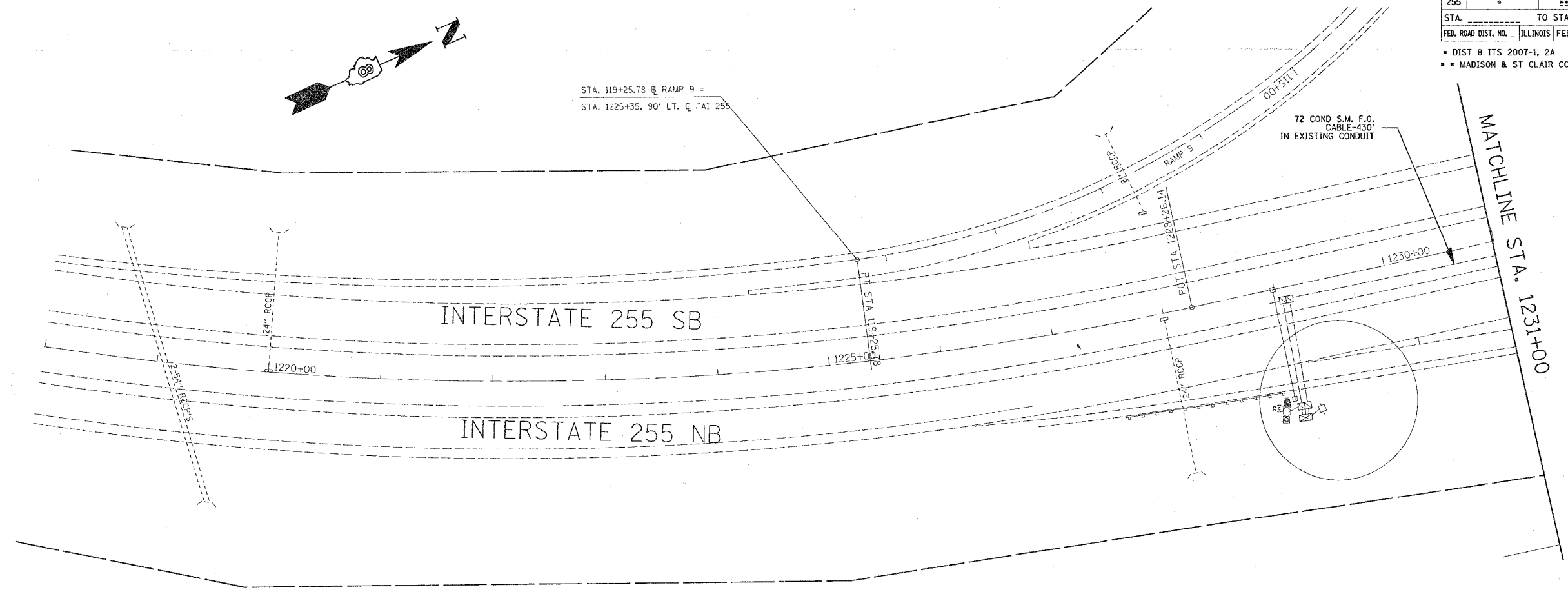
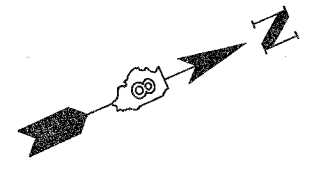

STA. 119+25.78 @ RAMP 9 =
STA. 1225+35, 90' LT. @ FAI 255

72 COND S.M. F.O. CABLE-430' IN EXISTING CONDUIT

MATCHLINE STA. 1231+00

72 COND S.M. F.O. CABLE-87' IN EXISTING CONDUIT

80' ITS TOWER EX.

72 COND S.M. F.O. CABLE-10' IN EXISTING CONDUIT

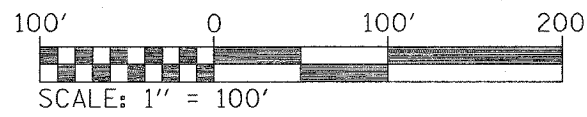

I-255
STA. 1218+00-STA. 1231+00
SHEET 12 OF 15

REVISIONS	
NAME	DATE

ILLINOIS DEPARTMENT OF TRANSPORTATION
ITS PLAN
SHEET 12 OF 15
FAI 255
SECTION DIST 8 ITS 2007-1, 2A
MADISON & ST. CLAIR COUNTIES

SCALE: VERT. _____
HORIZ. _____
DATE _____ DRAWN BY _____
CHECKED BY _____

PLOT DATE = 12/11/2006
FILE NAME = c:\pro\pct\ad\1365\electrical\map\121800.dgn
PLOT SCALE = 49.9992' / IN.
REFERENCE = #REF#