

FAP. RFL.	SECTION	COUNTY	TOTAL SHEETS	SHEET NO.
	94-F3000-06-BT	COOK		14
STA. 151+00		TO STA. 202+00		
FED. ROAD DIST. NO.	ILLINOIS	83709	STPE-0001(479)	

**COORDINATE DATA:**

306	N 1967217.337 E 1047772.688
307	N 1967205.132 E 1047912.025
308	N 1967245.088 E 1048180.192

309	N 1967234.356 E 1048280.375
310	N 1967202.941 E 1048363.493
311	N 1967190.067 E 1048438.314
312	N 1967193.680 E 1048614.011

313	N 1967167.358 E 1048702.018
314	N 1967141.007 E 1048788.002
315	N 1967142.362 E 1048979.403
316	N 1967142.696 E 1049002.186

317	N 1967151.000 E 1049375.019
318	N 1967155.652 E 1049432.828
319	N 1967168.289 E 1049523.600
320	N 1967173.061 E 1049590.731

321	N 1967173.338 E 1049667.143
322	N 1967167.062 E 1049747.949
323	N 1967161.358 E 1049783.593
324	N 1967155.079 E 1049862.588

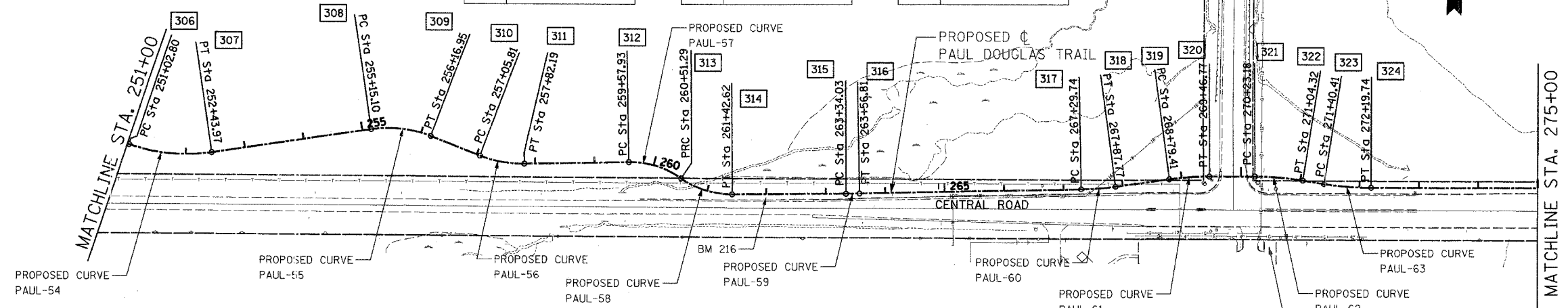

**PROPOSED CURVE DATA**

PROP. CURVE PAUL-54 PI STA. = 251+74.72 Δ = 26° 57' 41" (LT) D = 19° 05' 55" R = 300.00' T = 71.92' L = 141.17' E = 8.50' P.C. STA = 251+02.80 P.T. STA = 252+43.97	PROP. CURVE PAUL-55 PI STA. = 255+67.16 Δ = 29° 10' 44" (RT) D = 28° 38' 52" R = 200.00' T = 52.06' L = 101.85' E = 6.66' P.C. STA = 255+15.10 P.T. STA = 256+16.95	PROP. CURVE PAUL-56 PI STA. = 257+44.47 Δ = 21° 52' 57" (LT) D = 28° 38' 52" R = 200.00' T = 38.66' L = 76.38' E = 3.70' P.C. STA = 257+05.81 P.T. STA = 257+82.19	PROP. CURVE PAUL-57 PI STA. = 260+06.17 Δ = 35° 39' 37" (RT) D = 38° 11' 50" R = 150.00' T = 48.25' L = 93.36' E = 7.57' P.C. STA = 259+57.93 P.T. STA = 260+51.29	PROP. CURVE PAUL-58 PI STA. = 260+98.42 Δ = 34° 53' 16" (LT) D = 38° 11' 50" R = 150.00' T = 47.13' L = 91.34' E = 7.23' P.C. STA = 260+51.29 P.T. STA = 261+42.62	PROP. CURVE PAUL-59 PI STA. = 263+45.42 Δ = 0° 52' 13" (LT) D = 3° 49' 11" R = 1,500.00' T = 11.39' L = 22.79' E = 0.04' P.C. STA = 263+34.03 P.T. STA = 263+56.81	PROP. CURVE PAUL-60 PI STA. = 267+58.79 Δ = 6° 38' 58" (LT) D = 11° 27' 33" R = 500.00' T = 29.05' L = 58.03' E = 0.84' P.C. STA = 267+29.74 P.T. STA = 267+87.77	PROP. CURVE PAUL-61 PI STA. = 269+13.14 Δ = 7° 43' 05" (RT) D = 11° 27' 33" R = 500.00' T = 33.73' L = 67.35' E = 1.14' P.C. STA = 268+79.41 P.T. STA = 269+46.77	PROP. CURVE PAUL-62 PI STA. = 270+63.84 Δ = 9° 17' 52" (RT) D = 11° 27' 33" R = 500.00' T = 40.66' L = 81.14' E = 1.65' P.C. STA = 270+23.18 P.T. STA = 271+04.32	PROP. CURVE PAUL-63 PI STA. = 271+80.16 Δ = 9° 05' 25" (LT) D = 11° 27' 33" R = 500.00' T = 39.75' L = 79.33' E = 1.58' P.C. STA = 271+40.41 P.T. STA = 272+19.74
--	--	---	---	---	---	--	--	--	--

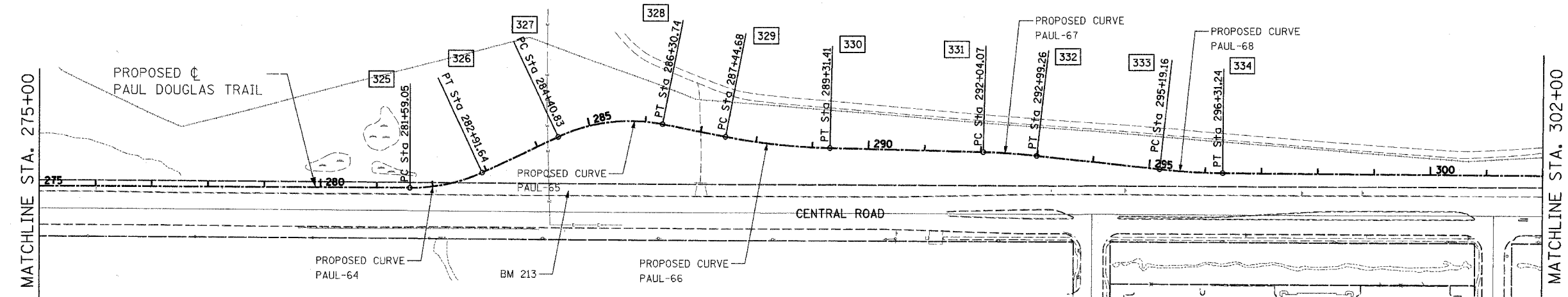

**PROPOSED CURVE DATA**

PROP. CURVE PAUL-64 PI STA. = 282+26.44 Δ = 25° 19' 22" (LT) D = 19° 05' 55" R = 300.00' T = 67.40' L = 132.59' E = 7.48' P.C. STA = 281+59.05 P.T. STA = 282+91.64	PROP. CURVE PAUL-65 PI STA. = 285+39.09 Δ = 36° 16' 13" (RT) D = 19° 05' 55" R = 300.00' T = 98.26' L = 189.91' E = 15.68' P.C. STA = 284+40.83 P.T. STA = 286+30.74	PROP. CURVE PAUL-66 PI STA. = 288+38.27 Δ = 9° 43' 34" (LT) D = 5° 12' 31" R = 1,100.00' T = 93.59' L = 186.73' E = 3.97' P.C. STA = 287+44.68 P.T. STA = 289+31.41	PROP. CURVE PAUL-67 PI STA. = 292+51.70 Δ = 4° 57' 29" (RT) D = 5° 12' 31" R = 1,100.00' T = 47.62' L = 95.19' E = 1.03' P.C. STA = 292+04.07 P.T. STA = 292+99.26	PROP. CURVE PAUL-68 PI STA. = 295+75.25 Δ = 5° 50' 15" (LT) D = 5° 12' 31" R = 1,100.00' T = 56.08' L = 112.07' E = 1.43' P.C. STA = 295+19.16 P.T. STA = 296+31.24
--	---	--	---	--

**COORDINATE DATA:**

325	N 1967155.079 E 1050801.892	330	N 1967229.677 E 1051547.674
326	N 1967183.905 E 1050930.207	331	N 1967223.865 E 1051820.278
327	N 1967247.718 E 1051065.067	332	N 1967217.723 E 1051915.236
328	N 1967271.085 E 1051250.355	333	N 1967194.052 E 1052133.861
329	N 1967249.446 E 1051362.223	334	N 1967187.680 E 1052245.703

NOTE:  
FOR CONTROL POINT AND BENCHMARK INFORMATION  
SEE SHEET 10.

ILLINOIS DEPARTMENT OF TRANSPORTATION  
DISTRICT NO. 1 SCHAUMBURG  
**ALIGNMENT, BENCHMARKS,  
AND TIES**

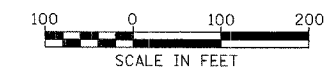

SCALE AS NOTED  
DATE MARCH 28, 2006  
DRAWN BY RTA  
CHECKED BY SMH