

- | EXISTING LEGEND | | PROPOSED LEGEND | |
|-----------------|---|-----------------|--|
| | PAVEMENT REMOVAL (HOT-MIX ASPHALT) | | COMB CC&G (DEPRESSED) |
| | HOT-MIX ASPHALT SURFACE REMOVAL, 2 3/4" | | DETECTABLE WARNINGS |
| | CURB AND GUTTER OR CURB REMOVAL | | HOT-MIX ASPHALT SURFACE COURSE, MIX "D", N70; 2" LEVELING BINDER (MACHINE METHOD), N50; 3/4" |
| | FENCE REMOVAL | | TYPE A RAMP |
| | DRIVEWAY REMOVAL | | |
| | SIDEWALK REMOVAL | | |
| | TREE REMOVAL (OF SIZE SHOWN) | | |
| | TEMPORARY FENCE | | |

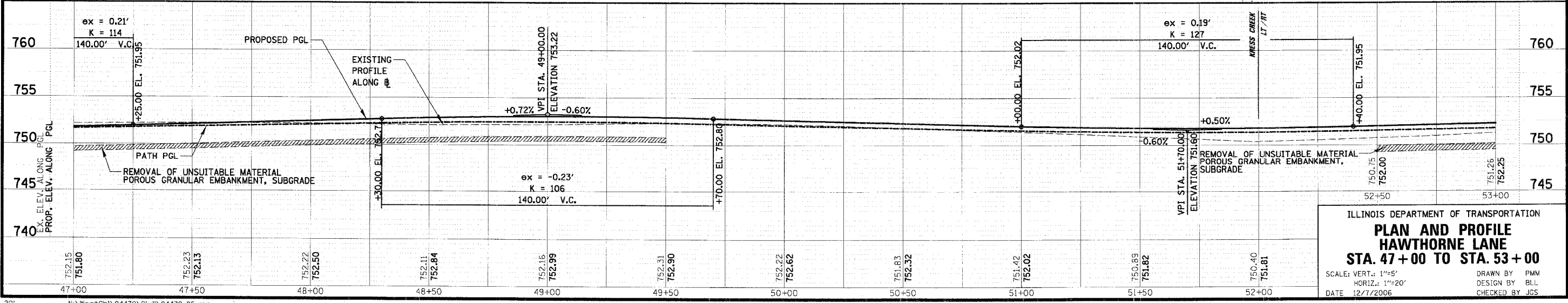
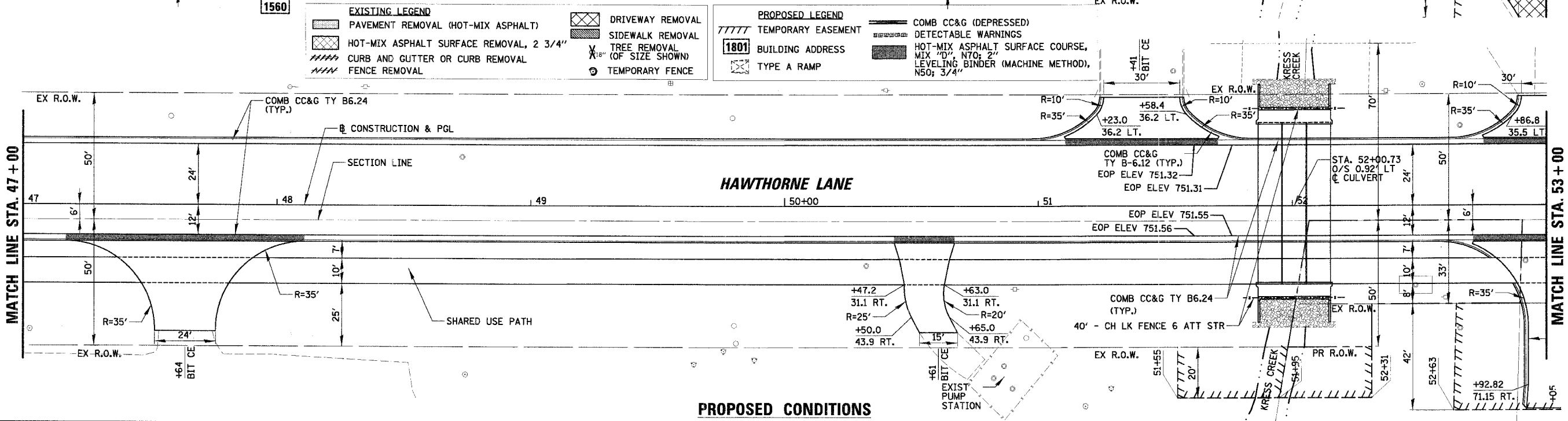

ILLINOIS DEPARTMENT OF TRANSPORTATION
PLAN AND PROFILE
HAWTHORNE LANE
STA. 47+00 TO STA. 53+00
 SCALE: VERT. 1"=5'
 HORIZ. 1"=20'
 DATE 12/7/2006
 DRAWN BY PMM
 DESIGN BY BLL
 CHECKED BY JCS

PLAN
 SURVEYED BY
 ALIGNED
 CHECKED
 ST. OF MAX. CURVATURE
 DATE FILE NAME

PROFILE
 SURVEYED BY
 GRADES
 CHECKED
 ELEV. NOTED
 STRUCTURE
 WATERING OTHER

N:\WestCh\04479\04479.TBL
 N:\WestCh\04479\Civil\04479_05.rpp