

F.A.U. RT.:	SECTION	COUNTY	TOTAL SHEETS	SHEET NO.
1389	99-00062-00-PV	DUPAGE	199	39
CONTRACT NO. 83873				
FED. ROAD DIST. NO.	ILLINOIS FED. AID PROJECT			

PLAN  
 SURVEYED BY: \_\_\_\_\_ DATE: \_\_\_\_\_  
 CHECKED BY: \_\_\_\_\_  
 NOTE BOOK NO. \_\_\_\_\_  
 ALIGNMENT CHECKED BY: \_\_\_\_\_  
 STATIONING NO. \_\_\_\_\_  
 ROAD FILE NAME: \_\_\_\_\_

PROFILE  
 SURVEYED BY: \_\_\_\_\_ DATE: \_\_\_\_\_  
 CHECKED BY: \_\_\_\_\_  
 NOTE BOOK NO. \_\_\_\_\_  
 STRUCTURE NO. / TYPE OF RD: \_\_\_\_\_

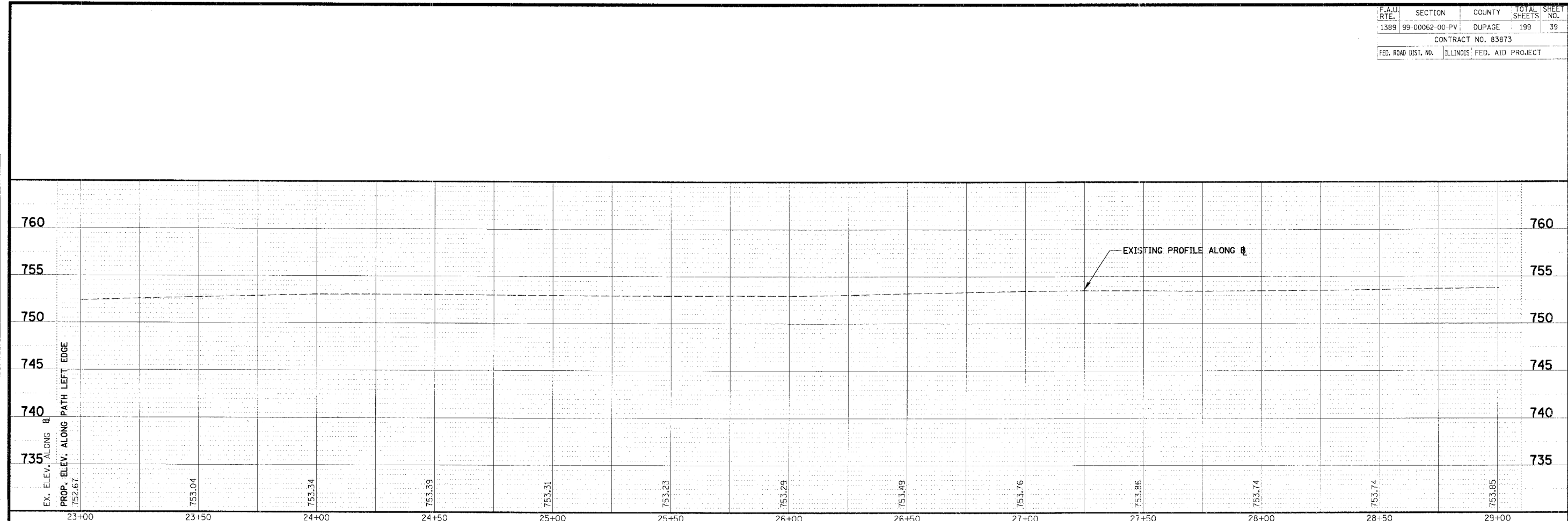

EX. ELEV. ALONG  $\emptyset$   
 PROP. ELEV. ALONG PATH LEFT EDGE

NOTE:  
 ALL PATH VPI'S TO HAVE  
 5' VERTICAL CURVES, OR AS SHOWN

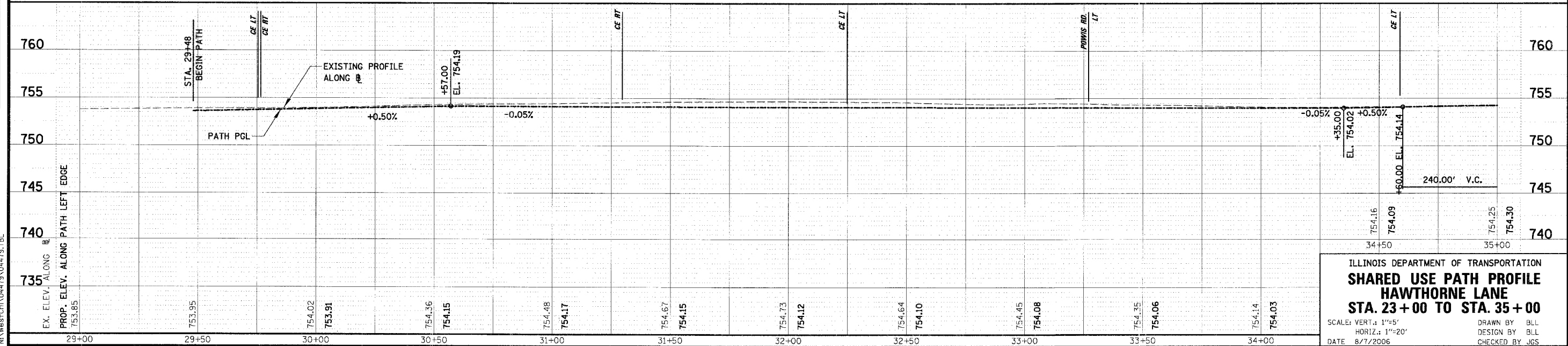

EX. ELEV. ALONG  $\emptyset$   
 PROP. ELEV. ALONG PATH LEFT EDGE

ILLINOIS DEPARTMENT OF TRANSPORTATION  
**SHARED USE PATH PROFILE**  
**HAWTHORNE LANE**  
**STA. 23 + 00 TO STA. 35 + 00**  
 SCALE: VERT.: 1"=5'  
 HORIZ.: 1"=20'  
 DATE 8/7/2006  
 DRAWN BY BILL  
 DESIGN BY BILL  
 CHECKED BY JGS