

P.A.U. NO.:	SECTION	COUNTY	TOTAL SHEETS	SHEET NO.
1389	99-00062-00-PV	DUPAGE	199	63
CONTRACT NO. 83873				
FED. ROAD DIST. NO. ILLINOIS FED. AID PROJECT				

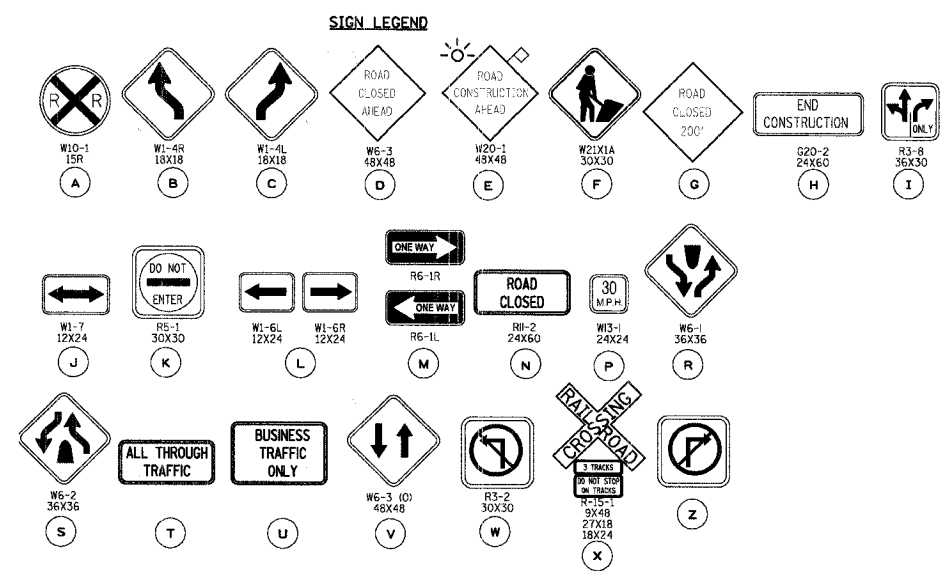
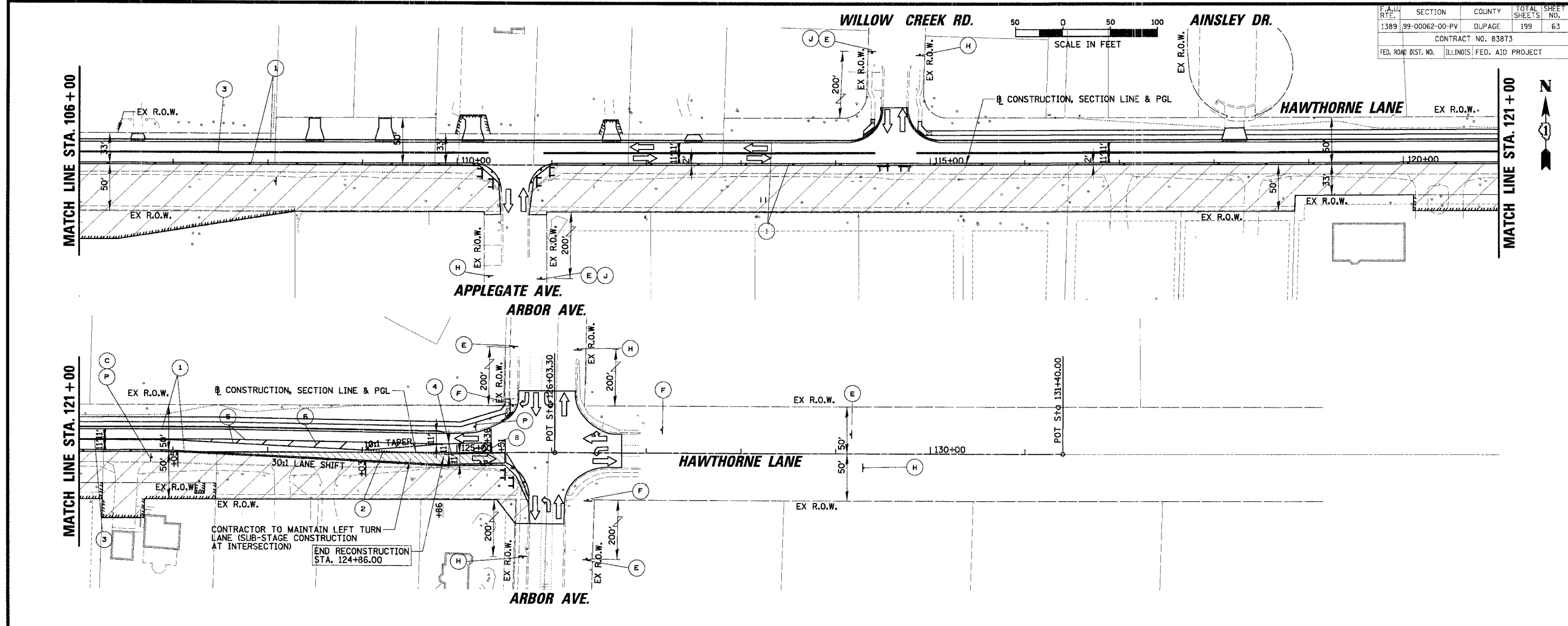

- LEGEND**
- ① TEMPORARY PAVEMENT MARKING - LINE 4" (WHITE)
 - ② TEMPORARY PAVEMENT MARKING - LINE 6" (WHITE SKIP-DASH 6'-2')
 - ③ TEMPORARY PAVEMENT MARKING - LINE 4" (DOUBLE YELLOW @ 11" C-C)
 - ④ TEMPORARY PAVEMENT MARKING - LINE 6" (WHITE)
 - ⑤ TEMPORARY PAVEMENT MARKING - LINE 4" (YELLOW)
 - ⑥ TEMPORARY PAVEMENT MARKING - LINE 12" (YELLOW DIAGONALS @ 20' C-C)
 - ⑦ TEMPORARY PAVEMENT MARKING - LINE 12" (WHITE DIAGONALS @ 10' C-C)
 - ⑧ TEMPORARY PAVEMENT MARKING - LINE 24" (WHITE)
 - ⑨ TEMPORARY PAVEMENT MARKING - LETTERS AND SYMBOLS (WHITE)
- LEGEND**
- WORK ZONE
 - TEMPORARY PAVEMENT
 - TYPE II BARRICADE W/ LIGHT OR VERTICAL PANEL W/ LIGHT
 - TYPE III BARRICADE W/ LIGHTS
 - WORK ZONE SIGN
 - TRAFFIC FLOW

REVISIONS		ILLINOIS DEPARTMENT OF TRANSPORTATION	
NAME	DATE	MAINTENANCE OF TRAFFIC - STAGE 5	
		HAWTHORNE LANE	
		STA. 106+00 TO STA. 121+00	
		SCALE: 50'	DRAWN BY: PMM
		DATE: 1/5/2007	DESIGN BY: BLL
			CHECKED BY: JGS

N:\WestCnt\04479\04479.TBL