

F.A.M. RTE.	SECTION	COUNTY	TOTAL SHEETS	SHEET NO.
1389	99-00062-00-PV	DUPAGE	199	93
CONTRACT NO. 83873				
FED. ROAD DIST. NO. ILLINOIS FED. AID PROJECT				

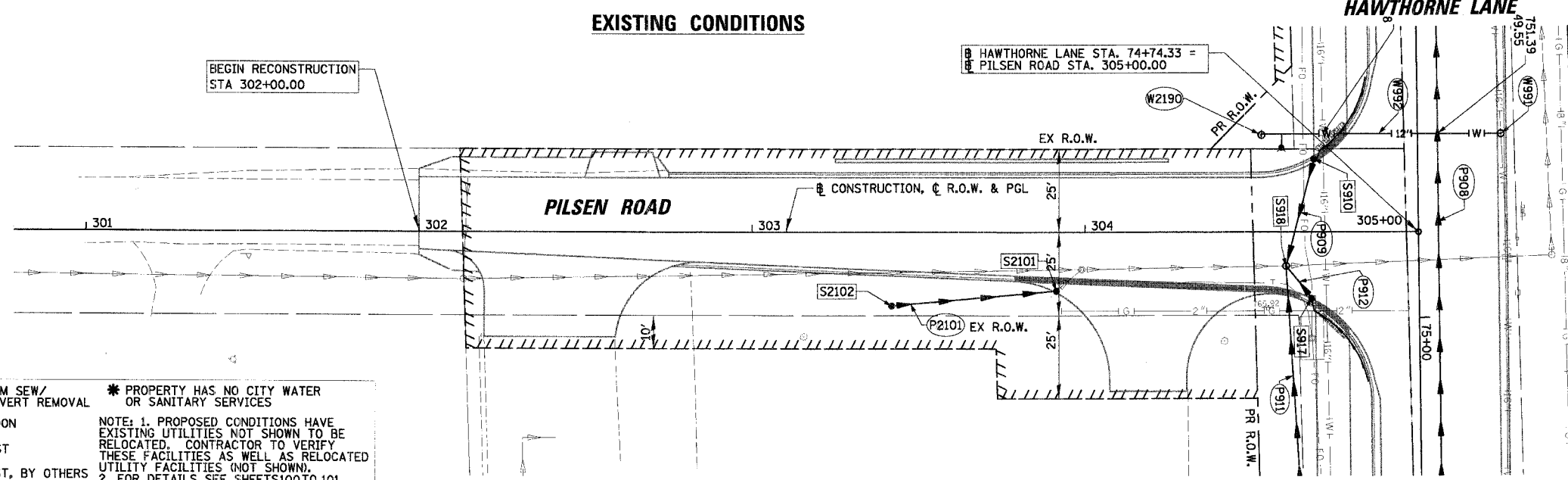
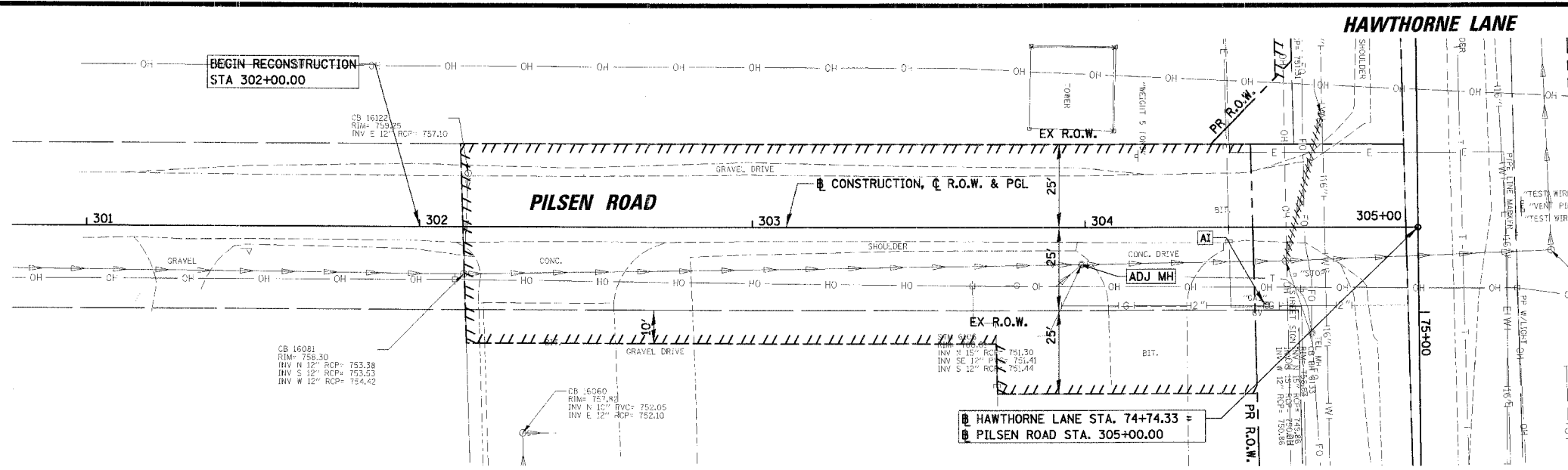
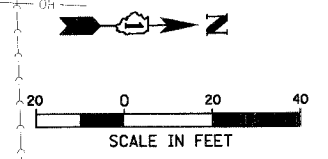

LEGEND

[R] REMOVAL **|||||** STRM SEW/ CULVERT REMOVAL * PROPERTY HAS NO CITY WATER OR SANITARY SERVICES

[RI] REMOVAL, BY OTHERS **[AB]** ABANDON NOTE: 1. PROPOSED CONDITIONS HAVE EXISTING UTILITIES NOT SHOWN TO BE RELOCATED. CONTRACTOR TO VERIFY THESE FACILITIES AS WELL AS RELOCATED UTILITY FACILITIES (NOT SHOWN). 2. FOR DETAILS SEE SHEETS 100 TO 101.

[REC] RECONSTRUCT **[ADJ]** ADJUST

[REL] RELOCATE **[AI]** ADJUST, BY OTHERS

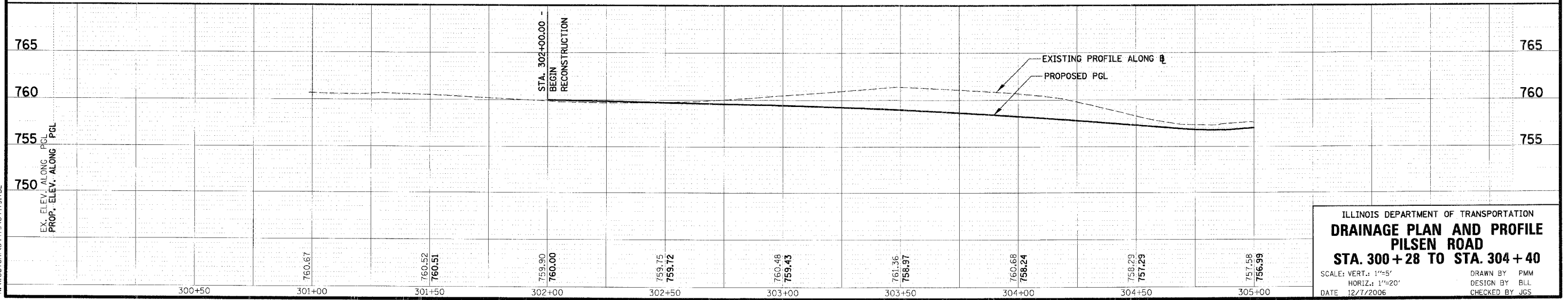

ILLINOIS DEPARTMENT OF TRANSPORTATION
DRAINAGE PLAN AND PROFILE
PILSEN ROAD
STA. 300 + 28 TO STA. 304 + 40
 SCALE: VERT.: 1"=5'
 HORIZ.: 1"=20'
 DATE: 12/7/2006
 DRAWN BY: PMM
 DESIGN BY: BLL
 CHECKED BY: JGS

DATE: _____ BY: _____
 PLAN NO. _____
 CHECKED BY: _____
 DATE: _____

DATE: _____ BY: _____
 PROFILE NO. _____
 CHECKED BY: _____
 DATE: _____

n:\westch\04479\04479.dwg