

ORIGINAL SURVEY	DATE
BLANK/VP	BY
PLOTTED	DATE
TEMPLATE	BY
NOTES CHECKED	DATE
DATE	BY

CHRISTOPHER B. BURKE ENGINEERING LTD.
 9575 West Higgins Road, Suite 600
 Rosemont, Illinois 60018
 (847) 823-0500

FINAL SURVEY	DATE
NOTED	BY
DATE	BY
DATE	BY

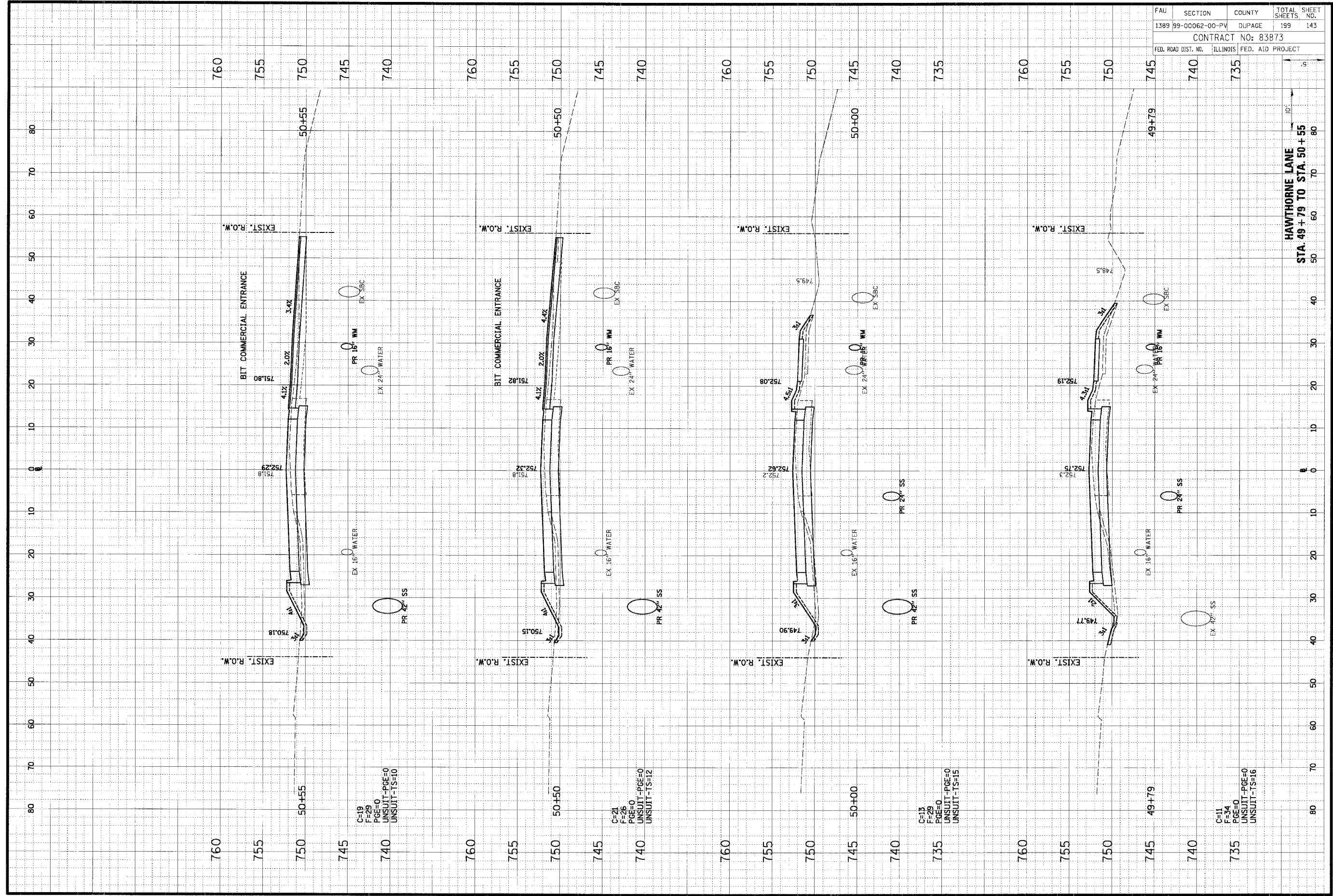

FAU	SECTION	COUNTY	TOTAL SHEETS	SHEET NO.
1389	99-00062-00-PV	DUPAGE	199	143
CONTRACT NO: 83873				
FED. ROAD DIST. NO.	ILLINOIS FED. AID PROJECT			

HAWTHORNE LANE
 STA. 49+79 TO STA. 50+55