

ORIGINAL SURVEY	DATE
SURVEYED	BY
PLANNED	
FIELD	
AREAS	
NO.	

**CHRISTOPHER B. BURKE ENGINEERING LTD.**  
 9575 West Higgins Road, Suite 600  
 Rosemont, Illinois 60018  
 (847) 923-0500

FINAL SURVEY	DATE
PLANNED	
FIELD	
AREAS	
NO.	

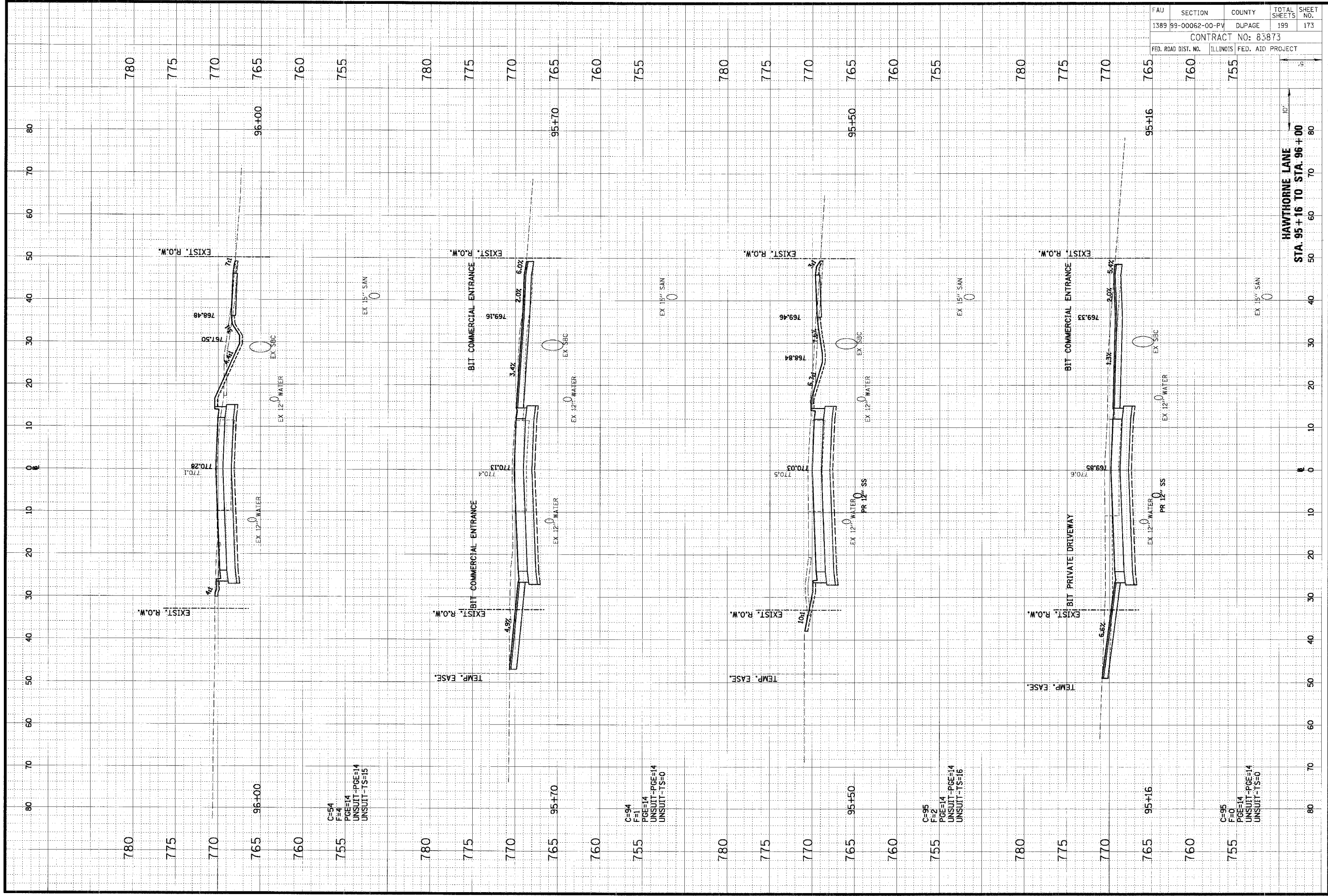

FAU	SECTION	COUNTY	TOTAL SHEETS	SHEET NO.
1389	99-00062-00-PV	DUPAGE	199	173
CONTRACT NO: 83873				
FED. ROAD DIST. NO.	ILLINOIS	FED. AID PROJECT		

HAWTHORNE LANE  
 STA. 95 + 16 TO STA. 96 + 00