

| STRUC. NO. | STA. | OFFSET | TYPE | RIM ELEV. | INV. ELEV. |
|------------|-------|--------|--|-----------|------------------------------------|
| 18 | 20+15 | 13' RT | R.D. STORM SEWER MANHOLE, 4' DIA., TYPE 1 FRAME, CLOSED LID | 617.30 | 613.10 NE 612.95 NW 612.90 S |
| 19 | 20+25 | 18' LT | R.D. CATCH BASIN, 4' DIA. TYPE 1 FRAME, OPEN LID | 617.00 | 613.25 SE |
| 20 | 20+28 | 18' RT | R.D. CATCH BASIN, 4' DIA. TYPE 1 FRAME, OPEN LID | 617.00 | 613.25 SW |
| C-4 | 20+30 | 0 | R.D. COMBINED SEWER MANHOLE, 4' DIA., TYPE 1 FRAME, CLOSED LID | 617.65 | 610.97 N-S |

EXISTING TOPOGRAPHY

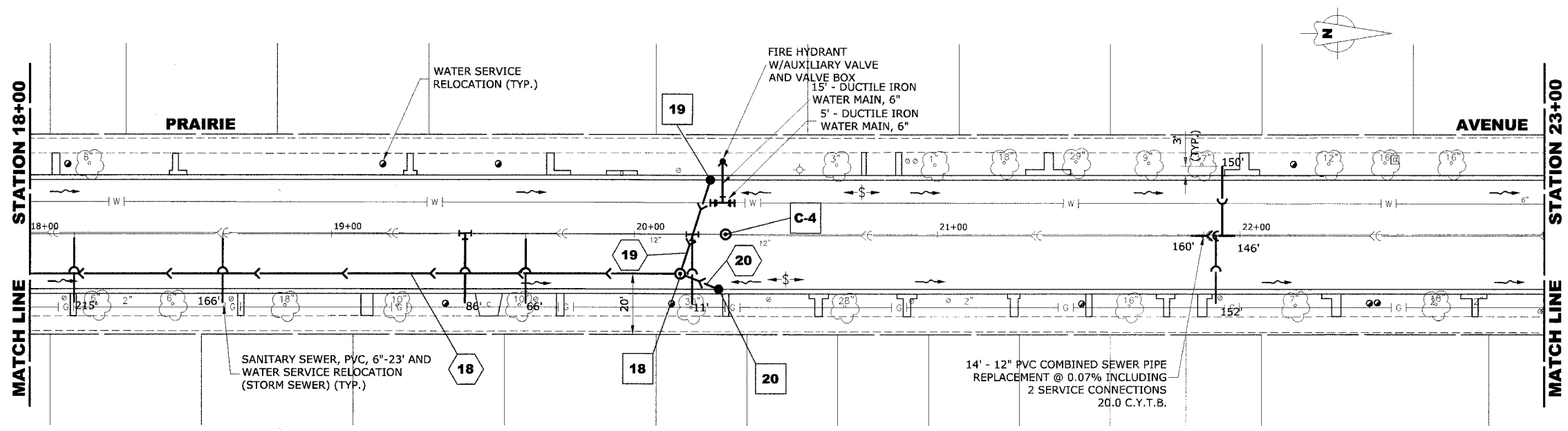

| PIPE NO. | LENGTH | DIA. | TYPE | SLOPE | C.Y.T.B. |
|----------|--------|------|------------------------|-------|----------|
| 18 | 310' | 15" | SS, TY-2, RCCP, CL-III | 0.32% | 157.4 |
| 19 | 32' | 10" | SS, PVC, SDR 26 | 1.00% | 1.3 |
| 20 | 14' | 10" | SS, PVC, SDR 26 | 1.00% | 0.5 |

PROPOSED IMPROVEMENTS

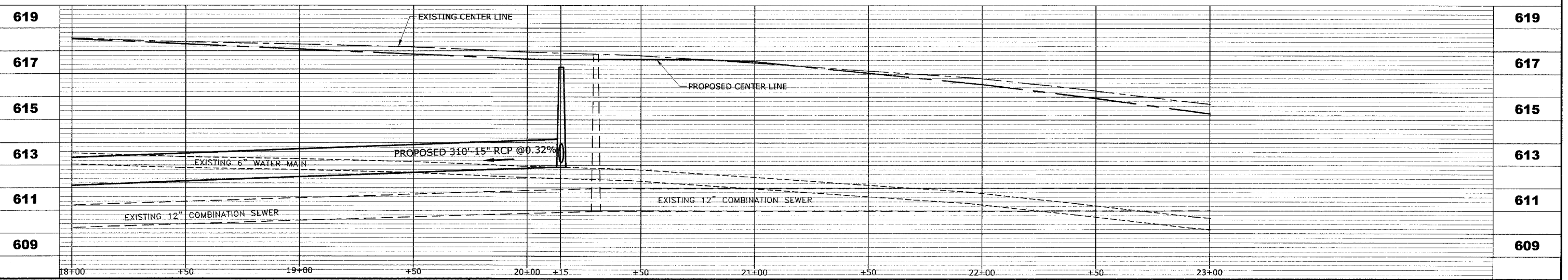

Drawing file: W:\Projects\12504283 - Prairie Ave 2nd Phase\Prarie\Profile.dwg Oct 05, 2005 - 3:14pm

HANCOCK ENGINEERING ♦ Civil Engineers ♦ Municipal Consultants ♦ Established 1911

9933 Roosevelt Road
Westchester, Illinois 60154-2790
Phone: 708/865-0300
Fax: 708/865-1212

**PRAIRIE AVENUE IMPROVEMENTS
PHASE II
VILLAGE OF BROOKFIELD, ILLINOIS**

**EXISTING AND PROPOSED
DRAINAGE AND UTILITIES
PLAN AND PROFILE**

| | |
|----------------------------|---------------------------------|
| SCALE: H: 1"=20', V: 1"=2' | SHEET 22 47 |
| DRAWN BY: MK/LEV | |
| BOOK NO.: #1475, #1504 | |
| DATE: 10-6-06 | |
| REVISION: | E.H.E. NO.: 125-04-26301 |