

ROUTE NO.	SECTION	COUNTY	TOTAL SHEETS	SHEET NO.
FAU 2732	**	COOK	47	35
ILLINOIS PROJECT M-8003(712)				
VILLAGE SECTION 00-00115-01-WR				
CONTRACT NO. 83881				

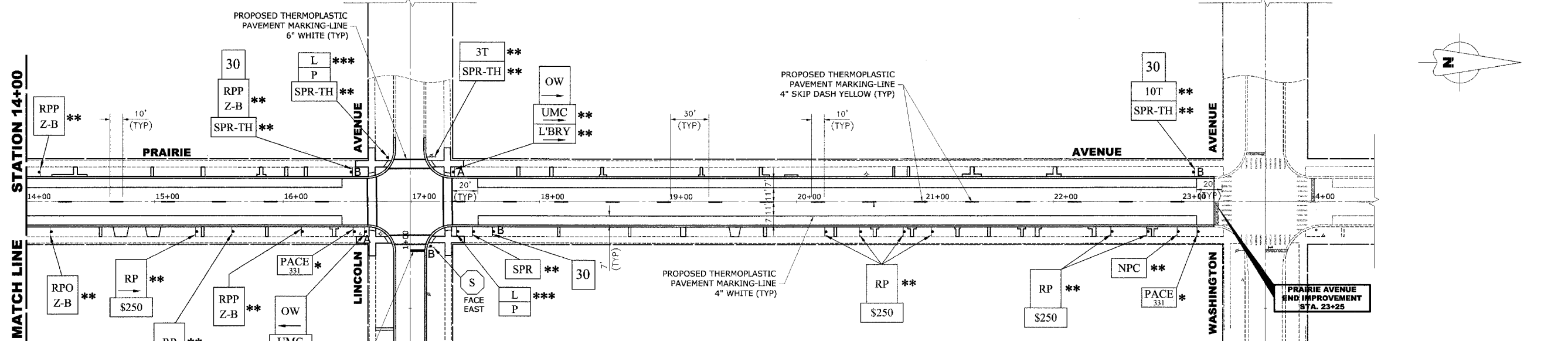

- \* CONTRACTOR TO CONTACT PACE TO COORDINATE PICK-UP OF THEIR SIGNS AND POSTS AT BEGINNING OF CONSTRUCTION. IF PACE DOES NOT PICK UP SIGNS, CONTRACTOR IS RESPONSIBLE FOR REMOVING AND STORING SIGNS AND POSTS WITHOUT DAMAGE TO THEM. (COST IS TO BE INCLUDED IN TRAFFIC CONTROL AND PROTECTION, SPECIAL)
- \*\* SPECIALTY SIGNS ARE TO BE REMOVED BY THE VILLAGE OF BROOKFIELD PRIOR TO CONSTRUCTION. VILLAGE OF BROOKFIELD WILL REINSTALL SIGNS AFTER COMPLETION OF PROJECT.
- \*\*\* STREET NAME SIGNS AND POSTS ARE TO BE REMOVED BY CONTRACTOR AT THE BEGINNING OF CONSTRUCTION, SAFELY STORED BY THE CONTRACTOR AND REINSTALLED BY THE CONTRACTOR AT THE COMPLETION OF THE PROJECT (COST IS TO BE INCLUDED IN TRAFFIC CONTROL AND PROTECTION, SPECIAL)

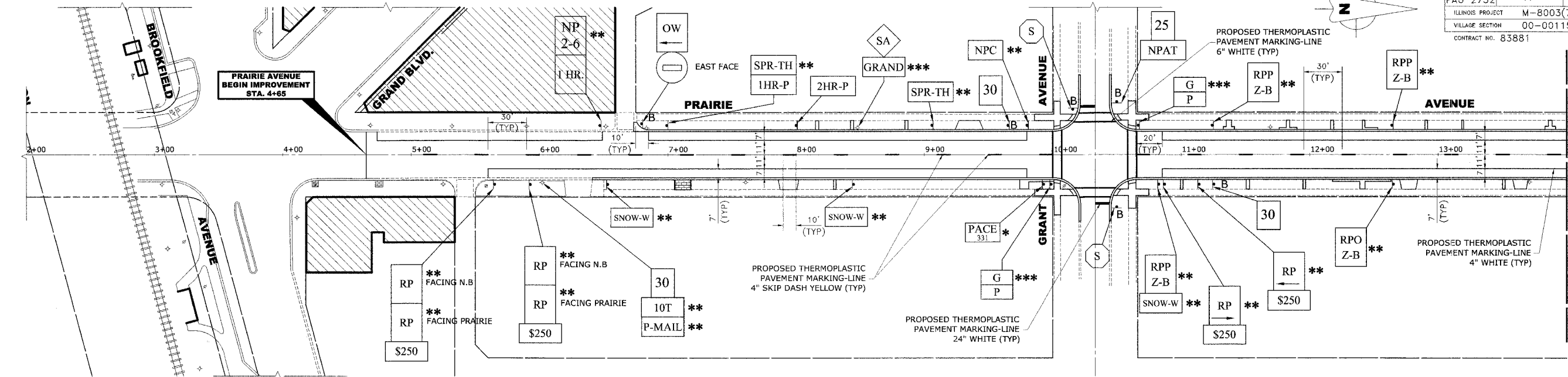
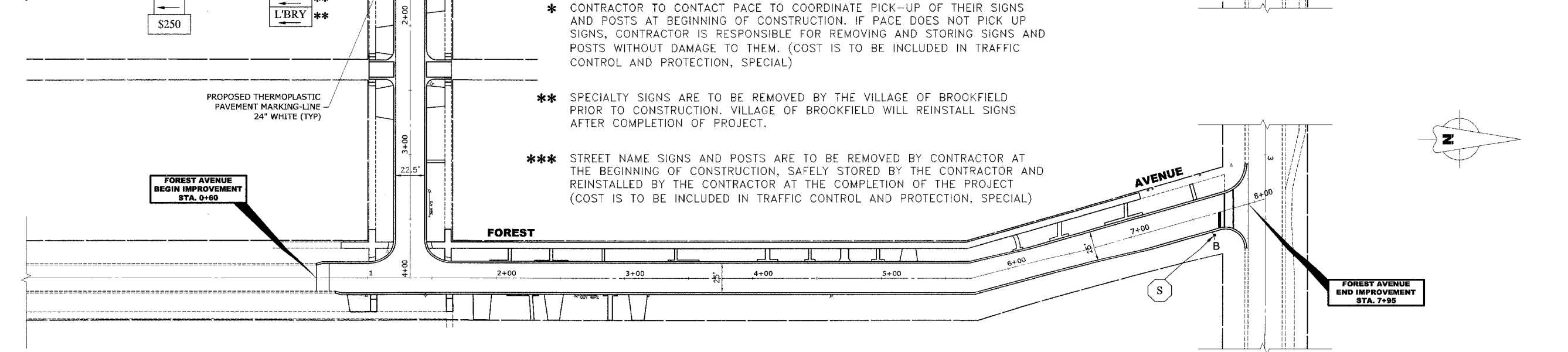

Drawing file: W:\Projects\12504253 - Prairie Ave 2nd Phase\Prarie\Prarie Pavement markings.dwg Oct 05, 2006 - 2:30pm

**HANCOCK ENGINEERING** ♦ Civil Engineers ♦ Municipal Consultants ♦ Established 1911

9933 Roosevelt Road  
Westchester, Illinois 60154-2780  
Phone: 708/865-0300  
Fax: 708/865-1212

**PRAIRIE AVENUE IMPROVEMENTS  
PHASE II  
PAVEMENT MARKING AND SIGNING PLAN  
VILLAGE OF BROOKFIELD, ILLINOIS**

**PAVEMENT MARKING AND SIGNING PLAN**

SCALE: 1"=40'	SHEET <b>35</b> <b>47</b>
DRAWN BY: MK/LEV	
BOOK NO.: #1475, #1504	
DATE: 10-6-06	
E.H.E. NO.: 125-04-26301	

REVISION: