

F.A.U. RTE.	SECTION	COUNTY	TOTAL SHEETS	SHEET NO.
1700	05-00045-02-PV	COOK/DUPAGE	103	29
STA. 7+86.95		TO STA. 17+50		
FED. ROAD DIST. NO. 7		ILLINOIS	FED. AID PROJECT	M-8003544

IMPROVEMENT BEGINS STA. 7+86.95

EXIST. EASEMENT  
EXIST. R.O.W.

NEXLINK MH TO BE ADJUSTED (BY OTHERS)

EXIST. R.O.W.

EXIST. EASEMENT

EXISTING FIBER OPTIC MARKER TO BE REMOVED (BY OTHERS)  
VERIZON HANDHOLE TO BE ADJUSTED (BY OTHERS)

PROP. R.O.W.

PROP. R.O.W.

PROP. R.O.W.

PROP. R.O.W.

DEVON AVENUE

VALVE BOXES (2) TO BE ADJUSTED

VALVE BOXES (3) TO BE ADJUSTED

UTILITY POLE AND SBC UTILITY BOXES TO BE RELOCATED (BY OTHERS)

GAS VALVE TO BE ADJUSTED (BY OTHERS)

CONSTRUCTION BASELINE

PROP. R.O.W.

ELECTRIC MANHOLES TO BE ADJUSTED (BY OTHERS)

EXIST. R.O.W.

EXIST. R.O.W.

EXIST. R.O.W.

EXIST. FIBER OPTIC MARKERS TO BE REMOVED (BY OTHERS)

EXIST. EASEMENT

EXIST. EASEMENT

EXIST. EASEMENT

GAS VALVE TO BE ADJUSTED (BY OTHERS)

EXIST. R.O.W.

EXIST. R.O.W.

EXIST. R.O.W.

- 1 STA. 9+22.7, 25.50' RT. FIRE HYDRANT TO BE REMOVED
- 2 STA. 10+69.6, 26.8' RT. FIRE HYDRANT TO BE REMOVED
- 3 STA. 15+50, 31.5' LT. DOMESTIC WATER SERVICE BOX TO BE ADJUSTED
- 4 STA. 16+49.5, 26.1' RT. FIRE HYDRANT TO BE REMOVED

- 5 STA. 16+65.8, 29.8' LT. DOMESTIC WATER SERVICE BOX TO BE ADJUSTED
- 1 STA. 9+44.9, 31.0' LT. SAN MH TO BE RECONSTRUCTED w/NEW FRAME & LID  
EX RIM = 694.86  
PR RIM = 694.15
- 2 STA. 10+67.3, 52.7' RT. SAN MH TO BE RECONSTRUCTED w/NEW FRAME & LID  
EX RIM = 693.89  
PR RIM = 693.58

- 7 STA. 9+54.0, 57.5' LT. CB, T-A, 4' DIA., T-1 FR. O.L.  
RIM = 694.16  
INV = 684.52 (12" N)
- 8 STA. 10+46.6, 57.6' LT. CB, T-C, T-1 FR. O.L.  
RIM = 693.90  
INV = 690.11 (12" S)
- 9 STA. 14+66.5, 26.0' LT. INLET, T-A, T-1 FR. O.L.  
RIM = 689.36  
INV = 685.88 (12" E)
- 10 STA. 14+66.5, 18.5' LT. CB, T-A, 4' DIA., T-1 FR. O.L.  
RIM = 689.04  
INV = 685.87 (12" W)  
INV = 685.17 (12" N)  
INV = 686.04 (4" NW&SW)
- 11 STA. 14+66.5, 18.5' RT. CB, T-A, 5' DIA., T-1 FR. O.L.  
RIM = 689.04  
INV = 684.53 (27" S)  
INV = 684.51 (27" N)  
INV = 686.04 (4" NE&SE)

- 5 STA. 14+92.40, 18.58' LT. INLET TO BE ADJUSTED w/NEW T-1 FR. O.L.  
EX RIM = 689.21  
PR RIM = 689.10
- 6 STA. 14+82.0, 18.5' RT. MH TO BE ADJUSTED w/NEW T-1 FR. O.L.  
EX RIM = 689.20  
PR RIM = 689.06

MATCH LINE STA. 17+50 (SEE SHEET NO. 30)

LIVELY BOULEVARD (EXISTING)

IMPROVEMENT BEGINS STA. 7+86.95

EXIST. EASEMENT  
PROP. F.O.W.

EXIST. R.O.W.

EXIST. EASEMENT

EXIST. EASEMENT

PROP. R.O.W.

PROP. R.O.W.

DEVON AVENUE

PROP. R.O.W.

PROP. R.O.W.

PROP. R.O.W.

PROP. R.O.W.

EXIST. R.O.W.

EXIST. R.O.W.

EXIST. R.O.W.

EXIST. R.O.W.

- 1 STA. 9+58.8, 57.7' LT. CONNECT TO EXIST. PIPE w/STORM SEWER TEE  
SEE DETAIL SHEET NO. 64  
INV = 684.46
- 2 3'-SS, CL. A, T-2, 12" @ 2.00%  
T.B.F. = 3.4 C.Y.
- 3 11'-SS, CL. A, T-1, 12" @ 0.50%  
T.B.F. = 1.5 C.Y.
- 4 3'-SS, CL. A, T-1, 12" @ 0.44%  
T.B.F. = 0.3 C.Y.
- 5 13'-SS, CL. A, T-1, 12" @ 0.50%  
T.B.F. = 1.7 C.Y.
- 6 STA. 14+81.9, 18.5' LT. CONNECT TO EXISTING PIPE w/STORM SEWER TEE  
SEE DETAIL SHEET NO. 64  
INV = 685.11

LEGEND  
PIPE UNDERDRAIN, 4", FABRIC LINED TRENCH (25' AT EACH LOCATION)

MATCH LINE STA. 17+50 (SEE SHEET NO. 30)

LIVELY BOULEVARD (PROPOSED)

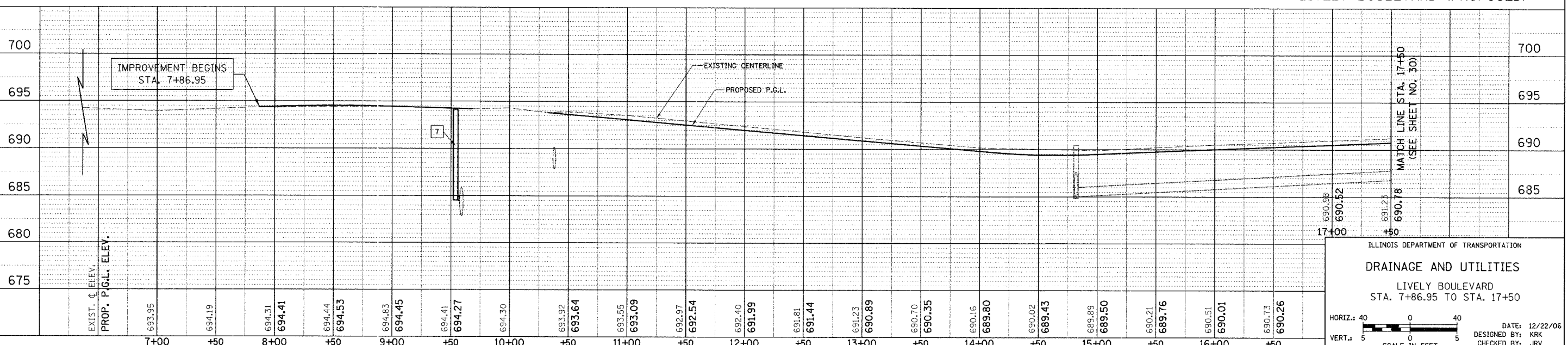

ILLINOIS DEPARTMENT OF TRANSPORTATION  
DRAINAGE AND UTILITIES  
LIVELY BOULEVARD  
STA. 7+86.95 TO STA. 17+50

HORIZ.: 40  
VERT.: 5  
SCALE IN FEET

DATE: 12/22/06  
DESIGNED BY: KRK  
CHECKED BY: JRV