

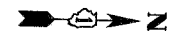

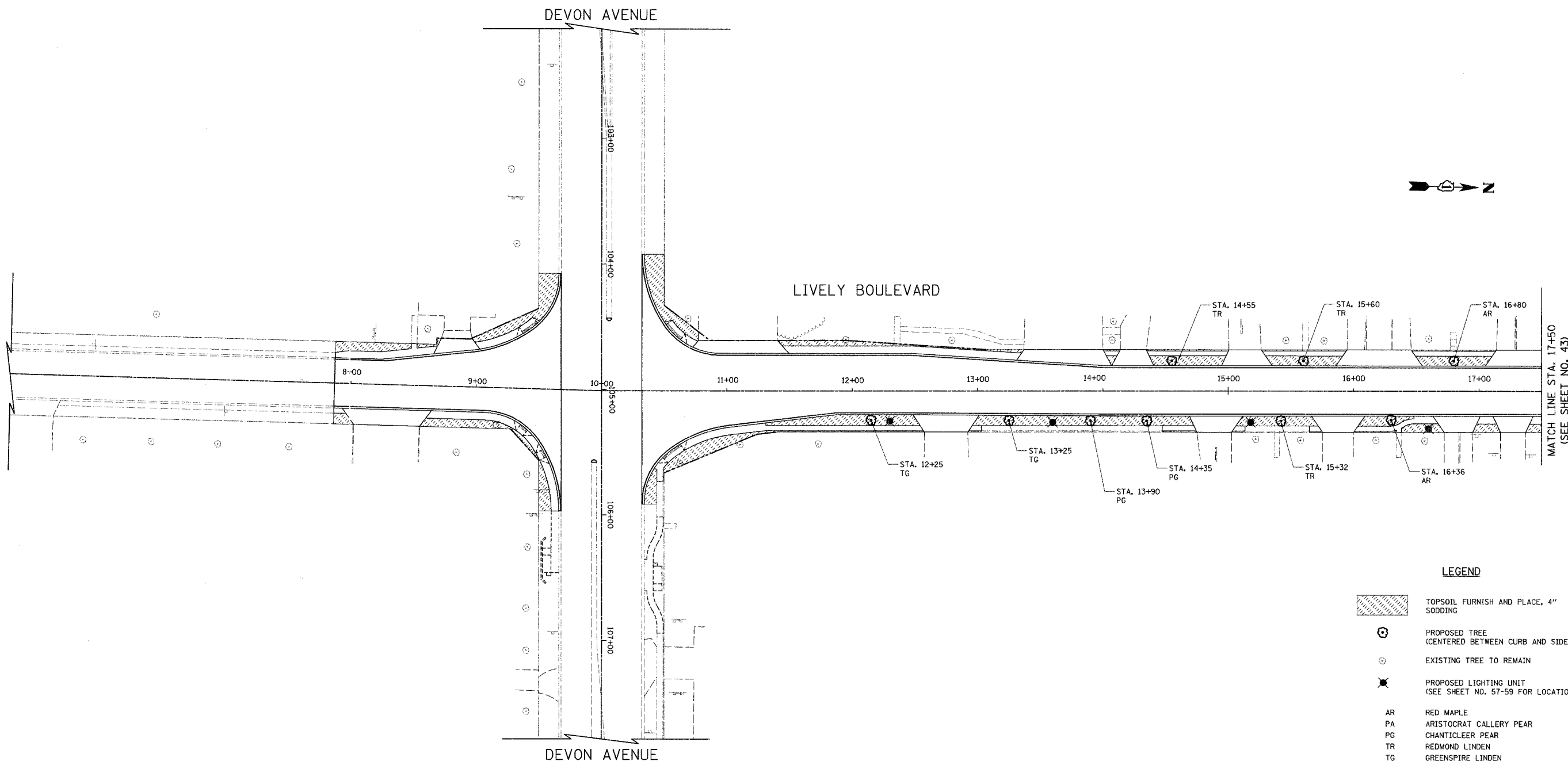

F.A.U. RTE.	SECTION	COUNTY	TOTAL SHEETS	SHEET NO.
1700	05-00045-02-PV	COOK/DUPAGE	103	42
LANDSCAPING PLAN				
FED. ROAD DIST. NO. 7		ILLINOIS	FED. AID PROJECT M-8003(544)	



**LEGEND**

-  TOPSOIL FURNISH AND PLACE, 4" SODDING
-  PROPOSED TREE (CENTERED BETWEEN CURB AND SIDEWALK)
-  EXISTING TREE TO REMAIN
-  PROPOSED LIGHTING UNIT (SEE SHEET NO. 57-59 FOR LOCATIONS)
- AR RED MAPLE
- PA ARISTOCRAT CALLERY PEAR
- PG CHANTICLEER PEAR
- TR REDMOND LINDEN
- TG GREENSPIRE LINDEN

ILLINOIS DEPARTMENT OF TRANSPORTATION

**LANDSCAPING PLAN**

LIVELY BOULEVARD  
STA. 7+87 TO STA. 17+50

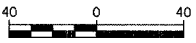

SCALE IN FEET

DATE: 10/18/06  
DESIGNED BY: KRK  
CHECKED BY: JRV