

F.A.U. RTE.	SECTION	COUNTY	TOTAL SHEETS	SHEET NO.
1700	05-00045-02-PV	COOK/DUPAGE	103	43
LANDSCAPING PLAN				
FED. ROAD DIST. NO. 7 ILLINOIS FED. AID PROJECT M-80031544				

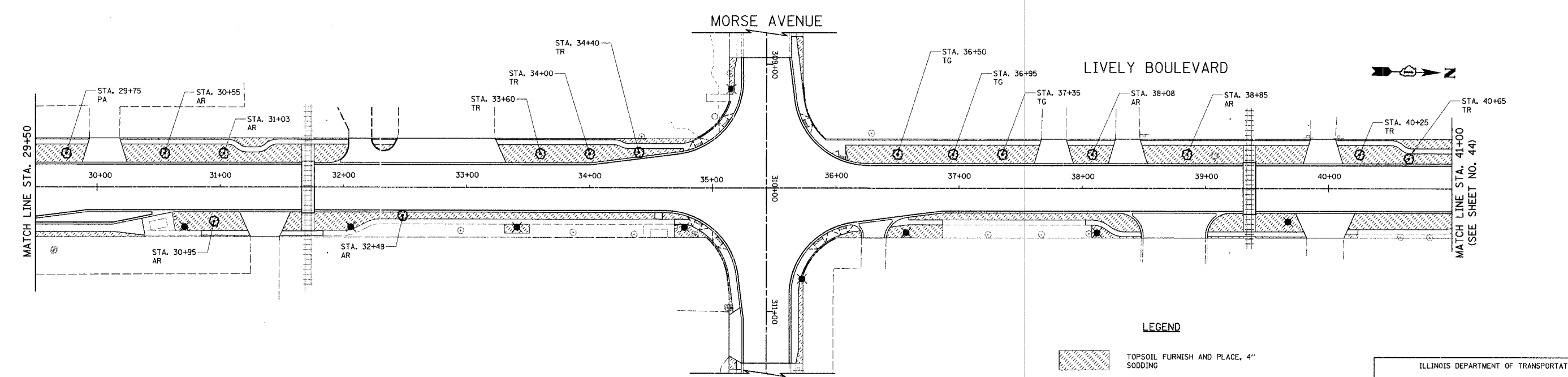
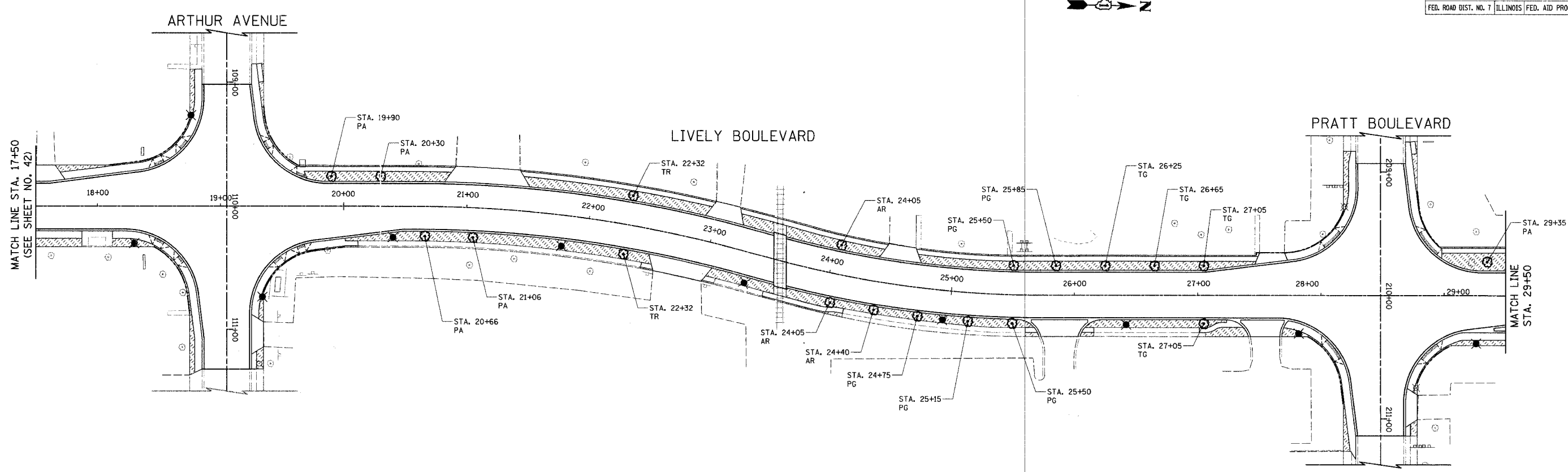
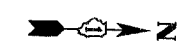

- AR RED MAPLE
- PA ARISTOCRAT CALLERY PEAR
- PG CHANTICLEER PEAR
- TR REDMOND LINDEN
- TG GREENSPIRE LINDEN

- LEGEND**
- TOPSOIL FURNISH AND PLACE, 4" SODDING
 - PROPOSED TREE (CENTERED BETWEEN CURB AND SIDEWALK)
 - EXISTING TREE TO REMAIN
 - PROPOSED LIGHTING UNIT (SEE SHEET NO. 57-59 FOR LOCATIONS)

ILLINOIS DEPARTMENT OF TRANSPORTATION

LANDSCAPING PLAN

LIVELY BOULEVARD
STA. 17+50 TO STA. 41+00

SCALE IN FEET

DATE: 12/22/06
DESIGNED BY: KRK
CHECKED BY: JRV