

P.A.U. NO.	SECTION	COUNTY	TOTAL SHEETS	SHEET NO.
1700	05-00045-02-PV	COOK/DUPAGE	103	69
STA.		TO STA.		
FED. ROAD DIST. NO.		SLAB NO.	FED. AID PROJECT NO. 8003(544)	

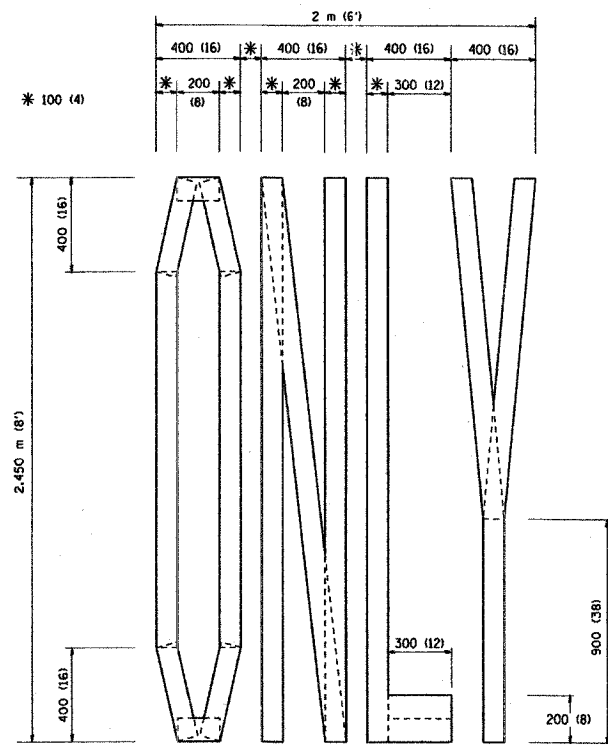

QUANTITY
 100 (4) LINE = 19.7 m (64.1 ft.)
 1.97 sq. m (21.1 sq. ft.)

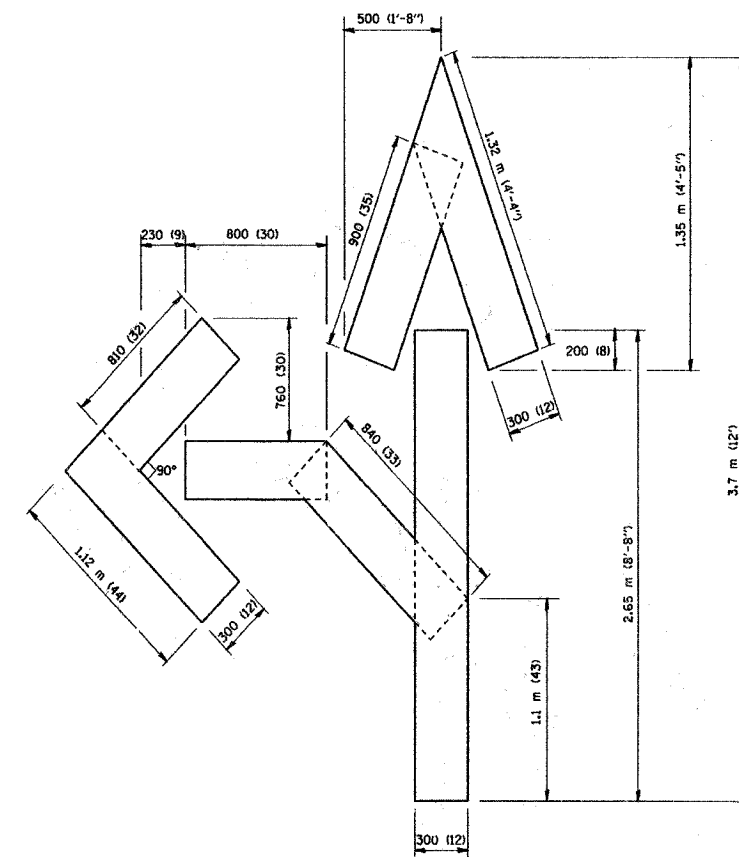

QUANTITY
 100 (4) LINE = 25.3 m (82.5 ft.)
 2.53 sq. m (27.5 sq. ft.)

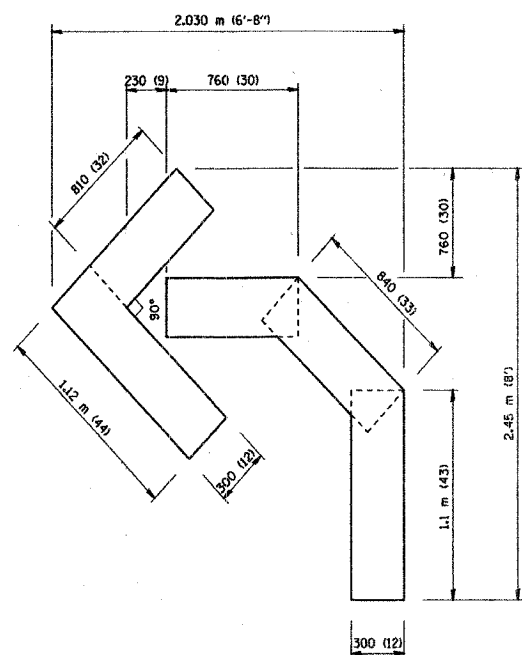

QUANTITY
 100 (4) LINE = 13.9 m (45.5 ft.)
 1.39 sq. m (15.2 sq. ft.)

All dimensions are in millimeters (Inches) unless otherwise shown.

ILLINOIS DEPARTMENT OF TRANSPORTATION

TEMPORARY PAVEMENT MARKING LETTERS AND SYMBOLS

REVISIONS	
NAME	DATE
T. RAMMACHER	09/18/94
J. OBERLE	06/01/96
T. RAMMACHER	06/05/96
T. RAMMACHER	11/04/97
T. RAMMACHER	03/02/98

SCALE: NONE
 DATE 03/13/00

DRAWN BY CADD
 CHECKED BY

Mon_Mar_13_13:54:41_2000...v:\cf\files\CAD\ref...w:\prk\metric\tc16m.dct