

| | | | | |
|---------------------|----------------|----------|-----------------|-----------|
| FAU ROUTE NO. | SECTION | COUNTY | TOTAL SHEETS | SHEET NO. |
| 1342 | 06-00029-00-RS | KANE | 14 | 4 |
| STA. | TO STA. | ILLINOIS | FED AID PROJECT | |
| C-91-089-07 | | | M-8003 (729) | |
| CONTRACT NO.: 83892 | | | | |

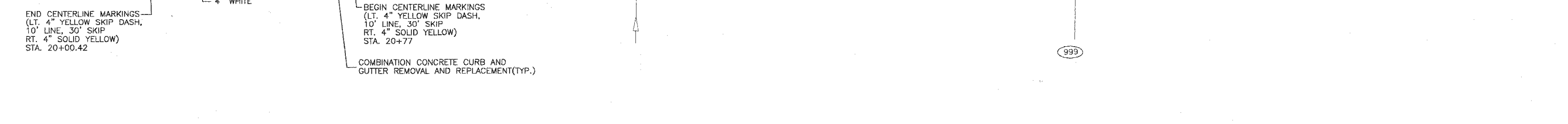
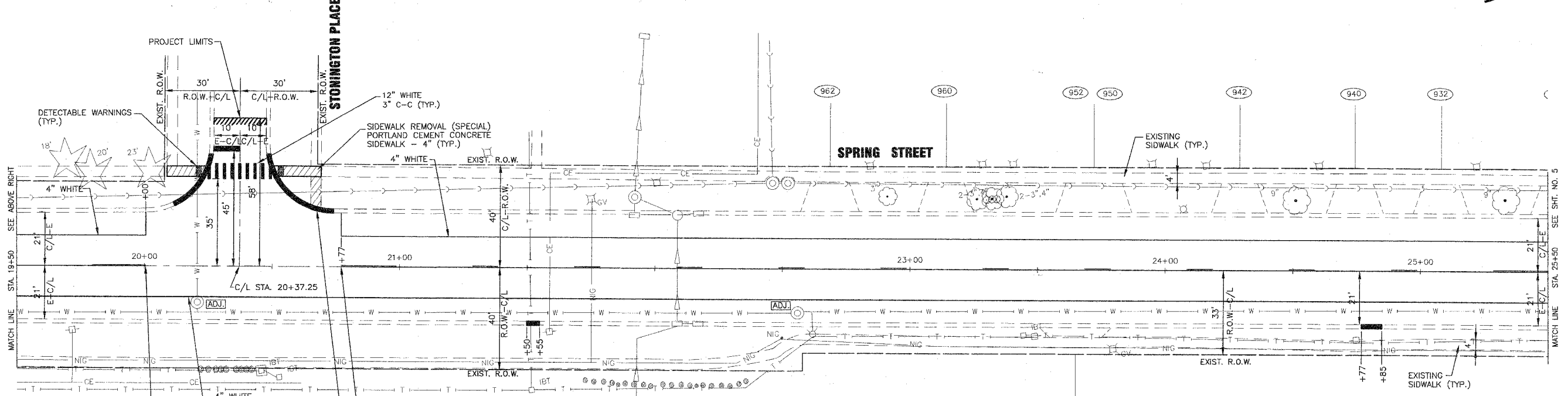
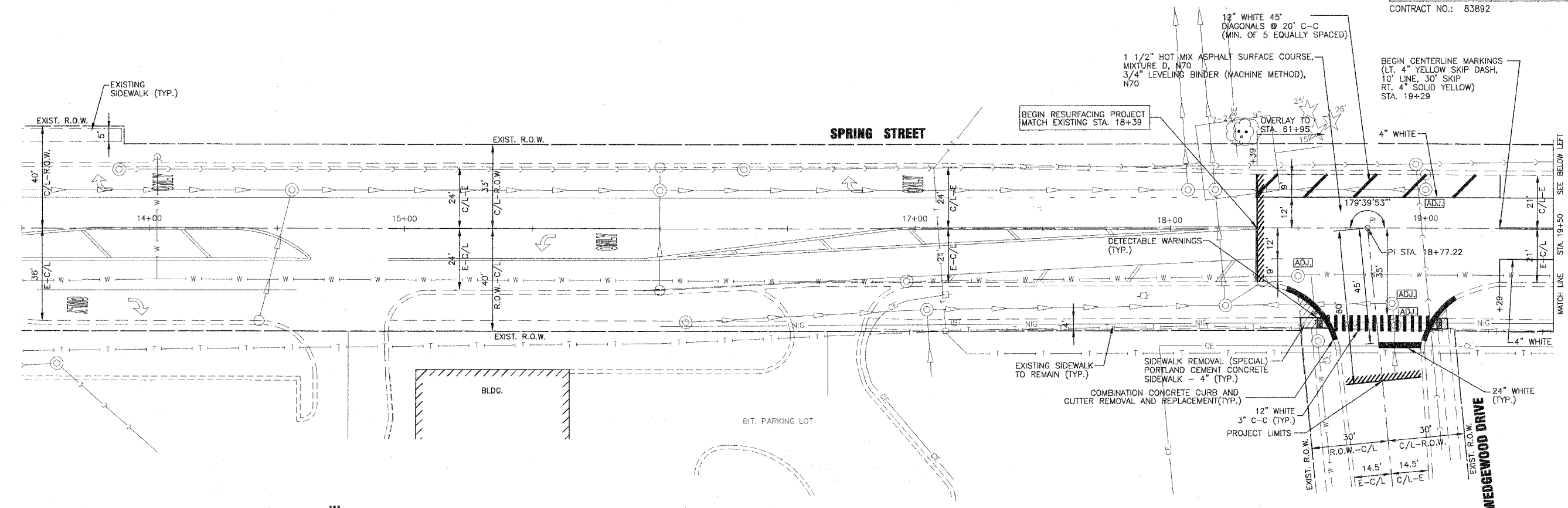

I:\SELGVA\05124\LAPP-DWGS\From Graystone\051124\PLAN.dwg - SH4
 Plotted: 11/19/06 @ 2:19pm by 362bnp
 Date: 11/19/06
 State: Illinois
 License No.: 184-001121 - Expires 4-30-07

| CONSULTANTS | REV. NO. | DATE | DESCRIPTION |
|--|----------|----------|---------------------|
| BAXTER & WOODMAN Consulting Engineers | 1 | 11-01-06 | PER I.D.O.T. REVIEW |
| | 2 | 11-22-06 | PER I.D.O.T. REVIEW |

* - REFER TO EQUIPMENT MANUFACTURER'S SHOP DRAWINGS

BAXTER & WOODMAN
Consulting Engineers

Baxter & Woodman
Crystal Lake, Illinois 815.459.1280
Burlington, Wisconsin 262.763.7634
Mokena, Illinois 708.478.2090
DeKalb, Illinois 815.797.3111
Graystone, Illinois 815.623.3080
Rockford, Illinois 815.498.1551
Plainfield, Illinois 815.695.7425

VILLAGE OF SOUTH ELGIN, ILLINOIS
FAU 1342 SPRING STREET
STP (LAPP) IMPROVEMENTS

SPRING STREET
STA. 13+50 TO STA. 25+50

| | | | |
|-------------|---------|-------------|---------------|
| DESIGNED BY | JRR | SCALE | HORIZ: 1"=20' |
| DRAWN BY | UKB | PROJECT NO. | 051124 |
| CHECKED BY | MWP | SHEET NO. | 4 OF 14 |
| DATE | 8/18/06 | | |