

| | | | | |
|---------------------|----------------|-----------------|--------------|-----------|
| F.A.U. ROUTE NO. | SECTION | COUNTY | TOTAL SHEETS | SHEET NO. |
| 1342 | 06-00029-00-RS | KANE | 14 | 12 |
| STA. | TO STA. | | | |
| FED. ROAD DIST. NO. | ILLINOIS | FED AID PROJECT | | |
| C-91-089-07 | | M-8003 (729) | | |

CONTRACT NO.: 83892

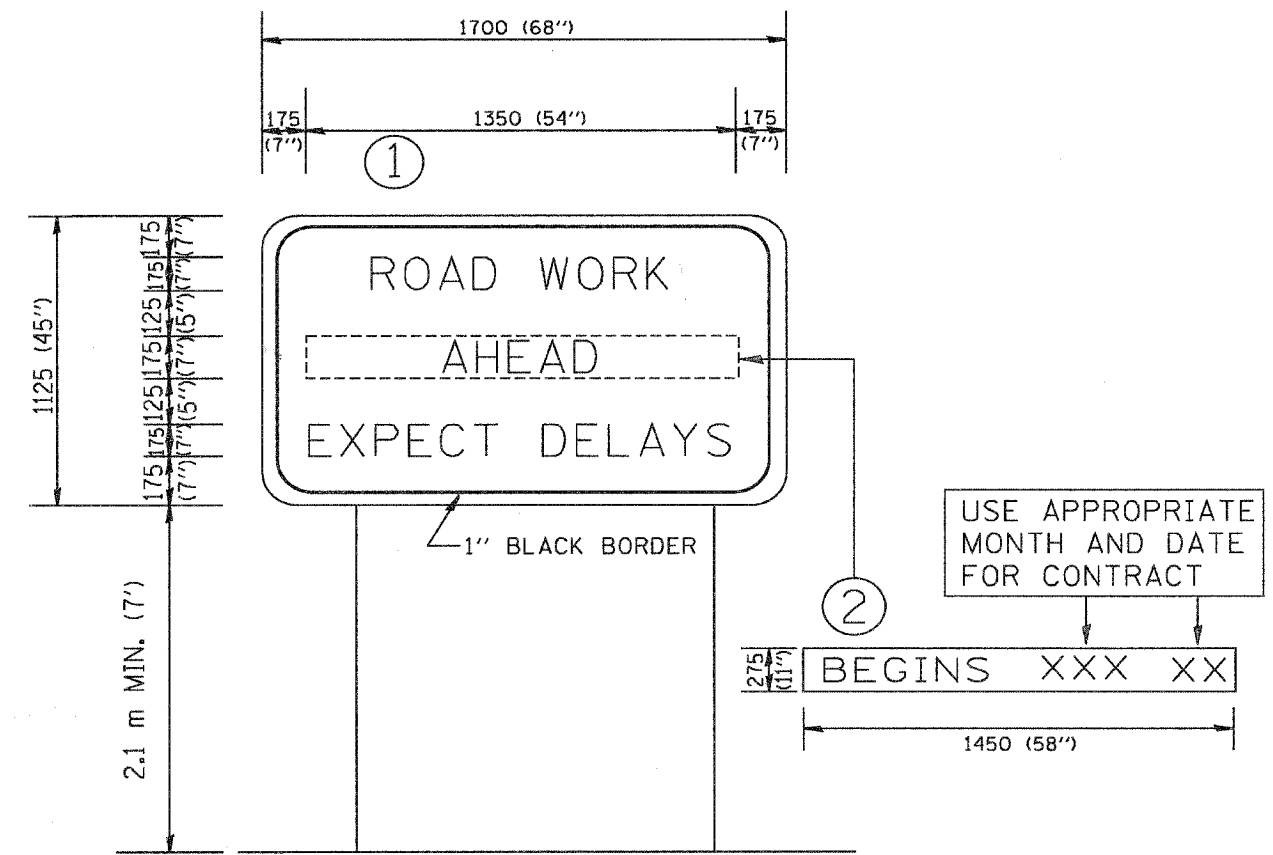

NOTES:

1. USE BLACK LETTERING ON ORANGE BACKGROUND.
2. ERECT SIGNS IN ADVANCE OF THE LOCATION FOR THE "ROAD CONSTRUCTION AHEAD" SIGN AT LOCATIONS AS DIRECTED BY THE ENGINEER.
3. ERECT SIGN ① WITH INSTALLED PANEL ② ONE WEEK PRIOR TO THE START OF CONSTRUCTION.
4. REMOVE PANEL ② SOON AFTER THE START OF CONSTRUCTION.
5. SEE SPECIAL PROVISION FOR "TEMPORARY INFORMATION SIGNING" FOR ADDITIONAL INFORMATION.
6. ONE SIGN ASSEMBLY EQUALS 2.3 SQ. M. (25.70 SQ. FT.)

ALL DIMENSIONS ARE IN MILLIMETERS (INCHES) UNLESS OTHERWISE SHOWN.

| REVISIONS | |
|--------------|----------|
| NAME | DATE |
| R. MIRS | 9-15-97 |
| R. MIRS | 12-11-97 |
| T. RAMMACHER | 2-2-99 |
| | |
| | |
| | |
| | |
| | |
| | |

ILLINOIS DEPARTMENT OF TRANSPORTATION
TEMPORARY INFORMATION SIGNING

SCALE: DATE: 2/15/2006
DRAWN BY DESIGN
CHECKED BY
TC22

I:\SEL\051124\1App-DWG\051124-SH12.dwg - SH12
Plotter: 11-32-06 @ 10:28am By: 362dmp
Copyright © 2006, By Baxter & Woodman, Inc.
State of Illinois - Professional Design Firm
License No. - 184-001121 - Expires 4-30-07