

|                       |         |           |           |             |
|-----------------------|---------|-----------|-----------|-------------|
| ROUTE NO.             | SECTION | COUNTY    | SHEET NO. | SHEET TOTAL |
| FAP 0525              |         | WINNEBAGO | 157       | 28          |
| FED. ROAD DIST. NO. 7 |         | ILLINOIS  | PROJECT   |             |
| 02-00518-00-BR        |         |           |           |             |

SHEET NO. 2  
5 SHEETS

85399

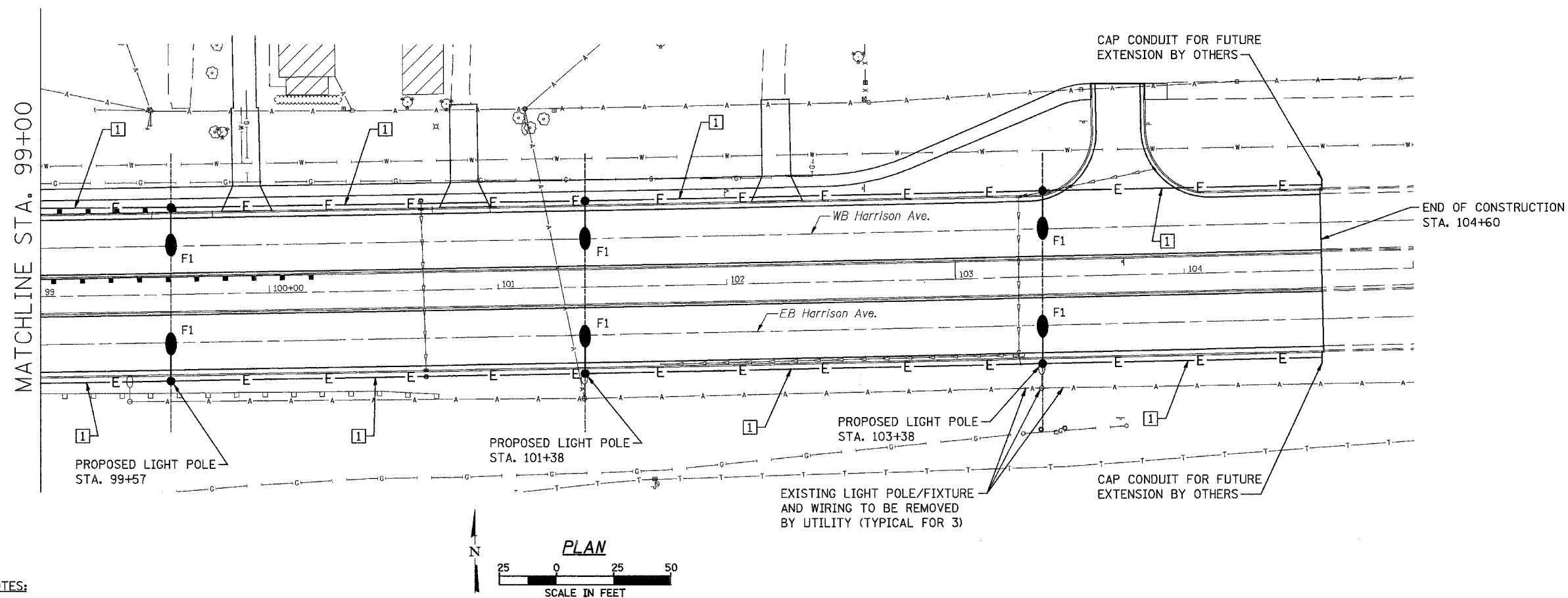

**KEYED NOTES:**

- 1 2" C. (SCHED. 40 PVC) WITH PULL STRING (200 LB) - WIRE PROVIDED UNDER FUTURE SEPARATE WORK BY OTHERS.

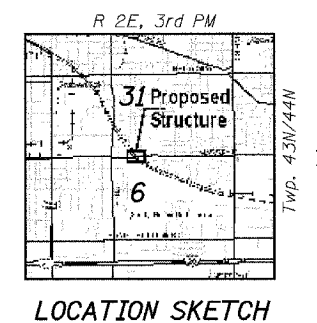

THE LOCATION, SIZE AND TYPE OF MATERIAL OF EXISTING UNDERGROUND UTILITIES INDICATED ON THE PLANS IS NOT REPRESENTED AS BEING ACCURATE, SUFFICIENT OR COMPLETE. IT SHALL BE THE CONTRACTOR'S RESPONSIBILITY TO DETERMINE THE ACTUAL LOCATION OF ALL SUCH FACILITIES, INCLUDING THE SERVICE CONNECTIONS TO UNDERGROUND UTILITIES. PRIOR TO CONSTRUCTION THE CONTRACTOR SHALL NOTIFY THE UTILITY COMPANIES OF HIS OPERATIONAL PLANS AND SHALL OBTAIN FROM THE RESPECTIVE UTILITY COMPANIES DETAILED INFORMATION AND ASSISTANCE RELATIVE TO THE LOCATION OF THEIR FACILITIES AND THE WORKING SCHEDULE OF THE COMPANIES FOR REMOVAL OR ADJUSTMENT WHERE REQUIRED. IN THE EVENT AN UNEXPECTED UTILITY INTERFERENCE IS ENCOUNTERED DURING CONSTRUCTION, THE CONTRACTOR SHALL IMMEDIATELY NOTIFY THE UTILITY COMPANY OF JURISDICTION. THE ENGINEER SHALL ALSO BE IMMEDIATELY NOTIFIED. ANY SUCH MAINS AND SERVICES SHALL BE RESTORED TO SERVICE AT ONCE AND PAID FOR BY THE CONTRACTOR AT NO ADDITIONAL COST TO THE CONTRACT.

CONTACT JOINT UTILITY LOCATING INFORMATION FOR EXCAVATING (JULIE) 1-800-892-0123 FOR UTILITY INFORMATION.

revised  
2/15/07

Corporate License Number 184-001-084  
**ROADWAY LIGHTING PLAN**  
HARRISON AVENUE BRIDGE  
OVER UP & CC&P RAILROAD  
F.A.P. ROUTE 0525  
SECTION 02-00518-00-BR  
ROCKFORD, ILLINOIS  
WESTBOUND STRUCTURE NO. 101-6109  
EASTBOUND STRUCTURE NO. 101-6111

|    |  |                    |
|----|--|--------------------|
| L2 |  | JOB NO.<br>03R1751 |
|    |  | DATE<br>07/18/06   |

2:35:17 PM 07/18/06  
 02:35:17 PM 07/18/06  
 AND: 02:35:17 PM 07/18/06  
 2:35:17 PM 07/18/06  
 02:35:17 PM 07/18/06  
 02:35:17 PM 07/18/06