

ROUTE NO.	SECTION	COUNTY	SHEET	SHEET	SHEET NO.
FAP 0525	*	WINNEBAGO	157	154	47
FED. ROAD DIST. NO. 7					ILLINOIS
FED. AID PROJECT					50 SHEETS
* 02-00518-00-BR					

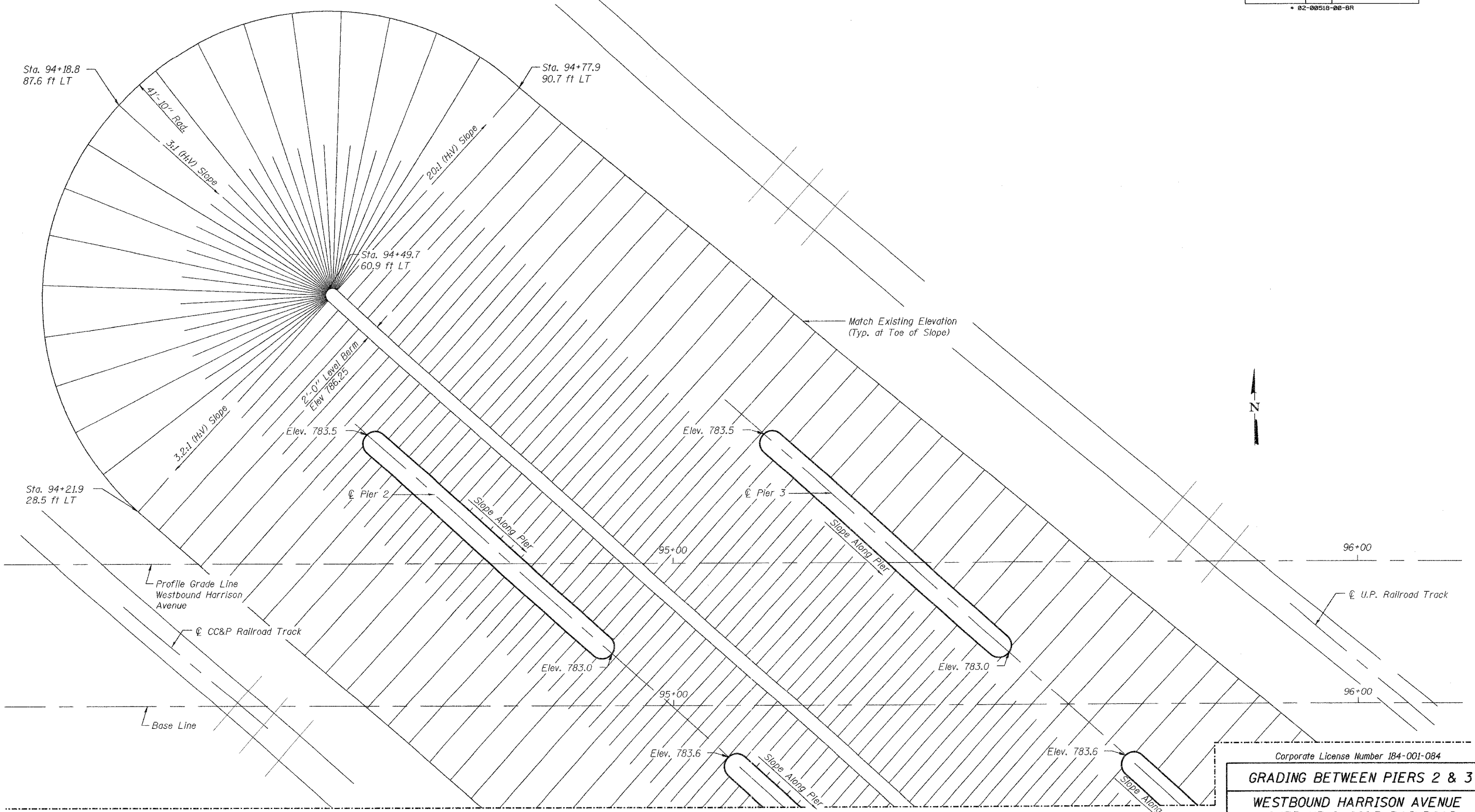

MATCH LINE (SEE EASTBOUND BRIDGE PLANS)

NOTES
 Stationing and offset are defined with respect to the Base Line.

PLAN

Corporate License Number 184-001-084

GRADING BETWEEN PIERS 2 & 3

WESTBOUND HARRISON AVENUE
 OVER UP & CC&P RAILROAD
 F.A.P. ROUTE 0525
 SECTION 02-00518-00-BR
 ROCKFORD, ILLINOIS
 STATION 95+25.35
 STRUCTURE NO. 101-6109

© Copyright Hanson Professional Services Inc. 2006

HANSON

JOB NO. 03R1751
 DATE 12/14/06

11/5/07 AM 12/12/2006 11:59 AM
 I:\03\Proj\03R1751\Struct\Sheet\West Bound S-Off WP-Grading.dwg
 LAYOUT: JMR 07/06/06
 DRAWN: JMR 07/17/06
 REVIEWED: FLN 08/02/06