

**STATE OF ILLINOIS**  
**DEPARTMENT OF TRANSPORTATION**  
**DIVISION OF HIGHWAYS**  
**PLANS FOR PROPOSED**  
**HIGHWAY BRIDGE PROGRAM**

**DOUGLAS ROAD DISTRICT**  
**SECTION 01-11127-00-BR**  
**IROQUOIS COUNTY**  
**PROJECT NO. BROS-075(126)**  
**T.R. ROUTE 189**  
**C-93-094-04**

ROUTE NO.	SECTION	COUNTY	TOTAL SHEETS	SHEET NO.
T.R. 189	01-11127-00-BR	IROQUOIS	20	1
ROAD DIST.		ILLINOIS	DOUGLAS	

CONTRACT NO. 87287

SHEET NO.	INDEX OF SHEETS	TITLE
1.	COVER SHEET	
2.	SUMMARY OF QUANTITIES, GENERAL NOTES & TYPICAL SECTIONS	
3.	PLAN AND PROFILE SHEET	
4.-9.	BRIDGE PLANS	
10.-13.	BORINGS	
14.-19.	STATION CROSS SECTIONS	
20.	EROSION CONTROL PLAN	

**STANDARDS:**  
280001-03  
515001-02  
631026-03  
635006-02  
702001-06  
BLR 21-6

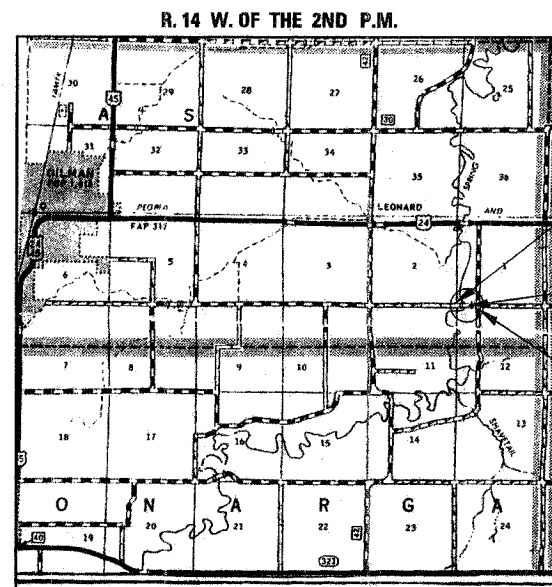
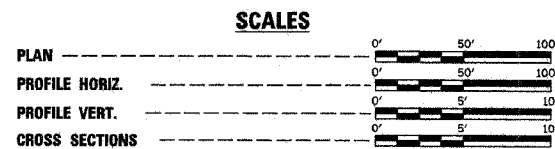

IMPROVEMENT BEGINS  
STA. 11+00

STA. 15+07 - SPECIAL BRIDGE DESIGN  
**PRECAST PRESTRESSED CONCRETE  
DECK BEAM BRIDGE - 2 SPANS AT  
86'-0", 86'-0", 30' ROADWAY, SKEW=0°**  
EXISTING S.N. 038-4038  
PROPOSED S.N. 038-4056

IMPROVEMENT ENDS  
STA. 19+10

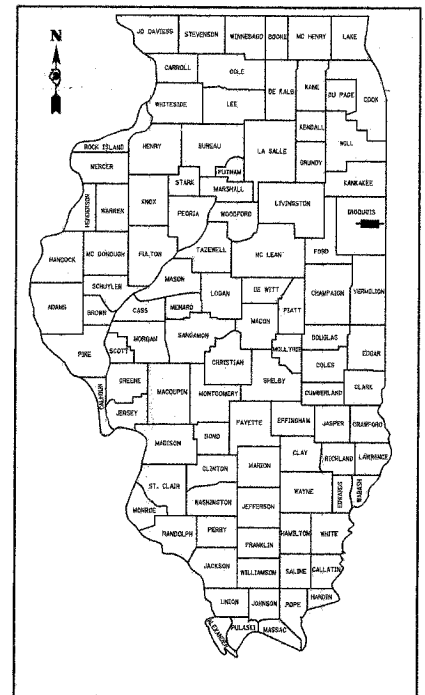
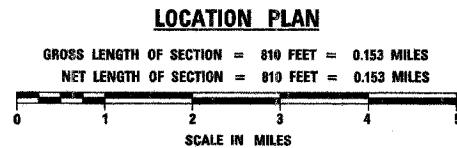

LOCATION OF SECTION INDICATED THUS:

**CLASSIFICATION: LOCAL ROAD 0-250**  
**CURRENT ADT: <150 ADT**  
**3R DESIGN GUIDELINES**  
**DESIGN SPEED: 30 MPH**

TOLL FREE JOINT UTILITY LOCATING  
INFORMATION FOR EXCAVATORS (J.U.L.I.E.)  
TELEPHONE NUMBER 1-800-892-0123

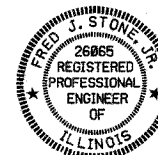

*Fred S. Stone* (12-13-06)  
ILLINOIS PROFESSIONAL NO. 26065  
EXPIRES 11-30-07

PASSED	December 18, 2006	2006
<i>Roger Rotondo</i> ROAD DISTRICT COMMISSIONER		
APPROVED	December 18, 2006	2006
<i>John M. ...</i> COUNTY ENGINEER		
PASSED	December 21, 2006	2006
<i>Ken ...</i> DISTRICT THREE ENGINEER OF LOCAL ROADS & STREETS		
RELEASED FOR BID BASED ON LIMITED REVIEW	December 21, 2006	2006
<i>Diana ...</i> DEPUTY DIRECTOR OF HIGHWAYS, REGION TWO ENGINEER		

STATE OF ILLINOIS  
DEPARTMENT OF TRANSPORTATION

CONTRACT NO. 87287

4440 ASH GROVE  
SPRINGFIELD, IL 62711  
(217) 793-8800  
www.fehr-graham.com

**FEHR-GRAHAM & ASSOCIATES, LLC**  
ENGINEERING AND SCIENCE CONSULTANTS  
PROFESSORS, ENGINEERS, ARCHITECTS, PLANNERS, AND ENVIRONMENTALISTS