

42300200 PCC DRIVEWAY PAVT 6	
STA. 20+91 LT	14.8 SQ YD
STA. 21+42 LT	14.5 SQ YD
STA. 21+93 RT	15.0 SQ YD
STA. 22+10 LT	14.5 SQ YD
STA. 22+54 RT	21.2 SQ YD
STA. 22+87 LT	14.5 SQ YD

42400100 PC CONCRETE SIDEWALK 4	
STA. 20+55 LT	19.8 SQ FT
STA. 20+70 RT	20.0 SQ FT
STA. 21+20 LT	17.6 SQ FT
STA. 21+22 RT	20.3 SQ FT
STA. 21+31 RT	128.5 SQ FT
STA. 21+70 RT	19.4 SQ FT
STA. 21+71 LT	50.5 SQ FT
STA. 21+72 RT	75.0 SQ FT
STA. 21+80 LT	19.5 SQ FT
STA. 22+25 RT	20.0 SQ FT
STA. 22+36 RT	237.5 SQ FT
STA. 23+25 LT	21.5 SQ FT

60235700 INLETS TA T3F&G	
STA. 22+38 R/L	20 EACH
60218400 MAN TA 4 DIA TIF CL	
STA. 22+38 LT	10 EACH

60604400 COMB. CC&G TB6.18	
STA. 20+07 - 35+87 LT	1,583.2 FT
STA. 20+16 - 35+90 RT	1,578.0 FT

20800150 TRENCH BACKFILL	
STA. 22+38 LT	1.5 CU YD
STA. 22+38 RT	4.6 CU YD

550B0050 STORM SEW CL B 1 12	
STA. 22+38 LT	8.1 FT
STA. 22+38 RT	23.3 FT

K1005863 TREE ROOT PRUNING	
STA. 21+54 RT	1.0 EACH

SECTION #	TOTAL SHEETS	SHEET NO.
06-00447-12-PV	50	14

	BRICK WEARING SURFACE		PCC SIDE-WALK, 8"		PCC DRIVEWAY PAVT, 6"		LEV BIND & HMA SC		SANITARY
	COMB. CC&G TB6.18		BRICK SIDEWALK		CONCRETE HEADER		PROP STORM SEWER		EX. STORM SEWER
	PCC SIDE-WALK, 4"		BRICK DRIVEWAY PAVT.		UNDERGROUND TELEPHONE		GAS		

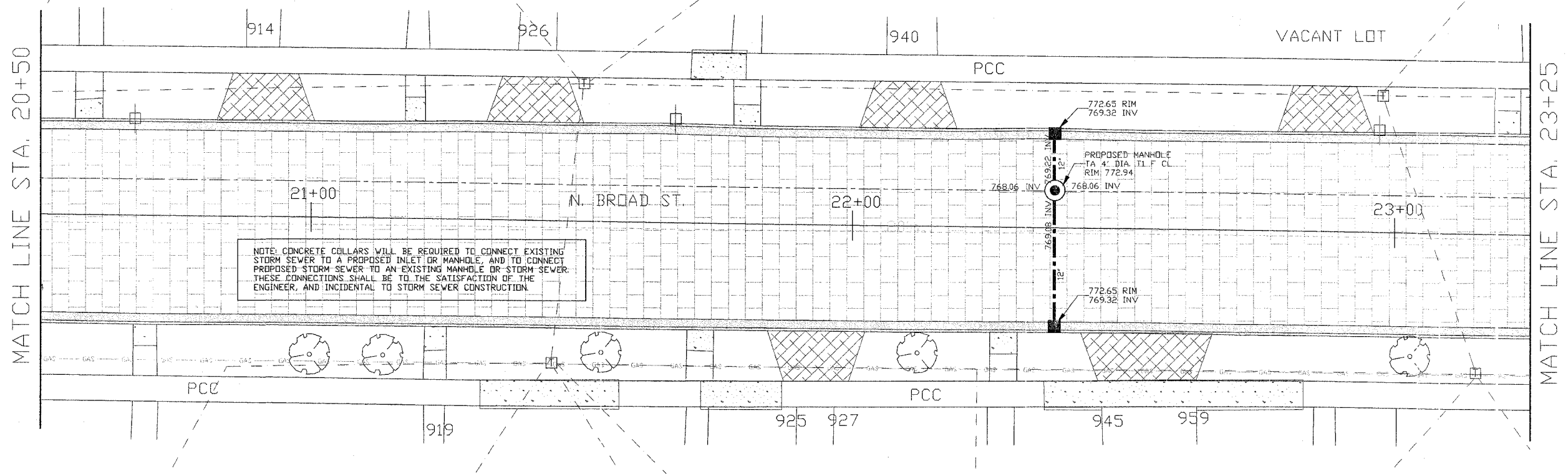
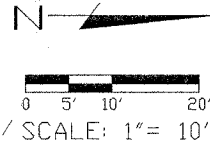

NOTE: CONCRETE COLLARS WILL BE REQUIRED TO CONNECT EXISTING STORM SEWER TO A PROPOSED INLET OR MANHOLE, AND TO CONNECT PROPOSED STORM SEWER TO AN EXISTING MANHOLE OR STORM SEWER. THESE CONNECTIONS SHALL BE TO THE SATISFACTION OF THE ENGINEER, AND INCIDENTAL TO STORM SEWER CONSTRUCTION.

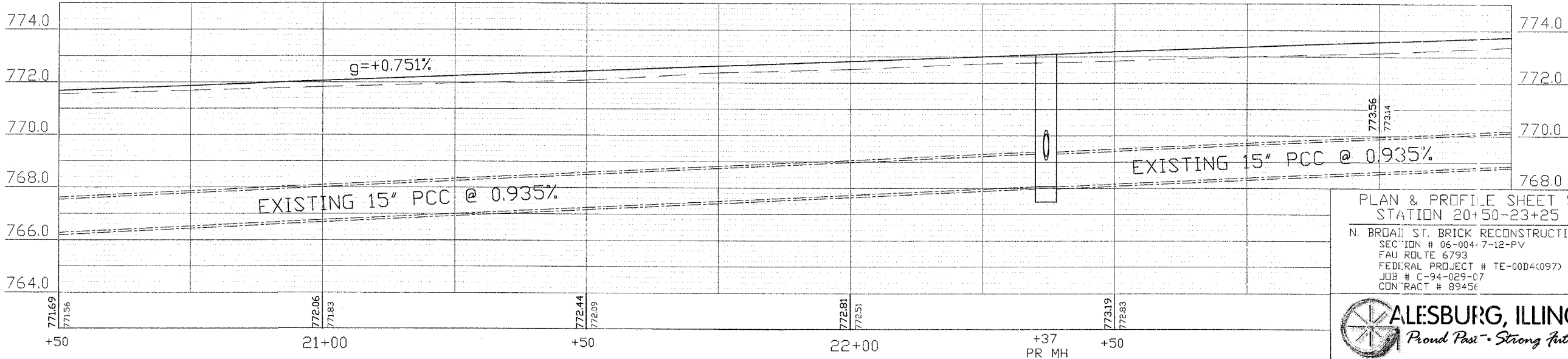

PLAN & PROFILE SHEET 5
STATION 20+50-23+25
N. BROAD ST. BRICK RECONSTRUCTION
SECTION # 06-004-7-12-PV
FAU ROUTE 6793
FEDERAL PROJECT # TE-00D4(097)
JOB # C-94-029-07
CONTRACT # 89456

