

F.A.S. RTE.	SECTION	COUNTY	TOTAL SHEETS	SHEET NO.
473	05-00046-12-RP	McLEAN	32	11
STA. 53+00		TO STA. 59+00		
FED. ROAD DIST. NO.		ILLINOIS FED. AID PROJECT		
CONTRACT NO. 91370				

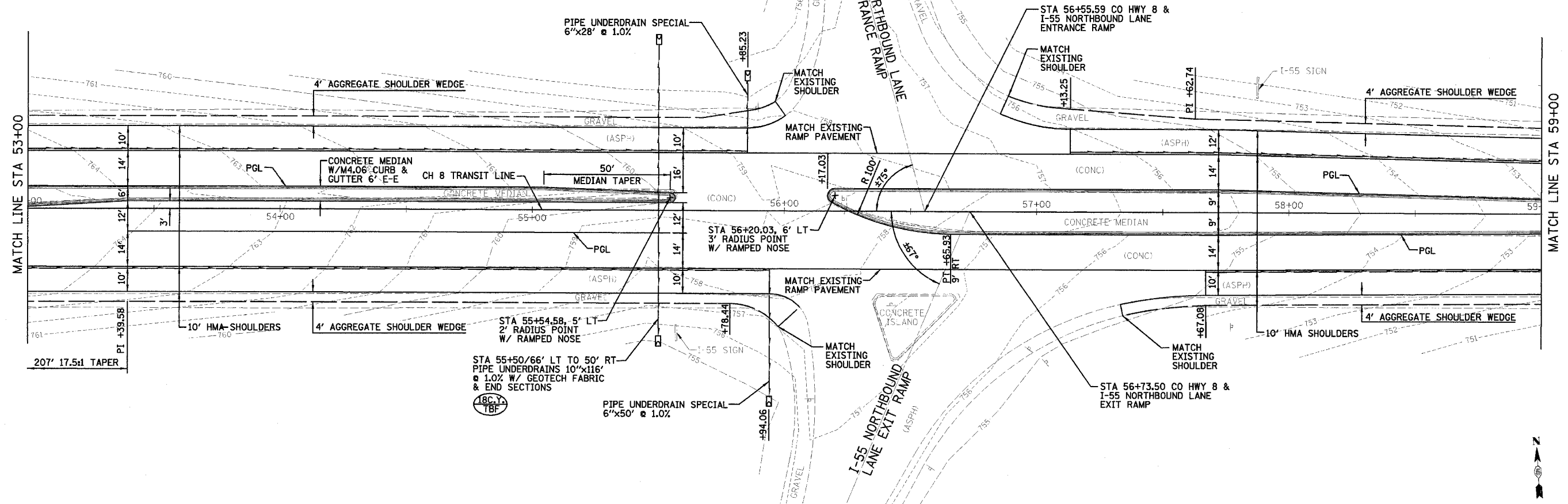

CO HWY 8 LEXINGTON OVERPASS

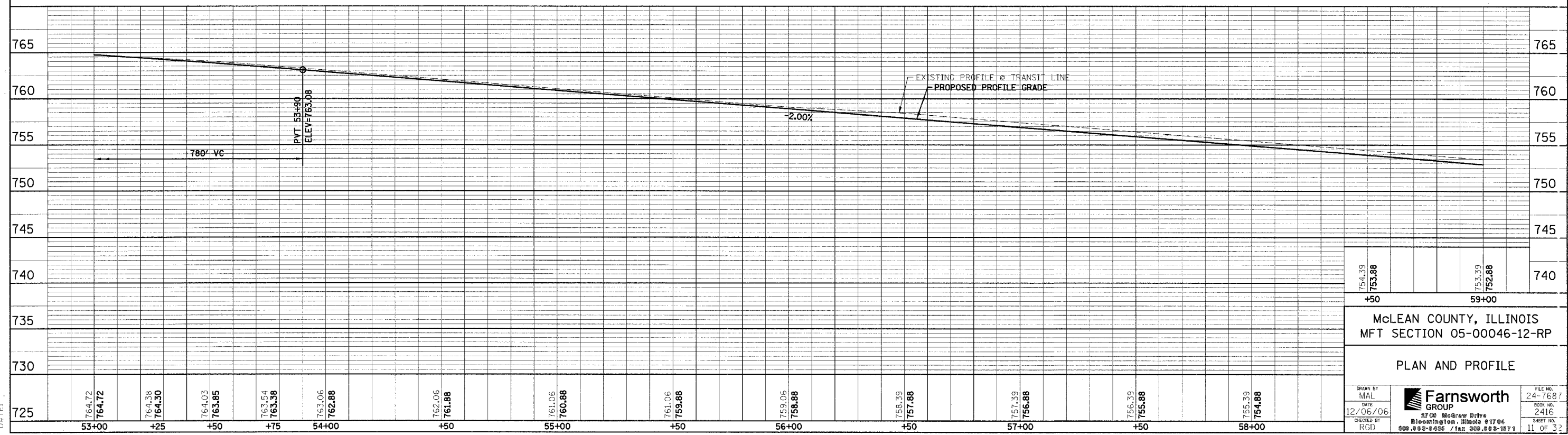
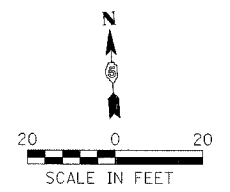

754.39	753.88	753.39	752.88
+50		59+00	
McLEAN COUNTY, ILLINOIS MFT SECTION 05-00046-12-RP			
PLAN AND PROFILE			
DRAWN BY MAL	CHECKED BY RGD	DATE 12/06/06	FILE NO. 24-7687 BOOK NO. 2-416 SHEET NO. 11 OF 32
			2700 McGraw Drive Bloomington, Illinois 61704 800.480-8455 / fax 309.886-1871

FILE:  
DATE: