

F.A.S. RTE.	SECTION	COUNTY	TOTAL SHEETS	SHEET NO.
473	05-00046-12-RP	McLEAN	32	16
STA.	TO STA.			
FED. ROAD DIST. NO.	ILLINOIS	FED. AID PROJECT		
CONTRACT NO. 91370				

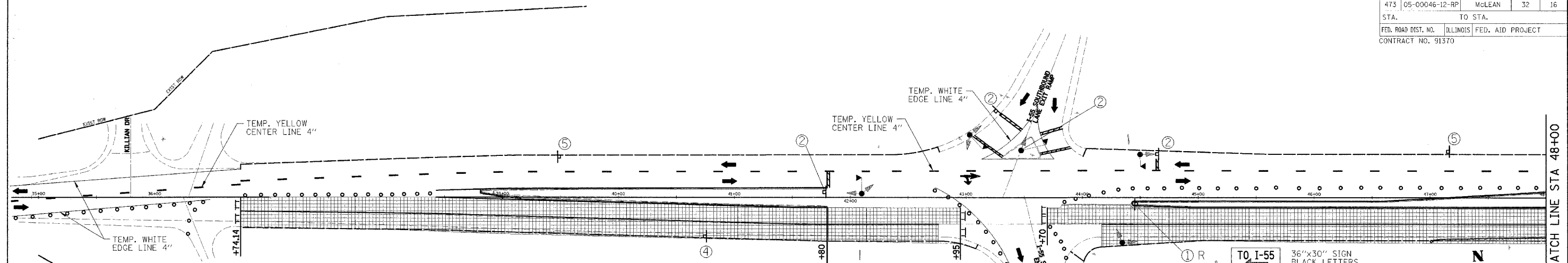

- STAGE III:**
- REMOVE EXISTING CONCRETE PAVEMENT, EXCAVATE FOR SUBBASE, AND HMA SHOULDERS AT THE FOLLOWING LOCATIONS:
 - STA 36+74.14 TO STA 42+95 EASTBOUND LANE
 - STA 43+70 TO STA 48+66.95 EASTBOUND LANE
 - STA 56+30 TO STA 57+30 EASTBOUND LANE
 - STA 63+15 TO STA 63+99.57 EASTBOUND LANE
 - CONSTRUCT PORTIONS OF UNDERDRAINS AT THE ABOVE LOCATIONS, INCLUDING OUTLET PIPE AND HEADWALLS.
 - PLACE SUBBASE MATERIAL AT THE ABOVE LOCATIONS.
 - PLACE PCC PAVEMENT AT THE ABOVE LOCATIONS.
 - PLACE HMA CONCRETE SHOULDERS AT THE ABOVE LOCATIONS.
 - MODIFY TRAFFIC CONTROL DEVICES AND STRIPING AS NEEDED FOR STAGE IV.

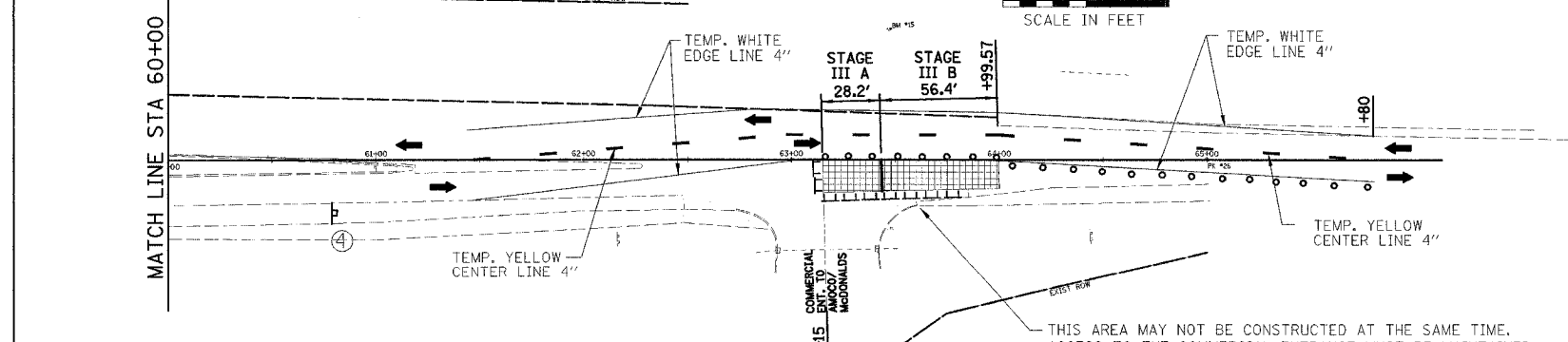
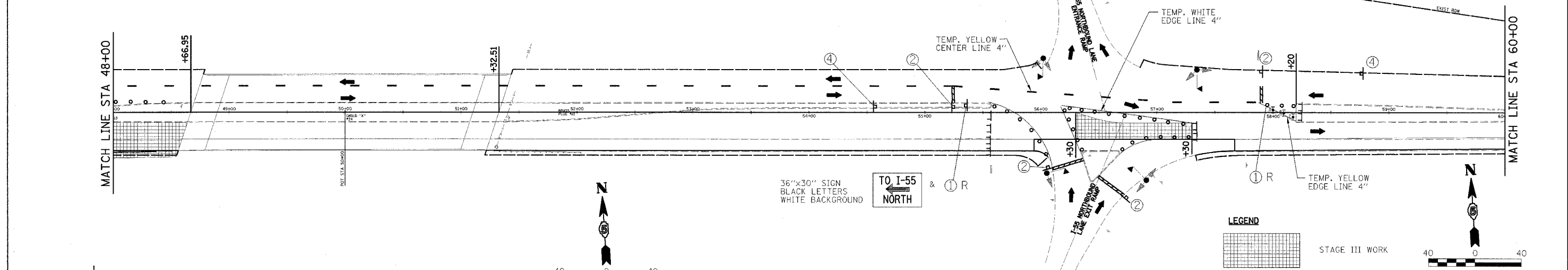

STAGE III GENERAL NOTES

- TWO 11 FOOT LANES MUST BE MAINTAINED AT ALL TIMES, UNLESS LOCATED WITHIN THE ONE-WAY AREA CONTROLLED BY THE TEMPORARY SIGNALS, WHICH SHALL HAVE ONE LANE WITH A MINIMUM 12' WIDTH.
- THE CONTRACTOR SHALL PLACE SIGNS STATING "RESTRICTED WIDTH" ON I-55 500' BEFORE EACH EXIT RAMP.
- EXISTING SIGNS AND PAVEMENT MARKINGS CONFLICTING WITH CONSTRUCTION TRAFFIC CONTROL SHALL BE REMOVED. CONFLICTING SIGNS MAY BE COVERED INSTEAD OF REMOVED AT THE OPTION OF THE CONTRACTOR.
- DRUM OR BARRICADE SPACING SHALL BE 8 FOOT CENTER-TO-CENTER AROUND LANE CLOSURES AND IN TAPERS AND 25 FOOT IN TANGENT SECTIONS, UNLESS OTHERWISE SHOWN.

THIS AREA MAY NOT BE CONSTRUCTED AT THE SAME TIME. ACCESS TO THE COMMERCIAL ENTRANCE MUST BE MAINTAINED AT ALL TIMES. THEREFORE ONLY ONE PORTION, STAGE III A OR STAGE III B, SHALL BE CONSTRUCTED AT A TIME. CONSTRUCTION JOINTS SHALL MATCH SAW JOINTS IN ADJACENT PAVEMENT. TEMPORARY PAVEMENT MARKING-LETTERS AND SYMBOLS PAY ITEM SHALL BE USED TO PLACE DIRECTIONAL ARROWS ON THE ENTRANCE DURING PHASING.

LEGEND

- STAGE III WORK
- POLE WITH SIGNAL HEAD
- MICROWAVE DETECTOR
- TEMPORARY WHITE LINE, 24" (STOP BAR)
- SIGN
- DRUMS OR TYPE I BARRICADES
- TYPE III BARRICADES WITH "ROAD CLOSED" SIGN (G20-100(O))
- VERTICAL BARRICADE
- VERTICAL BARRICADE WITH DIRECTIONAL ARROW
- PROPOSED TRAFFIC FLOW
- STOP SIGN

OR	OR	R10-11A-2430	OR
R4-7A-3648	R10-6A-3036	R4-8-3648	W1-4-48
①	②	③	④
L OR R			

McLEAN COUNTY, ILLINOIS
MFT SECTION 05-00046-12-RP

STAGE CONSTRUCTION PLAN
STAGE III

DRAWN BY MAL		FILE NO. 24-7687
DATE 12/06/06		BOOK NO. 2416
CHECKED BY RCD		SHEET NO. 16 OF 32
2700 McGraw Drive Bloomington, Illinois 61706 800.883-8435 / Fax 800.883-1871		