

F.A.S. RTE.	SECTION	COUNTY	TOTAL SHEETS	SHEET NO.
473	05-00046-12-RP	McLEAN	32	19
STA.	TO STA.			
FED. ROAD DIST. NO.	ILLINOIS	FED. AID PROJECT		
CONTRACT NO. 91370				

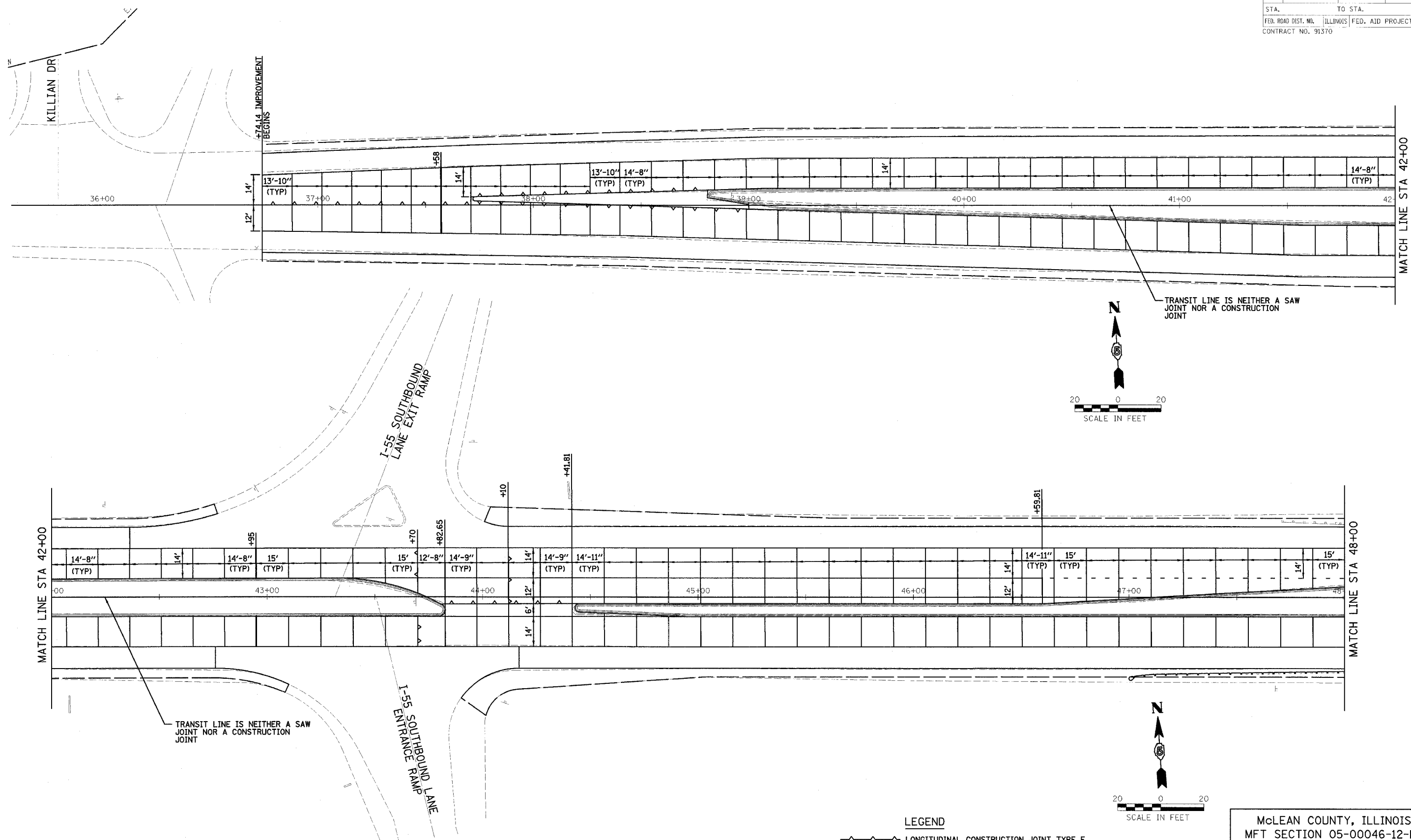

LEGEND

- LONGITUDINAL CONSTRUCTION JOINT TYPE E OR TIED TRANSVERSE CONSTRUCTION JOINT TYPE D
- SAWED TRANSVERSE JOINT TYPE C
- 1" EXPANSION JOINT W/ DOWEL BARS

NOTE: NO LOAD TRANSFER ASSEMBLIES ARE REQUIRED AT SAWED TRANSVERSE CONTRACTION JOINTS.

McLEAN COUNTY, ILLINOIS
MFT SECTION 05-00046-12-RP

SAW JOINT DETAIL PLAN

DRAWN BY MAL	Farnsworth GROUP 2700 McGraw Drive Bloomington, Illinois 61704 800.888.8438 / fax 800.888.1871	FILE NO. 24-7687
DATE 12/06/06		BOOK NO. 2416
CHECKED BY RGD		SHEET NO. 19 OF 32