

| | | | | |
|---------------------|----------------|---------------------------|--------------|-----------|
| F.A.S. RTE. | SECTION | COUNTY | TOTAL SHEETS | SHEET NO. |
| 473 | 05-00046-12-RP | McLEAN | 32 | 20 |
| STA. | | TO STA. | | |
| FED. ROAD DIST. NO. | | ILLINOIS FED. AID PROJECT | | |
| CONTRACT NO. 91370 | | | | |

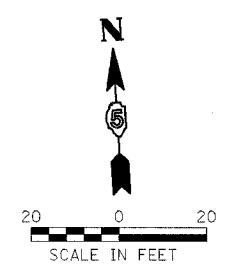
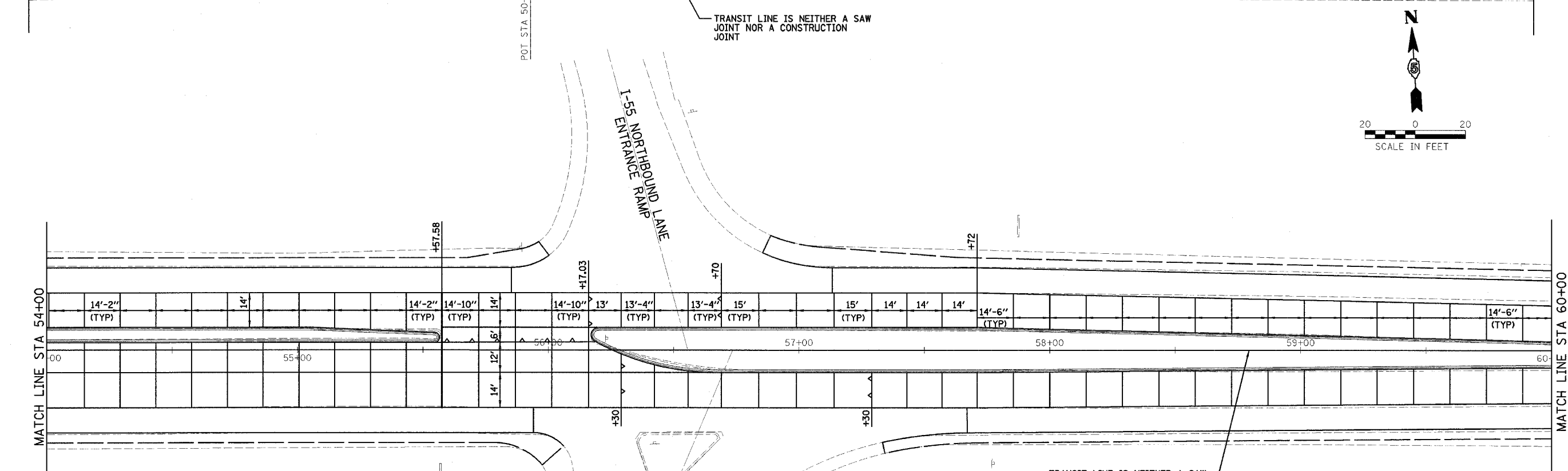
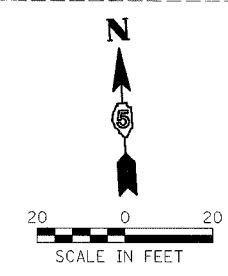
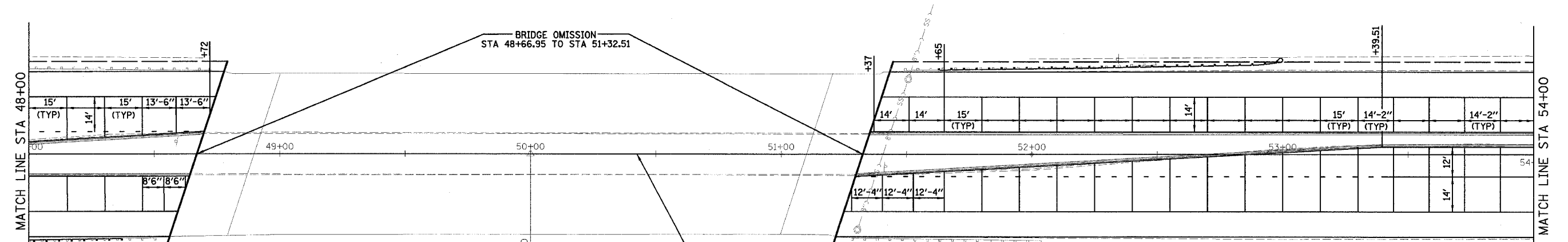

- LEGEND**
- LONGITUDINAL CONSTRUCTION JOINT TYPE E OR TIED TRANSVERSE CONSTRUCTION JOINT TYPE D
 - SAWED TRANSVERSE JOINT TYPE C
 - 1" EXPANSION JOINT W/ DOWEL BARS

NOTE: NO LOAD TRANSFER ASSEMBLIES ARE REQUIRED AT SAWED TRANSVERSE CONTRACTION JOINTS.

McLEAN COUNTY, ILLINOIS
MFT SECTION 05-00046-12-RP

SAW JOINT DETAIL PLAN

| | | |
|-------------------|---|-----------------------|
| DRAWN BY MAL | | FILE NO. 24-7687 |
| DATE 12/06/06 | | BOOK NO. 2416 |
| CHECKED BY RGD | 2700 McGraw Drive Bloomington, Illinois 61704 309.833-2435 / fax 309.833-1871 | SHEET NO. 20 OF 32 |