

F.A.U. RTE.	SECTION	COUNTY	TOTAL SHEETS	SHEET NO.
7902	...	CHRISTIAN	67	18
STA. 154+00.00		TO STA. 168+00.00		
FED. ROAD DIST. NO.		ILLINOIS FED. AID PROJECT		
... 03-00055-00-FP				

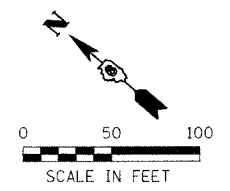

DESIGN	INT.	DATE	REASON

PLAN	DATE	BY

PLOTS & CHECKS	INT.	DATE	NO.	REASON

PROF. FILE	DATE	BY

CHECKS	INT.	DATE	REASON

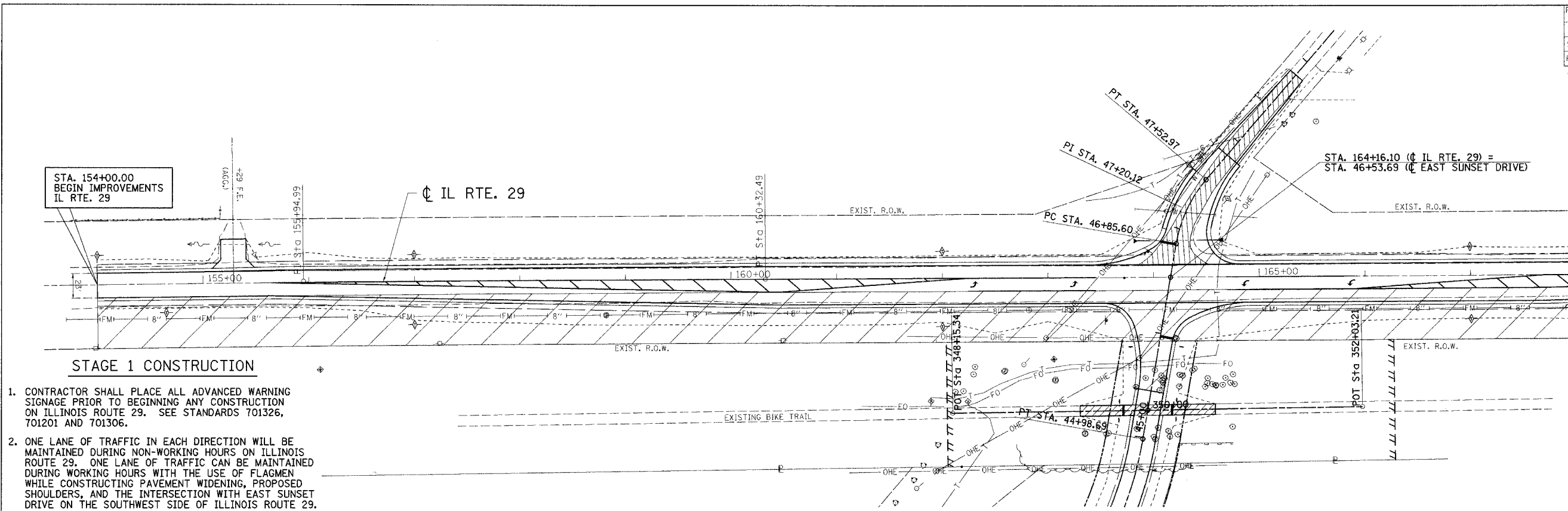

- STAGE 1 CONSTRUCTION**
- CONTRACTOR SHALL PLACE ALL ADVANCED WARNING SIGNAGE PRIOR TO BEGINNING ANY CONSTRUCTION ON ILLINOIS ROUTE 29. SEE STANDARDS 701326, 701201 AND 701306.
 - ONE LANE OF TRAFFIC IN EACH DIRECTION WILL BE MAINTAINED DURING NON-WORKING HOURS ON ILLINOIS ROUTE 29. ONE LANE OF TRAFFIC CAN BE MAINTAINED DURING WORKING HOURS WITH THE USE OF FLAGMEN WHILE CONSTRUCTING PAVEMENT WIDENING, PROPOSED SHOULDERS, AND THE INTERSECTION WITH EAST SUNSET DRIVE ON THE SOUTHWEST SIDE OF ILLINOIS ROUTE 29.
 - THE CONTACTOR SHALL PROVIDE AND MAINTAIN ACCESS TO TR 205B AT ALL TIMES DURING CONSTRUCTION.
 - THE EXISTING BIKE TRAIL WILL NOT BE DISTURBED DURING THIS STAGE.

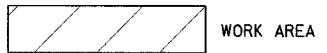

STAGE 1

REVISION	DATE	BY

GREENE & BRADFORD, INC.
 CONSULTING ENGINEERS
 1000 W. STATE ST. / SUITE 200 / TAYLORVILLE, IL 62586
 (618) 291-1100

COMPUTER FILE NO.
 STAGE1-01

PROJECT: 02159
 06/12/06-GSJ

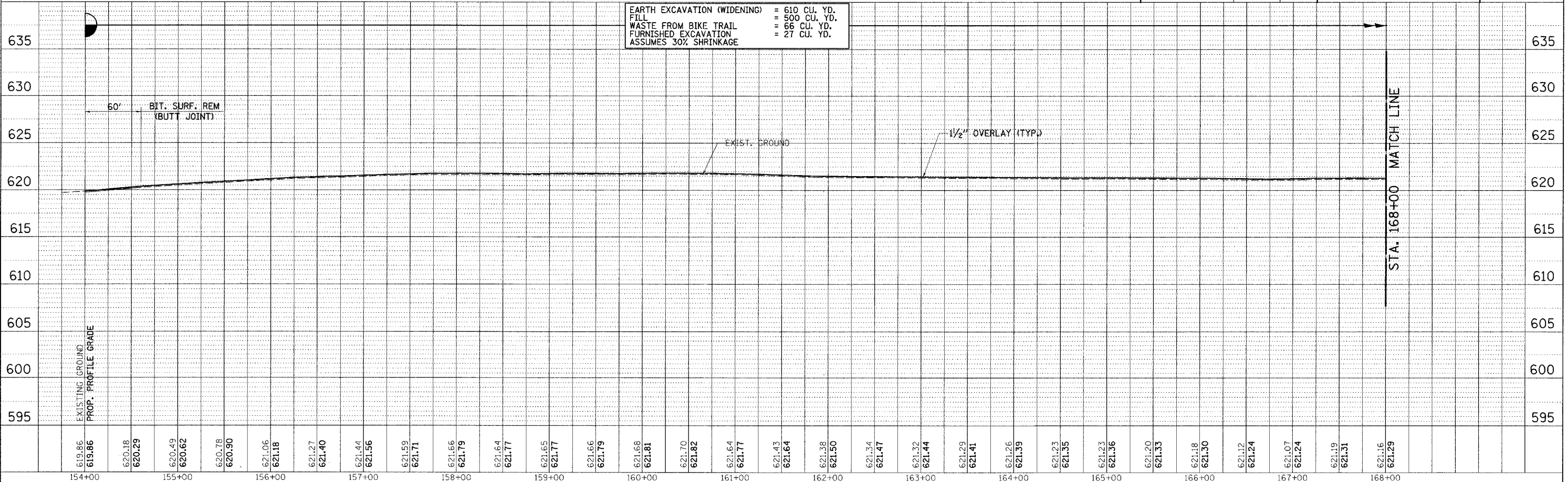

EARTH EXCAVATION (WIDENING) = 610 CU. YD.
 FILL = 500 CU. YD.
 WASTE FROM BIKE TRAIL = 66 CU. YD.
 FURNISHED EXCAVATION = 27 CU. YD.
 ASSUMES 30% SHRINKAGE