

**RONALD W. &
 PATRICIA L. UTTERBACK**

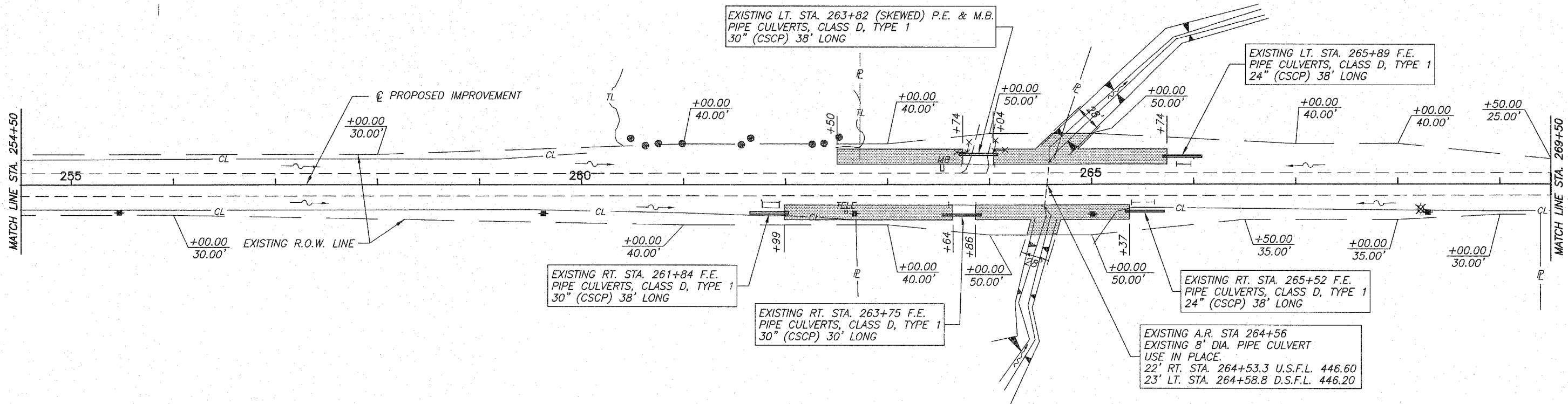

SCALES
 1" = 50' HOR.
 1" = 5' VER.

SUSAN W. SHOLEM BRIDGES

N.E. 1/4, N.E. 1/4, SEC. 34, T.10N., R.13W., 2ND PM.

INDICATES STONE RIPRAP DITCH (EXISTING)

J. BENNETT

S.E. 1/4, N.E. 1/4, SEC. 34, T.10N., R.13W., 2ND PM.

B.M. #18 - 2 SPIKE NAILS IN P.P.
 28' RT. STA. 255+47
 ELEV. 465.67

