

S.W. 1/4, S.W. 1/4, SEC. 35, T.10N., R.13W., 2ND PM.

CHARLES E. HILLS

ALL TIES
IRON PINS

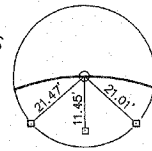

P.I. STA. 300+49.49
IRON PIN (FLUSH)

W. 1/2, N.W. 1/4, SEC. 2, T.9N., R.13W., 2ND PM.

WILLIAM HILLS ET. AL.

| ROUTE NO. | SECTION | COUNTY | TOTAL SHEETS | SHEET NO. |
|-----------------------|----------------|---------|--------------|-----------|
| F.A.S. 896 | 08-00262-00-RS | CLARK | 27 | 11 |
| FED. ROAD DIST. NO. 7 | ILLINOIS | PROJECT | RS-696(106) | |

CONTRACT NO. 95487

CURVE DATA

PI STA=300+49.49
 $\Delta = 6^{\circ}07'44''$ R
 D= 2'59'59"
 R=1910.08'
 T=102.26'
 L=204.32'
 E=2.74'
 S.E. = 0.060'/' ATTAINED IN 162'
 STA. 298+39.24 TO STA. 300+01.24
 TRANSITION TO NO CROWN IN 122'
 STA. 301+20 TO STA. 302+42

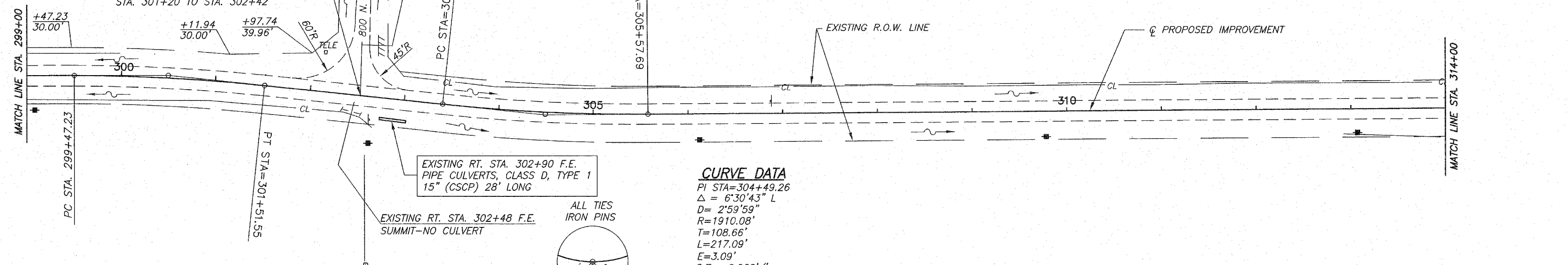

CURVE DATA

PI STA=304+49.26
 $\Delta = 6^{\circ}30'43''$ L
 D= 2'59'59"
 R=1910.08'
 T=108.66'
 L=217.09'
 E=3.09'
 S.E. = 0.060'/'
 TRANSITION FROM NO CROWN IN 122'
 STA. 302+42 TO STA. 303+64
 ATTAINED IN 162'
 STA. 305+03.67 TO STA. 306+65.67

ALL TIES
IRON PINS

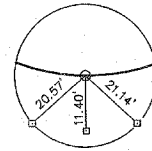

P.I. STA. 304+49.26
P.K. NAIL (FLUSH)

ANNA JEANNETTE HILLS

S.E. 1/4, S.E. 1/4, SEC. 34, T.10N., R.13W., 2ND PM.

JOAN BENNETT

N.E. 1/4, N.E. 1/4, SEC. 3, T.9N., R.13W., 2ND PM.

