

F.A. RTE.	SECTION	COUNTY	TOTAL SHEETS	SHEET NO.
*	**	WILLIAMSON	917	125
STA. TO STA.				
FED. ROAD DIST. NO. ILLINOIS FED. AID PROJECT				
* I-57, & OLD IL 13 (FAU 9629)				
** (X1-6-2)VB-2,(X1-6)HBK-2				

STA. 1545+60 (C NB) SKEWED 42° RT. AH.  
 EXIST. 36" RCCP EXTEND WITH  
 PIPE CULVERTS, CLASS A, TYPE 2 36"  
 LT. 12.0', DSFL = 455.47  
 RT. 24.0', USFL = 457.04  
 CONCRETE COLLAR 0.66 CU. YDS. EACH (SEE DETAIL SHEET)  
 CAST-IN-PLACE REINFORCED CONCRETE END SECTIONS 36"  
 PIPE CULVERT REMOVAL  
 CONCRETE HEADWALL REMOVAL  
 EXTENSION RT. MUST BE COMPLETED PRIOR TO I-57 STAGE 3 CONSTRUCTION  
 EXTENSION LT. MUST BE COMPLETED PRIOR TO I-57 STAGE 3 CONSTRUCTION

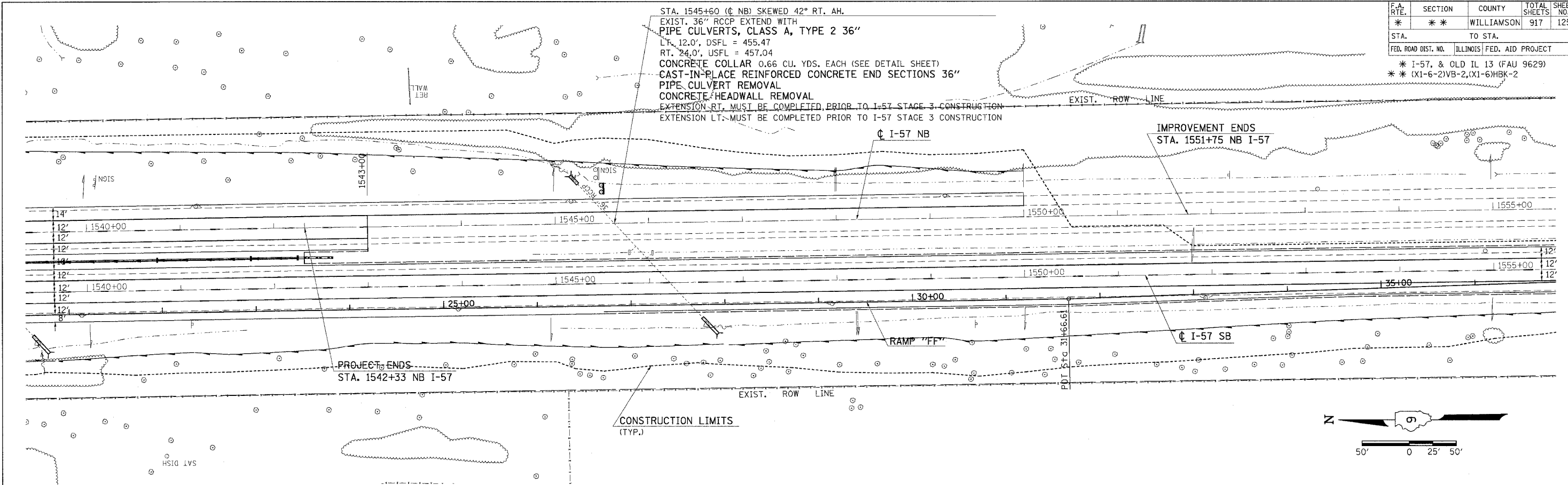

**NORTHBOUND**

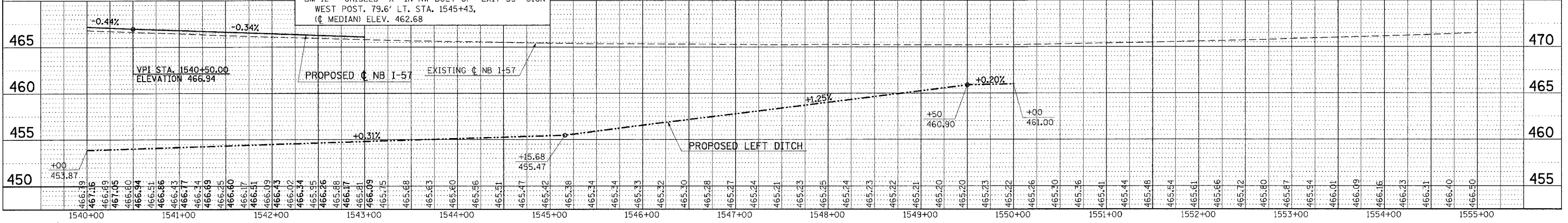

**SOUTHBOUND**

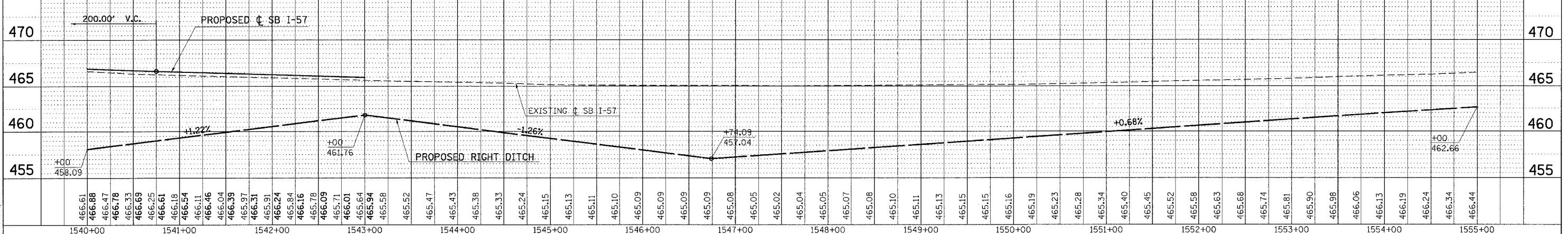

**I-57 PLAN - PROFILE STA. 1540+00 TO STA. 1555+00**

DATE	BY	REVISION

DATE	BY	REVISION

PLOT DATE = 12/7/2006  
 FILE NAME = I:\Projects\98950\98950.dwg  
 PLOT SCALE = 50.0000 / IN.  
 USER NAME = hudson  
 PPR44, IPT4