

F.A. RTE.	SECTION	COUNTY	TOTAL SHEETS	SHEET NO.
*	**	WILLIAMSON	917	131
STA.		TO STA.		
FED. ROAD DIST. NO.		ILLINOIS FED. AID PROJECT		
* I-57, & OLD IL 13 (FAU 9629)				
** (X1-6-2)VB-2,(X1-6)HBK-2				

# DETOUR PLAN: RAMP E AND FF CLOSED

FOR I-57 STAGE 4, 7, 7A, 7B, 7C

**LEGEND**

- PROPOSED SIGN
- EXISTING SIGN
- TRAFFIC FLOW
- CHANGEABLE MESSAGE SIGN
- CLOSED RAMP
- EXISTING SIGN

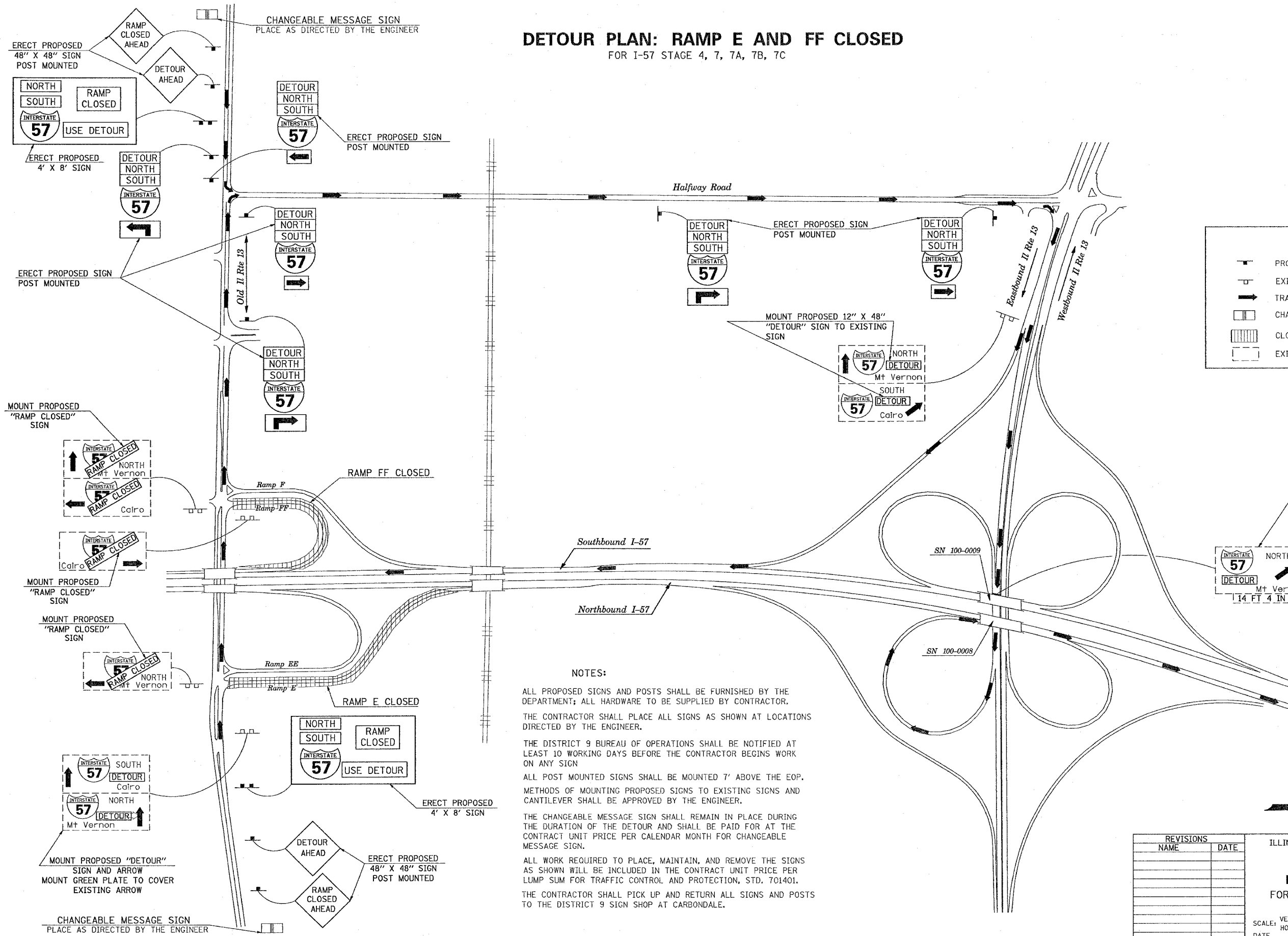

**NOTES:**

ALL PROPOSED SIGNS AND POSTS SHALL BE FURNISHED BY THE DEPARTMENT; ALL HARDWARE TO BE SUPPLIED BY CONTRACTOR. THE CONTRACTOR SHALL PLACE ALL SIGNS AS SHOWN AT LOCATIONS DIRECTED BY THE ENGINEER.

THE DISTRICT 9 BUREAU OF OPERATIONS SHALL BE NOTIFIED AT LEAST 10 WORKING DAYS BEFORE THE CONTRACTOR BEGINS WORK ON ANY SIGN

ALL POST MOUNTED SIGNS SHALL BE MOUNTED 7' ABOVE THE EOP. METHODS OF MOUNTING PROPOSED SIGNS TO EXISTING SIGNS AND CANTILEVER SHALL BE APPROVED BY THE ENGINEER.

THE CHANGEABLE MESSAGE SIGN SHALL REMAIN IN PLACE DURING THE DURATION OF THE DETOUR AND SHALL BE PAID FOR AT THE CONTRACT UNIT PRICE PER CALENDAR MONTH FOR CHANGEABLE MESSAGE SIGN.

ALL WORK REQUIRED TO PLACE, MAINTAIN, AND REMOVE THE SIGNS AS SHOWN WILL BE INCLUDED IN THE CONTRACT UNIT PRICE PER LUMP SUM FOR TRAFFIC CONTROL AND PROTECTION, STD. 701401.

THE CONTRACTOR SHALL PICK UP AND RETURN ALL SIGNS AND POSTS TO THE DISTRICT 9 SIGN SHOP AT CARBONDALE.

MOUNT PROPOSED 12" X 48" "DETOUR" SIGN TO EXISTING SIGN ATTACHED TO SN 100-0009

14 FT 4 IN

REVISIONS	
NAME	DATE

ILLINOIS DEPARTMENT OF TRANSPORTATION

**DETOUR PLAN**

**RAMP E AND FF CLOSED**

FOR I-57 STAGE 4, 7, 7A, 7B, 7C

SCALE: VERT. NONE  
DATE:            HORIZ.

DRAWN BY CNH  
CHECKED BY

PLOT DATE = 12/8/2006  
FILE NAME = c:\temp\proj\98950\131.dwg  
USER NAME = hudson