



F.A. RTE.	SECTION	COUNTY	TOTAL SHEETS	SHEET NO.
*	*	WILLIAMSON	917	176
STA. TO STA.				
FED. ROAD DIST. NO. ILLINOIS FED. AID PROJECT				
* I-57, & OLD IL 13 (FAU 9629)				
* (X1-6-2)VB-2,(X1-6)HBK-2				

LEGEND

-  INLET AND PIPE PROTECTION
-  TEMPORARY DITCH CHECKS
-  TEMPORARY EROSION CONTROL SEEDING

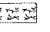
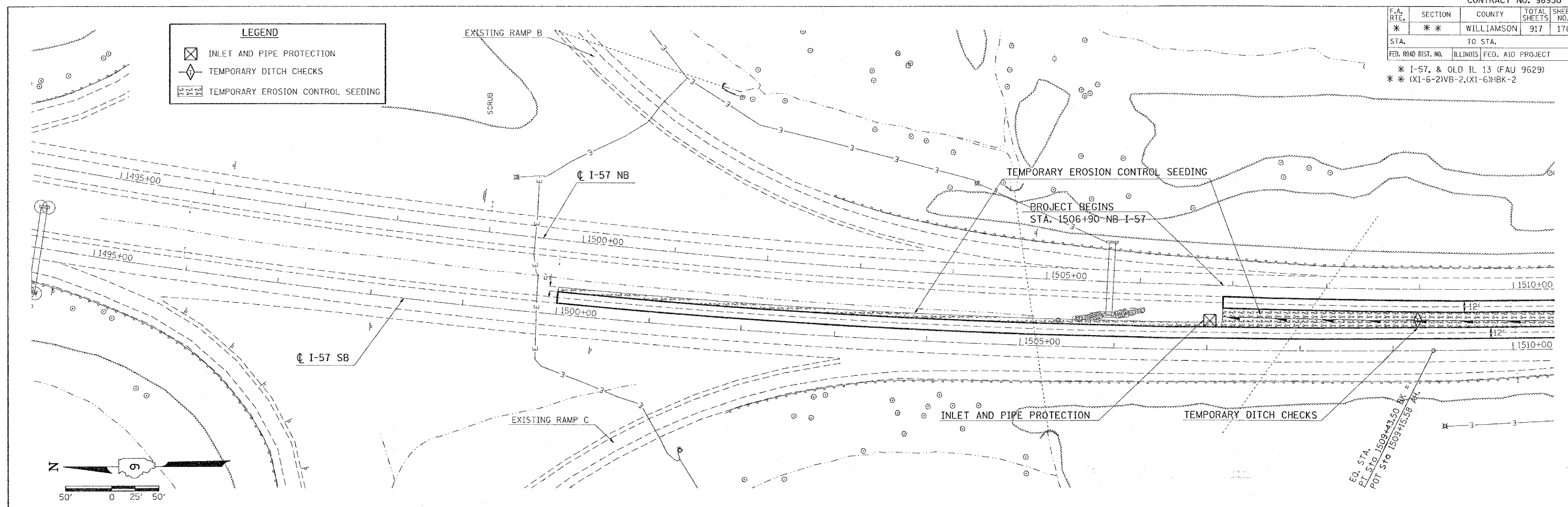

PLAN

REVISIONS	DATE
PLOTTED	
ALIGNED	
CHECKED	
NO. _____	DATE _____

PROFILE

REVISIONS	DATE
GRADES CHECKED	
PLOTTED	
STRUCTURE NOTATION CHECKED	
NO. _____	DATE _____

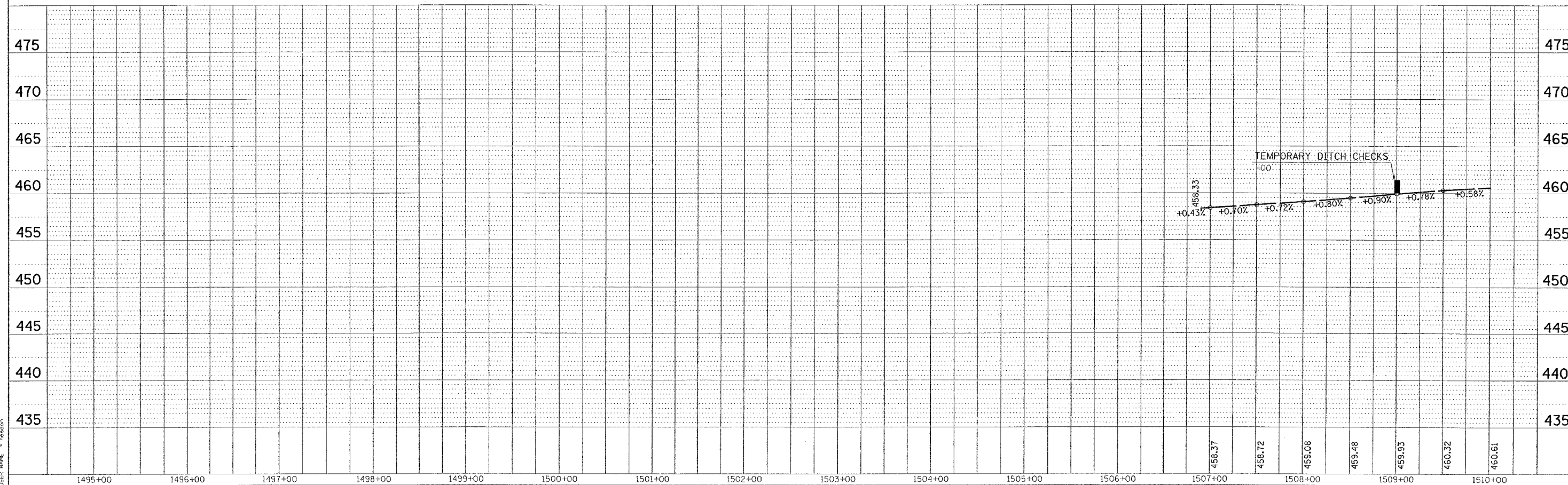

PLOT DATE = 10/26/2006
 PLOT SCALE = 1" = 40' / H
 USER NAME = heherson

TEMPORARY EROSION CONTROL I-57 FOR STAGE 1A - STA. 1495+00 TO STA. 1510+00