

F.A. RTE.	SECTION	COUNTY	TOTAL SHEETS	SHEET NO.
*	*	WILLIAMSON	917	324
STA.	TO STA.			
FED. ROAD DIST. NO.	ILLINOIS	FED. AID PROJECT		

* I-57, & OLD IL 13 (FAU 9629)
* (X1-6-2)VB-2,(X1-6)HBK-2

LEGEND

- INLET AND PIPE PROTECTION
- TEMPORARY DITCH CHECKS
- SEDIMENT BASIN
- EROSION CONTROL BLANKET
- PERIMETER EROSION BARRIER
- PIPE CULVERT AND END SECTIONS 8" (EROSION CONTROL)

EXIST. CURVE NBL102
PI STA. = 1496+40.64
 $\Delta = 18^\circ 56' 34''$ (LT)
 $D = 0^\circ 40' 00''$
 $R = 8,594.33'$
 $T = 1,433.79'$
 $L = 2,841.41'$
 $E = 118.78'$
P.C. STA. = 1482+06.85
P.T. STA. = 1510+48.26

EXIST. CURVE SBL102
PI STA. = 1495+35.88
 $\Delta = 18^\circ 56' 34''$ (LT)
 $D = 0^\circ 40' 00''$
 $R = 8,594.33'$
 $T = 1,433.79'$
 $L = 2,841.41'$
 $E = 118.78'$
P.C. STA. = 1481+02.09
P.T. STA. = 1509+43.50

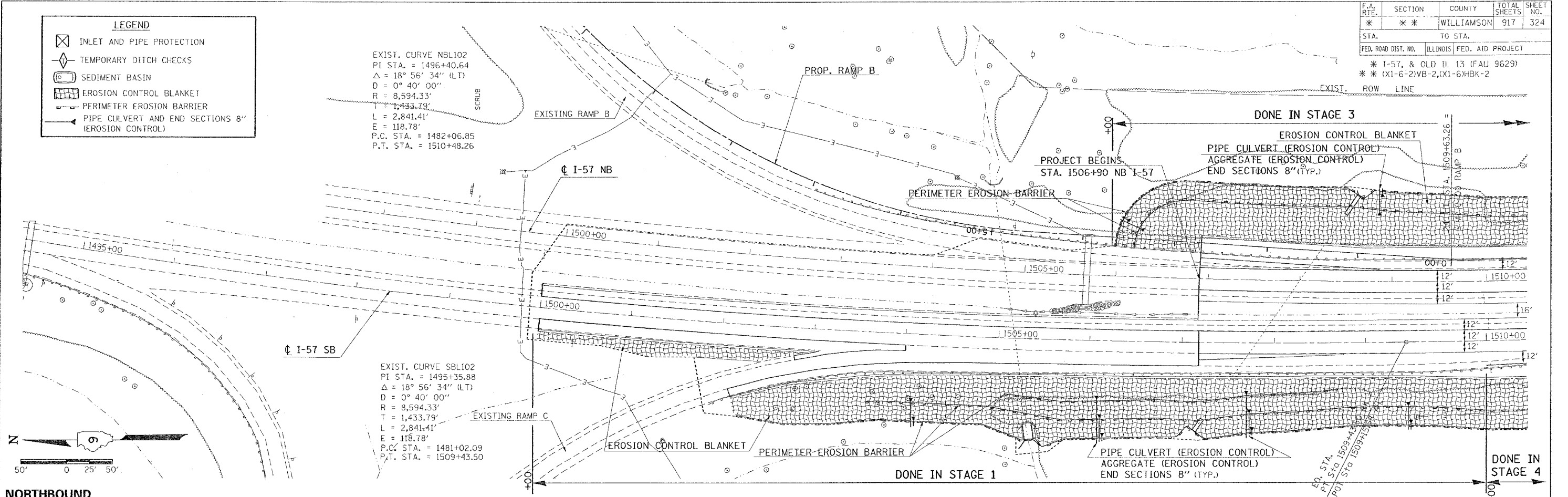

NORTHBOUND

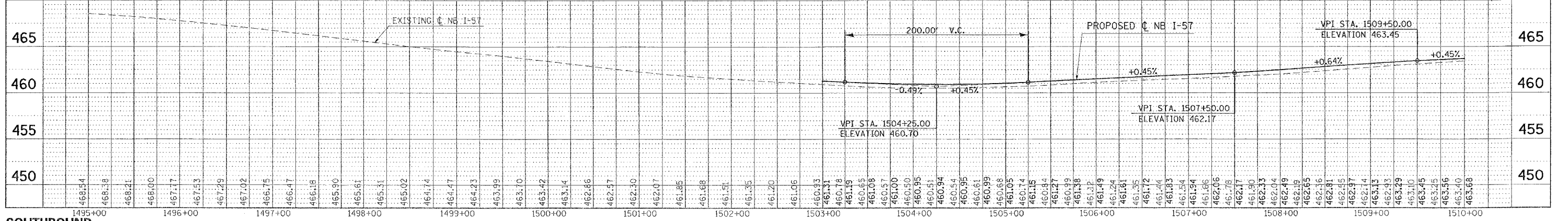

SOUTHBOUND

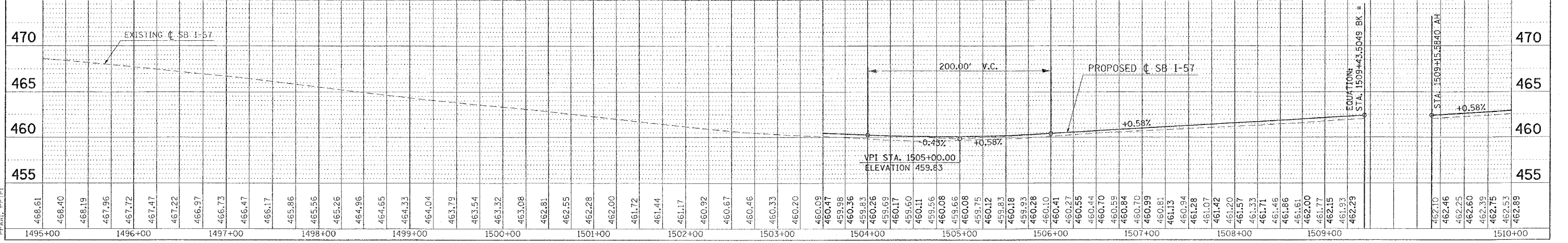

TEMPORARY EROSION CONTROL FAI-57 FOR STAGES 1, 2, 3, 4 - STA. 1495+00 TO STA. 1510+00

DATE	BY
DATE	BY

DATE	BY
DATE	BY

LOT DATE = 10/10/2008
FILE NAME = c:\p08\meta\p082802\d13\p13s.dgn
PLOT SCALE = 500000 / 1" IN.
USER NAME = hmd
PLOT DATE = 10/10/2008