

CONTRACT NO. 98950			
F.A. RTE.	SECTION	COUNTY	TOTAL SHEET NO.
*	**	WILLIAMSON	917 447
STA. 4+75.0000		TO STA. 5+25.0000	
FED. ROAD DIST. NO. ILLINOIS FED. AID PROJECT			
* I-57, & OLD IL 13 (FA) 9629			
** (X1-6-2)NB-2, (X1-6)RBK-2			

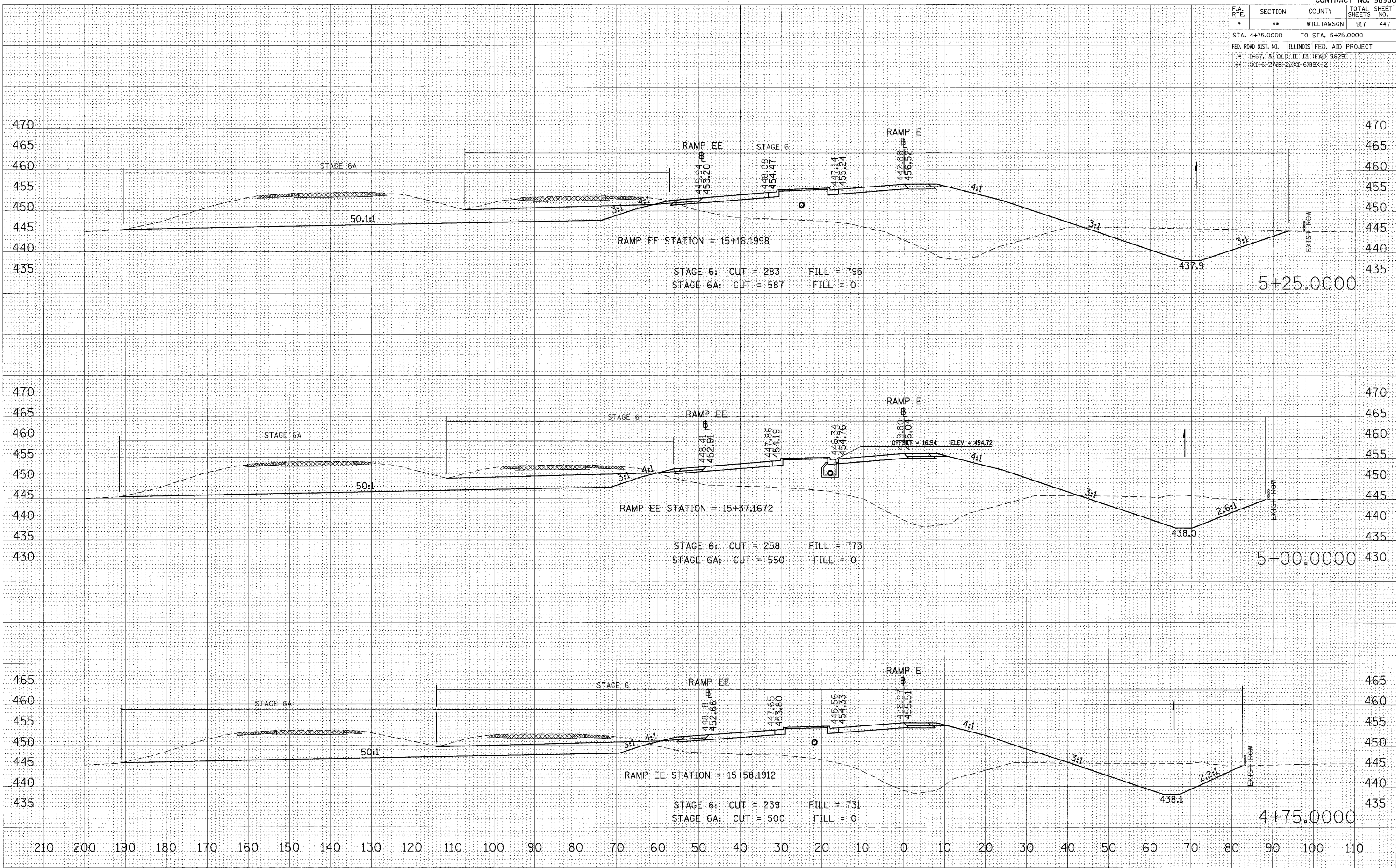

DATE: _____
 BY: _____
 SURVEYED: _____
 PLOTTED: _____
 NOTE BOOK: _____
 AREAS CHECKED: _____
 NO. _____

DATE: _____
 BY: _____
 SURVEYED: _____
 PLOTTED: _____
 NOTE BOOK: _____
 AREAS CHECKED: _____
 NO. _____

DATE: 10/26/2006
 PLOT SCALE: 1/8" = 10.0000' / IN.
 USER NAME: lavendrbba

STA 4+75.0000 TO STA 5+25.0000 RAMP E